

PPM Energy - Rugby 230 kV Wind Farm Line

Engineers: Steve M. Olson & Rick S. Johnson, PE

9/22/2005
Page 1/15

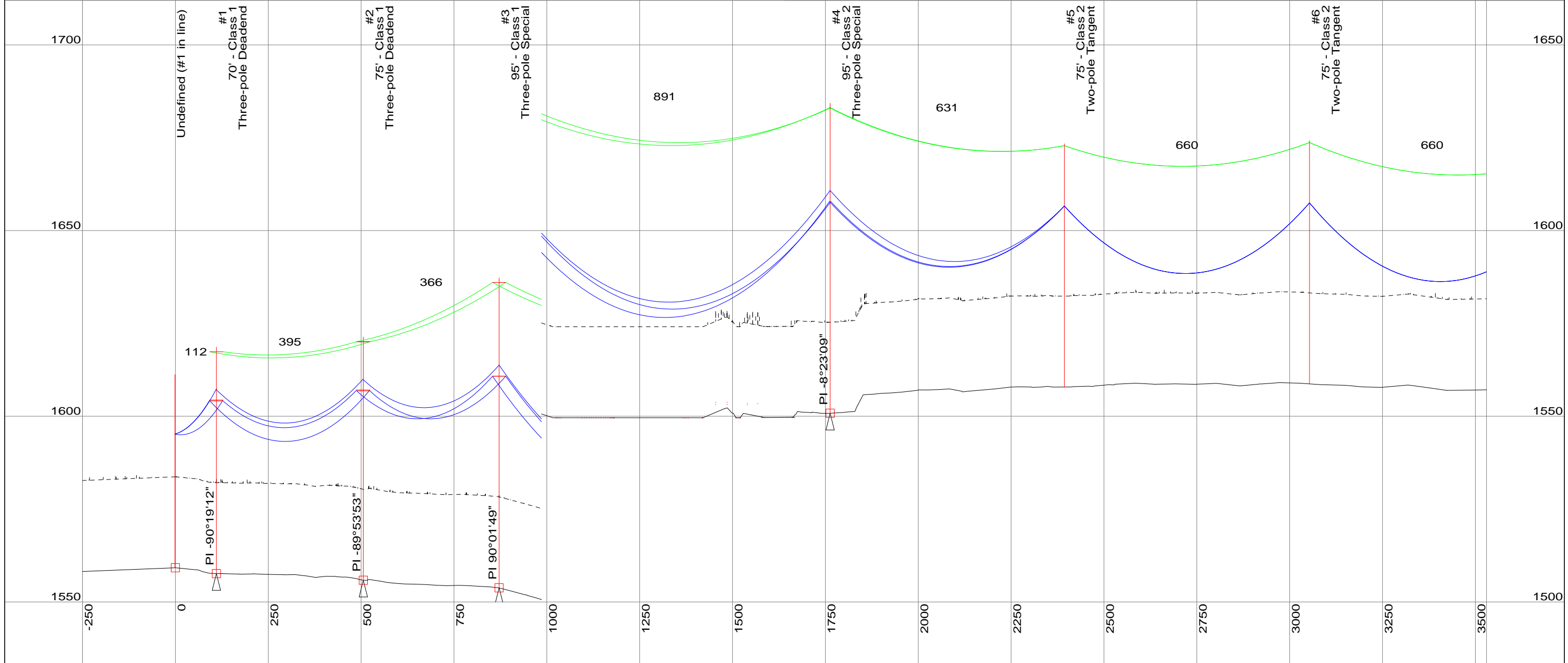

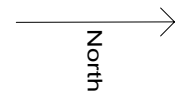
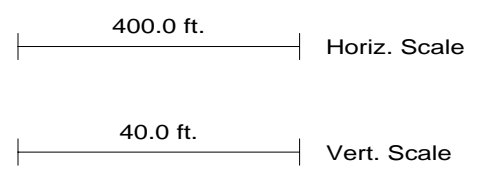
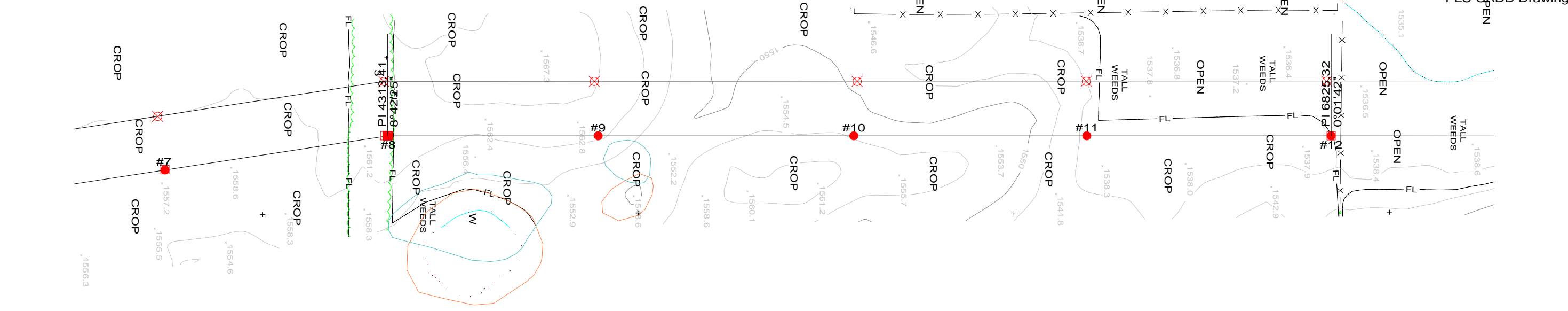

PPM Energy - Rugby 230 kV Wind Farm Line
 Engineers: Steve M. Olson & Rick S. Johnson, PE
 9/22/2005
 Page 2/15

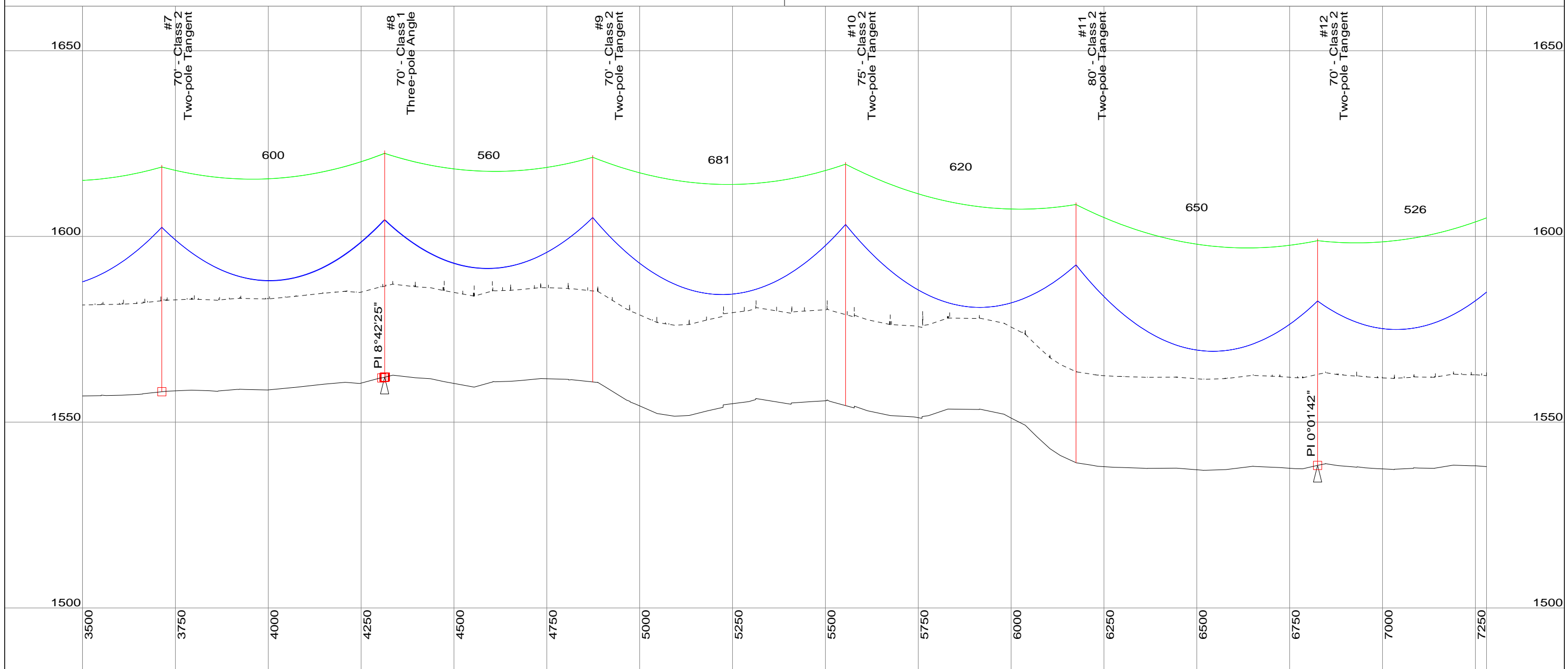

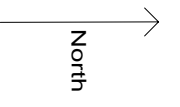
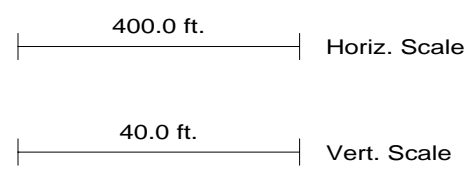
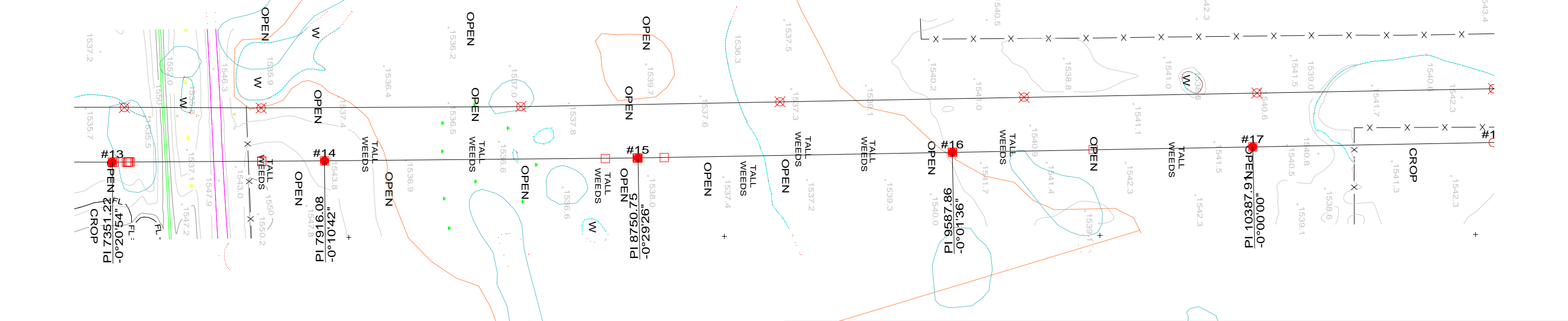

PPM Energy - Rugby 230 kV Wind Farm Line

Engineers: Steve M. Olson & Rick S. Johnson, PE

9/22/2005
Page 3/15

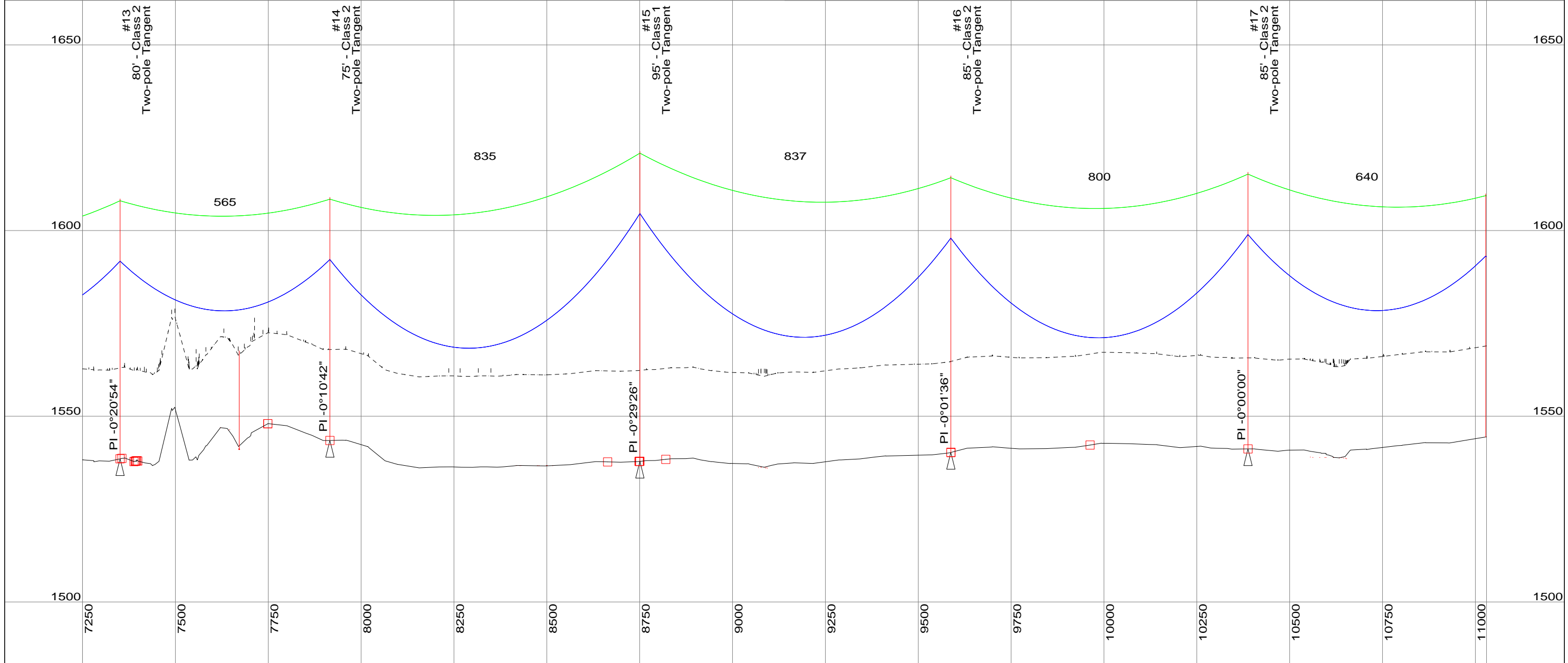

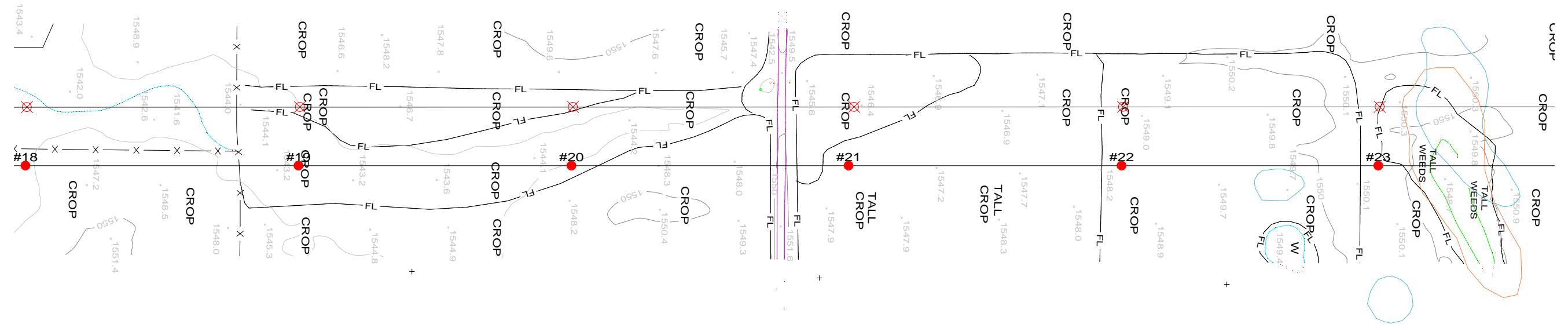

PPM Energy - Rugby 230 kV Wind Farm Line

Engineers: Steve M. Olson & Rick S. Johnson, PE

9/22/2005
Page 4/15

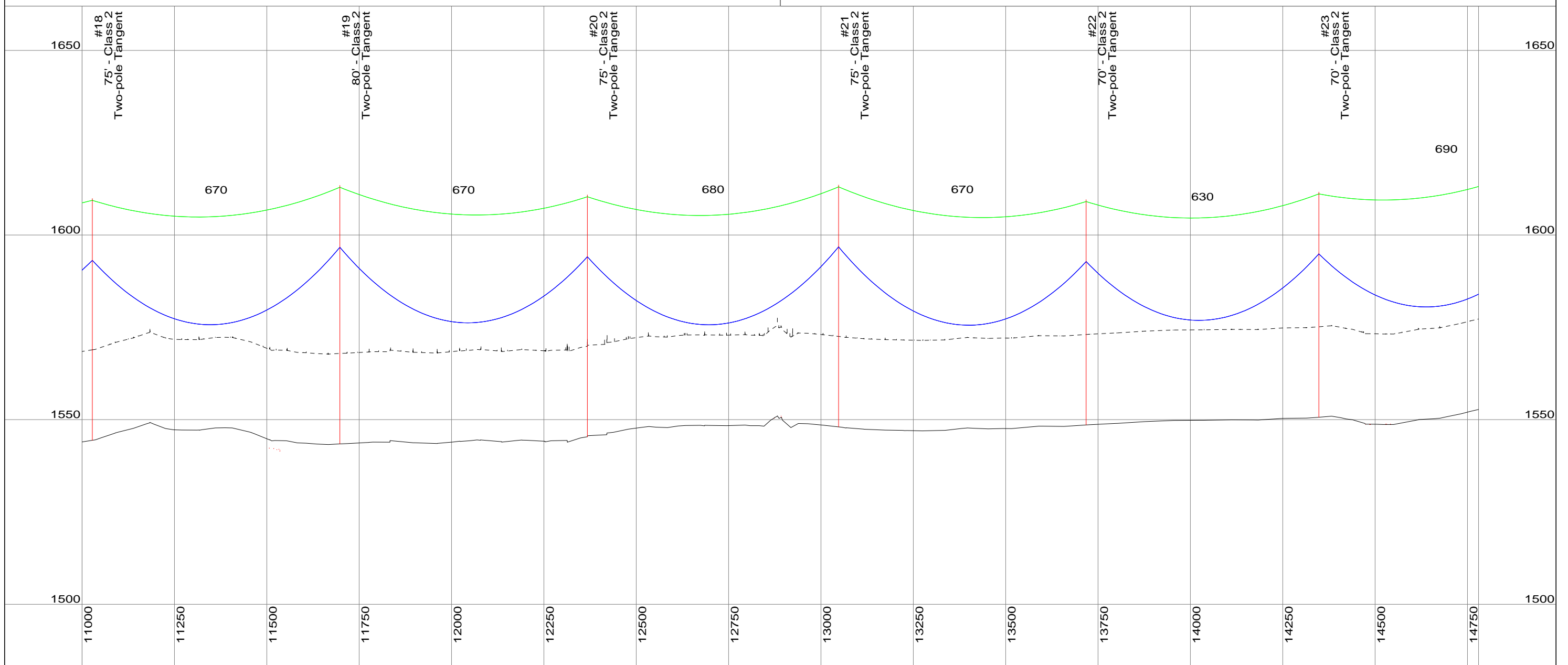
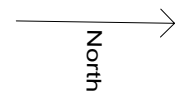
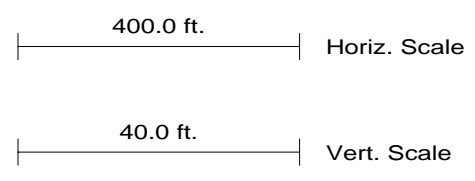

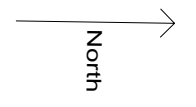
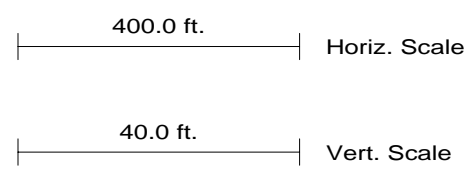
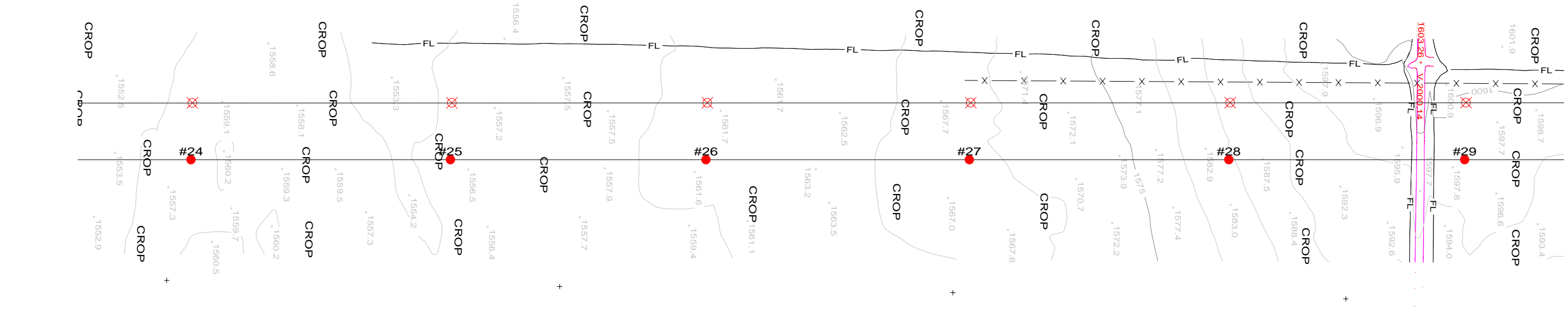

PPM Energy - Rugby 230 kV Wind Farm Line

Engineers: Steve M. Olson & Rick S. Johnson, PE

9/22/2005
Page 5/15

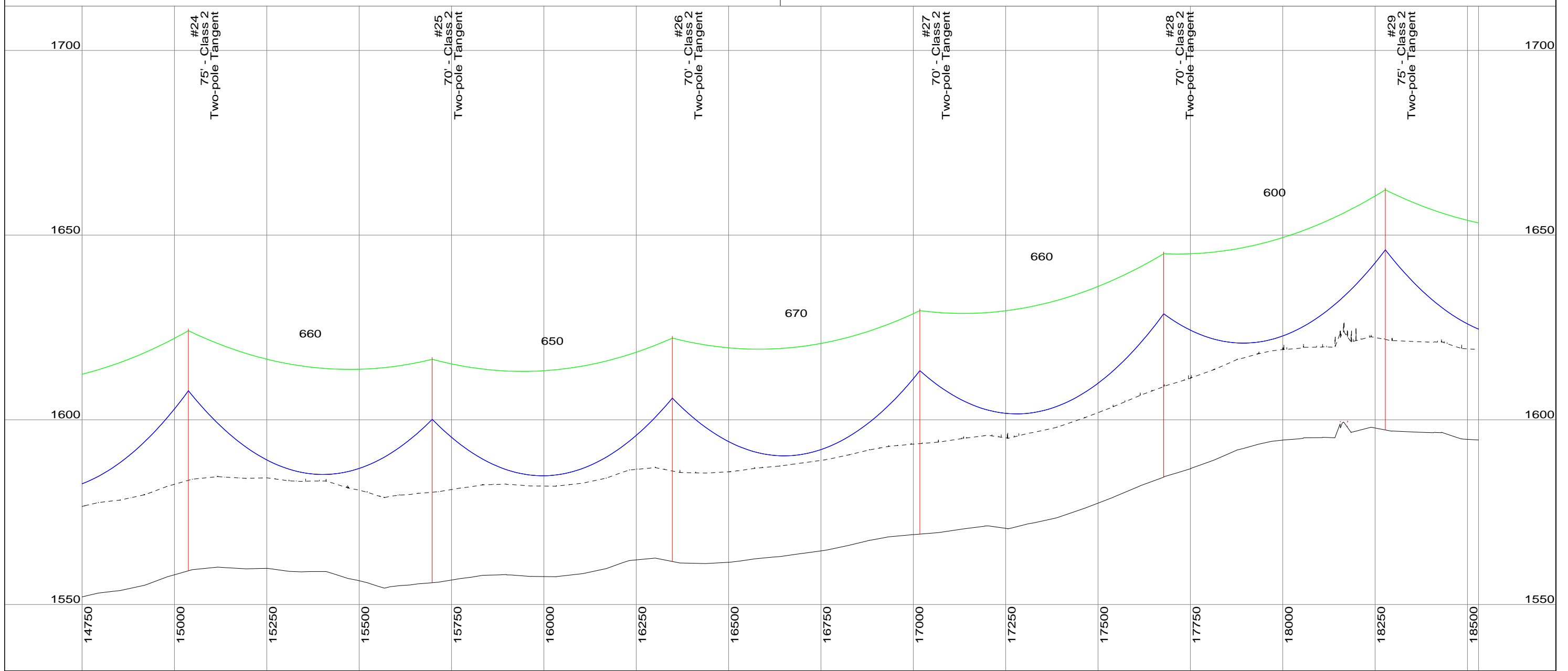

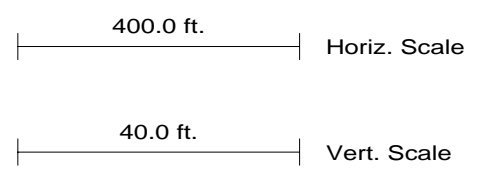
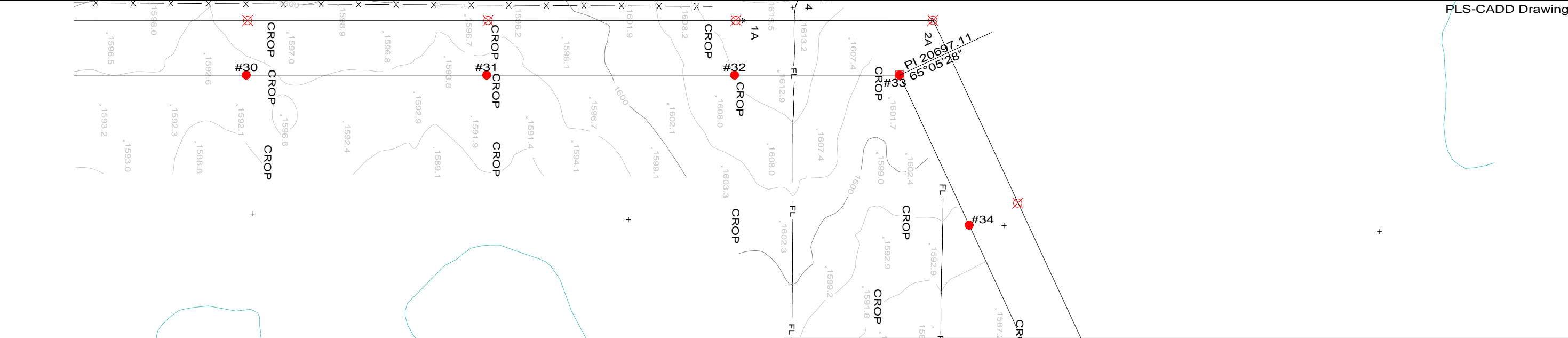

PPM Energy - Rugby 230 kV Wind Farm Line

Engineers: Steve M. Olson & Rick S. Johnson, PE 9/22/2005
Page 6/15

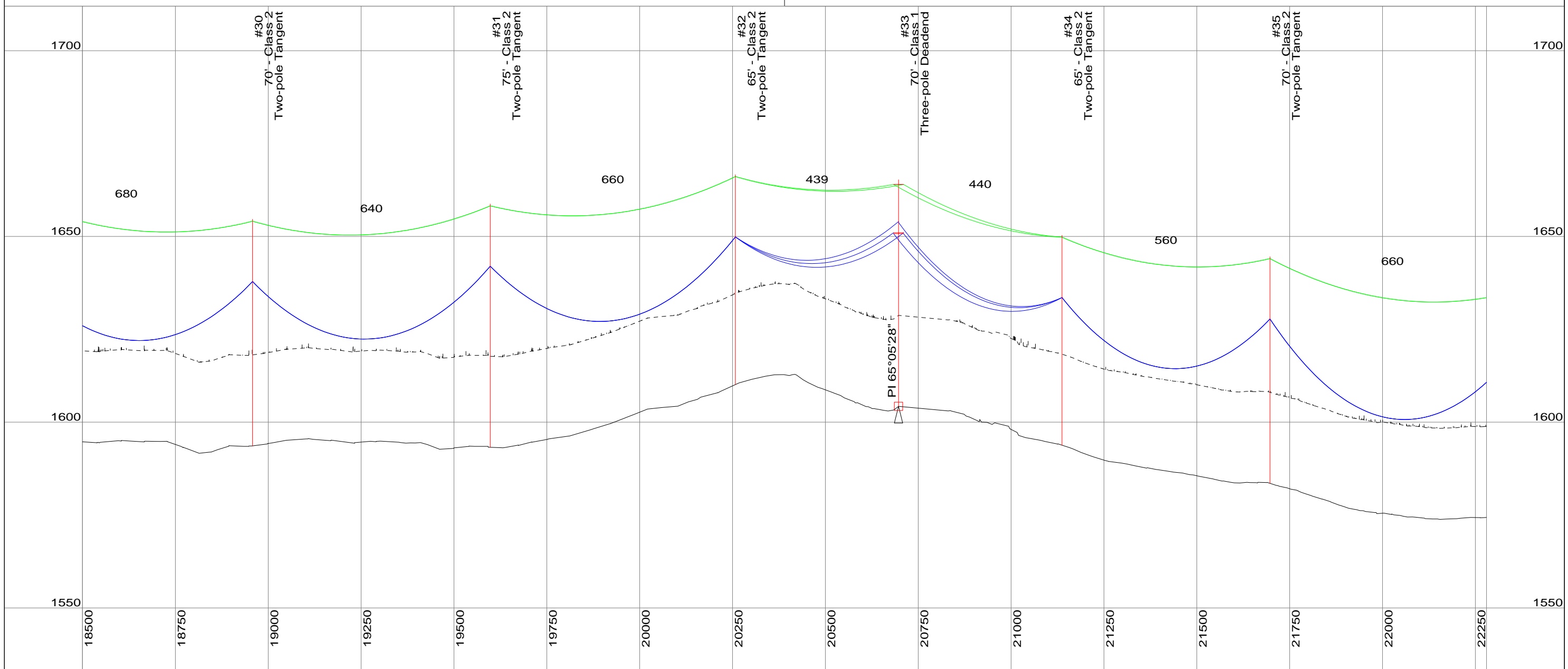

N 516G

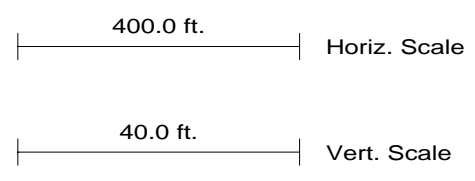
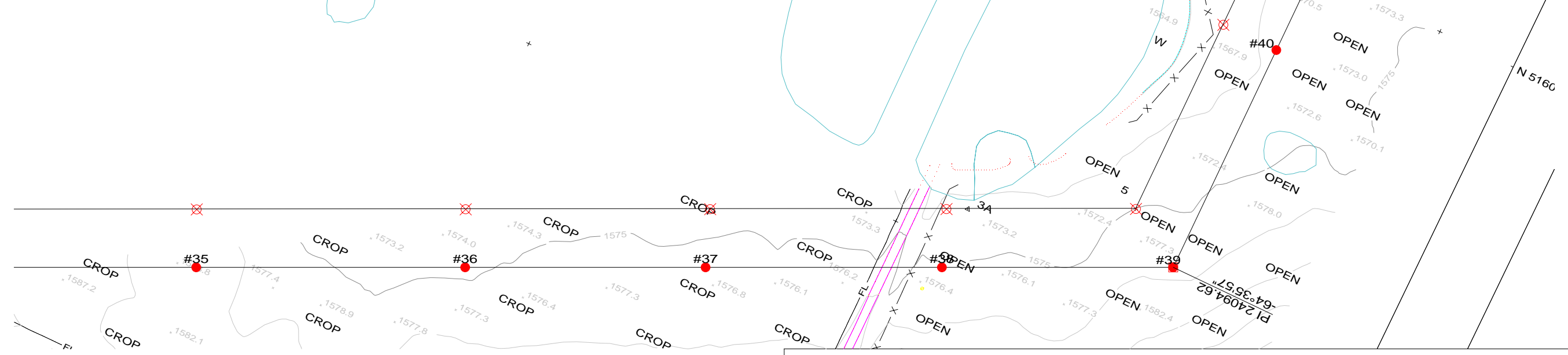

PPM Energy - Rugby 230 kV Wind Farm Line

Engineers: Steve M. Olson & Rick S. Johnson, PE

9/22/2005
Page 7/15

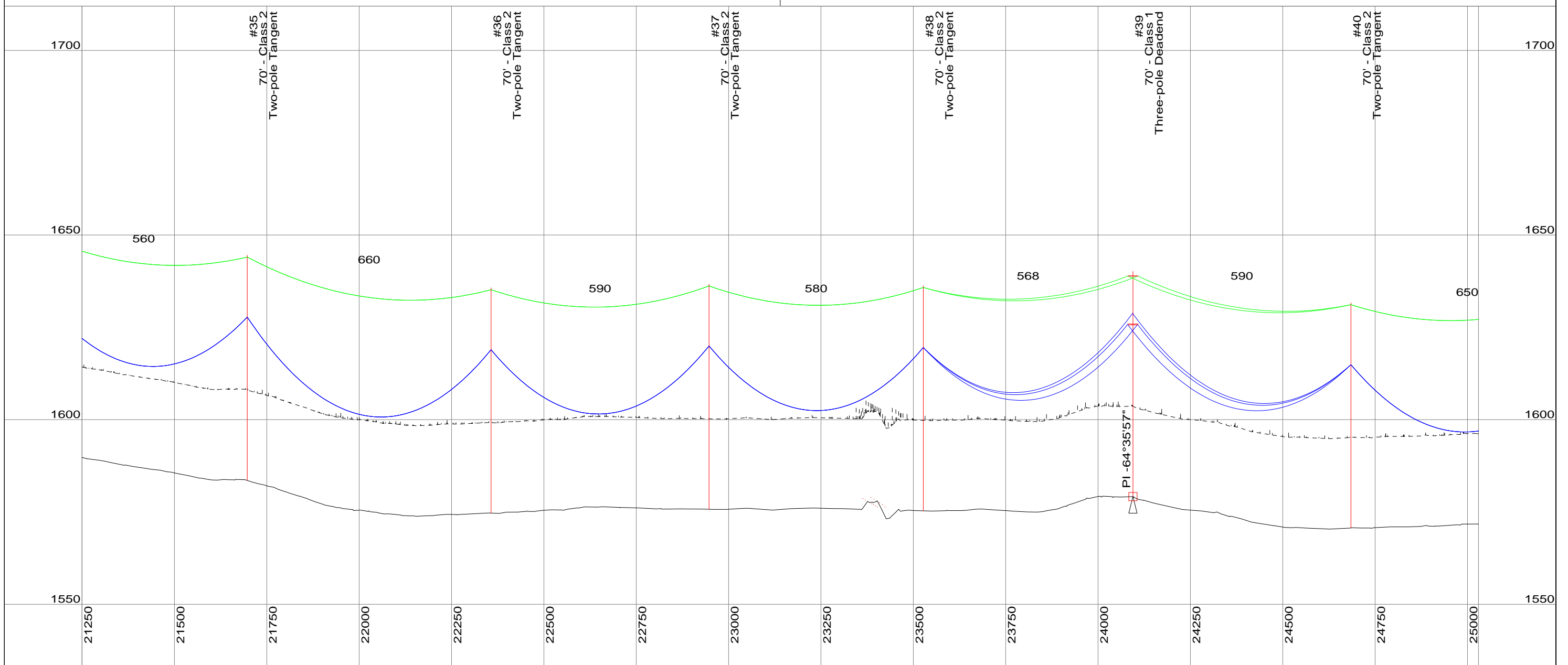

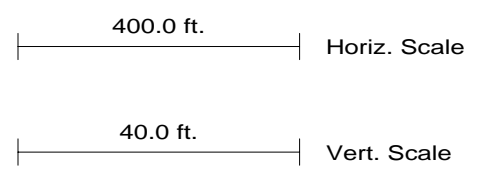
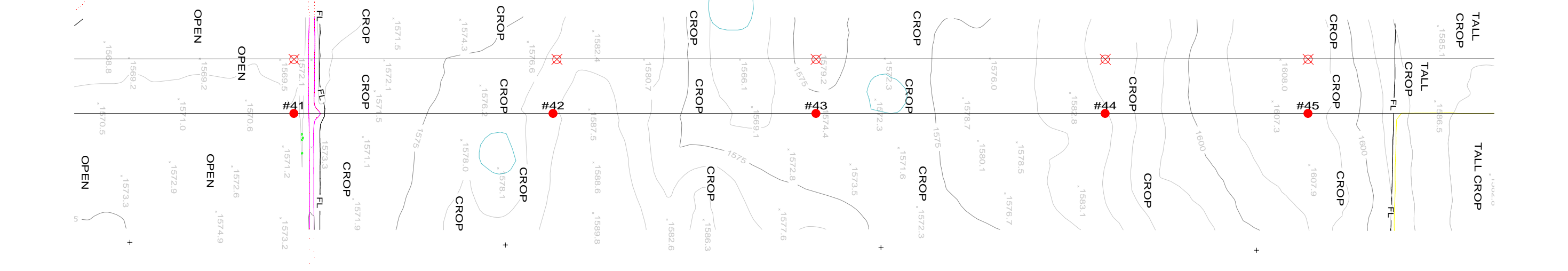

PPM Energy - Rugby 230 kV Wind Farm Line

Engineers: Steve M. Olson & Rick S. Johnson, PE

9/22/2005
Page 8/15

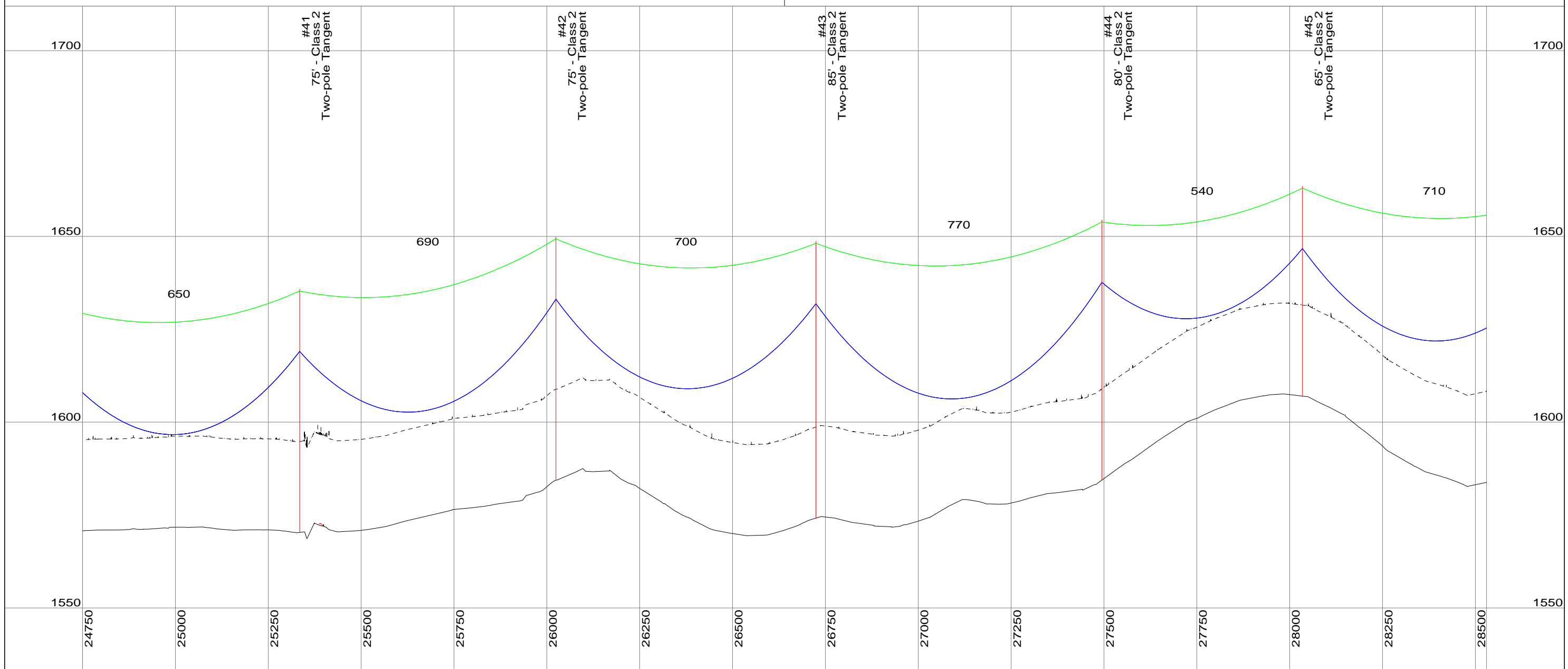

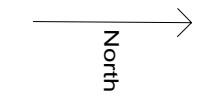
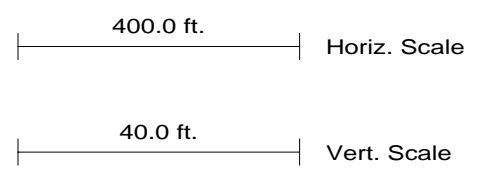
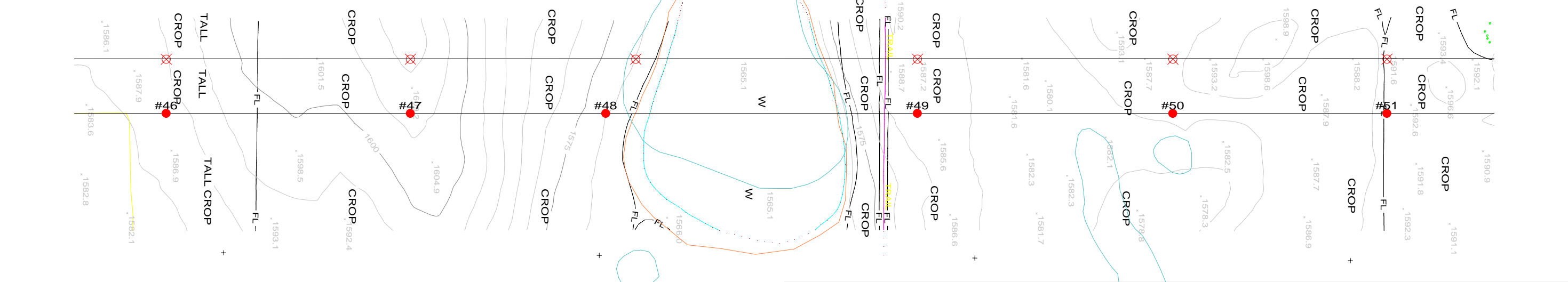

PPM Energy - Rugby 230 kV Wind Farm Line
 Engineers: Steve M. Olson & Rick S. Johnson, PE
 9/22/2005
 Page 9/15

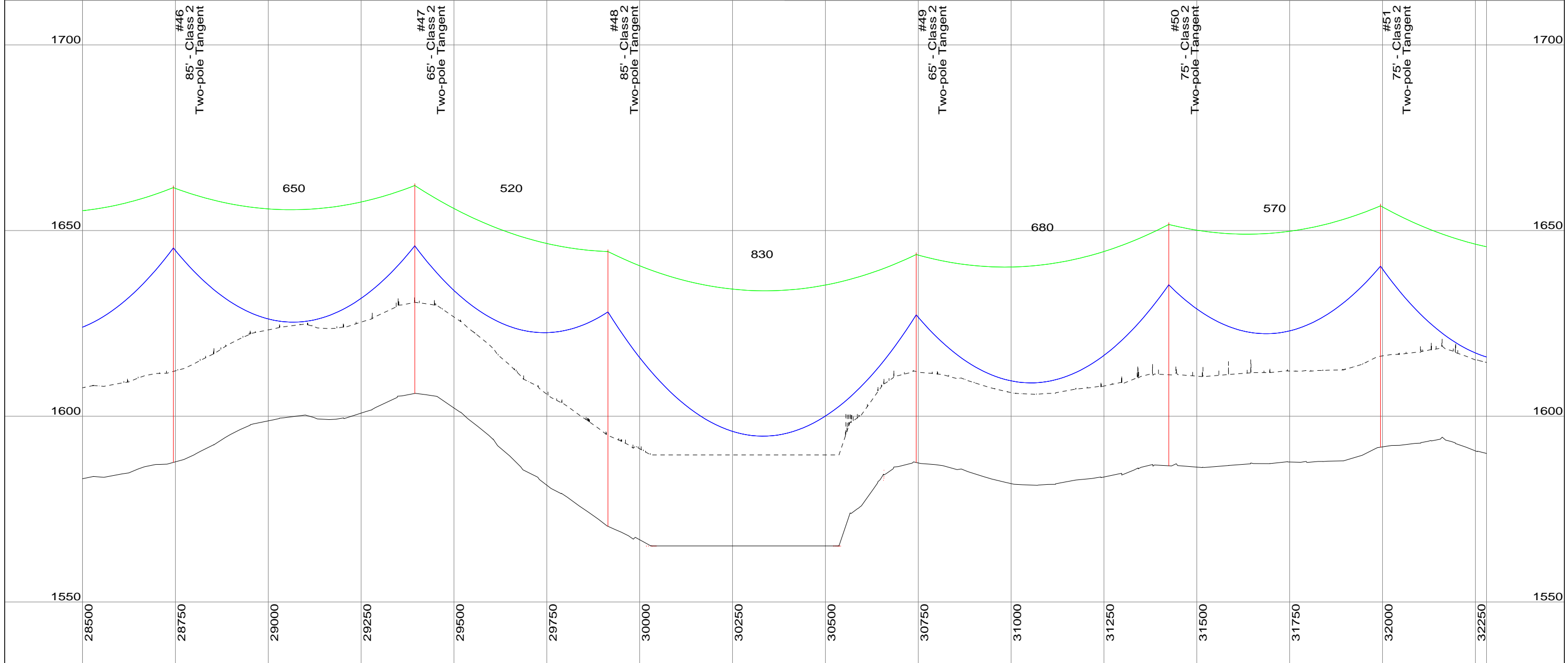

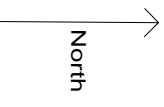
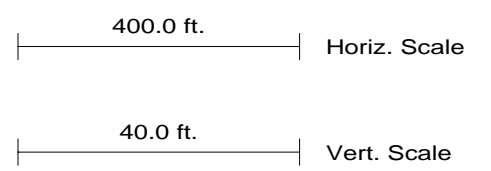
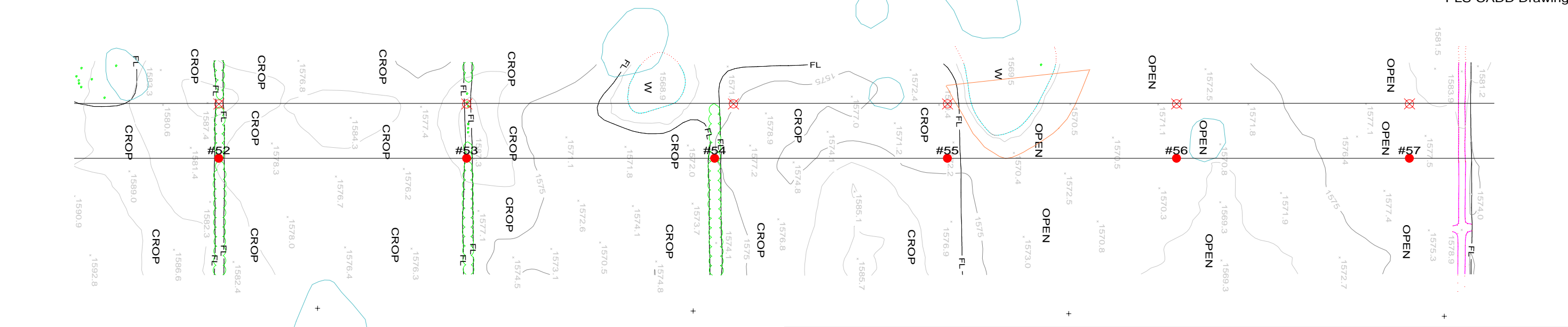

PPM Energy - Rugby 230 kV Wind Farm Line

Engineers: Steve M. Olson & Rick S. Johnson, PE

9/22/2005
Page 10/15

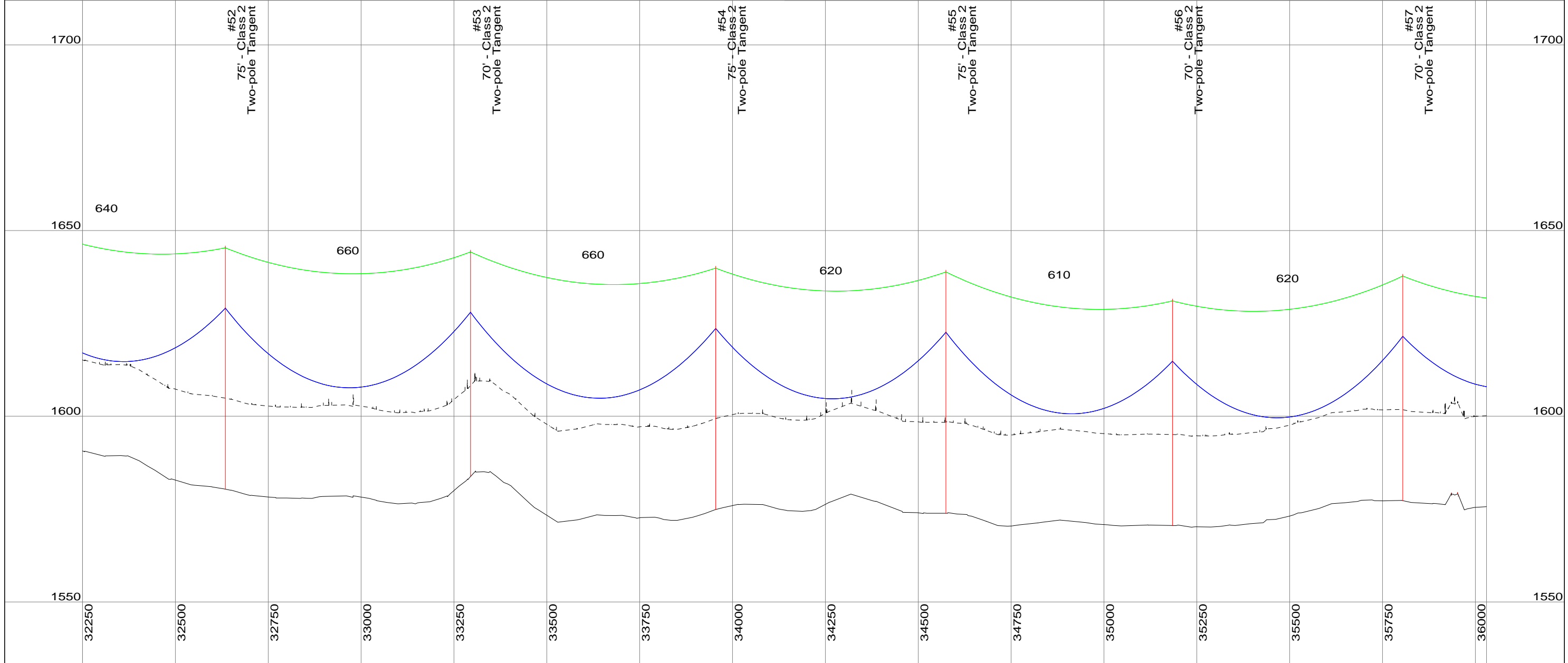

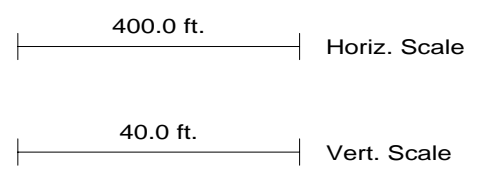
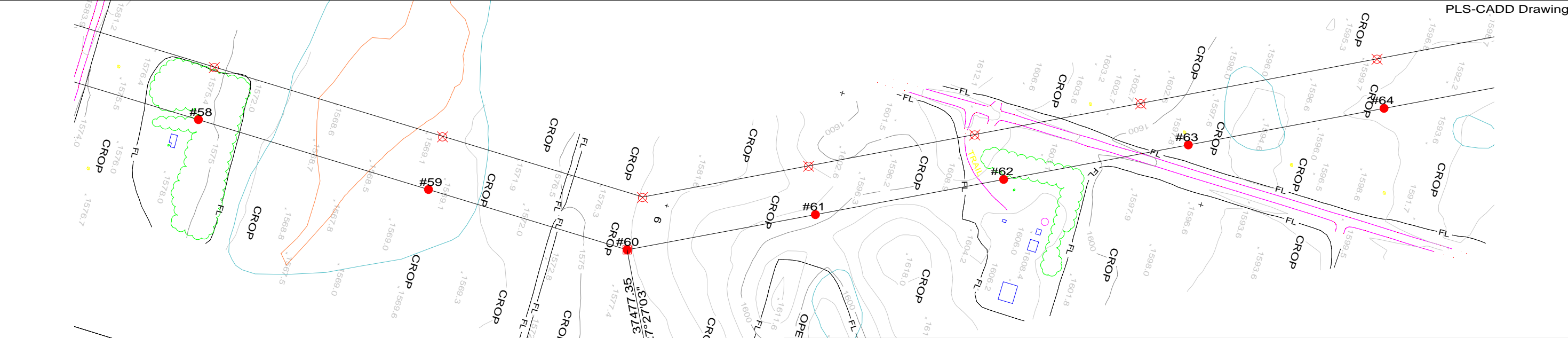

PPM Energy - Rugby 230 kV Wind Farm Line

Engineers: Steve M. Olson & Rick S. Johnson, PE

9/22/2005
Page 11/15

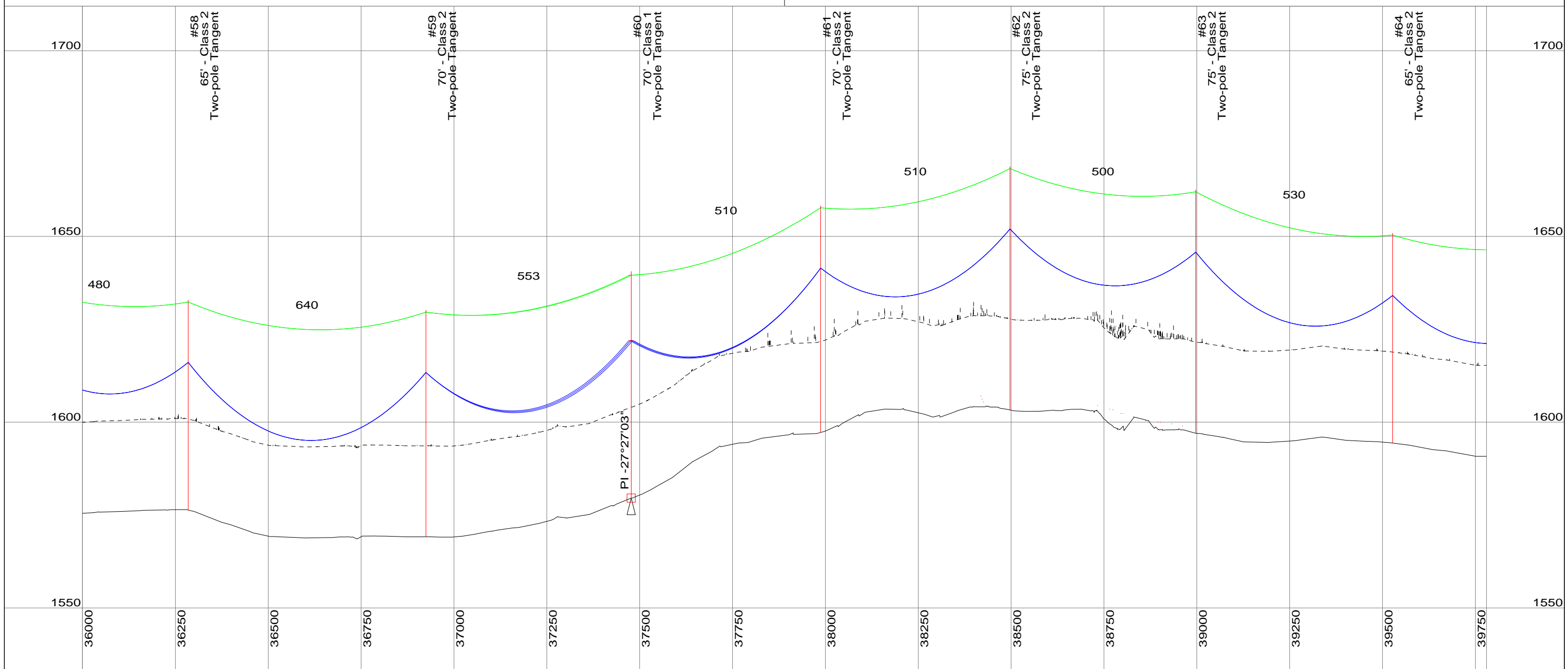

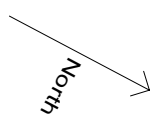
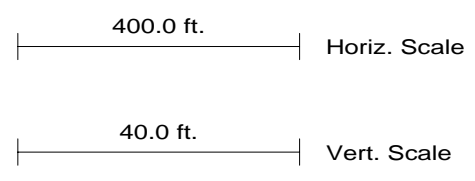
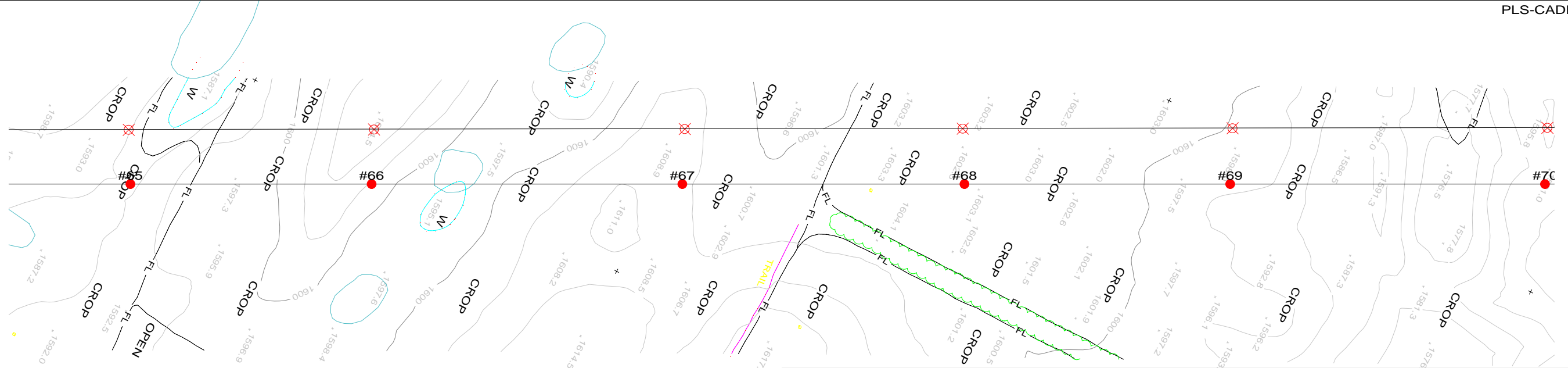

PPM Energy - Rugby 230 kV Wind Farm Line

Engineers: Steve M. Olson & Rick S. Johnson, PE

9/22/2005 Page 12/15

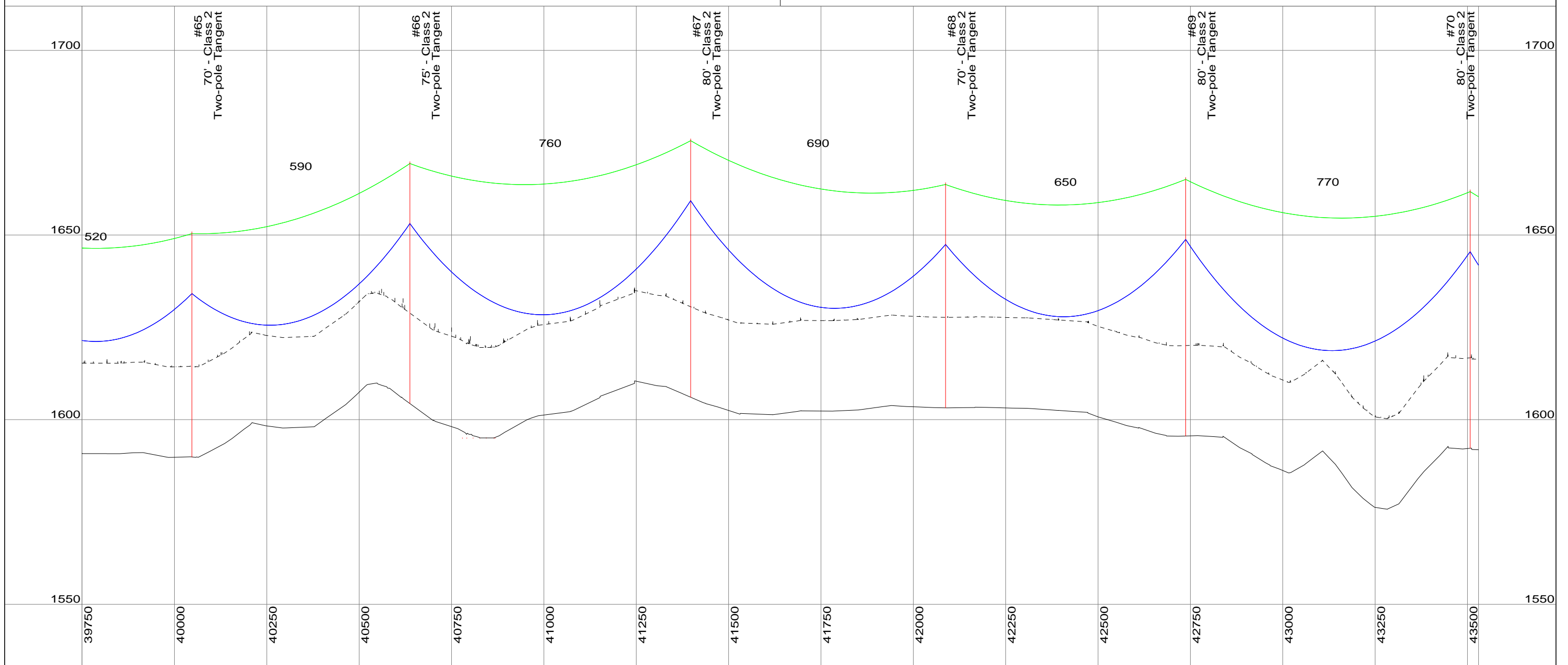

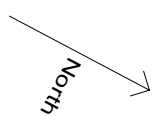
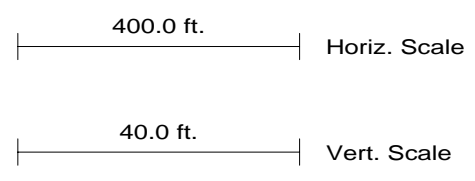

PPM Energy - Rugby 230 kV Wind Farm Line

Engineers: Steve M. Olson & Rick S. Johnson, PE

9/22/2005
Page 13/15

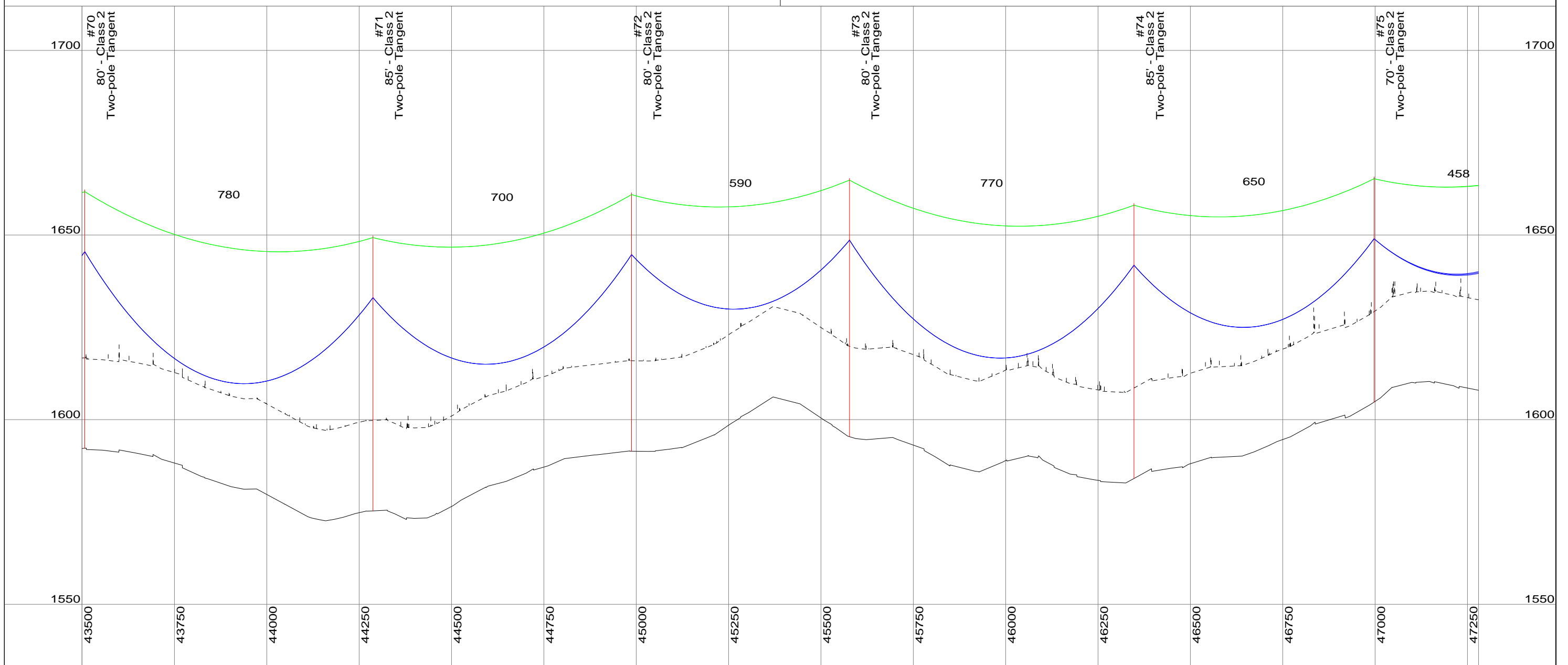

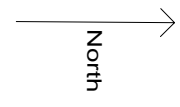
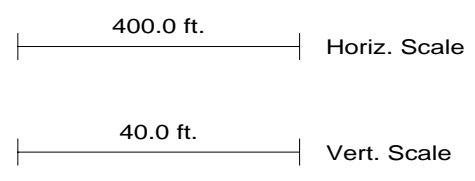
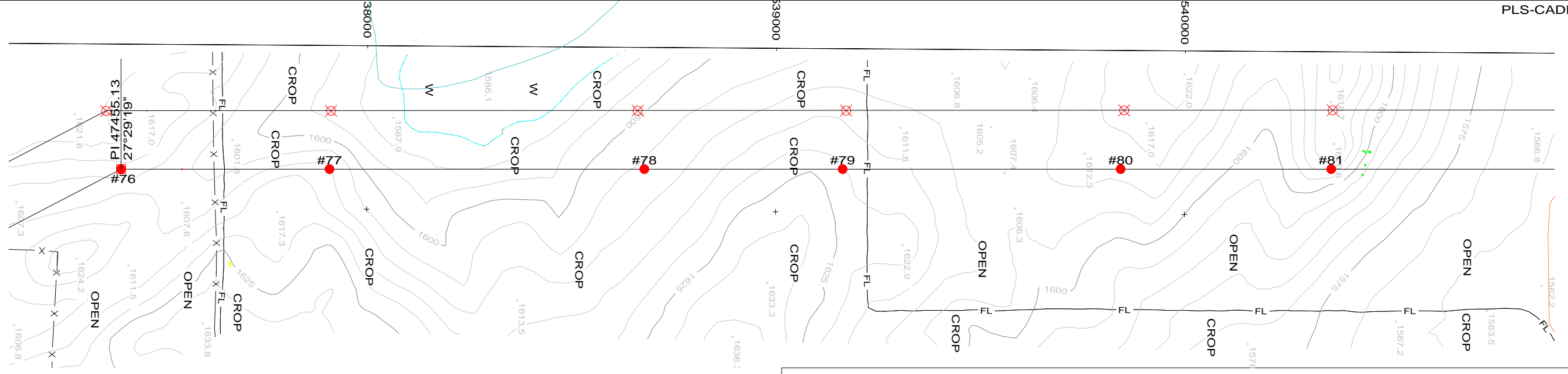

PPM Energy - Rugby 230 kV Wind Farm Line

Engineers: Steve M. Olson & Rick S. Johnson, PE

9/22/2005
Page 14/15

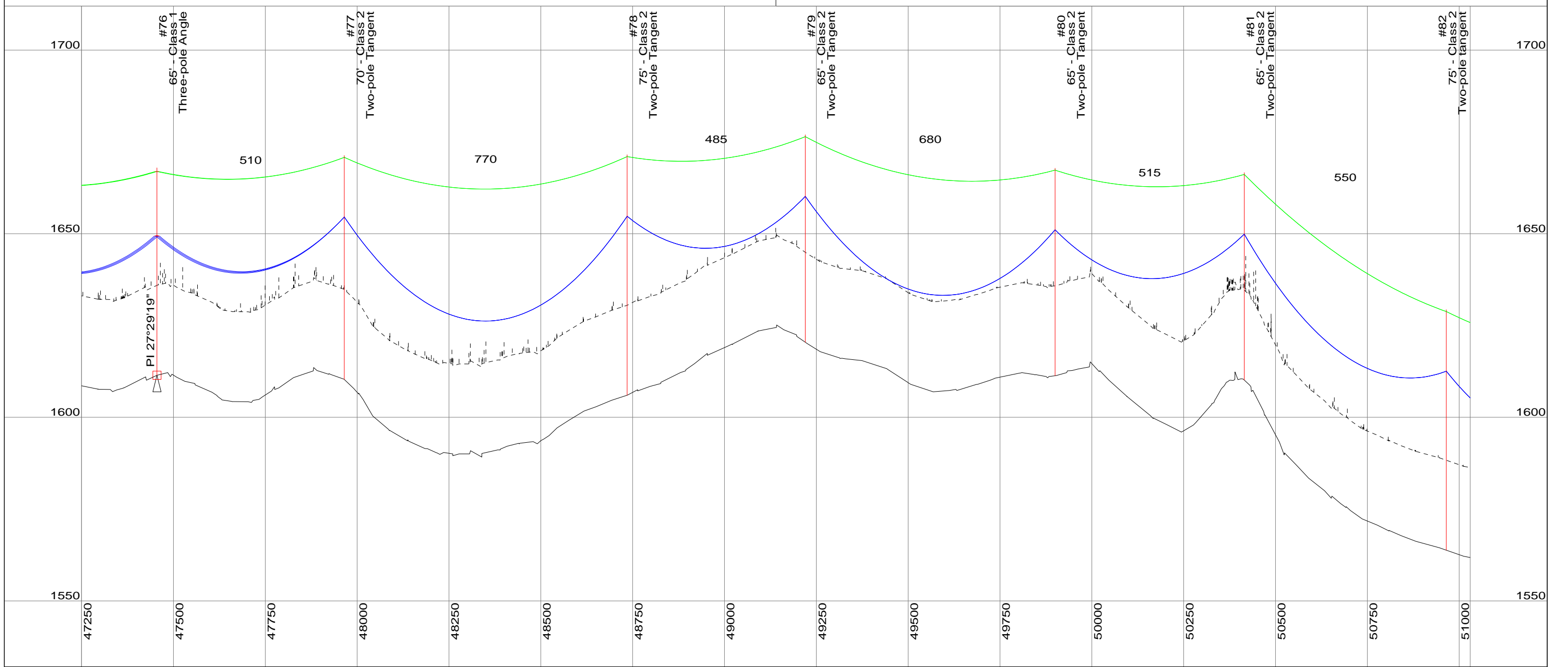

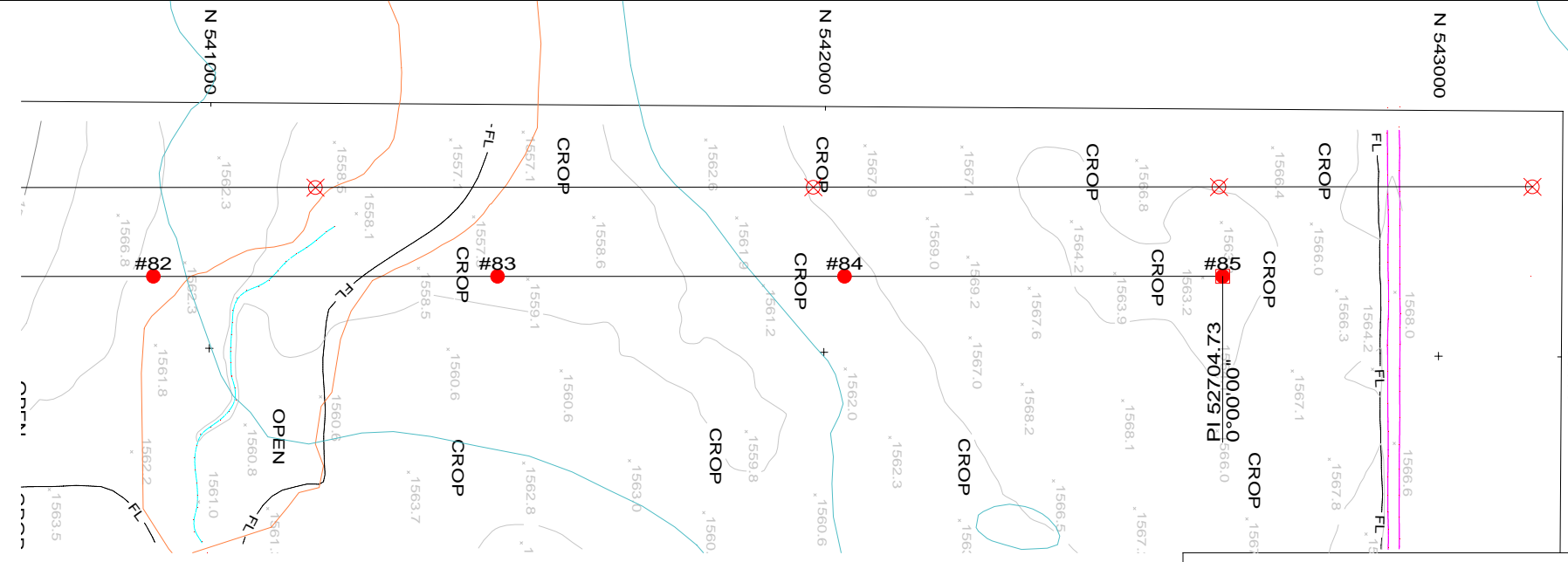

PPM Energy - Rugby 230 kV Wind Farm Line

Engineers: Steve M. Olson & Rick S. Johnson, PE
 9/22/2005
 Page 15/15

