

RIGHT-OF-WAY HORIZONTAL REPRESENTATION (2D)
 TRACT NUMBER
 OWNERSHIP/AGENCY
 LENGTH APPLICABLE DWG. NO.

LAND USE

PIPELINE PROFILE
 HORIZ: 1"=500' VER: 1"=100'
 HORIZONTAL REPRESENTATION (2D)

LEGEND

- KEYSTONE PIPELINE
- STATE BOUNDARY
- COUNTY/TOWNSHIP
- SECTIONS
- NATIONAL OR STATE RESERVATION BOUNDARY
- PROPERTY LINE
- FENCE
- EXCLUSIONARY FENCE
- POWER LINE
- TELEPHONE LINE
- BURIED CABLE
- WATER LINE
- SANITARY SEWER LINE
- SD
- FOREIGN PIPELINE
- RAILROAD
- HIGHWAY/ROAD
- STREAM/DITCH
- WETLAND
- INTERSTATE ROUTE
- U.S. ROUTE
- STATE ROUTE
- POINT OF INTERSECTION (PI)
- PIPELINE MILEPOST
- DIRECTION OF FLOW
- HOUSE
- BUILDING
- WATER WELL
- MAINLINE VALVE
- TRACT NUMBER

PIPELINE SCHEMATIC

- HEAVYWALL PIPE
- WELD FITTING
- TRANSITION PIECE
- CASING PIPE
- CONCRETE COATING
- SET ON WEIGHS
- PIPELINE WARNING SIGN
- PIPELINE MARKER
- MATERIAL ITEM
- GROUNDING MAT
- ZINC RIBBON
- AERIAL MARKER
- CATHODIC TEST STATION
- MAINLINE VALVE
- CHECK VALVE
- OPEN CUT
- BORER
- DRINKING WATER USA
- ECOLOGICAL USA
- HIGHLY POPULATED AREA
- OPERATOR (KEYSTONE) DEFINED
- OTHER POPULATED AREA
- SOURCE WATER PROTECTION AREA
- WELLHEAD PROTECTION AREA

PIPELINE PLAN (SCALE 1" = 500') HORIZONTAL REPRESENTATION (2D)

HORIZONTAL STATIONS (2D)

SLOPE STATIONS (3D)

STATIONS (3D)

TEST SECTIONS (3D)

ENVIRONMENTAL MITIGATION/RECLAMATION STATIONS (2D)

TOPSOIL SALVAGE METHOD

STREAMS

WETLANDS

TIMING CONSTRAINTS

STATIONS

MONITORING

RECLAMATION

SPECIAL CONSIDERATIONS

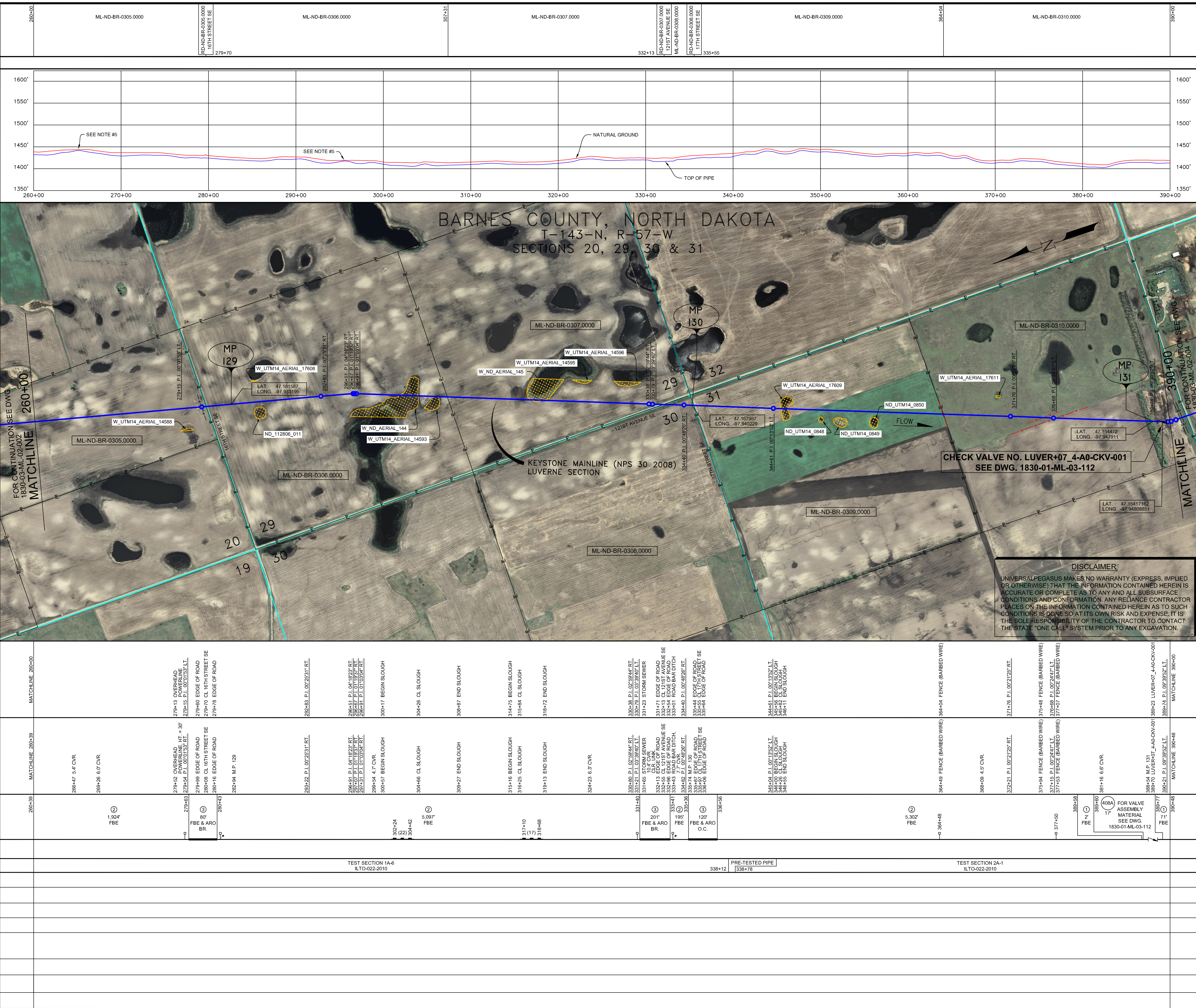

GENERAL NOTES

- ALL CHAINAGES ARE IN FEET UNLESS OTHERWISE SPECIFIED.
- DATUM ELEVATION AND PROJECTION ARE BASED ON MEAN SEA LEVEL AND NAD 83.
- FIELD PIPE LOCATING REQUIRED TO DETERMINE PLACEMENT OF PIPELINE WITHIN PERMANENT EASEMENT.
- UNLESS OTHERWISE NOTED, 48 INCHES MINIMUM COVER EXCEPT 36 INCHES IN AREAS OF CONSOLIDATED ROCK.
- NO ACTUAL AS-BUILT GROUND SHOTS WERE TAKEN AT THIS LOCATION. THE PROFILE REPRESENTS A PROJECTION FROM SHOTS TAKEN AT 150' TO 250' INTERVALS.
- THE TYPE OF COATING APPLIED TO THE FIELD WELDS DURING THE ORIGINAL CONSTRUCTION WAS TWO COMPONENT LIQUID EPOXY. THE COATING PRODUCTS USED WERE DENSO 7200 OR GPC SP-2888.
- THE SUBSTANTIAL CONSTRUCTION COMPLETION DATE, BASED ON CALPER PIG RUN, WAS SEPTEMBER 23, 2009 FOR M.P. 114.00 TO M.P. 130.00, AUGUST 05, 2009 FOR M.P. 129.90 TO M.P. 168.72 AND AUGUST 07, 2009 M.P. 168.73 TO M.P. 165.68.
- ORIGINAL IN-SERVICE DATE OF THE KEYSTONE PIPELINE (PHASE 1): JUNE 30, 2010.
- CPS CALCULATION DATE: MAY 2010.
- ORION STATION SERIES NUMBER: 1162700.
- TO DETERMINE THE MILE POST AT A GIVEN LOCATION, ADD THE 3D STATION NUMBER FROM THIS SEGMENT TO STATION NUMBER 6528+26 AND DIVIDE BY 5280.

OPERATING AND TEST PRESSURE

- THE MAXIMUM OPERATING PRESSURE (MOP) IS 1440 PSIG.
- THE MINIMUM TEST PRESSURE WAS 900 PSIG.

BILL OF MATERIALS (3D)

ITEM NO.	DESCRIPTION	QUANTITY
1	30" O.D. X 0.438" W.T., API-SLX-70 WFBE COATING	73'
2	30" O.D. X 0.386" W.T., API-SLX-70 WFBE COATING	12,518'
3	30" O.D. X 0.518" W.T., API-SLX-70 WFBE COATING & ABRASION RESISTANT OVERCOAT	401'
408A	CHECK VALVE ASSEMBLY LUVER+07_4-A0-CKV-001 (+17)	1 EA
	PIPELINE MARKERS	0 EA
	PIPELINE WARNING SIGNS	6 EA
	CATHODIC TEST STATION	2 EA
	AERIAL MARKER	0 EA

REFERENCE DRAWINGS

REF. NO.	DRAWING NO.	REV. NO.	DRAWING TITLE
408A	1830-01-ML-03-112	3	CHECK VALVE
	1830-01-ML-03-113	0	CHECK VALVE
	1830-01-ML-02-003		LUVER+07_4-A0-CKV-001

REVISIONS

NO.	DATE	REV. BY	CHKD. BY	APPD. BY	DESCRIPTION
1	5/17/09	UEI	RDG	LAG	ISSUED FOR CONSTRUCTION
2	10/17/09	UEI			ISSUED FOR AS-BUILT
					1830-01-ML-02-003
					REPLACES COVERAGE OF IFC DRAWINGS
					1830-03-ML-02-004
					1830-03-ML-02-005

ENGINEERING RECORDS

DRAWN BY	INITIAL	DATE	ENY. APPRD.	INITIAL	DATE
UEI		10/01/18			

PROFESSIONAL ENGINEER

NAME	STATE	LIC#	REV#	DATE
LOYS A. GRAY, III	ND	PE5714		

SCALE: 0 125 250 500 Feet

AS-BUILT ALIGNMENT

M.P. 128.57 TO M.P. 131.04
 SHEET 3 OF 20 SHEETS
 STA. 260+39 TO STA. 390+48 (3D)
 DRAWING NO. 1830-03-ML-02-003 REV. 2

Z:\00_KEYSTONE_AS_BUILT\14-alignment sheets for North Dakota\ND1830-03-003.dwg, 3/9/2011 1:52:10 PM, pdfFactory.p3