

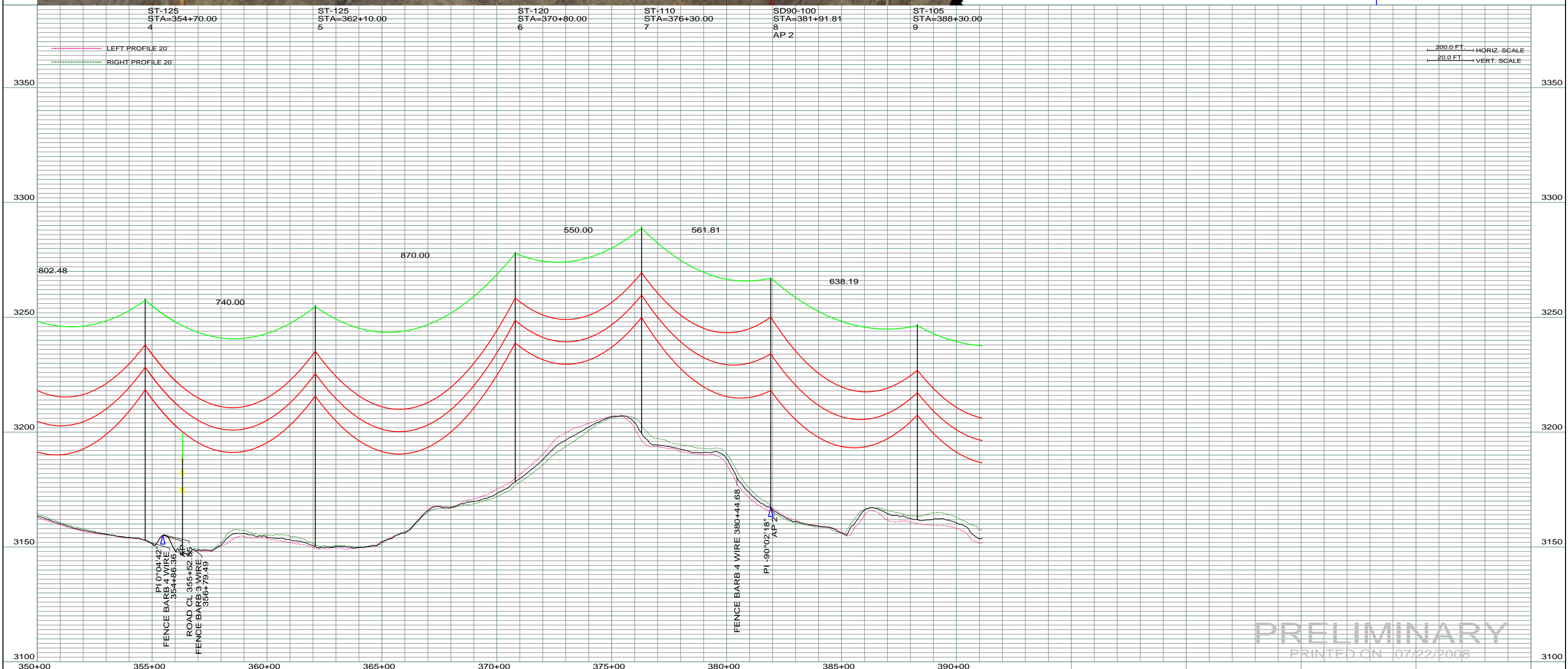

DATE OF AERIAL PHOTOGRAPHY
NOVEMBER 08, 2007
GEODIGITAL INTERNATIONAL



REV	DESCRIPTION	DRWN	DSGN	APPD	DATE	REV	DESCRIPTION	DRWN	DSGN	APPD	DATE
1	-	-	-	-	-	5	-	-	-	-	-
2	-	-	-	-	-	-	-	-	-	-	-
3	-	-	-	-	-	-	-	-	-	-	-
4	-	-	-	-	-	-	-	-	-	-	-

CONDUCTOR	SIZE	STRINGING TENSION	NESEC TENSION	DESIGN RULING SPAN	ACTUAL RULING SPAN
OHGW	1272 MCM ACSR	7/16" E.H.S. STEEL			
OPGW	AC 86/596				

DESIGN INFORMATION		DESIGN BY:	DATE
STATE NAME:	NORTH DAKOTA	DAM/CDB	04/03/08
ZONE:	3302 SOUTH	DRAWN BY:	CDB
		DESIGN CHK:	-
		DRAFT CHK:	-
		APPROVED:	

FACILITY:	
TRANSMISSION SYSTEM MAINTENANCE	
LOCATION UNIT:	
181 - RHAME SUB TO BELFIELD SUB - 230 KV LINE	
RHAME TO BELFIELD TRANSMISSION PROJECT	
PLAN AND PROFILE	
MILE 1 & 2	

SCALE:		COUNTY NAME:	
AS SHOWN		BOWMAN	
BASIN DRAWING NO.		REV.	
181-090-T3-002		0	

PRELIMINARY
PRINTED ON 07/22/2008