



DATE OF AERIAL PHOTOGRAPHY
NOVEMBER 08, 2007
GEODIGITAL INTERNATIONAL

ST-100 STA=445+70.00 17	ST-115 STA=453+80.00 18	SD90-100 STA=461+71.40 19 AP 3	ST-130 STA=468+00.00 20
-------------------------------	-------------------------------	---	-------------------------------

--- LEFT PROFILE 20'
--- RIGHT PROFILE 20'

200.0 FT. --- HORIZ. SCALE
20.0 FT. --- VERT. SCALE

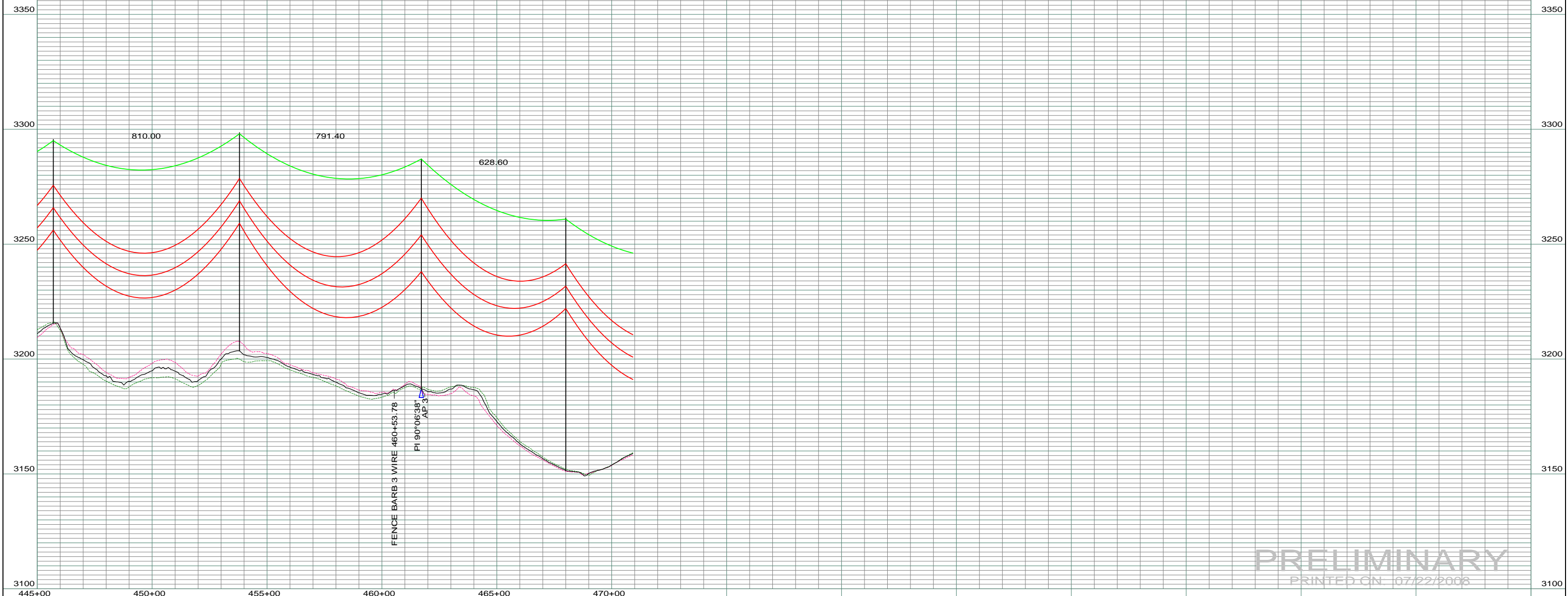

REV	DESCRIPTION	DRWN	DSGN	APPD	DATE	REV	DESCRIPTION	DRWN	DSGN	APPD	DATE
1	-	-	-	-	-	5	-	-	-	-	-
2	-	-	-	-	-	-	-	-	-	-	-
3	-	-	-	-	-	-	-	-	-	-	-
4	-	-	-	-	-	-	-	-	-	-	-

STATE NAME: NORTH DAKOTA		ZONE: 3302 SOUTH	
DESIGN INFORMATION			
CONDUCTOR	SIZE	STRINGING TENSION	NESC TENSION
	1272 MCM ACSR		
	7/16" E.H.S. STEEL		
	AC 86/596		

DESIGN BY: DAM/CDB	04/03/08
DRAWN BY: CDB	07/22/2008
DESIGN CHK: -	-
DRAFT CHK:	
APPROVED:	

FACILITY: TRANSMISSION SYSTEM MAINTENANCE	
LOCATION UNIT: 181 - RHAME SUB TO BELFIELD SUB - 230 KV LINE	
RHAME TO BELFIELD TRANSMISSION PROJECT	
SCALE: AS SHOWN	COUNTY NAME: BOWMAN
BASIN DRAWING NO. 181-090-T3-004	REV. 0