

0320
 LEO HEINRICH LLLP
 KAREN HEINRICH FAMILY TRUST
 GOV'T LOTS 3&4 E1/2SW1/4 SEC. 19-T132N-R101W
 CENTERLINE LENGTH 2686.96'
 162.85 RODS - 7.71 ACRES
 STA 1280+71.57 TO STA 1307+58.08

0340
 ROBERT & DIANE BREWER
 NE1/4 SEC. 19-T132N-R101W
 0.09 ACRES

0310
 STATE OF NORTH DAKOTA
 PART OF W1/2SW1/4 SEC. 19-T132N-R101W
 PART OF E1/2SE1/4 SEC. 24-T132N-R102W
 CENTERLINE LENGTH 200.00' - 12.12 RODS -0.57 ACRES
 STA 1276+71.57 TO STA 1280+71.57

0330
 LOGAN & DIANA SILHA
 SE1/4 SEC. 19-T132N-R101W
 CENTERLINE LENGTH 959.64'
 179.37 RODS - 8.49 ACRES
 STA 1307+58.08 TO STA 1337+17.21

DATE OF AERIAL PHOTOGRAPH
 NOVEMBER 08, 2007
 GEODIGITAL INTERNATIONAL

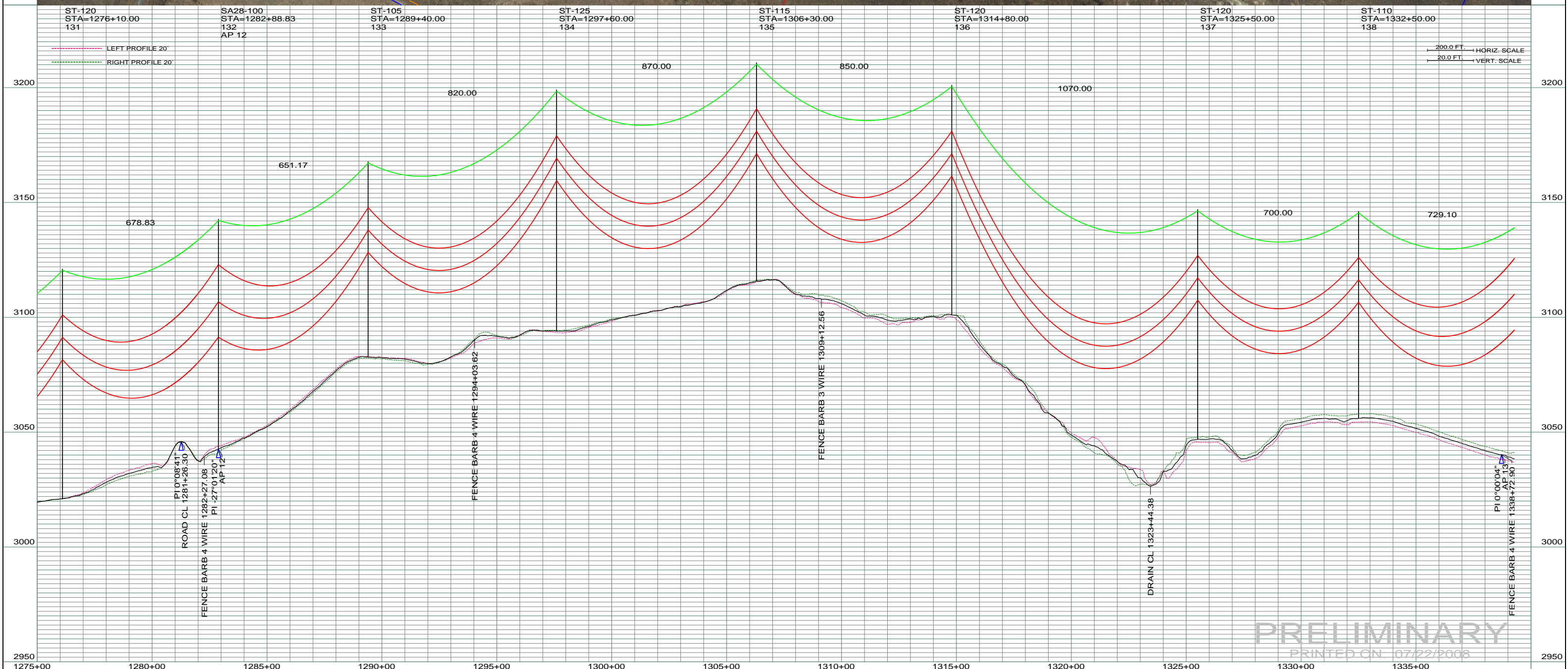

REV	DESCRIPTION	DRWN	DSGN	APPD	DATE	REV	DESCRIPTION	DRWN	DSGN	APPD	DATE
1		-	-	-	-	5					
2		-	-	-	-						
3		-	-	-	-						
4		-	-	-	-						

STATE NAME:	ZONE:	DESIGN BY:	DATE:	FACILITY:
NORTH DAKOTA	3302 SOUTH	DAM/CDB	04/03/08	TRANSMISSION SYSTEM MAINTENANCE
DESIGN INFORMATION		DRAWN BY:	DATE:	LOCATION UNIT:
CONDUCTOR	SIZE	STRINGING TENSION	NESEC TENSION	181 - RHAME SUB TO BELFIELD SUB - 230 KV LINE
	1272 MCM ACSR			
	OHGW	DESIGN RULING SPAN	ACTUAL RULING SPAN	
	7/16" E.H.S. STEEL			
	OPGW			
	AC 86/596			

DESIGN BY:	DATE:	FACILITY:	LOCATION UNIT:
DAM/CDB	04/03/08	TRANSMISSION SYSTEM MAINTENANCE	181 - RHAME SUB TO BELFIELD SUB - 230 KV LINE
DRAWN BY:	DATE:	RHHAME TO BELFIELD TRANSMISSION PROJECT	
CDB	07/22/2008		
DESIGN CHK:		PLAN AND PROFILE	
DRAFT CHK:			
APPROVED:			

PRELIMINARY
 PRINTED ON: 07/22/2008

SCALE: AS SHOWN	COUNTY NAME: BOWMAN
BASIN DRAWING NO. 181-90-T3-021	REV. 0

BASIN ELECTRIC POWER COOPERATIVE
 1717 EAST INTERSTATE AVENUE
 BISMARCK, NORTH DAKOTA
 PHONE 701-223-0441