

DATE OF AERIAL PHOTOGRAPHY
NOVEMBER 08, 2007
GEODIGITAL INTERNATIONAL

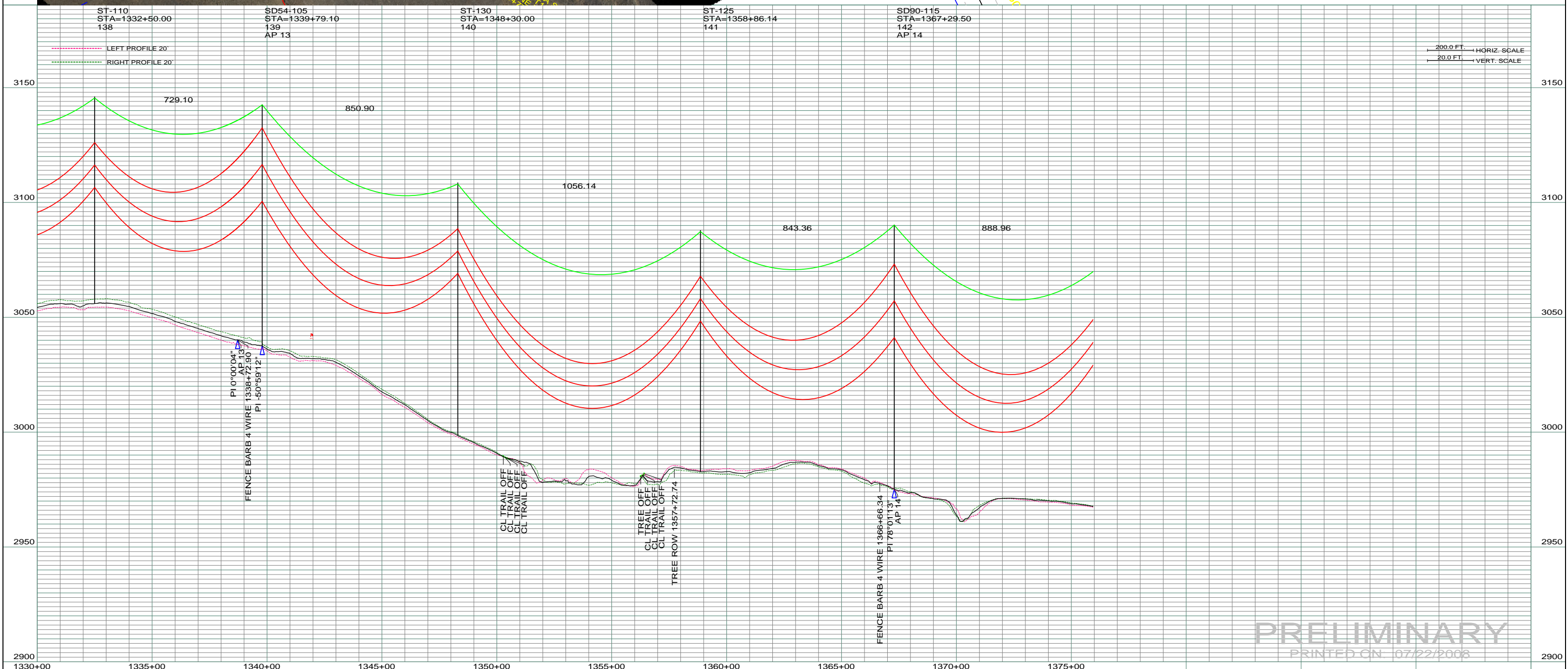

REV	DESCRIPTION	DRWN	DSGN	APPD	DATE	REV	DESCRIPTION	DRWN	DSGN	APPD	DATE
1	-	-	-	-	-	5					
2	-	-	-	-	-						
3	-	-	-	-	-						
4	-	-	-	-	-						

STATE NAME:	ZONE:
NORTH DAKOTA	3302 SOUTH

DESIGN INFORMATION				
CONDUCTOR	SIZE	STRINGING TENSION	NESC TENSION	DESIGN RULING SPAN
	1272 MCM ACSR			
	7/16" E.H.S. STEEL			
	AC 86/596			

DESIGN BY:	DAM/CDB	04/03/08
DRAWN BY:	CDB	07/22/2008
DESIGN CHK:	-	-
DRAFT CHK:	-	-
APPROVED:		

FACILITY:	TRANSMISSION SYSTEM MAINTENANCE
LOCATION UNIT:	181 - RHAME SUB TO BELFIELD SUB - 230 KV LINE
RHAME TO BELFIELD TRANSMISSION PROJECT	
PLAN AND PROFILE	

BASIN ELECTRIC POWER COOPERATIVE 1717 EAST INTERSTATE AVENUE BISMARCK, NORTH DAKOTA PHONE 701-223-0441	SCALE:	COUNTY NAME:
	AS SHOWN	BOWMAN
BASIN DRAWING NO.	REV.	
181-90-T3-022	0	