

ST-115 STA=1535+08.46 164	SA40-085 STA=1540+62.95 165 AP 17	ST-110 STA=1546+48.46 166	ST-110 STA=1553+38.46 167	ST-120 STA=1560+88.46 168	ST-115 STA=1569+68.46 169	ST-100 STA=1576+08.46 170	ST-115 STA=1583+78.46 171	ST-125 STA=1591+28.46 172
---------------------------------	--	---------------------------------	---------------------------------	---------------------------------	---------------------------------	---------------------------------	---------------------------------	---------------------------------

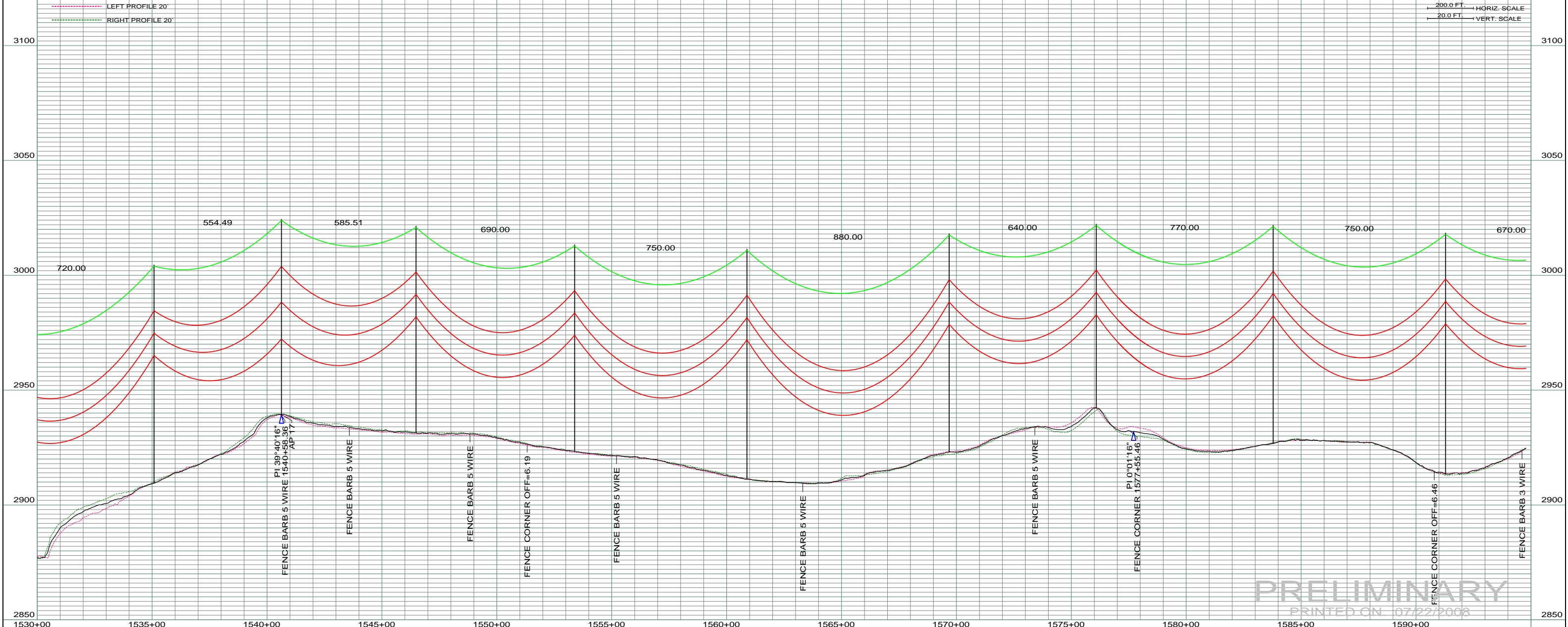

**PRELIMINARY**  
PRINTED ON 07/22/2008

REV	DESCRIPTION	DRWN	DSGN	APPD	DATE	REV	DESCRIPTION	DRWN	DSGN	APPD	DATE
1	-	-	-	-	-	5	-	-	-	-	-
2	-	-	-	-	-	-	-	-	-	-	-
3	-	-	-	-	-	-	-	-	-	-	-
4	-	-	-	-	-	-	-	-	-	-	-

STATE NAME: NORTH DAKOTA		ZONE: 3302 SOUTH	
DESIGN INFORMATION			
CONDUCTOR	1272 MCM ACSR	STRINGING TENSION	NESC TENSION
OHGW	7/16" E.H.S. STEEL	DESIGN RULING SPAN	ACTUAL RULING SPAN
OPGW	AC 86/596		

DESIGN BY:	DAM/CDB	04/03/08
DRAWN BY:	CDB	07/22/2008
DESIGN CHK:	-	-
DRAFT CHK:	-	-
APPROVED:	-	-

FACILITY: TRANSMISSION SYSTEM MAINTENANCE		<b>BASIN ELECTRIC POWER COOPERATIVE</b> 1717 EAST INTERSTATE AVENUE BISMARCK, NORTH DAKOTA PHONE 701-223-0441
LOCATION UNIT: 181 - RHAME SUB TO BELFIELD SUB - 230 KV LINE		
RHHAME TO BELFIELD TRANSMISSION PROJECT		SCALE: AS SHOWN
PLAN AND PROFILE		COUNTY NAME: BOWMAN
BASIN DRAWING NO. 181-90-T3-026		REV. 0