

0520
 WAYNE NARUM
 E 1/2 SEC. 21-T133N-R100W
 CENTERLINE LENGTH 5272.37'
 319.54 RODS-15.13 ACRES
 STA 1788+11.89 TO STA 1840+83.36



DATE OF AERIAL PHOTOGRAPH
 NOVEMBER 08, 2007
 GEODIGITAL INTERNATIONAL

SA28-115 STA=1795+63.16 199	ST-120 STA=1803+33.02 200	ST-115 STA=1811+07.55 201	ST-115 STA=1819+45.12 202	ST-115 STA=1827+49.06 203	ST-115 STA=1834+70.60 204	ST-115 STA=1843+94.53 205	ST-095 STA=1850+52.01 206
-----------------------------------	---------------------------------	---------------------------------	---------------------------------	---------------------------------	---------------------------------	---------------------------------	---------------------------------

--- LEFT PROFILE 20'
 --- RIGHT PROFILE 20'

200.0 FT. --- HORIZ. SCALE
 20.0 FT. --- VERT. SCALE

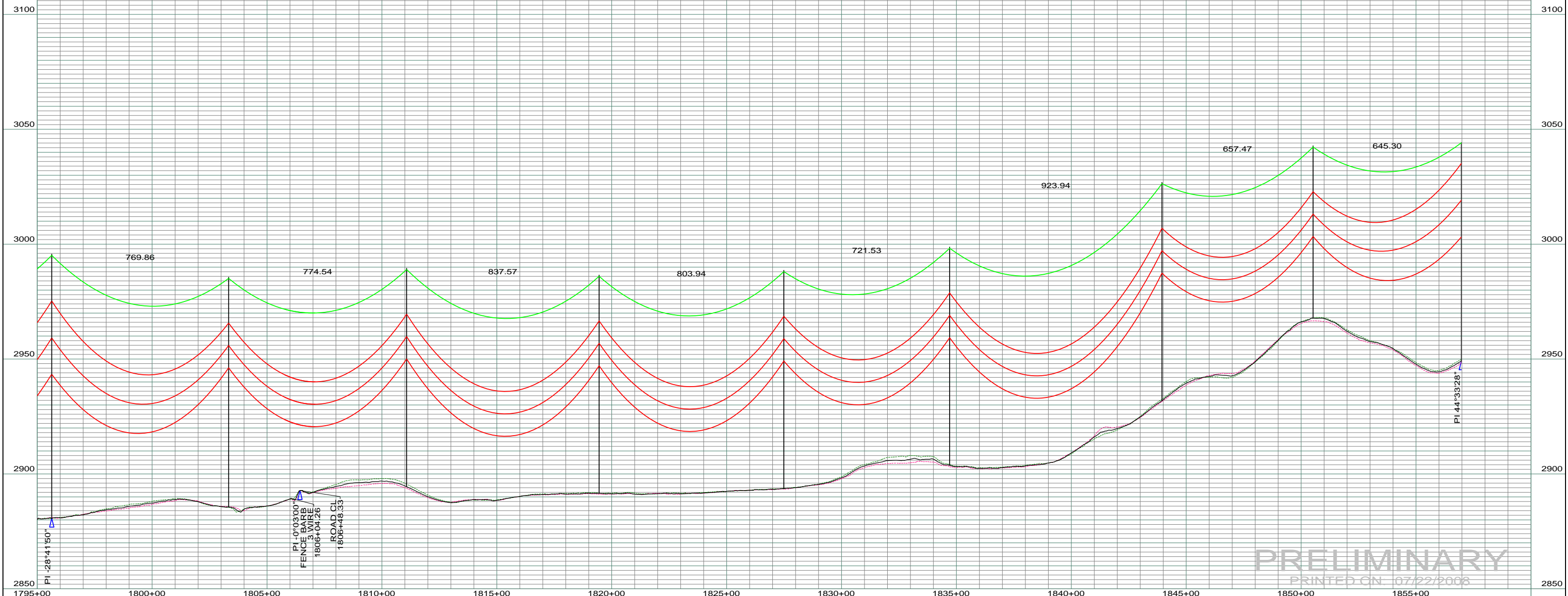

PRELIMINARY
 PRINTED ON 07/22/2008

REV	DESCRIPTION	DRWN	DSGN	APPD	DATE	REV	DESCRIPTION	DRWN	DSGN	APPD	DATE
1		-	-	-	-	5					
2		-	-	-	-						
3		-	-	-	-						
4		-	-	-	-						

STATE NAME: NORTH DAKOTA		ZONE: 3302 SOUTH		DESIGN BY: DAM/CDB	04/03/08	FACILITY: TRANSMISSION SYSTEM MAINTENANCE	
DESIGN INFORMATION				DRAWN BY: CDB	07/22/2008	LOCATION UNIT: 181 - RHAME SUB TO BELFIELD SUB - 230 KV LINE	
CONDUCTOR	SIZE	STRINGING TENSION	NESC TENSION	DESIGN RULING SPAN	ACTUAL RULING SPAN	RHAME TO BELFIELD TRANSMISSION PROJECT	
	1272 MCM ACSR					SCALE: AS SHOWN	
OHGW	7/16" E.H.S. STEEL					COUNTY NAME: SLOPE	
OPGW	AC 86/596					BASIN DRAWING NO. 181-90-T3-032	
APPROVED:						REV. 0	