



DATE OF AERIAL PHOTOGRAPHY
NOVEMBER 08, 2007
GEODIGITAL INTERNATIONAL

ST-110 STA=1907+76.50 213	ST-115 STA=1914+53.23 214	ST-120 STA=1923+57.65 215	SD48-100 STA=1932+36.99 216 AP 22	ST-115 STA=1940+18.86 217
---------------------------------	---------------------------------	---------------------------------	--	---------------------------------

LEFT PROFILE 20'
RIGHT PROFILE 20'

200.0 FT. HORIZ. SCALE
20.0 FT. VERT. SCALE

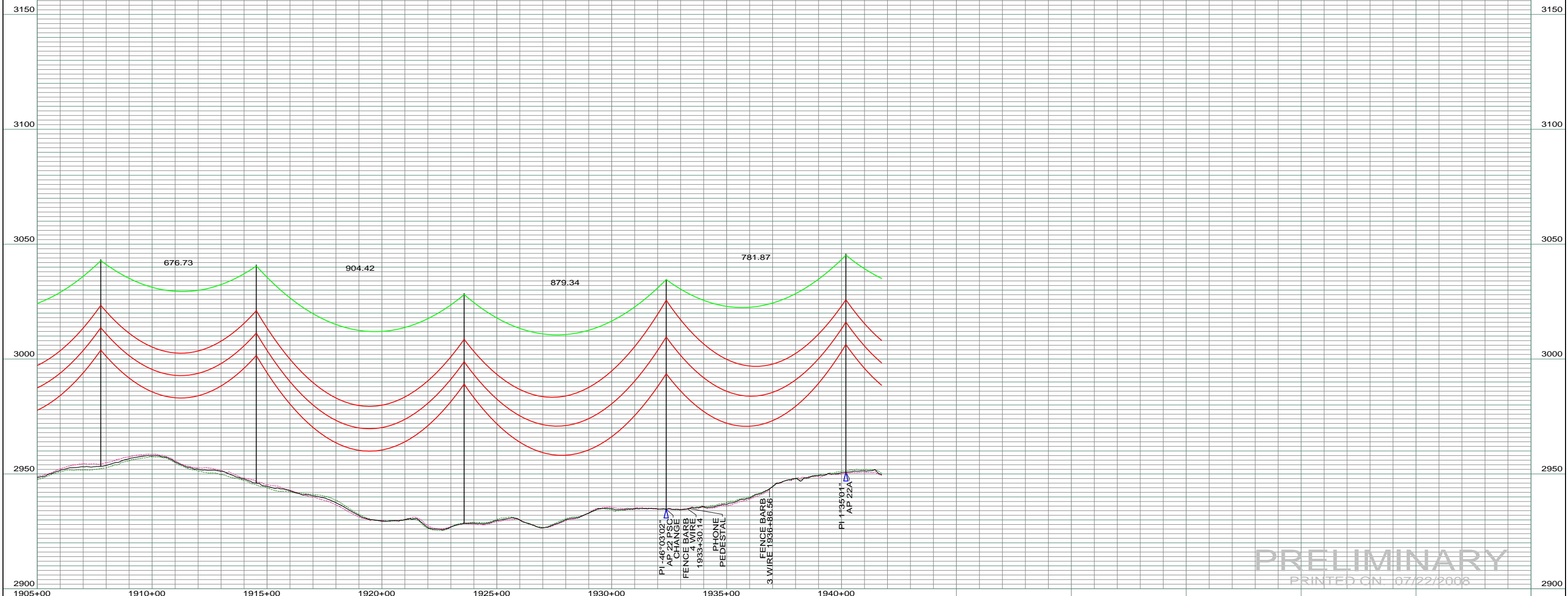

PRELIMINARY
PRINTED ON 07/22/2008

REV	DESCRIPTION	DRWN	DSGN	APPD	DATE	REV	DESCRIPTION	DRWN	DSGN	APPD	DATE	STATE NAME: NORTH DAKOTA	ZONE: 3302 SOUTH	DESIGN BY: DAM/CDB	04/03/08	FACILITY: TRANSMISSION SYSTEM MAINTENANCE	BASIN ELECTRIC POWER COOPERATIVE 1717 EAST INTERSTATE AVENUE BISMARCK, NORTH DAKOTA PHONE 701-223-0441	SCALE: AS SHOWN	COUNTY NAME: SLOPE		
1	-	-	-	-	-	5						DESIGN INFORMATION		DRAWN BY: CDB	07/22/2008	LOCATION UNIT: 181 - RHAME SUB TO BELFIELD SUB - 230 KV LINE					
2	-	-	-	-	-							CONDUCTOR	1272 MCM ACSR	STRINGING TENSION	NESC TENSION	DESIGN RULING SPAN		ACTUAL RULING SPAN	DESIGN CHK: -		
3	-	-	-	-	-							OHGW	7/16" E.H.S. STEEL						DRAFT CHK:		
4	-	-	-	-	-							OPGW	AC 86/596					APPROVED:			
																	RHAME TO BELFIELD TRANSMISSION PROJECT		BASIN DRAWING NO. 181-90-T3-034		REV. 0