

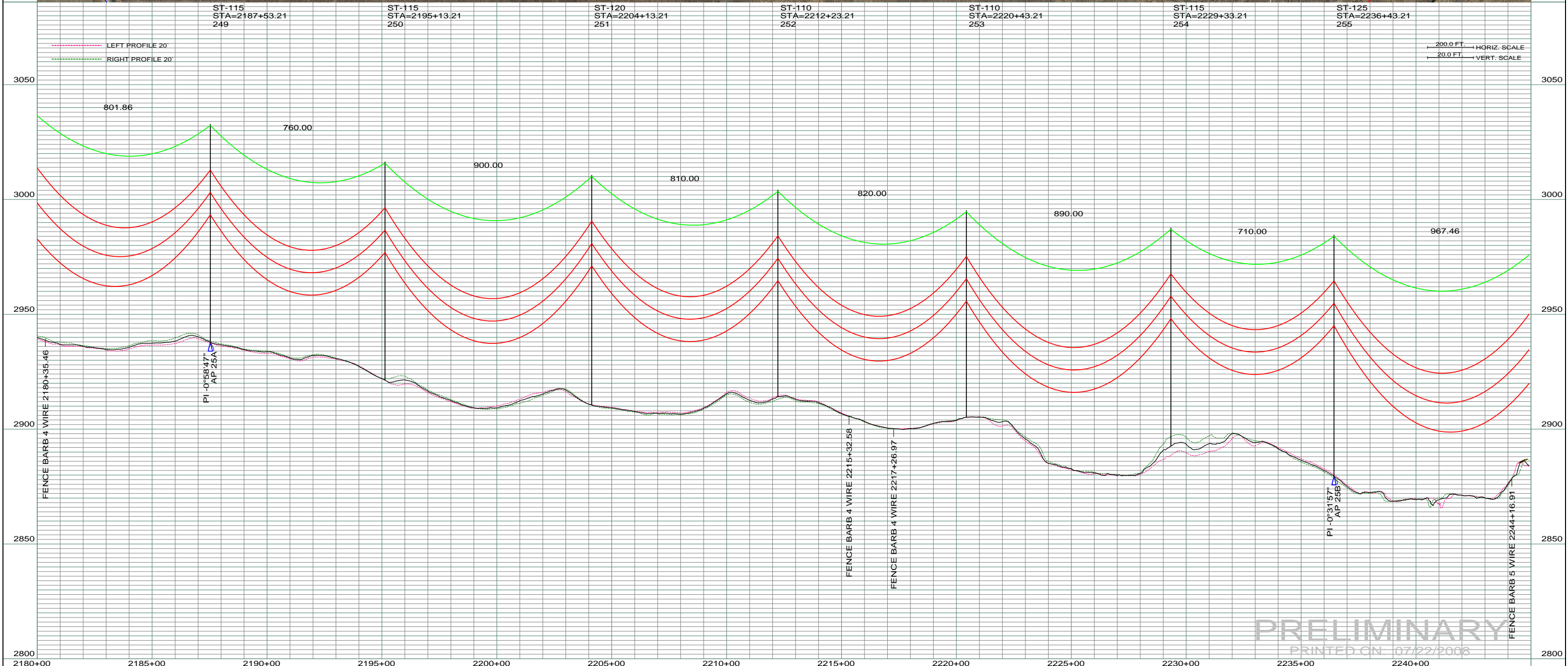

DATE OF AERIAL PHOTOGRAPH: NOVEMBER 08, 2007
 GEOSPATIAL INTERNATIONAL



PRELIMINARY
 PRINTED ON: 07/22/2008

REV	DESCRIPTION	DRWN	DSGN	APPD	DATE	REV	DESCRIPTION	DRWN	DSGN	APPD	DATE
1		-	-	-	-	5					
2		-	-	-	-						
3		-	-	-	-						
4		-	-	-	-						

STATE NAME:	ZONE:
NORTH DAKOTA	3302 SOUTH

DESIGN INFORMATION				
CONDUCTOR	SIZE	STRINGING TENSION	NESC TENSION	DESIGN RULING SPAN
	1272 MCM ACSR			
	7/16" E.H.S. STEEL			
	AC 86/596			

DESIGN BY:	DAM/CDB	04/03/08
DRAWN BY:	CDB	07/22/2008
DESIGN CHK:	-	-
DRAFT CHK:	-	-
APPROVED:		

FACILITY:	TRANSMISSION SYSTEM MAINTENANCE
LOCATION UNIT:	181 - RHAME SUB TO BELFIELD SUB - 230 KV LINE
RHAME TO BELFIELD TRANSMISSION PROJECT	
PLAN AND PROFILE	

BASIN ELECTRIC POWER COOPERATIVE 1717 EAST INTERSTATE AVENUE BISMARK, NORTH DAKOTA PHONE 701-223-0441	
SCALE:	COUNTY NAME:
AS SHOWN	SLOPE
BASIN DRAWING NO.	REV.
181-90-T3-040	0