

**0680**  
 JEFFREY & SUSANN POWELL  
 WALTER & LUELLA M. JACOBS  
 SE 1/4 SEC. 1-T134N-R100W  
 CENTERLINE LENGTH 191.00'-11.58 RODS-0.55 ACRES  
 STA 2334+42.16 TO STA 2336+33.12

**0690**  
 JOHN F. WALROD  
 S 1/2 SEC. 6-T134N-R99W  
 CENTERLINE LENGTH 4745.34'-287.60 RODS-13.62 ACRES  
 STA 2336+33.12 TO STA 2383+77.66

DATE OF AERIAL PHOTOGRAPHY  
 NOVEMBER 08, 2007  
 GEODIGITAL INTERNATIONAL

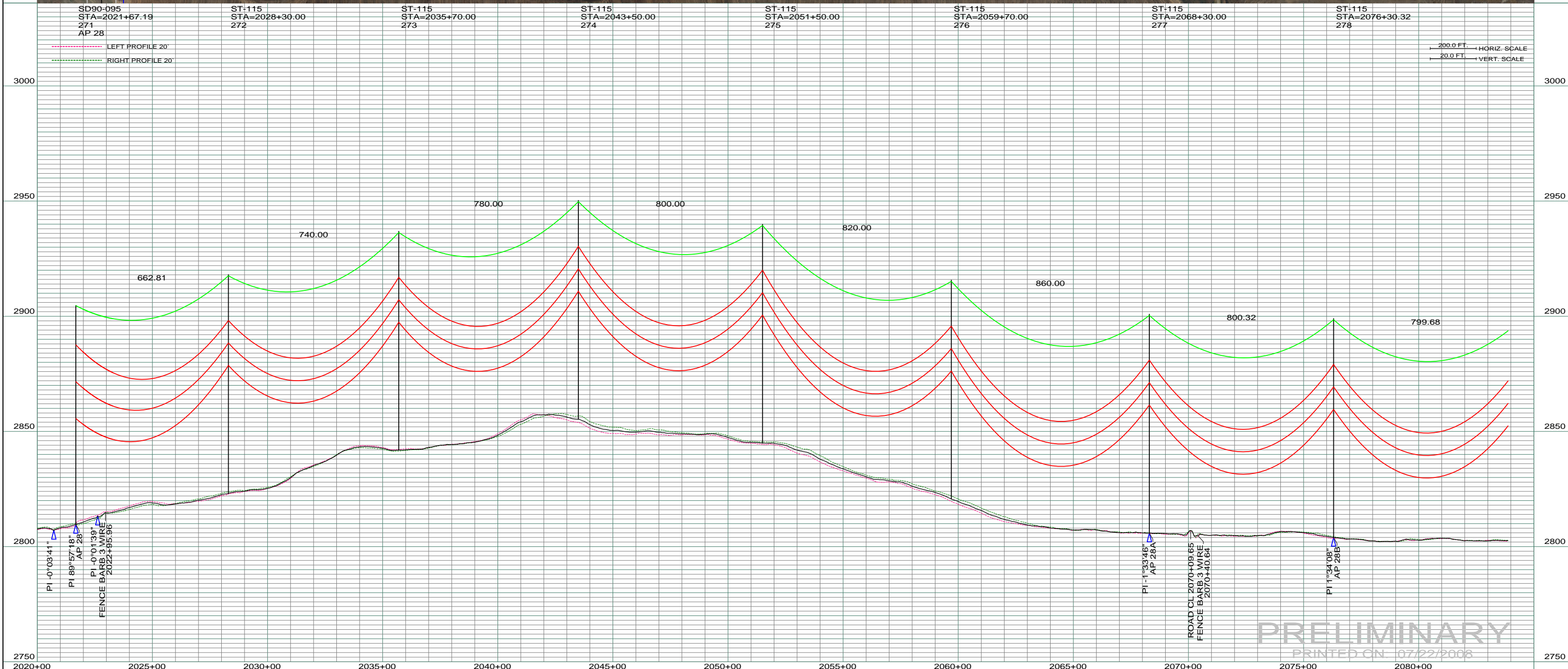

REV	DESCRIPTION	DRWN	DSGN	APPD	DATE	REV	DESCRIPTION	DRWN	DSGN	APPD	DATE
1		-	-	-	-	5					
2		-	-	-	-						
3		-	-	-	-						
4		-	-	-	-						

STATE NAME: NORTH DAKOTA		ZONE: 3302 SOUTH		DESIGN BY: DAM	07/22/2008	FACILITY: TRANSMISSION SYSTEM MAINTENANCE
DESIGN INFORMATION				DRAWN BY: CDB	07/22/2008	LOCATION UNIT: 181 - RHAME SUB TO BELFIELD SUB - 230 KV LINE
CONDUCTOR	SIZE	STRINGING TENSION	NESC TENSION	DESIGN RULING SPAN	ACTUAL RULING SPAN	RHAME TO BELFIELD TRANSMISSION PROJECT PLAN AND PROFILE MILE 1 & FROM RHAME SUBSTATION
	1272 MCM ACSR	-	-	-	-	
OHGW	7/16" E.H.S. STEEL	-	-	-	-	
OPGW	AC 86/596	-	-	-	-	SCALE: AS SHOWN
APPROVED:				DESIGN CHK: -		COUNTY NAME: BOWMAN
				DRAFT CHK: -		BASIN DRAWING NO. 181-090-T3-043
				APPROVED:		REV. 0

**PRELIMINARY**  
 PRINTED ON 07/22/2008

**BASIN ELECTRIC POWER COOPERATIVE**  
 1717 EAST INTERSTATE AVENUE  
 BISMARCK, NORTH DAKOTA  
 PHONE 701-223-0441