

0740
 ALEX STOCKERT RANCH TRUST
 Q172 SEC. 3-T134N-R99W
 CENTERLINE LENGTH 4372.48'-
 265.00 RODS-12.53 ACRES
 STA 2515+69.19 TO STA 2559+40.94

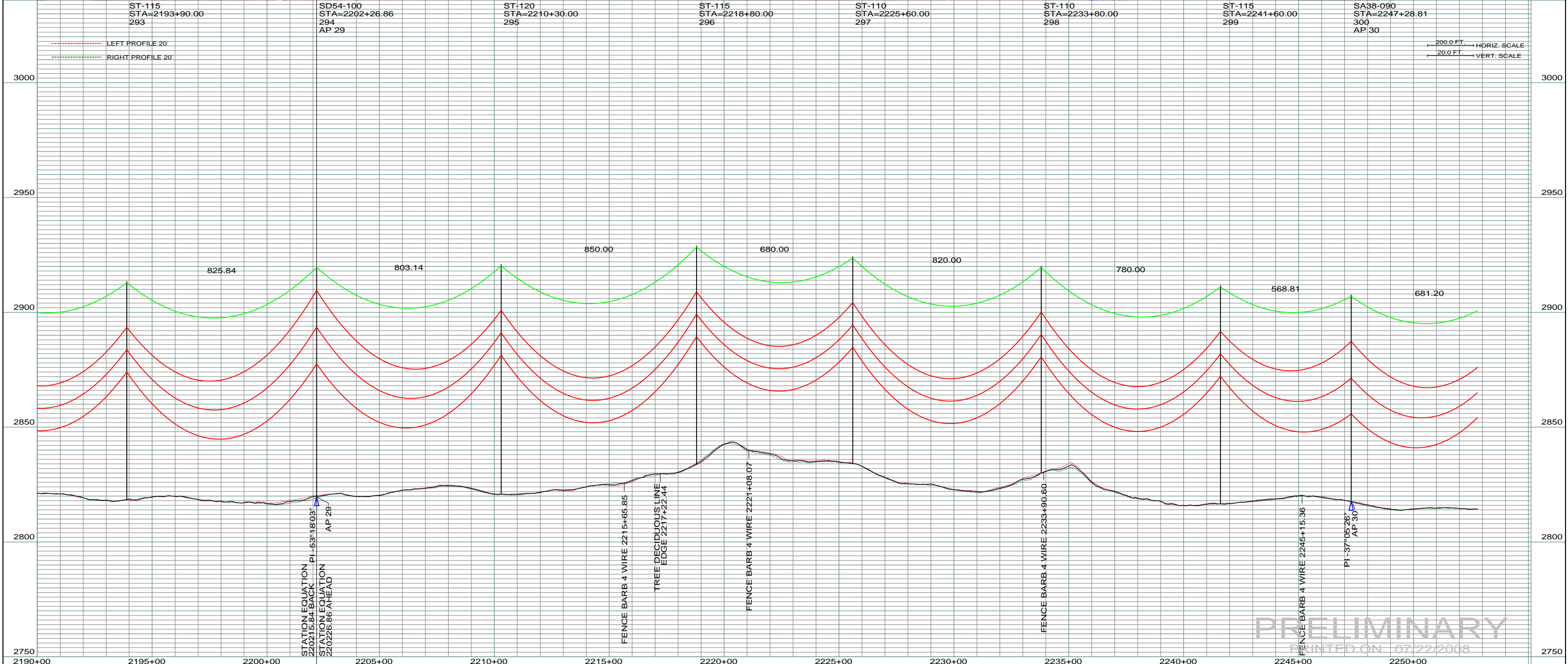

DATE OF AERIAL PHOTOGRAPHY
 NOVEMBER 08, 2007
 GEODIGITAL INTERNATIONAL



| REV | DESCRIPTION | DRWN | DSGN | APPD | DATE | REV | DESCRIPTION | DRWN | DSGN | APPD | DATE |
|-----|-------------|------|------|------|------|-----|-------------|------|------|------|------|
| 1 | - | - | - | - | - | 5 | - | - | - | - | - |
| 2 | - | - | - | - | - | - | - | - | - | - | - |
| 3 | - | - | - | - | - | - | - | - | - | - | - |
| 4 | - | - | - | - | - | - | - | - | - | - | - |

| | | | |
|--------------------------|--------------------|---|------------|
| STATE NAME: NORTH DAKOTA | ZONE: 3302 SOUTH | DESIGN BY: DAM | 07/22/2008 |
| DESIGN INFORMATION | | FACILITY: TRANSMISSION SYSTEM MAINTENANCE | |
| CONDUCTOR | 1272 MCM ACSR | DRAWN BY: CDB | 07/22/2008 |
| OHGW | 7/16" E.H.S. STEEL | DESIGN CHK: - | - |
| OPGW | AC 86/596 | DRAFT CHK: - | - |
| APPROVED: | | RHHAME TO BELFIELD TRANSMISSION PROJECT | |
| | | SCALE: AS SHOWN | |
| | | COUNTY NAME: BOWMAN | |
| | | BASIN DRAWING NO. 181-090-T3-046 | |
| | | REV. 0 | |