

0810  
JOHN R. LANGOWSKI, ETAL  
S1/2SW1/4 SEC. 14-T135N-R99W  
CENTERLINE LENGTH 1319.58'-79.97 RODS-3.79 ACRES  
STA 2735+35.59 TO STA 2748+54.95

0820  
WADE BOCK  
N1/2SW1/4, W1/2NW1/4 SEC. 14-T135N-R99W  
CENTERLINE LENGTH 3958.96'-239.94 RODS-11.36 ACRES  
STA 2748+54.95 TO STA 2788+13.24

A.P. 31  
N 31°03'38.42"  
E 1315664.36'  
EL 2819.30

DATE OF AERIAL PHOTOGRAPHY  
NOVEMBER 08, 2007  
GEO DIGITAL INTERNATIONAL

ST-105 STA-2420+70.00 322	ST-095 STA-2425+70.00 323	ST-090 STA-2430+20.00 324	ST-115 STA-2434+80.00 325	ST-115 STA-2442+50.00 326	ST-120 STA-2450+50.00 327	ST-115 STA-2459+20.00 328	ST-120 STA-2467+20.00 329	SD65-100 STA-2475+38.27 330 AP 31	ST-100 STA-2483+10.00 331
---------------------------------	---------------------------------	---------------------------------	---------------------------------	---------------------------------	---------------------------------	---------------------------------	---------------------------------	--	---------------------------------

--- LEFT PROFILE 20'  
--- RIGHT PROFILE 20'

200.0 FT. HORIZ. SCALE  
20.0 FT. VERT. SCALE

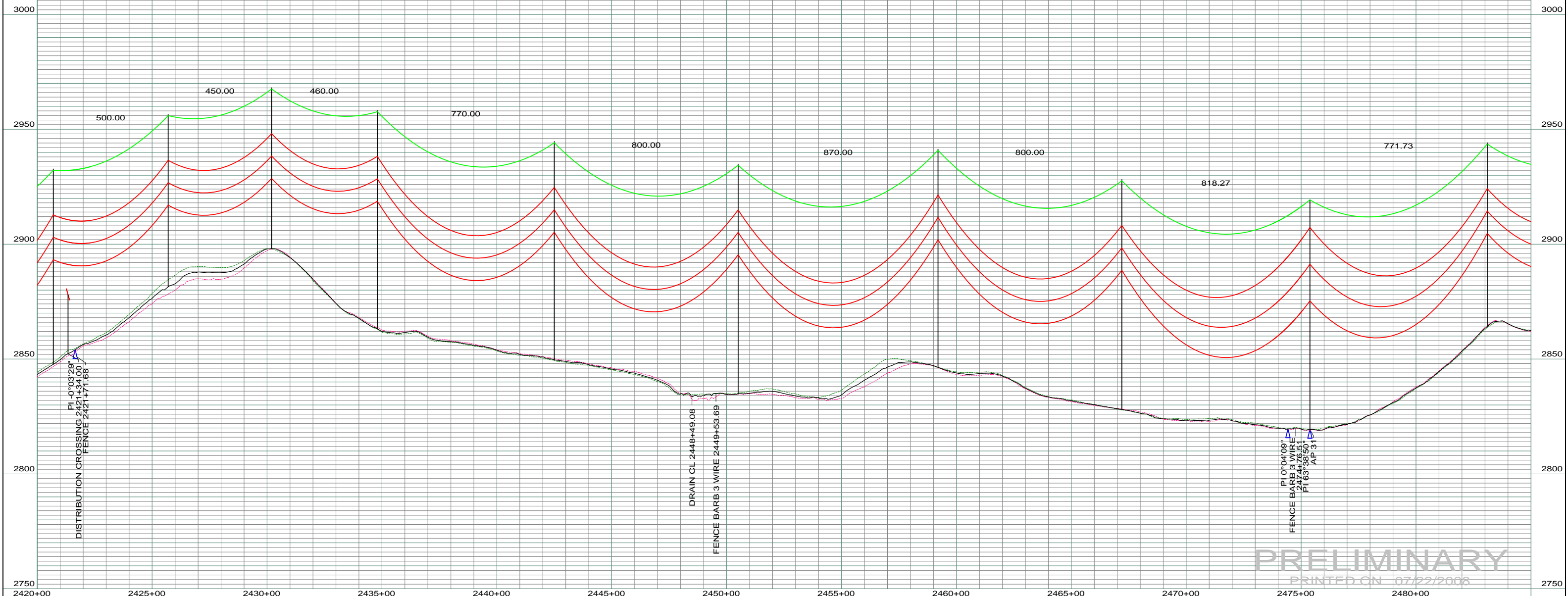

REV	DESCRIPTION	DRWN	DSGN	APPD	DATE	REV	DESCRIPTION	DRWN	DSGN	APPD	DATE
1		-	-	-	-	5					
2		-	-	-	-						
3		-	-	-	-						
4		-	-	-	-						

STATE NAME: NORTH DAKOTA		ZONE: 3302 SOUTH		DESIGN BY: DAM	07/22/2008
DESIGN INFORMATION				DRAWN BY: CDB	07/22/2008
CONDUCTOR	SIZE	STRINGING TENSION	NESC TENSION	DESIGN RULING SPAN	ACTUAL RULING SPAN
	1272 MCM ACSR				
	OHGW	7/16" E.H.S. STEEL			
	OPGW	AC 86/596			
DESIGN CHK: -		DRAFT CHK: -		APPROVED: -	

FACILITY: TRANSMISSION SYSTEM MAINTENANCE		BASIN ELECTRIC POWER COOPERATIVE 1717 EAST INTERSTATE AVENUE BISMARCK, NORTH DAKOTA PHONE 701-223-0441	
LOCATION UNIT: 181 - RHAME SUB TO BELFIELD SUB - 230 KV LINE			
RHAME TO BELFIELD TRANSMISSION PROJECT		SCALE: AS SHOWN	COUNTY NAME: BOWMAN
PLAN AND PROFILE		MILE 7 & 8	
BASIN DRAWING NO. 181-090-T3-050		REV. 0	