

**0900**  
 RAYMOND & SHIRLEY HEICK  
 NE 1/4 SEC. 31-T136N-R98W  
 CENTERLINE LENGTH 2641.47'-  
 160.09 RODS-7.58 ACRES  
 STA 3057+65.21 TO STA 3084+06.23

**0910**  
 GARDNER TRUST  
 SE 1/4 SEC. 30-T136N-R98W  
 CENTERLINE LENGTH 2642.10'-  
 160.13 RODS-7.58 ACRES  
 STA 3084+06.23 TO STA 3110+47.88

A.P. 38  
 N 338624.83  
 E 1331466.12  
 EL 2623.68



DATE OF AERIAL PHOTOGRAPH  
 NOVEMBER 08, 2007  
 GEODIGITAL INTERNATIONAL

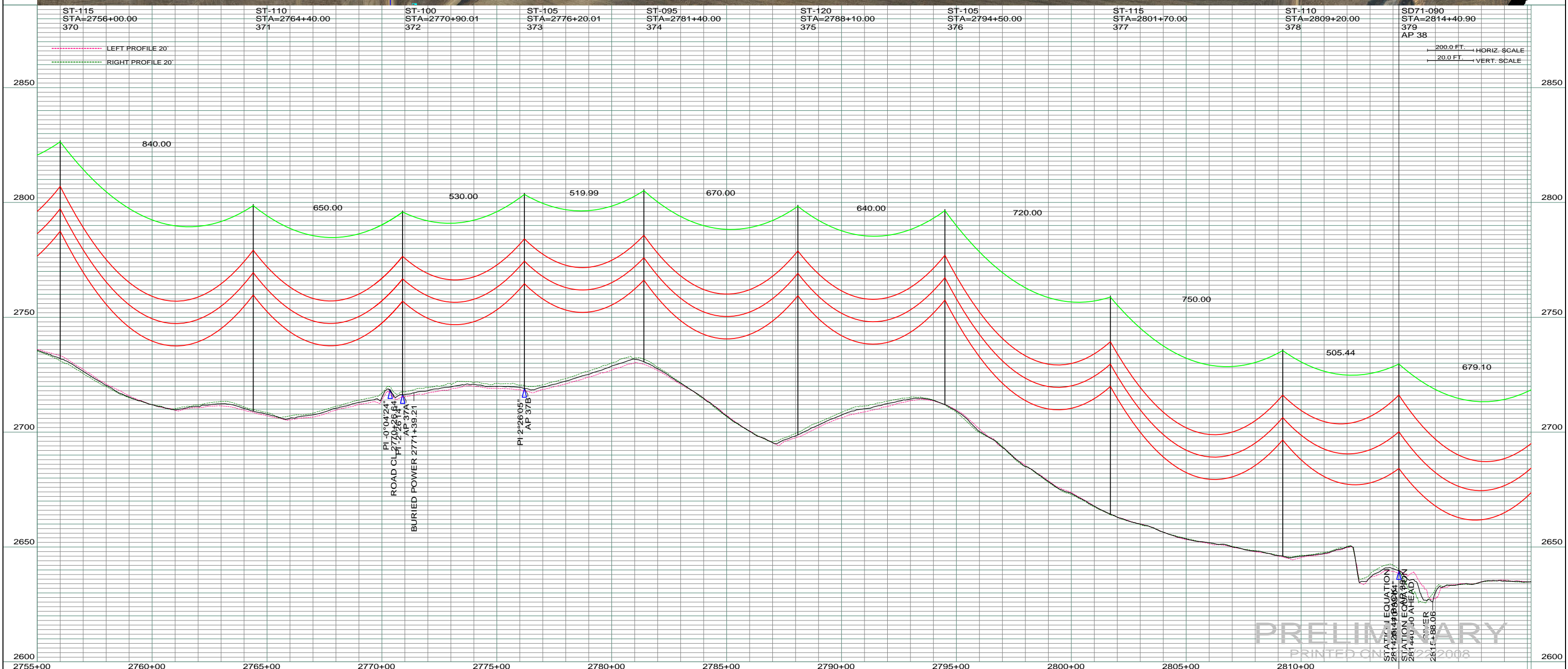

REV	DESCRIPTION	DRWN	DSGN	APPD	DATE	REV	DESCRIPTION	DRWN	DSGN	APPD	DATE
1	-	-	-	-	-	5	-	-	-	-	-
2	-	-	-	-	-	-	-	-	-	-	-
3	-	-	-	-	-	-	-	-	-	-	-
4	-	-	-	-	-	-	-	-	-	-	-

STATE NAME: NORTH DAKOTA	ZONE: 3302 SOUTH	DESIGN BY: DAM	07/22/2008	FACILITY: TRANSMISSION SYSTEM MAINTENANCE
DESIGN INFORMATION		DRAWN BY: CDB	07/22/2008	LOCATION UNIT: 181 - RHAME SUB TO BELFIELD SUB - 230 KV LINE
CONDUCTOR	SIZE: 1272 MCM ACSR	STRINGING TENSION	NESC TENSION	DESIGN RULING SPAN
OHGW	7/16" E.H.S. STEEL			ACTUAL RULING SPAN
OPGW	AC 86/596			
DESIGN CHECK: -		RHHAME TO BELFIELD TRANSMISSION PROJECT		
DRAFT CHECK: -		PLAN AND PROFILE		
APPROVED: -		MILE 13 & 14		

SCALE: AS SHOWN	COUNTY NAME: BOWMAN
BASIN DRAWING NO. 181-090-T3-056	REV. 0