

0925
 JAMES & MARJEAN SCHULZ
 NE 1/4 NW 1/4 SEC. 30-T136N-R98W
 0.23 RODS 0.08 ACRES
 STA 3154+88.09 TO STA 3154+91.86

0920
 EMILIA ILLICH
 NE 1/4 SEC. 30-T136N-R98W
 CENTERLINE LENGTH 4414.73'-
 269.38 RODS 12.61 ACRES
 STA 3110+47.88 TO STA 3154+91.86

A.P. 39
 N 339650.24
 E 1329472.08
 EL 2640.38

DATE OF AERIAL PHOTOGRAPHY
 NOVEMBER 08, 2007
 GEODIGITAL INTERNATIONAL

ST-110 STA=2821+20.00 380
 ST-115 STA=2828+40.00 381
 ST-110 STA=2835+70.00 382
 SD71-080 STA=2841+18.90 383 AP 39
 ST-115 STA=2847+30.00 384

LEFT PROFILE 20'
 RIGHT PROFILE 20'

200.0 FT. HORIZ. SCALE
 20.0 FT. VERT. SCALE

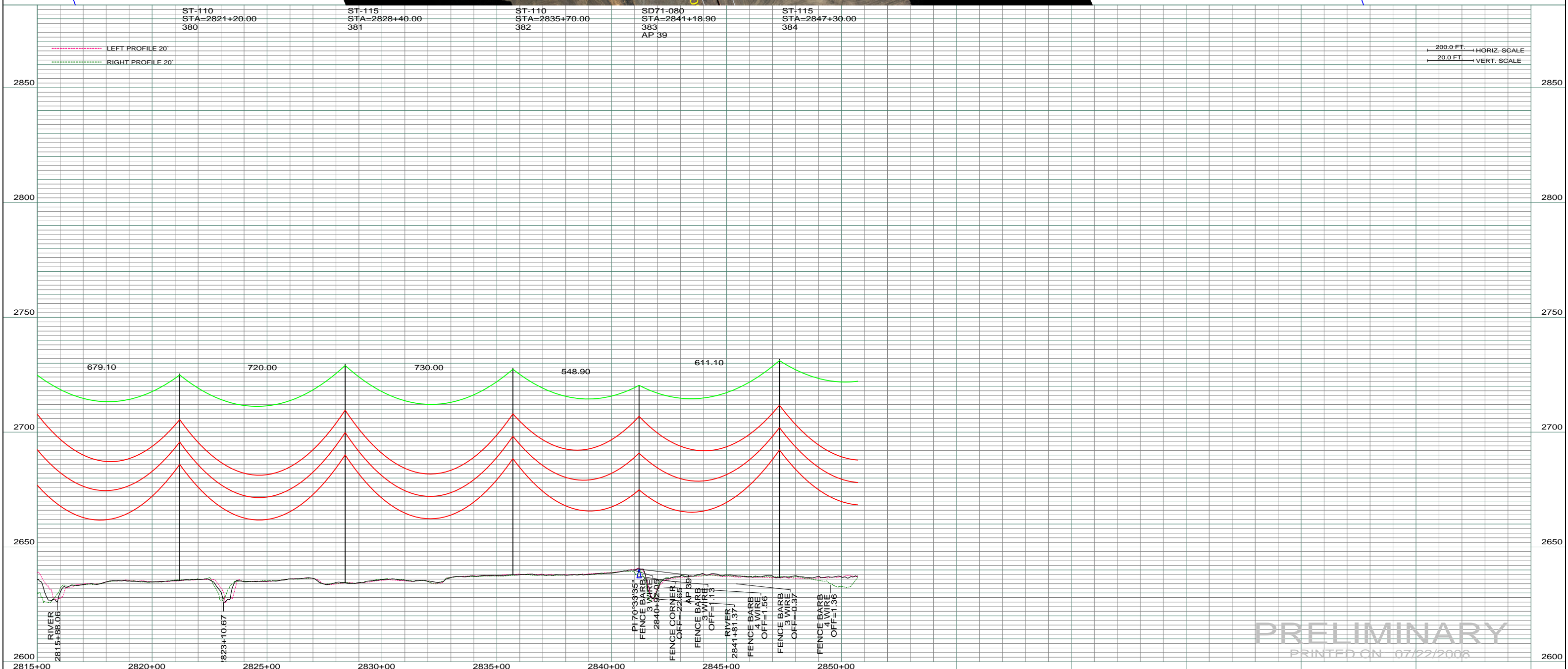

PRELIMINARY
 PRINTED ON 07/22/2008

| REV | DESCRIPTION | DRWN | DSGN | APPD | DATE | REV | DESCRIPTION | DRWN | DSGN | APPD | DATE | STATE NAME: NORTH DAKOTA | ZONE: 3302 SOUTH | DESIGN BY: DAM | 07/22/2008 | FACILITY: TRANSMISSION SYSTEM MAINTENANCE | LOCATION UNIT: 181 - RHAME SUB TO BELFIELD SUB - 230 KV LINE | BASIN ELECTRIC POWER COOPERATIVE |
|-----|-------------|------|------|------|------|-----|-------------|------|------|------|------|--------------------------|------------------|----------------|------------|---|--|---|
| 1 | | - | - | - | - | 5 | | | | | | | | | | | | 1717 EAST INTERSTATE AVENUE BISMARCK, NORTH DAKOTA PHONE 701-223-0441 |
| 2 | | - | - | - | - | | | | | | | | | | | | | SCALE: AS SHOWN |
| 3 | | - | - | - | - | | | | | | | | | | | | | COUNTY NAME: BOWMAN |
| 4 | | - | - | - | - | | | | | | | | | | | | | REV. 0 |

DESIGN INFORMATION

| CONDUCTOR | SIZE | STRINGING TENSION | NESC TENSION | DESIGN RULING SPAN | ACTUAL RULING SPAN |
|-----------|---------------|--------------------|--------------|--------------------|--------------------|
| | 1272 MCM ACSR | | | | |
| | OHGW | 7/16" E.H.S. STEEL | | | |
| | OPGW | AC 86/596 | | | |

DESIGN BY: DAM
 07/22/2008
 DRAWN BY: CDB
 07/22/2008
 DESIGN CHK: -
 DRAFT CHK: -
 APPROVED: -

RHAME TO BELFIELD TRANSMISSION PROJECT
 PLAN AND PROFILE
 MILE 14 & 15

SCALE: AS SHOWN
 BASIN DRAWING NO. 181-090-T3-057
 COUNTY NAME: BOWMAN
 REV. 0