



1090
NOEL NICHOLS
NW1/4; N1/2SW1/4 SEC. 29-T137N-R98W
LENGTH 3966.32'-240.38 RODS-5.69 ACRES
STA 3497+36.39 TO STA 3537+02.04

1080
JEFFREY & PEGGY HOLM ANDERSON
S1/2SW1/4; SE1/4 SEC. 29-T137N-R98W
CENTERLINE LENGTH 5199.19'-315.10 RODS-13.03 ACRES
STA 3458+59.97 TO STA 3510+58.27

1100
RAYMOND HECK
NE1/4 SEC. 29-T137N-R98W
LENGTH 2644.22'-160.26 RODS-3.79 ACRES
STA 3510+58.27 TO STA 3537+02.04

1120
RAYMOND HECK
SW1/4 SEC. 20-T137N-R98W
LENGTH 2644.24'-160.26 RODS-3.79 ACRES
STA 3537+02.04 TO STA 3563+45.82

DATE OF AERIAL PHOTOGRAPHY
NOVEMBER 08, 2007
GEO DIGITAL INTERNATIONAL

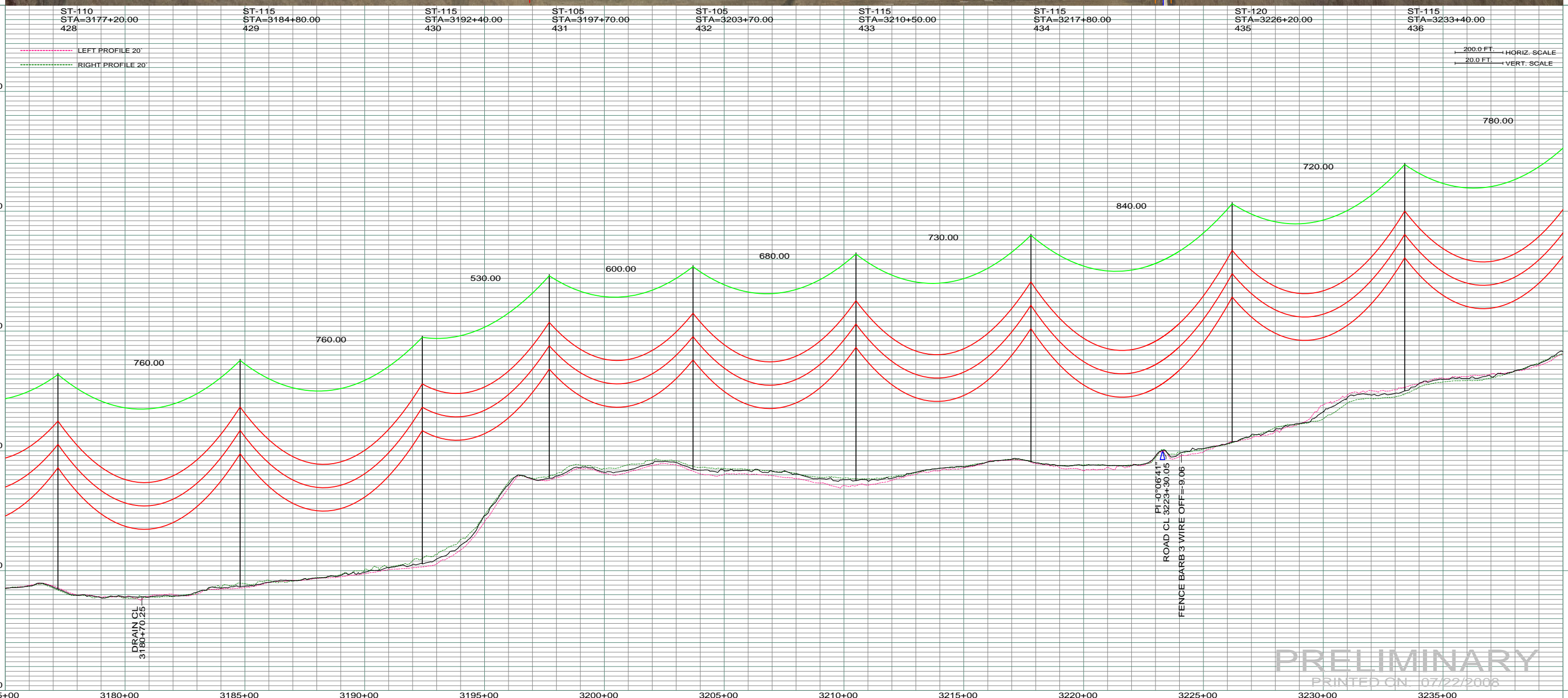

REV	DESCRIPTION	DRWN	DSGN	APPD	DATE	REV	DESCRIPTION	DRWN	DSGN	APPD	DATE
1		-	-	-	-	5					
2		-	-	-	-						
3		-	-	-	-						
4		-	-	-	-						

STATE NAME:	ZONE:	DESIGN BY:	DATE:	FACILITY:
NORTH DAKOTA	3302 SOUTH	DAM	07/22/2008	TRANSMISSION SYSTEM MAINTENANCE
DESIGN INFORMATION		DRAWN BY:	DATE:	LOCATION UNIT:
CONDUCTOR	SIZE	STRINGING TENSION	NESC TENSION	DESIGN RULING SPAN
	1272 MCM ACSR			
	OHGW	7/16" E.H.S. STEEL		
	OPGW	AC 86/596		

DESIGN BY:	DATE:	FACILITY:	LOCATION UNIT:
DAM	07/22/2008	TRANSMISSION SYSTEM MAINTENANCE	181 - RHAME SUB TO BELFIELD SUB - 230 KV LINE
DRAWN BY:	DATE:	RHAME TO BELFIELD TRANSMISSION PROJECT	
CDB	07/22/2008	PLAN AND PROFILE	
DESIGN CHK:		SCALE: AS SHOWN	
DRAFT CHK:		COUNTY NAME: BOWMAN	
APPROVED:		BASIN DRAWING NO. 181-90-T3-064	

SCALE:	COUNTY NAME:
AS SHOWN	BOWMAN
BASIN DRAWING NO.	REV.
181-90-T3-064	0

PRELIMINARY
PRINTED ON 07/22/2008