

DATE OF AERIAL PHOTOGRAPHY
NOVEMBER 08, 2007
GEO DIGITAL INTERNATIONAL

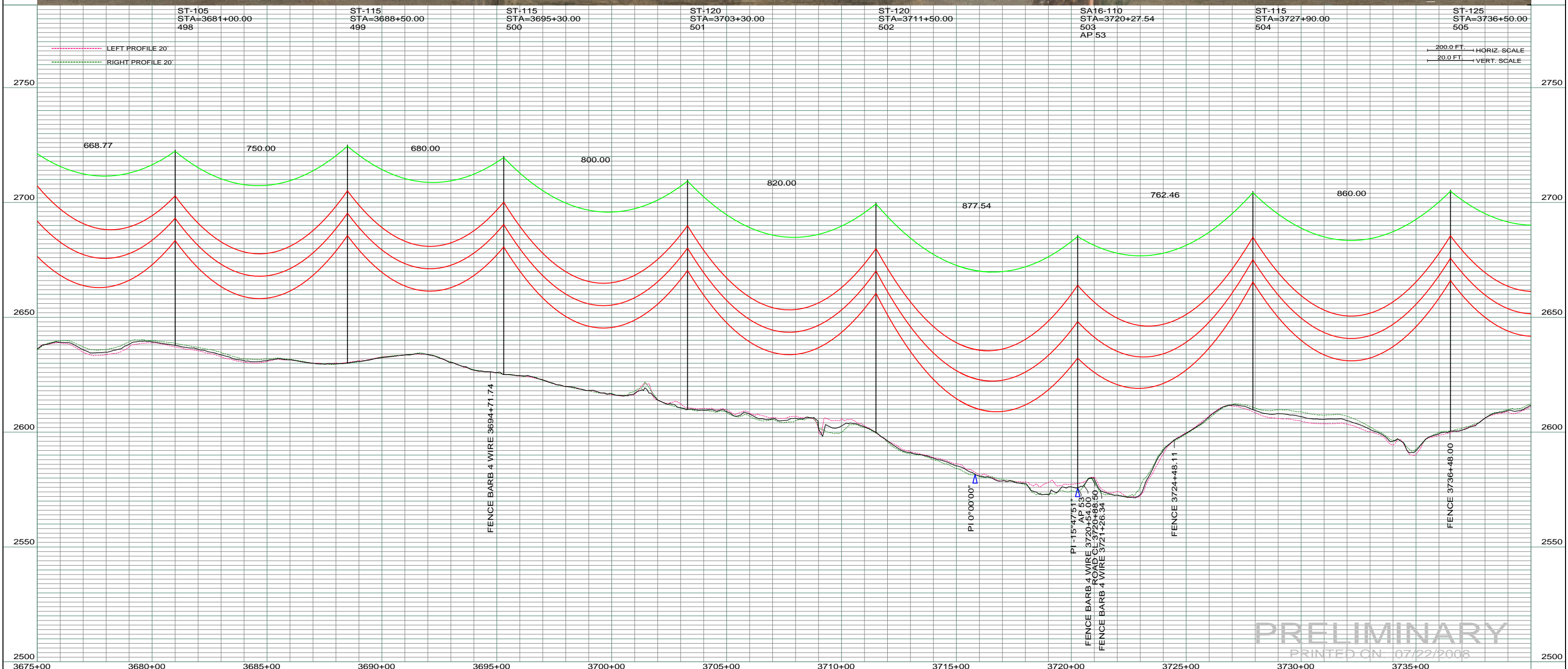

PRELIMINARY
PRINTED ON 07/22/2008

REV	DESCRIPTION	DRWN	DSGN	APPD	DATE	REV	DESCRIPTION	DRWN	DSGN	APPD	DATE	STATE NAME: NORTH DAKOTA	ZONE: 3302 SOUTH	DESIGN BY: DAM	07/22/2008	FACILITY: TRANSMISSION SYSTEM MAINTENANCE	1717 EAST INTERSTATE AVENUE BISMARCK, NORTH DAKOTA PHONE 701-223-0441	
1	-	-	-	-	-	5						DESIGN INFORMATION		DRAWN BY: CDB	07/22/2008	181 - RHAME SUB TO BELFIELD SUB - 230 KV LINE	BASIN ELECTRIC POWER COOPERATIVE SCALE: AS SHOWN COUNTY NAME: SLOPE BASIN DRAWING NO. 181-90-T3-075 REV. 0	
2	-	-	-	-	-							CONDUCTOR	1272 MCM ACSR					RHAME TO BELFIELD TRANSMISSION PROJECT PLAN AND PROFILE
3	-	-	-	-	-							OHGW	7/16" E.H.S. STEEL					
4	-	-	-	-	-							OPGW	AC 86/596					