

SE 1/4  
SEC. 36 T132N R103W  
BOWMAN CO., NORTH DAKOTA

0170  
STATE OF NORTH DAKOTA  
PART OF NW 1/4 SEC. 6 T131N R102W  
CENTERLINE LENGTH 222.53'  
13.49 RODS - 0.64 ACRES

0185  
DIRT FARMERS, LLP  
NW 1/4 LYING NORTH OF R.R. SEC. 6 T131N R102W  
CENTERLINE LENGTH 942.25 - 57.11 RODS - 2.70 ACRES

0175  
RANDALL & CONNIE GAEBE  
ALL LYING SOUTH OF R.R. SEC. 6 T131N R102W  
CENTERLINE LENGTH 31.25 - 1.89 RODS - 0.09 ACRES

0180  
SOUTH DAKOTA RAILROAD AUTHORITY  
PART OF NW 1/4 SEC. 6 T131N R102W  
CENTERLINE LENGTH 213.89 - 12.96 RODS - 0.61 ACRES

0190  
JAY & MYRTLE SOREIDE  
SW 1/4 SEC. 31 T132N R102W  
CENTERLINE LENGTH 2639.11'  
159.95 RODS - 7.57 ACRES

0200  
JULIE & ANDREW LEVOS  
GOVT LOTS 1&2 E1/2NW1/4  
SEC. 31 T132N R102W  
CENTERLINE LENGTH 4886.66'  
296.16 RODS - 14.02 ACRES



DATE OF AERIAL PHOTOGRAPHY  
NOVEMBER 08, 2007  
GEODIGITAL INTERNATIONAL

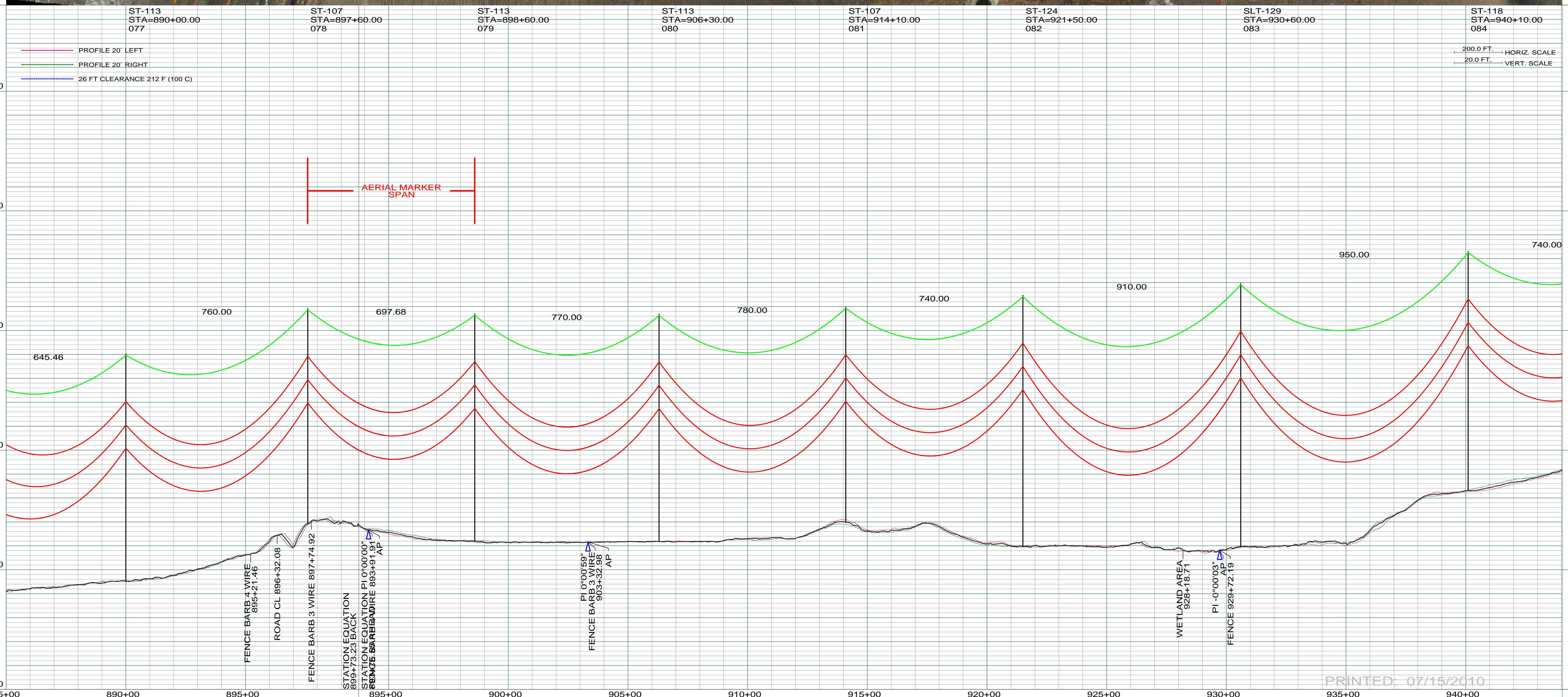

PRINTED: 07/15/2010

REV	DESCRIPTION	DRWN	DSGN	APPD	DATE
1	ISSUE TO PUBLIC SERVICE COMMISSION	CDB	CDB	DAM	09-05-08
2	ADDED AERIAL MARKER BALL TEXT, RELEASED FOR BID	CDB	CDB	DAM	01-15-09
3	ISSUED FOR CONSTRUCTION	CDB	CDB	DAM	03-30-09
4	AS-BUILT	CDB	CDB	DAM	07-16-10

REV	DESCRIPTION	DRWN	DSGN	APPD	DATE
1	STATE OF NORTH DAKOTA PART OF NW 1/4 SEC. 6 T131N R102W CENTERLINE LENGTH 222.53' 13.49 RODS - 0.64 ACRES				
2	DIRT FARMERS, LLP NW 1/4 LYING NORTH OF R.R. SEC. 6 T131N R102W CENTERLINE LENGTH 942.25 - 57.11 RODS - 2.70 ACRES				
3	RANDALL & CONNIE GAEBE ALL LYING SOUTH OF R.R. SEC. 6 T131N R102W CENTERLINE LENGTH 31.25 - 1.89 RODS - 0.09 ACRES				
4	SOUTH DAKOTA RAILROAD AUTHORITY PART OF NW 1/4 SEC. 6 T131N R102W CENTERLINE LENGTH 213.89 - 12.96 RODS - 0.61 ACRES				
5	JAY & MYRTLE SOREIDE SW 1/4 SEC. 31 T132N R102W CENTERLINE LENGTH 2639.11' 159.95 RODS - 7.57 ACRES				
6	JULIE & ANDREW LEVOS GOVT LOTS 1&2 E1/2NW1/4 SEC. 31 T132N R102W CENTERLINE LENGTH 4886.66' 296.16 RODS - 14.02 ACRES				

DESIGN INFORMATION		DESIGN BY:	DATE
CONDUCTOR	1272 MCM 45/7 ACSR	DAM/CDB	08-08-08
OPGW	AC-71/571	CDB	08-08-08
		DESIGN CHK:	08-08-08
		DRAFT CHK:	
		APPROVED:	09-05-08

DESIGN INFORMATION		DESIGN BY:	DATE
SIZE		DAM/CDB	08-08-08
STRINGING TENSION		CDB	08-08-08
NESC TENSION		SW/ULTEIG	08-08-08
DESIGN RULING SPAN			
ACTUAL RULING SPAN			

DESIGN INFORMATION		DESIGN BY:	DATE
CONDUCTOR	1272 MCM 45/7 ACSR	DAM/CDB	08-08-08
OPGW	AC-71/571	CDB	08-08-08
		DESIGN CHK:	08-08-08
		DRAFT CHK:	
		APPROVED:	09-05-08

DESIGN INFORMATION		DESIGN BY:	DATE
CONDUCTOR	1272 MCM 45/7 ACSR	DAM/CDB	08-08-08
OPGW	AC-71/571	CDB	08-08-08
		DESIGN CHK:	08-08-08
		DRAFT CHK:	
		APPROVED:	09-05-08

STATE NAME: NORTH DAKOTA  
NAD83 NDSPCS INTL FT SOUTH ZONE  
DESIGN BY: DAM/CDB 08-08-08  
DRAWN BY: CDB 08-08-08  
DESIGN CHK: SW/ULTEIG 08-08-08  
DRAFT CHK:  
APPROVED: DAM 09-05-08

FACILITY: TRANSMISSION SYSTEM MAINTENANCE  
LOCATION UNIT: 181-230KV LINE-RHAME SUBSTATION TO BELFIELD SUBSTATION  
RHAME TO BELFIELD 230KV TRANSMISSION LINE  
SCALE: AS SHOWN  
COUNTY NAME: BOWMAN  
BASIN DRAWING NO. 181-090-T3-013  
REV. 4

PLAN AND PROFILE  
MILE 10 & 11