

DATE OF AERIAL PHOTOGRAPHY  
NOVEMBER 08, 2007  
GEODIGITAL INTERNATIONAL

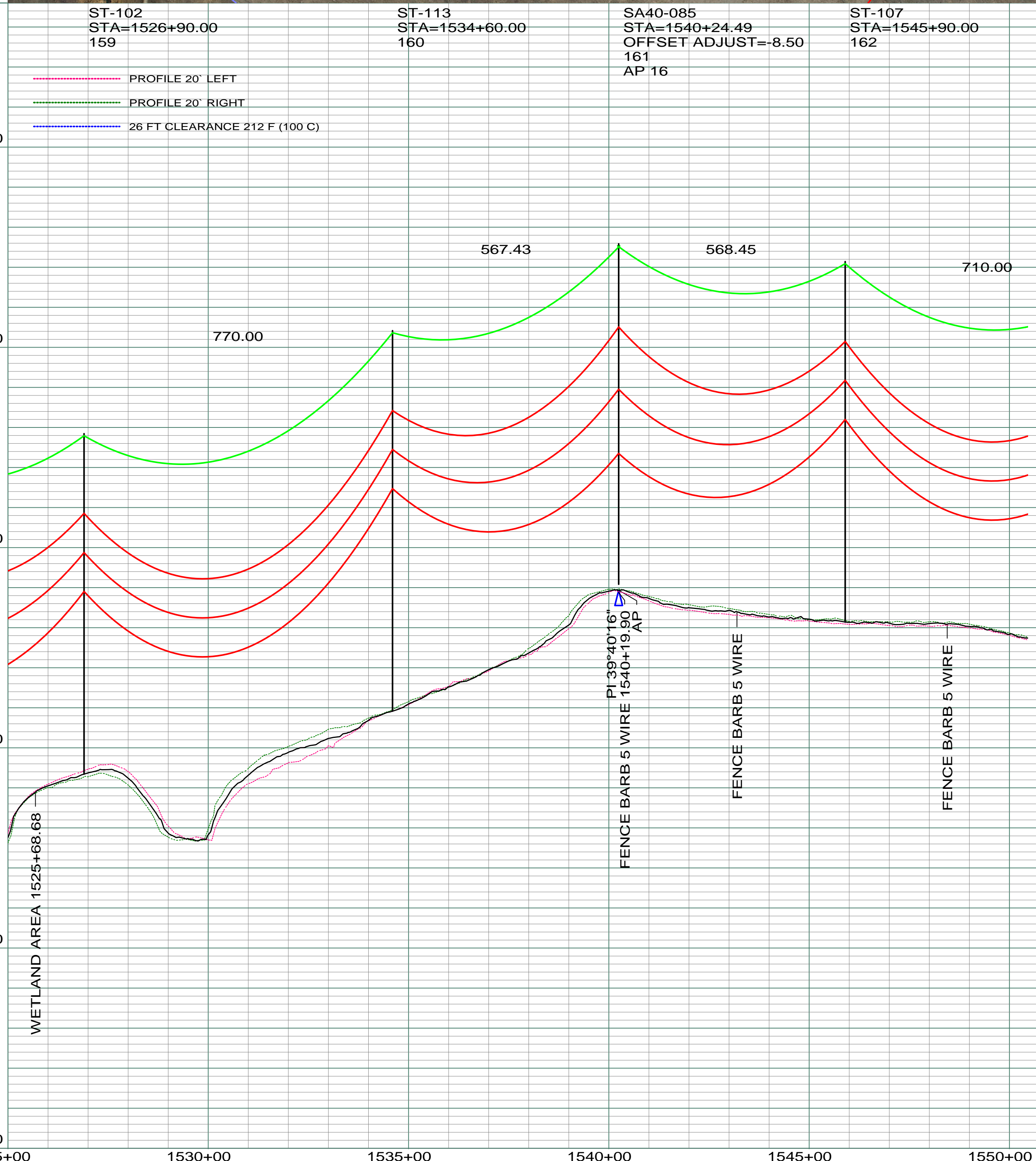

200.0 FT. HORIZ. SCALE  
20.0 FT. VERT. SCALE

PRINTED: 07/15/2010

REV	DESCRIPTION	DRWN	DSGN	APPD	DATE	REV	DESCRIPTION	DRWN	DSGN	APPD	DATE
1	ISSUE TO PUBLIC SERVICE COMMISSION	CDB	CDB	DAM	09-05-08	5	AS-BUILT	CDB	CDB	DAM	07-16-10
2	RELEASED FOR BID	CDB	CDB	DAM	01-15-09						
3	ISSUED FOR CONSTRUCTION	CDB	CDB	DAM	03-30-09						
4	MOVED STRS 159 AND 160 BACK DUE TO CULTURAL SITE	CDB	CDB	DAM	05-26-09						

DESIGN INFORMATION	
CONDUCTOR	SIZE
1272 MCM 45/7 ACSR <td>1272 MCM 45/7 ACSR</td>	1272 MCM 45/7 ACSR
OPGW	AC-71/571

DESIGN RULING SPAN	ACTUAL RULING SPAN
800	0
0	0

STATE NAME: NORTH DAKOTA NAD83 NDSPCS INTL FT SOUTH ZONE

DESIGN BY: DAM/CDB 08-08-08

DRAWN BY: CDB 08-08-08

DESIGN CHK: SW/ULTEIG 08-08-08

DRAFT CHK:

APPROVED: DAM 09-05-08

FACILITY: TRANSMISSION SYSTEM MAINTENANCE

LOCATION UNIT: 181-230KV LINE-RHAME SUBSTATION TO BELFIELD SUBSTATION

RHAME TO BELFIELD 230KV TRANSMISSION LINE

PLAN AND PROFILE  
MILE 22 & 23

SCALE: AS SHOWN

COUNTY NAME: BOWMAN

BASIN DRAWING NO. 181-090-T3-026

REV. 5

BASIN ELECTRIC POWER COOPERATIVE  
1717 EAST INTERSTATE AVENUE  
BISMARCK, NORTH DAKOTA  
PHONE 701-223-0441