

0530  
STATE OF NORTH DAKOTA  
SE 1/4 SEC. 16-T133N-R100W  
CENTERLINE LENGTH 228.46'-13.85 RODS-0.66 ACRES

SW 1/4  
SEC. 15 T133N R100W  
SLOPE CO., NORTH DAKOTA

0540  
DENNIS OLSON & MYRON OLSON  
ALL SEC. 15-T133N-R100W  
CENTERLINE LENGTH 7304.31'-442.69 RODS-20.95 ACRES

NE 1/4  
SEC. 15 T133N R100W  
SLOPE CO., NORTH DAKOTA

DATE OF AERIAL PHOTOGRAPHY  
NOVEMBER 09, 2007  
GEODIGITAL INTERNATIONAL

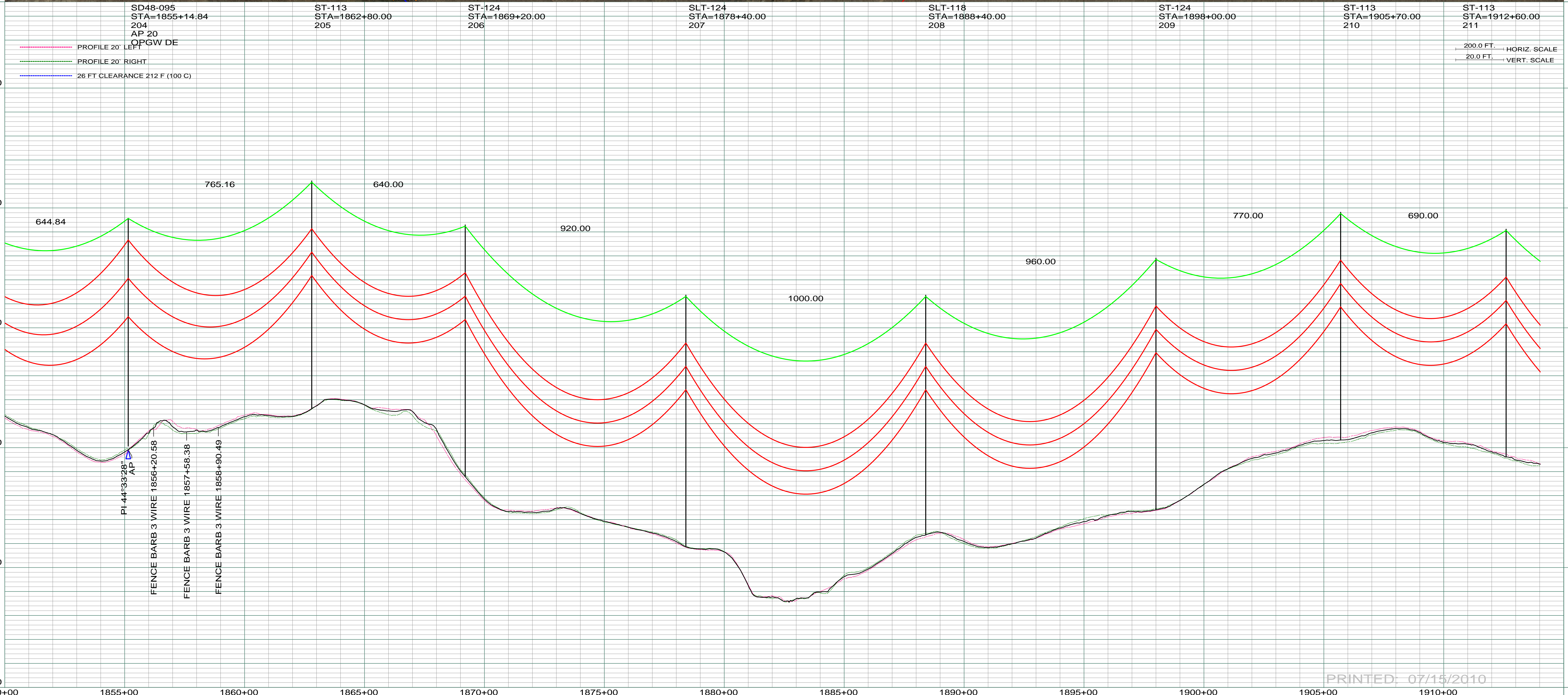

PRINTED: 07/15/2010

REV	DESCRIPTION	DRWN	DSGN	APPD	DATE	REV	DESCRIPTION	DRWN	DSGN	APPD	DATE
1	ISSUE TO PUBLIC SERVICE COMMISSION	CDB	CDB	DAM	09-05-08						
2	RELEASED FOR BID	CDB	CDB	DAM	01-15-09						
3	ISSUED FOR CONSTRUCTION	CDB	CDB	DAM	03-30-09						
4	AS-BUILT	CDB	CDB	DAM	07-16-10						

DESIGN INFORMATION	
CONDUCTOR	SIZE
1272 MCM 45/7 ACSR	1272 MCM 45/7 ACSR
OPGW	AC-71/571

DESIGN INFORMATION				
STRINGING TENSION	NESC TENSION	DESIGN RULING SPAN	ACTUAL RULING SPAN	
	0	800	0	
	0			

DESIGN BY:	DATE
DAM/CDB	08-08-08
DRAWN BY:	08-08-08
CDB	08-08-08
DESIGN CHK:	08-08-08
SW/ULTEIG	08-08-08
DRAFT CHK:	
APPROVED:	09-05-08
DAM	

FACILITY:	
TRANSMISSION SYSTEM MAINTENANCE	
LOCATION UNIT:	
181-230KV LINE-RHAME SUBSTATION TO BELFIELD SUBSTATION	
RAME TO BELFIELD 230KV TRANSMISSION LINE	
PLAN AND PROFILE	
MILE 28 & 30	

BASIN ELECTRIC POWER COOPERATIVE	
1717 EAST INTERSTATE AVENUE BISMARCK, NORTH DAKOTA PHONE 701-223-0441	
SCALE:	COUNTY NAME:
AS SHOWN	SLOPE
BASIN DRAWING NO.	REV.
181-090-T3-033	4