

SW 1/4  
SEC. 6 T134N R99W  
SLOPE CO., NORTH DAKOTA

SE 1/4  
SEC. 6 T134N R99W  
SLOPE CO., NORTH DAKOTA

NE 1/4  
SEC. 7 T134N R99W  
SLOPE CO., NORTH DAKOTA

0680  
JEFFREY & SUSANN POWELL  
WALTER & LUELLA M. JACOBS  
SE 1/4 SEC. 1-T134N-R100W  
CENTERLINE LENGTH 191.00'-11.58 RODS-0.55 ACRES

0690  
JOHN F. WALROD  
S 1/2 SEC. 6-T134N-R99W  
CENTERLINE LENGTH 4745.34'-287.60 RODS-13.62 ACRES

A.P. 28B  
N 293129.99  
E 1299539.08

A.P. 28A  
N 293134.10  
E 1298738.77

DATE OF AERIAL PHOTOGRAPHY  
NOVEMBER 08, 2007  
GEODIGITAL INTERNATIONAL

0680

0690

0690

SD90-095 STA=2351+67.19 267 AP 28 OPGW DE	ST-113 STA=2358+30.00 268	ST-113 STA=2365+70.00 269	ST-113 STA=2373+50.00 270	ST-113 STA=2381+50.00 271	ST-113 STA=2389+70.00 272	SLT-113 STA=2398+30.00 273 AP 28A	SLT-113 STA=2406+30.32 274 AP 28B
---	---------------------------------	---------------------------------	---------------------------------	---------------------------------	---------------------------------	--	--

PROFILE 20' LEFT  
PROFILE 20' RIGHT  
26 FT CLEARANCE 212 F (100 C)

200.0 FT. HORIZ. SCALE  
20.0 FT. VERT. SCALE

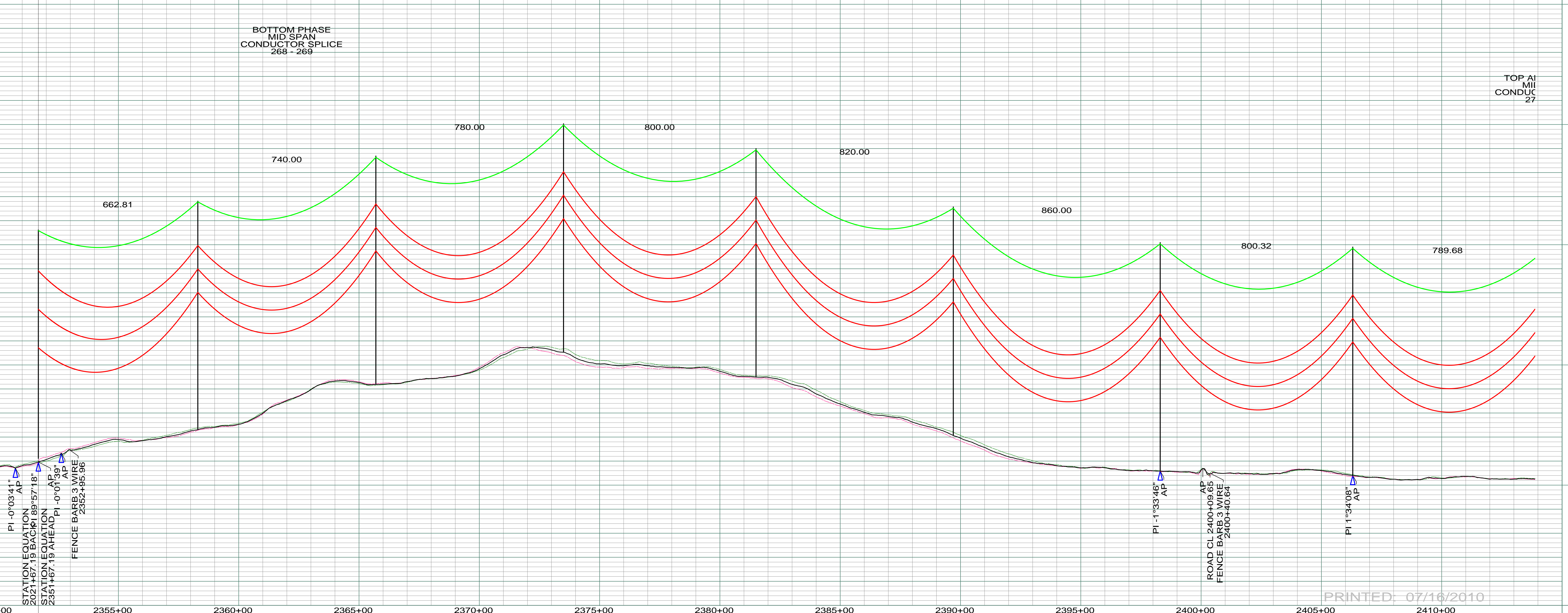

REV	DESCRIPTION	DRWN	DSGN	APPD	DATE	REV	DESCRIPTION	DRWN	DSGN	APPD	DATE	STATE NAME: NORTH DAKOTA	NAD83 NDSPCS INTL FT SOUTH ZONE	DESIGN BY: DAM/CDB	08-08-08	FACILITY: TRANSMISSION SYSTEM MAINTENANCE	
1	ISSUE TO PUBLIC SERVICE COMMISSION	CDB	CDB	DAM	08-08-08							DESIGN INFORMATION		DRAWN BY: CDB	08-08-08	LOCATION UNIT: 181-230KV LINE-RHAME SUBSTATION TO BELFIELD SUBSTATION	
2	RELEASE FOR BID	CDB	CDB	DAM	01-15-09							CONDUCTOR	1272 MCM 45/7 ACSR	DESIGN RULING SPAN	800	ACTUAL RULING SPAN	0
3	ISSUED FOR CONSTRUCTION	CDB	CDB	DAM	03-30-09							OPGW	AC-71/571	STRINGING TENSION		NESS TENSION	0
4	AS-BUILT	CDB	CDB	DAM	07-16-10									DRAFT CHK:		APPROVED: DAM	09-05-08

PRINTED: 07/16/2010

SCALE: AS SHOWN  
COUNTY NAME: SLOPE  
BASIN DRAWING NO. 181-090-T3-043  
REV. 4

BASIN ELECTRIC POWER COOPERATIVE  
1717 EAST INTERSTATE AVENUE  
BISMARCK, NORTH DAKOTA  
PHONE 701-223-0441