

NE 1/4
SEC. 3 T134N R99W
SLOPE CO., NORTH DAKOTA

0750
KEITH RUGGLES
NW 1/4 SEC. 2 T134N R99W
CENTERLINE LENGTH 1738.89 -
105.59 RODS - 4.99 ACRES

SE 1/4
SEC. 34 T135N R99W
SLOPE CO., NORTH DAKOTA

NE 1/4
SEC. 34 T135N R99W
SLOPE CO., NORTH DAKOTA

SW 1/4
SEC. 35 T135N R99W
SLOPE CO., NORTH DAKOTA

0760-0770
THOMAS G. & ELLEN M. POWELL
W 1/2 SEC. 35 T135N R99W
CENTERLINE LENGTH 5283.44 - 320.21 RODS - 15.16 ACRES

DATE OF AERIAL PHOTOGRAPHY
NOVEMBER 08, 2007
GEODIGITAL INTERNATIONAL

NORTH

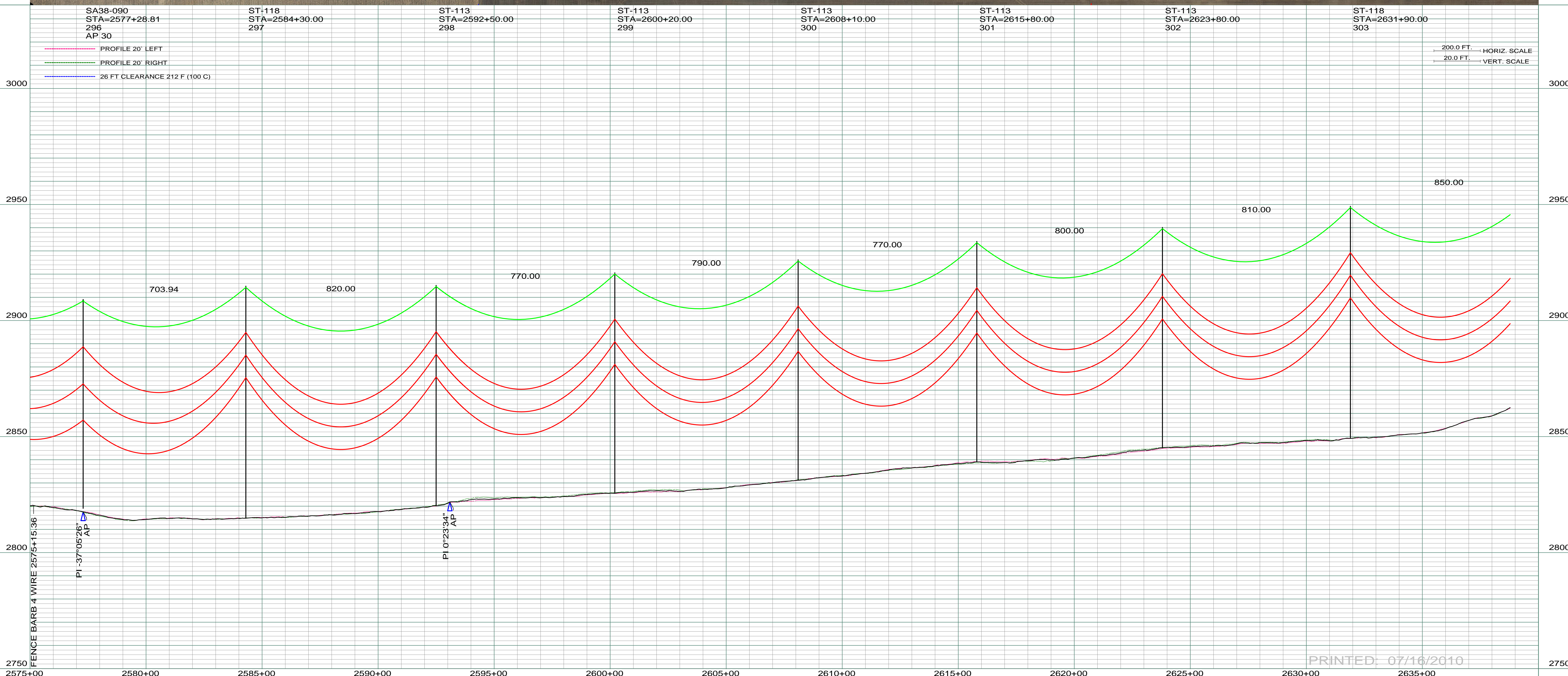

PRINTED: 07/16/2010

REV	DESCRIPTION	DRWN	DSGN	APPD	DATE	REV	DESCRIPTION	DRWN	DSGN	APPD	DATE
1	ISSUE TO PUBLIC SERVICE COMMISSION	CDB	CDB	DAM	08-08-08						
2	RELEASE FOR BID	CDB	CDB	DAM	01-15-09						
3	ISSUED FOR CONSTRUCTION	CDB	CDB	DAM	03-30-09						
4	AS-BUILT	CDB	CDB	DAM	07-16-10						

DESIGN INFORMATION	
CONDUCTOR	SIZE
1272 MCM 45/7 ACSR <td>1272 MCM 45/7 ACSR</td>	1272 MCM 45/7 ACSR
OPGW	AC-71/571

DESIGN INFORMATION	
STRINGING TENSION	NE SC TENSION
0	0
DESIGN RULING SPAN	ACTUAL RULING SPAN
800	0

DESIGN INFORMATION	
DESIGN BY:	DATE
DAM/CDB	08-08-08
DRAWN BY:	DATE
CDB	08-08-08
DESIGN CHK:	DATE
SW/ULTEIG	08-08-08
DRAFT CHK:	DATE
APPROVED:	DATE
DAM	09-05-08

FACILITY: TRANSMISSION SYSTEM MAINTENANCE
 LOCATION UNIT: 181-230KV LINE-RHAME SUBSTATION TO BELFIELD SUBSTATION
 SCALE: AS SHOWN
 COUNTY NAME: SLOPE
 BASIN DRAWING NO. 181-090-T3-047
 REV. 4