

SE 1/4
SEC. 27 T135N R99W
SLOPE CO., NORTH DAKOTA

NE 1/4
SEC. 27 T135N R99W
SLOPE CO., NORTH DAKOTA

SW 1/4
SEC. 26 T135N R99W
SLOPE CO., NORTH DAKOTA

0780
THOMAS G. & EILEEN M. POWELL
SW 1/4 SEC. 26-T135N-R99W
CENTERLINE LENGTH 2641.72'-160.10 RODS-7.58 ACRES

0790
MICHAEL C. GARDNER
NW 1/4 SEC. 26-T135N-R99W
CENTERLINE LENGTH 2641.72'-160.10 RODS-7.58 ACRES

DATE OF AERIAL PHOTOGRAPHY
NOVEMBER 08, 2007
GEODIGITAL INTERNATIONAL

OS-15 NORTH
6 ACRES

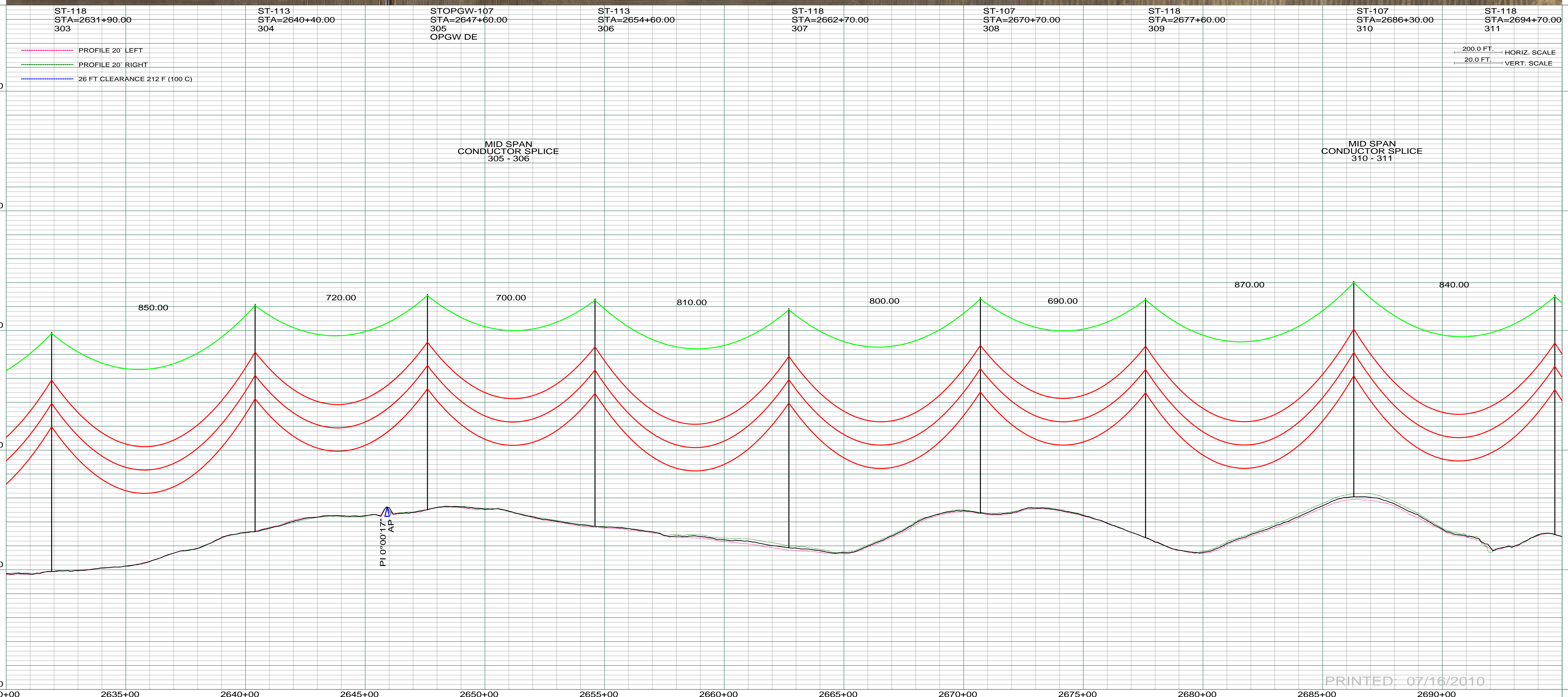

PRINTED: 07/16/2010

REV	DESCRIPTION	DRWN	DSGN	APPD	DATE	REV	DESCRIPTION	DRWN	DSGN	APPD	DATE
1	ISSUE TO PUBLIC SERVICE COMMISSION	CDB	CDB	DAM	08-08-08						
2	RELEASE FOR BID	CDB	CDB	DAM	01-15-09						
3	ISSUED FOR CONSTRUCTION	CDB	CDB	DAM	03-30-09						
4	AS-BUILT	CDB	CDB	DAM	07-16-10						

STATE NAME:	NAD83 NDSPCS INTL FT SOUTH ZONE
NORTH DAKOTA	

DESIGN INFORMATION					
CONDUCTOR	SIZE	STRINGING TENSION	NESC TENSION	DESIGN RULING SPAN	ACTUAL RULING SPAN
1272 MCM 45/7 ACSR			0	800	0
OPGW	AC-71/571		0		

DESIGN BY:	DAM/CDB	08-08-08
DRAWN BY:	CDB	08-08-08
DESIGN CHK:	SW/ULTEIG	08-08-08
DRAFT CHK:		
APPROVED:	DAM	09-05-08

FACILITY:	TRANSMISSION SYSTEM MAINTENANCE
LOCATION UNIT:	181-230KV LINE-RHAME SUBSTATION TO BELFIELD SUBSTATION
RHAME TO BELFIELD 230KV TRANSMISSION LINE	
PLAN AND PROFILE	
MILE 43 & 44	

SCALE:	AS SHOWN	COUNTY NAME:	SLOPE
BASIN DRAWING NO.	181-090-T3-048	REV.	4



BASIN ELECTRIC
POWER COOPERATIVE
1717 EAST INTERSTATE AVENUE
BISMARCK, NORTH DAKOTA
PHONE 701-223-0441