

NW 1/4
SEC. 32 T139N R98W
STARK CO., NORTH DAKOTA

1290
GORDON & STEPHONI KRANCE
NW 1/4 SEC. 32-T139N-R98W
CENTERLINE LENGTH 1319.35'-
79.96 RODS-3.78 ACRES

SE 1/4
SEC. 29 T139N R98W
STARK CO., NORTH DAKOTA

1300
CORNELIUS KOOREN
ALL LESS TRACT SEC. 29-T139N-R98W
CENTERLINE LENGTH 6271.79'-
319.50 RODS-15.13 ACRES

1280
LEOCADIA EMMIL FAMILY TRUST
PART OF S1/2N1/2NE1/4, S1/2NE1/4, SE1/4 SEC. 32-T139N-R98W
CENTERLINE LENGTH 4019.96'-
243.63 RODS-11.53 ACRES

DATE OF AERIAL PHOTOGRAPHY
NOVEMBER 08, 2007
GEODIGITAL INTERNATIONAL

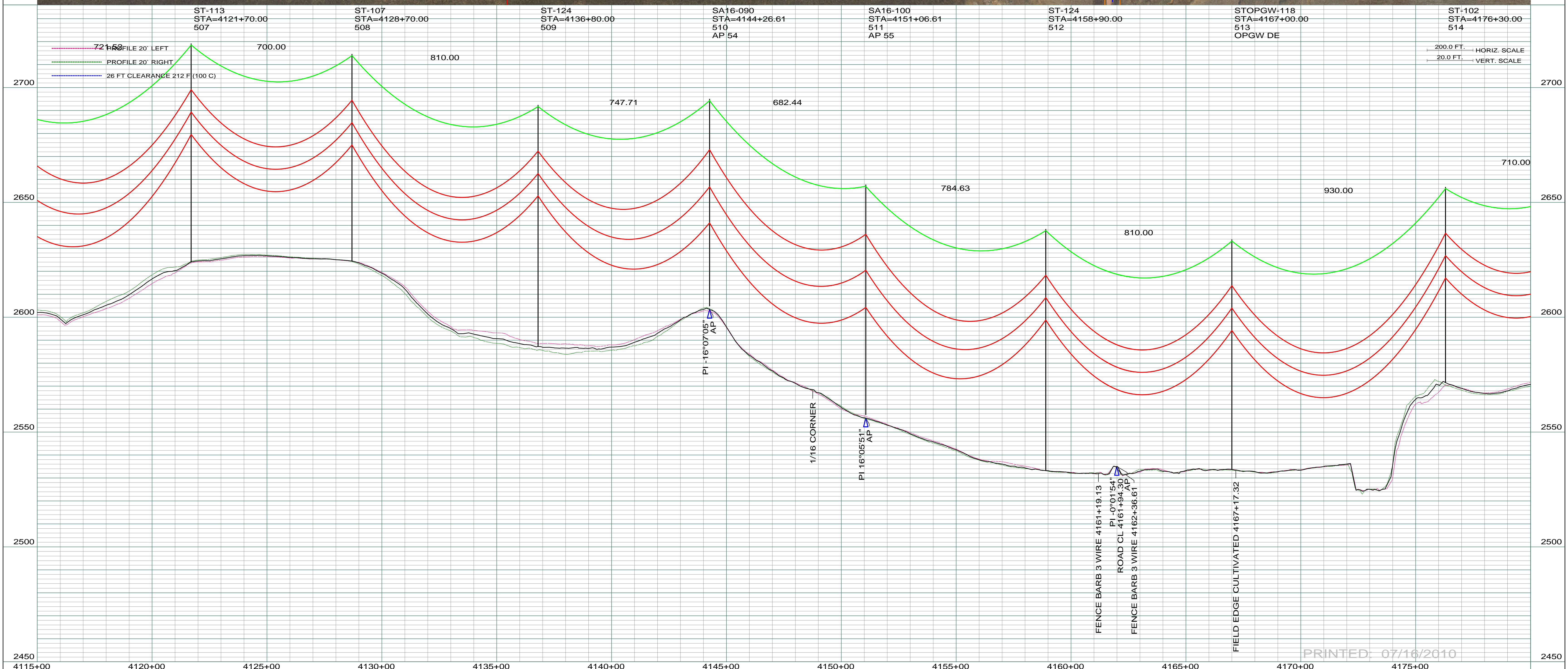

PRINTED: 07/16/2010

REV	DESCRIPTION	DRWN	DSGN	APPD	DATE	REV	DESCRIPTION	DRWN	DSGN	APPD	DATE
1	ISSUE TO PUBLIC SERVICE COMMISSION	CDB	CDB	DAM	08-08-08						
2	RELEASE FOR BID	CDB	CDB	DAM	01-15-09						
3	MOVED STR. 513 SOUTH 40 FT. OUT OF CROP LAND, ISSUED FOR CONSTRUCTION	CDB	CDB	DAM	03-30-09						
4	AS-BUILT	CDB	CDB	DAM	07-16-10						

STATE NAME:	NORTH DAKOTA	NAD83	NDSPCS	INTL FT	SOUTH ZONE
DESIGN INFORMATION					
CONDUCTOR	1272 MCM 45/7 ACSR	STRINGING TENSION	0	DESIGN RULING SPAN	800
OPGW	AC-71/571	NESC TENSION	0	ACTUAL RULING SPAN	0

DESIGN BY:	DAM/CDB	08-08-08
DRAWN BY:	CDB	08-08-08
DESIGN CHK:	SW/ULTEIG	08-08-08
DRAFT CHK:		
APPROVED:	DAM	09-05-08

FACILITY:	TRANSMISSION SYSTEM MAINTENANCE
LOCATION UNIT:	181-230KV LINE-RHAME SUBSTATION TO BELFIELD SUBSTATION
RHAME TO BELFIELD 230KV TRANSMISSION LINE	
PLAN AND PROFILE	
MILE 71 & 72	

SCALE:	AS SHOWN	COUNTY NAME:	STARK
BASIN DRAWING NO.	181-090-T3-077	REV.	4