

SW 1/4
SEC. 10 T156N R97W
WILLIAMS CO., NORTH DAKOTA

0570
EMIL FOSS, ETAL
S1/2NE1/4, NW1/4SE1/4, NE1/4SW1/4
SEC. 10 T156N R97W
CENTERLINE LENGTH 5281.69' 320.10 RODS=7.58 ACRES

0580
DONALD & CONNIE BERGSTROM
E1/2SE1/4, SW1/4SE1/4, SE1/4SW1/4,
W1/2SW1/4 SEC. 10 T156N R97W
CENTERLINE LENGTH 7442.24'
460.74 RODS=12.31 ACRES

SE 1/4
SEC. 10 T156N R97W
WILLIAMS CO., NORTH DAKOTA



LIDAR & AERIAL PHOTOGRAPHY
JULY 20, 2009
FUGRO HORIZONS, INC.

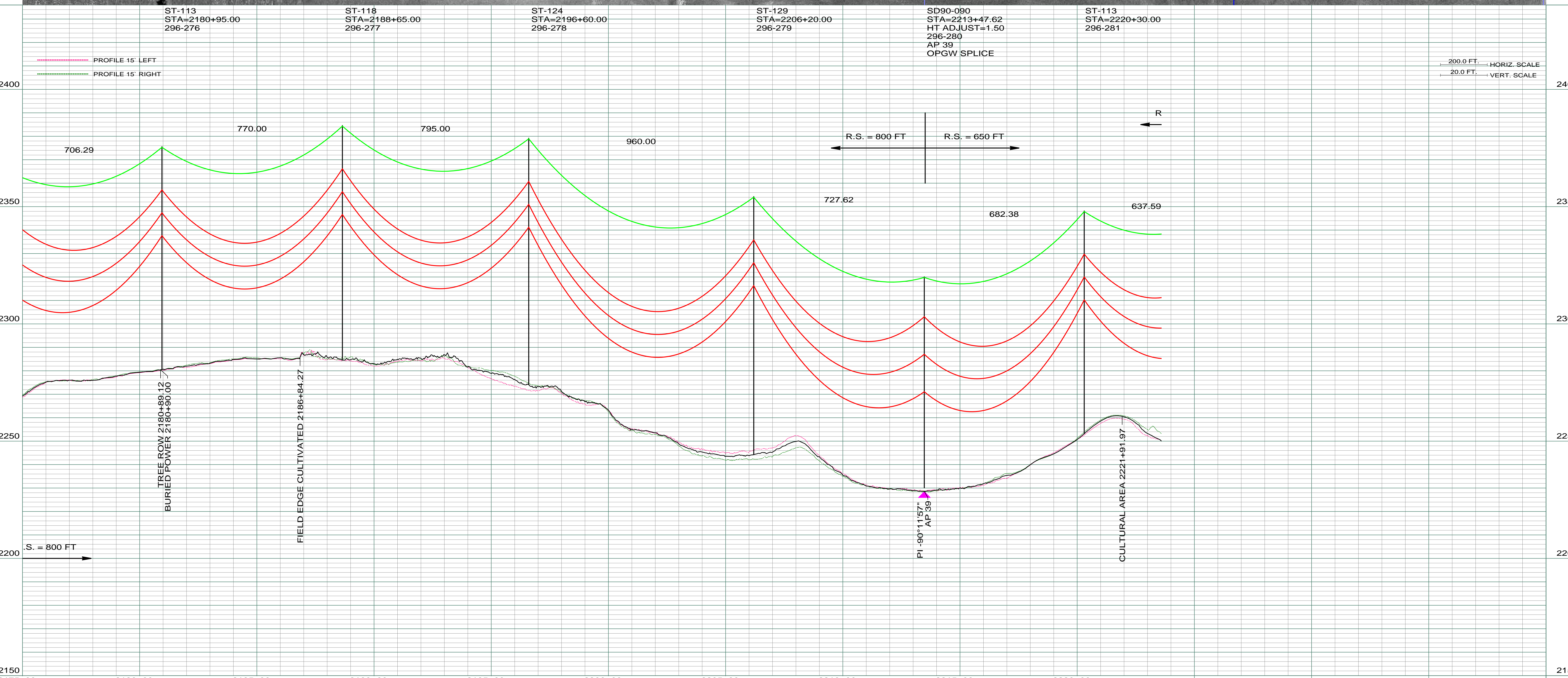

REV	DESCRIPTION	DRWN	DSGN	APPD	DATE	REV	DESCRIPTION	DRWN	DSGN	APPD	DATE
1	ISSUE FOR BID	CDB	CDB	DAM	10/27/09	5	AS-BUILT	CDB	CDB	DAM	03/07/11
2	ISSUED FOR CONSTRUCTION	CDB	CDB	DAM	02/03/10						
3	MODIFIED CROSSING TEXT AND MILE INFORMATION	CDB	CDB	DAM	03/11/10						
4	MOVED STR 276 5 FT AHEAD TO AVOID BURIED FIBER AND STR 277 5 FT BACK TO AVOID ROCK	CDB	CDB	DAM	09/30/10						

DESIGN INFORMATION		DESIGN BY:	DATE
CONDUCTOR	1272 MCM 45/7 ACSR	DAM/CDB	10/12/09
OPGW	AC-71/571	CDB	10/12/09
STRINGING TENSION	6501	DRAWN BY:	CDB
NESC TENSION	12617	DESIGN CHK:	MBN ENGRG.
DESIGN R.S.	800	DRAFT CHK:	
ACTUAL R.S.	807	APPROVED:	DAM

FACILITY:	TRANSMISSION SYSTEM MAINTENANCE	BASIN ELECTRIC POWER COOPERATIVE 1717 EAST INTERSTATE AVENUE BISMARCK, NORTH DAKOTA PHONE 701-223-0441
LOCATION UNIT:	296-230KV LINE-WILLISTON SUBSTATION TO TIOGA SUBSTATION	
WILLISTON TO TIOGA 230KV TRANSMISSION LINE		SCALE: AS SHOWN COUNTY NAME: WILLIAMS
PLAN AND PROFILE MILE 41 & 42		BASIN DRAWING NO. 296-090-T3-042 REV. 5