

NE 1/4 SEC. 9 T156N R96W WILLIAMS CO., NORTH DAKOTA  
 NW 1/4 SEC. 10 T156N R96W WILLIAMS CO., NORTH DAKOTA

0410  
 DIANE ERICKSON  
 NE 1/4 SEC. 9-T156N-R96W  
 LENGTH 2637.36-159.84 RODS-3.78 ACRES

0390  
 BIRGER & DONNA SKISTAD-LIFE ESTATE, ETAL  
 W1/2, NE1/4, SEC. 10-T156N-R96W  
 LENGTH 5285.40-320.33 RODS-11.37 ACRES

0400  
 BIRGER & DONNA SKISTAD-LIFE ESTATE, ETAL  
 E1/2SE1/4 SEC. 9-T156N-R96W  
 LENGTH 1318.68-79.92 RODS-1.89 ACRES

SW 1/4 SEC. 10 T156N R96W WILLIAMS CO., NORTH DAKOTA

0380  
 JEANETTE SWANSON  
 SE 1/4 SEC. 10-T156N-R96W  
 LENGTH 2643.16-160.19 RODS-3.79 ACRES

LIDAR & AERIAL PHOTOGRAPHY  
 JULY 20, 2009  
 FUGRO HORIZONS, INC.

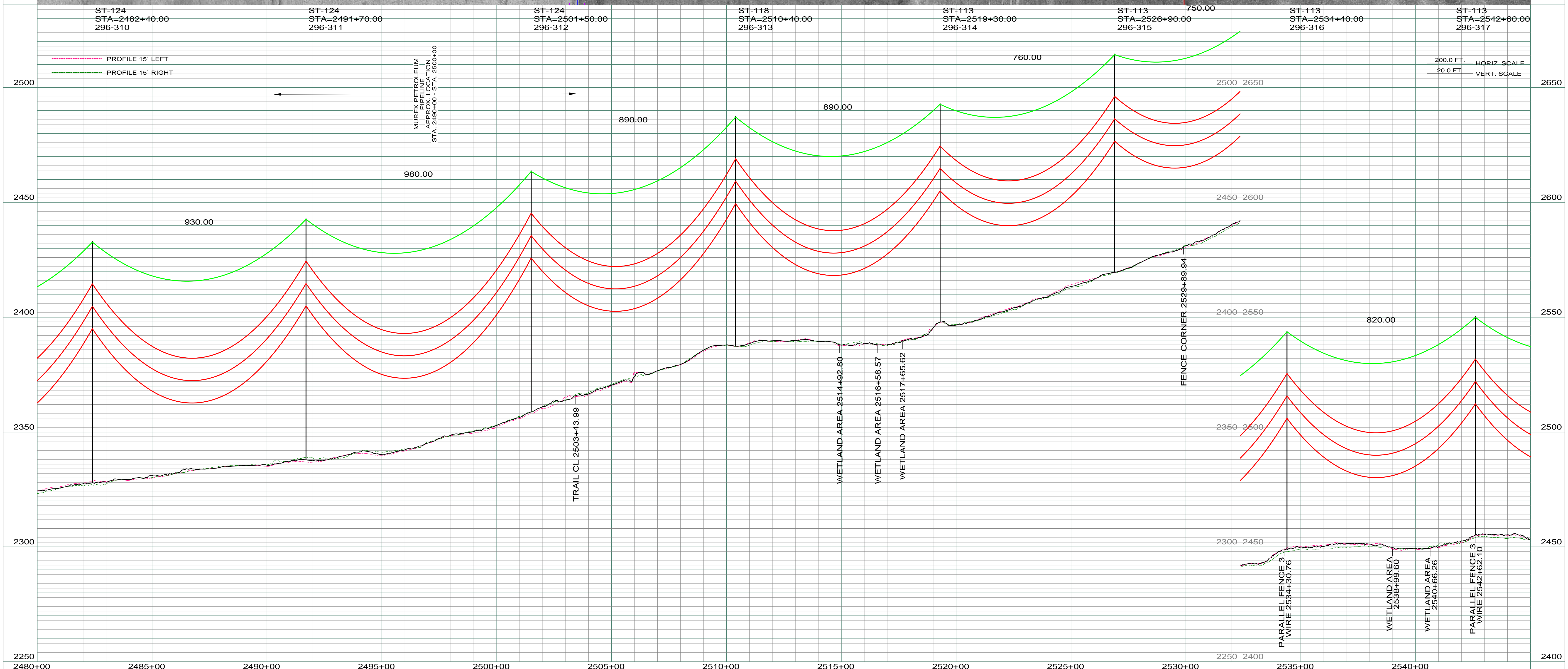

REV	DESCRIPTION	DRWN	DSGN	APPD	DATE	REV	DESCRIPTION	DRWN	DSGN	APPD	DATE
1	ISSUE FOR BID	CDB	CDB	DAM	10/27/09						
2	ISSUED FOR CONSTRUCTION	CDB	CDB	DAM	02/03/10						
3	MODIFIED CROSSING TEXT AND MILE INFORMATION	CDB	CDB	DAM	03/11/10						
4	AS-BUILT	CDB	CDB	DAM	03/07/11						

DESIGN INFORMATION					
CONDUCTOR	SIZE	STRINGING TENSION	NESC TENSION	DESIGN R.S.	ACTUAL R.S.
	1272 MCM 45/7 ACSR	6501	12617	850	881
	OPGW AC-71/571	2281	6035	850	892

DESIGN INFORMATION			
DESIGN BY:	DATE	DESIGN CHK:	DATE
DAM/CDB	10/12/09	MBN ENGRG.	01/08/10
DRAWN BY:	CDB	DRAFT CHK:	
	10/12/09		
APPROVED:	DAM		10/12/09

FACILITY:	
TRANSMISSION SYSTEM MAINTENANCE	
LOCATION UNIT:	
296-230KV LINE-WILLISTON SUBSTATION TO TIOGA SUBSTATION	
WILLISTON TO TIOGA 230KV TRANSMISSION LINE	
PLAN AND PROFILE	
MILE 46 & 47	

BASIN ELECTRIC POWER COOPERATIVE	
1717 EAST INTERSTATE AVENUE BISMARCK, NORTH DAKOTA PHONE 701-223-0441	
SCALE:	COUNTY NAME:
AS SHOWN	WILLIAMS
BASIN DRAWING NO.	REV.
296-090-T3-048	4