

NE 1/4  
SEC. 30 T157N R94W  
MOUNTAIN CO., NORTH DAKOTA

**0040**  
MESET RESTATED FAMILY TRUST, ETAL  
S1/2 NW 1/4, NW 1/4 SEC. 30 T157N R94W  
CENTERLINE LENGTH 2717.30 164.63 RODS 1.80 ACRES

**0045**  
VERNON NELSON  
W1/2 SE 1/4 LESS R/W SEC. 30 T157N R94W  
CENTERLINE LENGTH 352.07 21.32 RODS 1.00 ACRES

LIDAR & AERIAL PHOTOGRAPHY  
JULY 20, 2008  
FUGRO HORIZONS, INC.

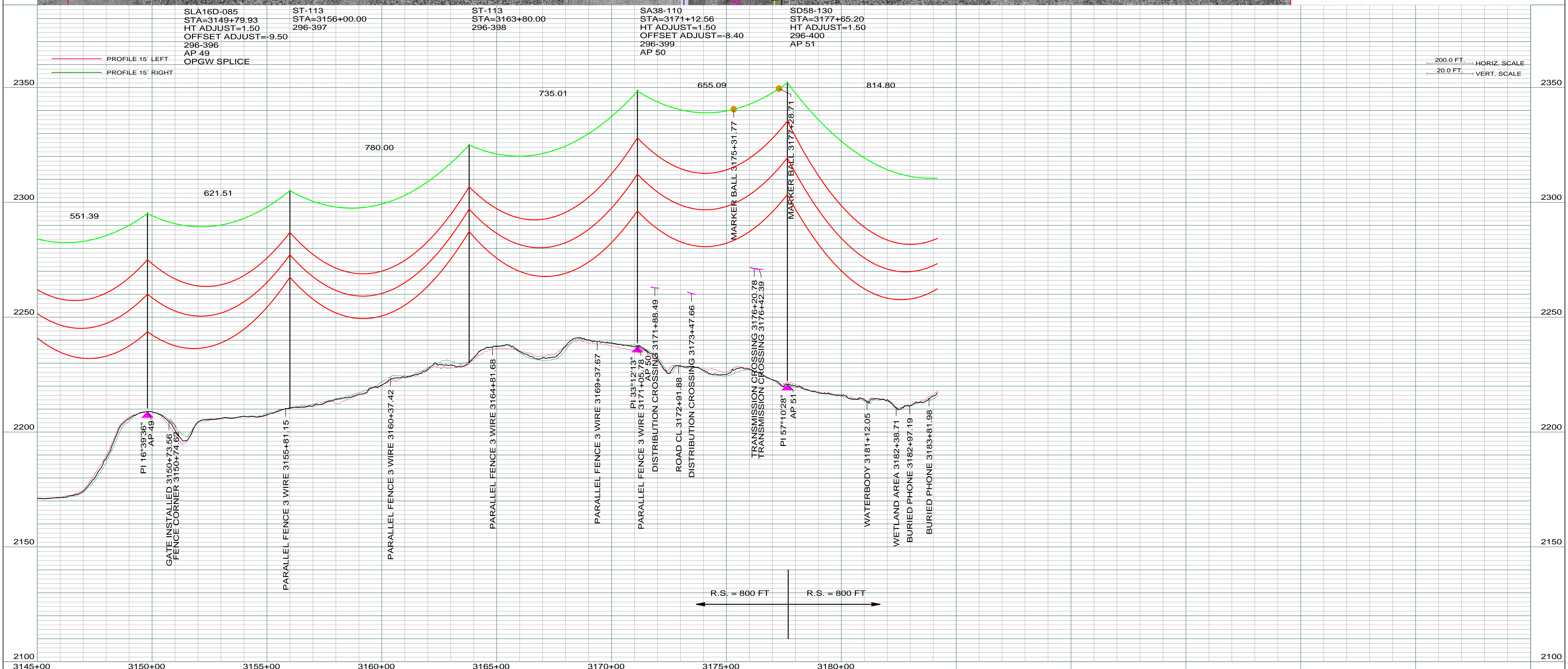

SLA16D-085 STA=3149+79.93 HT ADJUST=1.50 OFFSET ADJUST=-9.50 296-396 AP 49 OPGW SPLICE	ST-113 STA=3156+00.00 296-397	ST-113 STA=3163+80.00 296-398	SA38-110 STA=3171+12.56 HT ADJUST=1.50 OFFSET ADJUST=-8.40 296-399 AP 50	SD58-130 STA=3177+65.20 HT ADJUST=1.50 296-400 AP 51
--	-------------------------------------	-------------------------------------	---	--

200.0 FT. HORIZ. SCALE  
20.0 FT. VERT. SCALE

REV	DESCRIPTION	DRWN	DSGN	APPD	DATE	REV	DESCRIPTION	DRWN	DSGN	APPD	DATE
1	MOVED STR 395 BK 10 FEET, ISSUE FOR BID	CDB	CDB	DAM	10/22/09						
2	ISSUED FOR CONSTRUCTION	CDB	CDB	DAM	02/03/10						
3	MODIFIED CROSSING TEXT AND MILE INFORMATION	CDB	CDB	DAM	03/11/10						
4	AS-BUILT	CDB	CDB	DAM	03/07/11						

DESIGN INFORMATION					
CONDUCTOR	SIZE	STRINGING TENSION	NEC TENSION	DESIGN R.S.	ACTUAL R.S.
	1272 MCM 45/7 ACSR	6501	12617	800	832
	OPGW	AC-71/571	2248	5660	706

DESIGN BY:	DAM/CDB	10/12/09
DRAWN BY:	CDB	10/12/09
DESIGN CHK:	MBN ENGRG.	01/08/10
DRAFT CHK:		
APPROVED:	DAM	10/12/09

FACILITY:	TRANSMISSION SYSTEM MAINTENANCE
LOCATION UNIT:	296-230KV LINE-WILLISTON SUBSTATION TO TIOGA SUBSTATION
WILLISTON TO TIOGA 230KV TRANSMISSION LINE	
PLAN AND PROFILE	
MILE 59 & 60	

 BASIN ELECTRIC POWER COOPERATIVE 1717 EAST INTERSTATE AVENUE BISMARCK, NORTH DAKOTA PHONE 701-223-0441	COUNTY NAME:	MOUNTAIN	
	SCALE:	AS SHOWN	
BASIN DRAWING NO.	296-090-T3-061	REV.	4