

STATE OF NORTH DAKOTA  
PUBLIC SERVICE COMMISSION

Otter Tail Corporation  
230 kV Transmission Lin Reroute  
Richland County  
Siting Application

Case No. PU-07-766

**AFFIDAVIT OF SERVICE BY ORDINARY MAIL & ELECTRONIC MAIL**

STATE OF NORTH DAKOTA  
COUNTY OF BURLEIGH

**Claire Tipton** deposes and says that:

she is over the age of 18 years and not a party to this action and, on the **19<sup>th</sup> day of February, 2008**, she deposited in the United States Mail, Bismarck, North Dakota, **37** envelopes by first class mail, fully prepaid, securely sealed and each containing a photocopy and **32** electronic mails electronically sent a copy of:

Notice of Filing and Notice of Opportunity for Hearing

The envelopes and electronic mails respectively were addressed as follows:

See attached list.

Each post office address shown is the respective addressee's last reasonably ascertainable post office address and each email address is the respective addressee's last reasonably ascertainable electronic mailing address.

  
\_\_\_\_\_

Subscribed and sworn to before me  
this **19<sup>th</sup> day of February, 2008**.

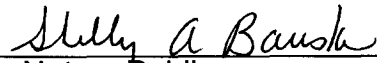
  
\_\_\_\_\_  
Notary Public

SEAL

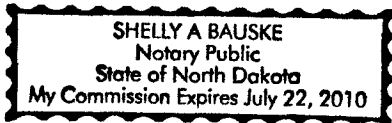

[mweninge@pioneer.state.nd.us](mailto:mweninge@pioneer.state.nd.us)  
Melinda Weninger  
Aeronautics Commission  
PO Box 5020  
Bismarck ND 58502-5020

[rharper@bepc.com](mailto:rharper@bepc.com)  
Ron Harper  
Basin Electric Power Coop  
1717 E Interstate Ave  
Bismarck ND 58501-0564

[carp1091@qwest.net](mailto:carp1091@qwest.net)  
Robert Colton  
Carpenters Union  
217 S Mandan St  
Bismarck ND 58504-5516

[jmittleider@nd.gov](mailto:jmittleider@nd.gov)  
John Mittleider  
Department of Commerce  
600 East Blvd  
Bismarck ND 58505

[brbjella@flecklaw.com](mailto:brbjella@flecklaw.com)  
Brian Bjella  
Fleck Mather & Strutz, Ltd.  
PO Box 2798  
Bismarck ND 58502-2798

[tgrove@greenergy.com](mailto:tgrove@greenergy.com)  
Terry Grove  
Great River Energy  
P O Box 800  
Elk River MN 55330-0800

[nlange@iwla.org](mailto:nlange@iwla.org)  
Nancy Lange  
Izaak Walton League of America  
1619 Dayton Ave Ste 202  
St Paul MN 55104

[sanditabor@lignite.com](mailto:sanditabor@lignite.com)  
Sandi Tabor  
Lignite Energy Council  
PO Box 2277  
Bismarck ND 58502-2277

[dloer@minnkota.com](mailto:dloer@minnkota.com)  
David W. Loer  
Minnkota Power Cooperative, Inc  
Box 13200  
Grand Forks ND 58208-3200

[jpaczkowski@state.nd.us](mailto:jpaczkowski@state.nd.us)  
John Paczkowski  
N D Water Commission  
900 E Boulevard  
Bismarck ND 58505

[apbismarck@ap.org](mailto:apbismarck@ap.org)  
Phyllis Mensing  
Associated Press  
PO Box 1018  
Bismarck ND 58502-1018

[colson@bepc.com](mailto:colson@bepc.com)  
Clare Olson  
Basin Electric Power Coop  
1717 E Interstate Ave  
Bismarck ND 58501-0564

[dscheurer@bepc.com](mailto:dscheurer@bepc.com)  
Duane Scheurer  
Dakota Gasification Company

[jwmorris@flecklaw.com](mailto:jwmorris@flecklaw.com)  
John Morrison  
Fleck Mather & Strutz, Ltd.  
PO Box 2798  
Bismarck ND 58502-2798

[dsaggau@GREnergy.com](mailto:dsaggau@GREnergy.com)  
Davic Saggau  
Great River Energy  
P O Box 800  
Elk River MN 55330-0800

[kander@ictc.com](mailto:kander@ictc.com)  
Keith Anderson  
Inter-Community Telephone Company LLC  
PO Box 8  
Nome ND 58062-0008

[jdwyer@lignite.com](mailto:jdwyer@lignite.com)  
John Dwyer  
Lignite Energy Council  
PO Box 2277  
Bismarck ND 58502-2277

[mds@willistonbasin.com](mailto:mds@willistonbasin.com)  
Mary Bluemle  
Minerals Diversified Services  
PO Box 2256  
Bismarck ND 58501-2256

[ronness@ndoil.org](mailto:ronness@ndoil.org)  
N D Petroleum Council  
PO Box 1395  
Bismarck ND 58502-1395

[tsteinwa@nd.gov](mailto:tsteinwa@nd.gov)  
MR TERRY STEINWAND  
ND GAME & FISH DEPT  
INSIDE MAIL

carla.deutsch@thomson.com  
Carla Deutsch  
Netscan

julie.tessier@thomson.com  
Julie Tessier  
Netscan

jim.melchior@coteau.com  
Jim Melchior  
North American Coal Corp  
2000 Schafer St Ste D  
Bismarck ND 58501-1204

asap@bis.midco.net  
Allyn Sapa  
North Dakota Chapter of the Wildlife Society  
PO Box 1442  
Bismarck ND 58505-0480

pat@ndta.net  
Patricia Gisinger  
North Dakota Telephone Assoc  
PO Box 2614  
Bismarck ND 58502-2614

beth\_jensen@transcanada.com  
Beth Jensen  
Northern Border Pipeline Company  
PO Box 3330  
Omaha NE 68103-0330

dloer@minnkota.com  
David Loer  
Square Butte Elec Coop  
PO Box 13200  
Grand Forks ND 58208-3200

john.irby@bismarcktribune.com  
John Irby, Editor  
The Bismarck Tribune  
PO Box 5516  
Bismarck ND 58502-5516

kjvannin@usgs.gov  
K Vannin  
U S Geological Survey

news@wdaz.com

WDAZ-TV  
PO Box 12639  
Grand Forks ND 58208-2639

keith.tiggelaar@wbip.com  
Keith Tiggelaar  
Williston Basin Interstate Pplne Co  
P O Box 5601  
Bismarck ND 58506-5601

mark.nisbet@xcelenergy.com  
Mark Nisbet  
Xcel Energy  
PO Box 2747  
Fargo ND 58108-2747

Stanley Wright  
Box 97  
Stanley ND 58784-0097

Mike Hummel  
BNI Coal, Ltd.  
PO Box 897  
Bismarck ND 58502-0897

Bob Fogarty  
Cenex Minot Terminal  
Box 429  
Minot ND 58701-0429

Laurie Baranko  
Dakota Resource Council  
PO Box 1095  
Dickinson ND 58602-1095

Gene Hysjulien  
Department of Human Services  
State Capitol  
Bismarck ND 58505

J Williams  
Dome Pipeline Corporation  
2959 Sierra Ct SW  
Iowa City IA 52246

Rick Larson  
Energy Development Impact Office  
1707 N 9th St  
Bismarck ND 58501

John Hoeven  
Governor's Office  
State Capitol  
Bismarck ND 58505

Indian Affairs Commission  
State Capitol  
Bismarck ND 58505

Bruce Imsdahl  
Montana-Dakota Utilities Co  
400 N 4th St  
Bismarck ND 58501

Roger Johnson  
Agriculture Department  
State Capitol  
Bismarck ND 58505

Arvid Barstad  
Cementing Service  
710 W 15th St  
Williston ND 58801

Will Kaul  
Cooperative Power Association  
P O Box 800  
Elk River MN 55330-0800

Department of Commerce  
1600 E Century Ave Ste 20  
Bismarck ND 58503-0649

Dept of Career and Technical Education  
State Capitol  
Bismarck ND 58505

M A Maki  
Enbridge Pipeline (North Dakota) LLC  
119 N 25th St E  
Superior WI 54880-5247

Cathy Callahan  
Geo Resources Inc  
PO Box 1505  
Williston ND 58801-1505

Historical Society  
North Dakota Heritage Center  
Bismarck ND 58505

Harvey Ness  
Lignite Energy Council  
PO Box 2277  
Bismarck ND 58502-2277

Galen Anderson  
Nakota Company  
PO Box 1633  
Bismarck ND 58502-1633

Thomas Hanson  
ND Assoc of Soil Conservation Dist  
3310 University Drive  
Bismarck ND 58504-7564

Harlan Fuglesten  
ND Association of RECs  
PO Box 727  
Mandan ND 58554-0727

Francis G Ziegler, P.E.  
ND Department of Transportation  
State Highway Building  
Bismarck ND 58505

MR ED MURPHY  
ND GEOLOGICAL SURVEY  
INSIDE MAIL

ND Job Service  
P.O. Box 5507  
Bismarck ND 58506-5507

Lisa K Fair-McEvers  
ND Labor Dept  
600 E Blvd Ave

Mike Haupt  
ND Land Department  
1707 N 9th St  
Bismarck ND 58501

Doug Prchal  
North Dakota Parks & Rec  
1600 E Century Ave Ste 3  
Bismarck ND 58503-0649

Wayne Stenehjem  
Office of Attorney General  
State Capitol  
Bismarck ND 58505

Plus OMB  
600 E. Boulevard Dept. 110  
Bismarck ND 58505-0406

Dale Frink  
State Engineer  
ND Water Commission 900 East Boulevard  
Bismarck ND 58505

State Health Department  
State Capitol  
Bismarck ND 58505

Janell Cole Capitol Reporter  
The Forum  
Inside Mail

Hala Bates  
Theodore Roosevelt National Park  
P O Box 7  
Medora ND 58645-0007

M Zschomler  
U S Fish & Wildlife  
3425 Miriam Ave  
Bismarck ND 58501-7926

Brian Morris  
Western Area Power Administration  
PO Box 1173  
Bismarck ND 58502-1173

John Castleberry  
Williston Basin Interstate Pplne Co  
P O Box 5601  
Bismarck ND 58506-5601

**STATE OF NORTH DAKOTA  
PUBLIC SERVICE COMMISSION**

**Otter Tail Corporation.  
230 kV Transmission Line Reroute  
Richland County  
Siting Application**

**Case No. PU-07-766**

**NOTICE OF FILING AND NOTICE OF OPPORTUNITY FOR HEARING**

**February 6, 2008**

On January 23, 2008, Otter Tail Corporation filed for a waiver of procedures and time schedules, requesting that the Commission waive the requirement of the filing of an application for a certificate of corridor compatibility and route permit and public hearing and forthwith issue a certificate and route permit authorizing the construction and relocation of approximately 0.64 miles of 230 kilovolt (kV) electric transmission line now located in water near Grass Lake in Richland County. Otter Tail asserts that the proposed reroute will produce only minimal adverse effects and that a demonstrable emergency exists that requires construction before the existing line structures can be damaged by spring ice flows. The proposed reroute is west and north of Lidgerwood in Sections 31 and 32 in Township 131 North (Dexter), Range 52 West and Section 5 in Township 130 North (Grant), Range 52 West as shown on the attached map.

The issues to be considered in this proceeding are:

1. Will the location, construction, and operation of the proposed transmission line produce minimal adverse effects on the environment and upon the welfare of the citizens of North Dakota?
2. Is the proposed transmission line compatible with the environmental preservation and the efficient use of resources?
3. Will the proposed transmission line reroute minimize adverse human and environmental impact while ensuring continuing system reliability and integrity and ensuring that energy needs are met and fulfilled in an orderly and timely fashion?
4. Is the proposed transmission line of such length, design, location, or purpose that it will produce minimal adverse effects so that procedures and time schedules may be waived?

5. Does a demonstrable emergency exist which requires immediate construction so that adherence to procedures and time schedules would jeopardize the utility's system?
6. Is it appropriate for the Commission to waive any procedures and time schedules as requested in the application?

Those interested are invited to comment on the application in writing. Persons desiring a hearing must file a written request identifying their interest in the proceeding and the reasons for requesting a hearing. Comments and requests for hearings must be received by **March 5, 2008**. If deemed appropriate, the Commission can determine the matter without a hearing.

For more information, contact the Public Service Commission, State Capitol, Bismarck, North Dakota 58505, 701-328-2400; or Relay North Dakota 1-800-366-6888 TTY. If you require any auxiliary aids or services, such as readers, signers, or braille materials please notify Illona A. Jeffcoat-Sacco, Executive Secretary, at least 24 hours prior to the hearing.

**PUBLIC SERVICE COMMISSION**

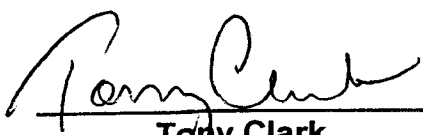
		
<b>Tony Clark</b> Commissioner	<b>Susan E. Wefald</b> President	<b>Kevin Cramer</b> Commissioner

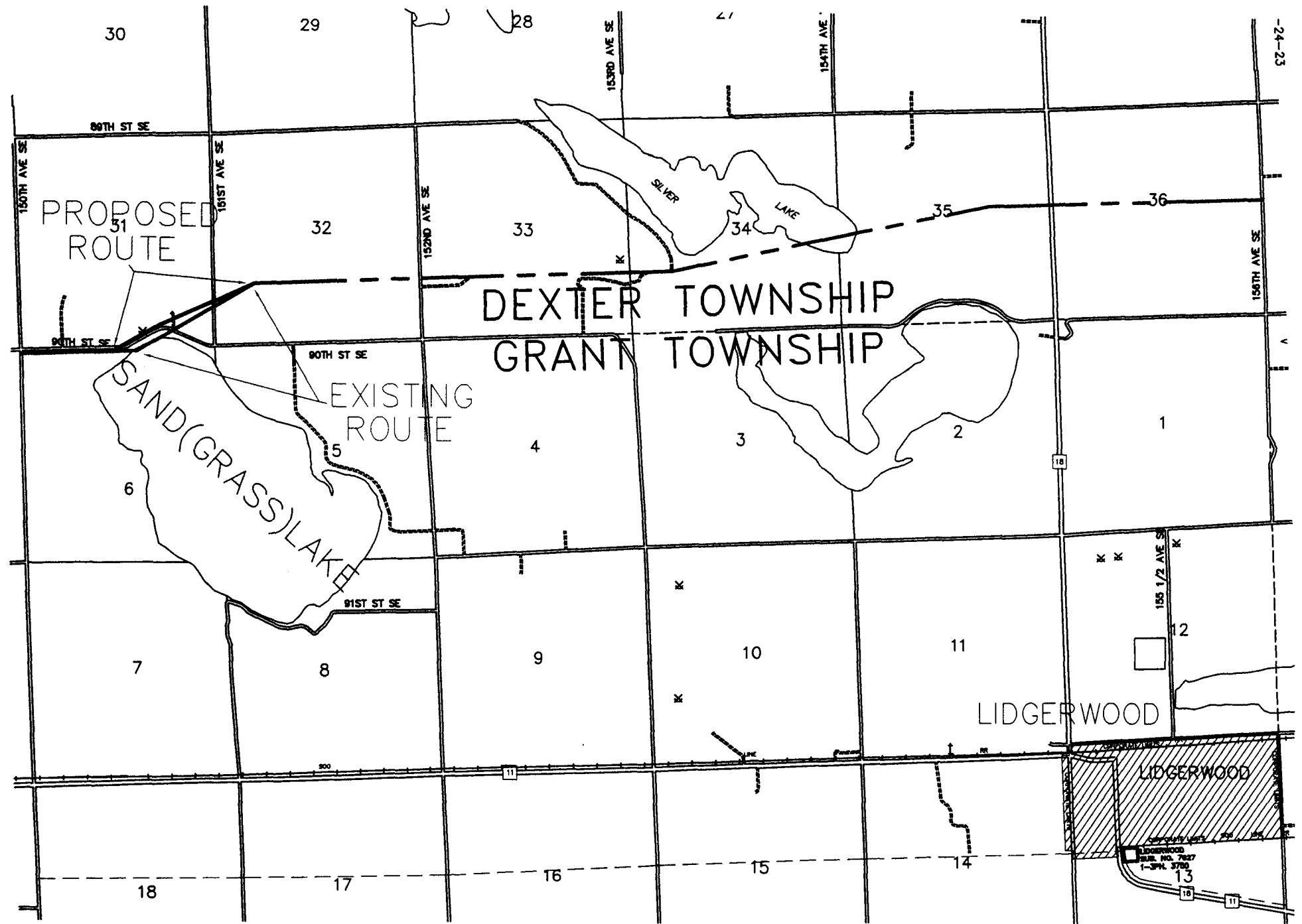

PROPOSED ROUTE

32

DEXTER TOWNSHIP  
GRANT TOWNSHIP

SAND (GRASS) LAKE

EXISTING ROUTE

LIDGERWOOD

LIDGERWOOD

LIDGERWOOD  
PLAT NO. 7827  
1-30-3780

30

29

28

27

-24-23

80TH ST SE

150TH AVE SE

161ST AVE SE

152ND AVE SE

153RD AVE SE

154TH AVE

155TH AVE SE

90TH ST SE

90TH ST SE

91ST ST SE

155 1/2 AVE SE

18

17

16

15

14

13

12

12

11

10

9

8

7

1

2

3

4

33

34

35

36

SILVER LAKE

32

6

5

