

**STATE OF NORTH DAKOTA
PUBLIC SERVICE COMMISSION**

**M-Power, LLC
Electric Generation/Wind-Griggs/Steele County
Siting Application**

Case No. PU-08-34

**M-Power, LLC
230 kV Transmission Line Barnes/Steele County
Siting Application**

Case No. PU-08-107

AFFIDAVIT OF SERVICE BY CERTIFIED MAIL

STATE OF NORTH DAKOTA
COUNTY OF BURLEIGH

Janet Marquart deposes and says that:

she is over the age of 18 years and not a party to this action and, on the **25th day of June, 2008**, she deposited in the United States Mail, at Bismarck, North Dakota, **two** envelopes with certified postage, return receipt requested, fully prepaid, securely sealed and each containing a photocopy of:

14 PU-08-107 Filed: 6/25/2008 Pages: 4
Affidavit Certified - Notice of Filings, Hearings

Notice of Filings and Notice of Hearings

Public Service Commission

The envelopes were addressed as follows:

Lawrence Bender
Fredrickson & Byron, PA
200 N 3rd St, Ste 150
Bismarck, ND 58501-3879

Warren Enyart, Secretary
M-Power, LLC
PO Box 335
Finley, ND 58230

Cert. No. 7008 0150 0003 3556 2476

Cert. No. 7008 0150 0003 3556 2469

Each address shown is the respective addressee's last reasonably ascertainable post office address.

Subscribed and sworn to before me
this **25th day of June, 2008**

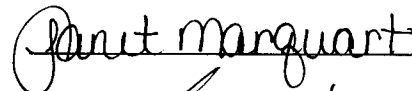



Notary Public

SEAL

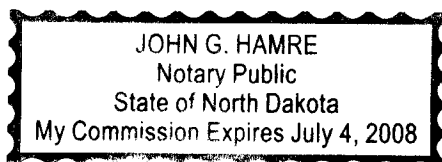

20 PU-08-34 Filed: 6/25/2008 Pages: 4
Affidavit Certified - Notice of Filings, Hearings

Public Service Commission

**STATE OF NORTH DAKOTA
PUBLIC SERVICE COMMISSION**

**M-Power, LLC
Electric Generation/Wind-Griggs/Steele County
Siting Application**

Case No. PU-08-34

**M-Power, LLC
230 kV Transmission Line Barnes/Steele County
Siting Application**

Case No. PU-08-107

NOTICE OF FILINGS AND NOTICE OF HEARINGS

June 19, 2008

On May 16, 2008, in Case No. PU-08-34, M-Power, LLC filed an application for a waiver or reduction of certain procedures and time schedules and a certificate of site compatibility to authorize construction of a 157.5 MW Laverne Wind Farm in Griggs and Steele Counties of North Dakota as shown on the attached map. The Commission finds the application is complete.

On May 21, 2008, in Case No. PU-08-107, M-Power, LLC filed an application for a waiver or reduction of procedures and time schedules and a consolidated application for a certificate of corridor compatibility and route permit to authorize construction of approximately 13 miles of 230 kV electric transmission line and associated facilities extending from the proposed Lavern Wind Farm in Steele County to an interconnection to be established near Pillsbury in Barnes County, North Dakota. The proposed transmission line corridor and route are shown on the attached map. The Commission finds the applications are complete conditioned on M-Power, LLC filing a map detailing proposed final transmission line structure locations on or before July 21, 2008.

M-Power, LLC requests the Commission waive or reduce procedures and time schedules set forth in North Dakota Century Code chapter 49-22 and North Dakota Administrative Code article 69-06 to allow for a single consolidated application for corridor certificate and route permit and hold one consolidated hearing on the waiver request and application for corridor certificate and route permit.

A Public Hearing on the application for a waiver and consolidated application for transmission line corridor and route filed in Case No. PU-08-107 is scheduled to begin **July 28, 2008 at 10:00 a.m. CDT in the Cooperstown Country Club, 305 Fairway Drive, Cooperstown, ND 58425.**

A Public Hearing on the application for a certificate of site compatibility filed in Case No. PU-08-34 is scheduled to begin **July 28, 2008 at 11:30 a.m. CDT in the Cooperstown Country Club, 305 Fairway Drive, Cooperstown, ND 58425.**

The issues to be considered in these proceedings are:

1. Will the location, construction, and operation of the proposed facilities produce minimal adverse effects on the environment and upon the welfare of the citizens of North Dakota?
2. Are the proposed facilities compatible with the environmental preservation and the efficient use of resources?
3. Will the proposed facility locations minimize adverse human and environmental impact while ensuring continuing system reliability and integrity and ensuring that energy needs are met and fulfilled in an orderly and timely fashion?
4. Is it appropriate for the Commission to waive procedures and time schedules as requested, including the request for a single consolidated application for corridor certificate and route permit?

For more information contact the Public Service Commission, State Capitol, Bismarck, North Dakota 58505, 701-328-2400; or Relay North Dakota 1-800-366-6888 TTY. If you require any auxiliary aids or services, such as readers, signers, or braille materials please notify Illona A. Jeffcoat-Sacco, Executive Director, at least 24 hours in advance.

PUBLIC SERVICE COMMISSION

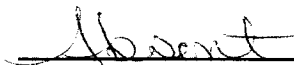

**Tony Clark
Commissioner**



**Susan E. Wefald
President**



**Kevin Cramer
Commissioner**

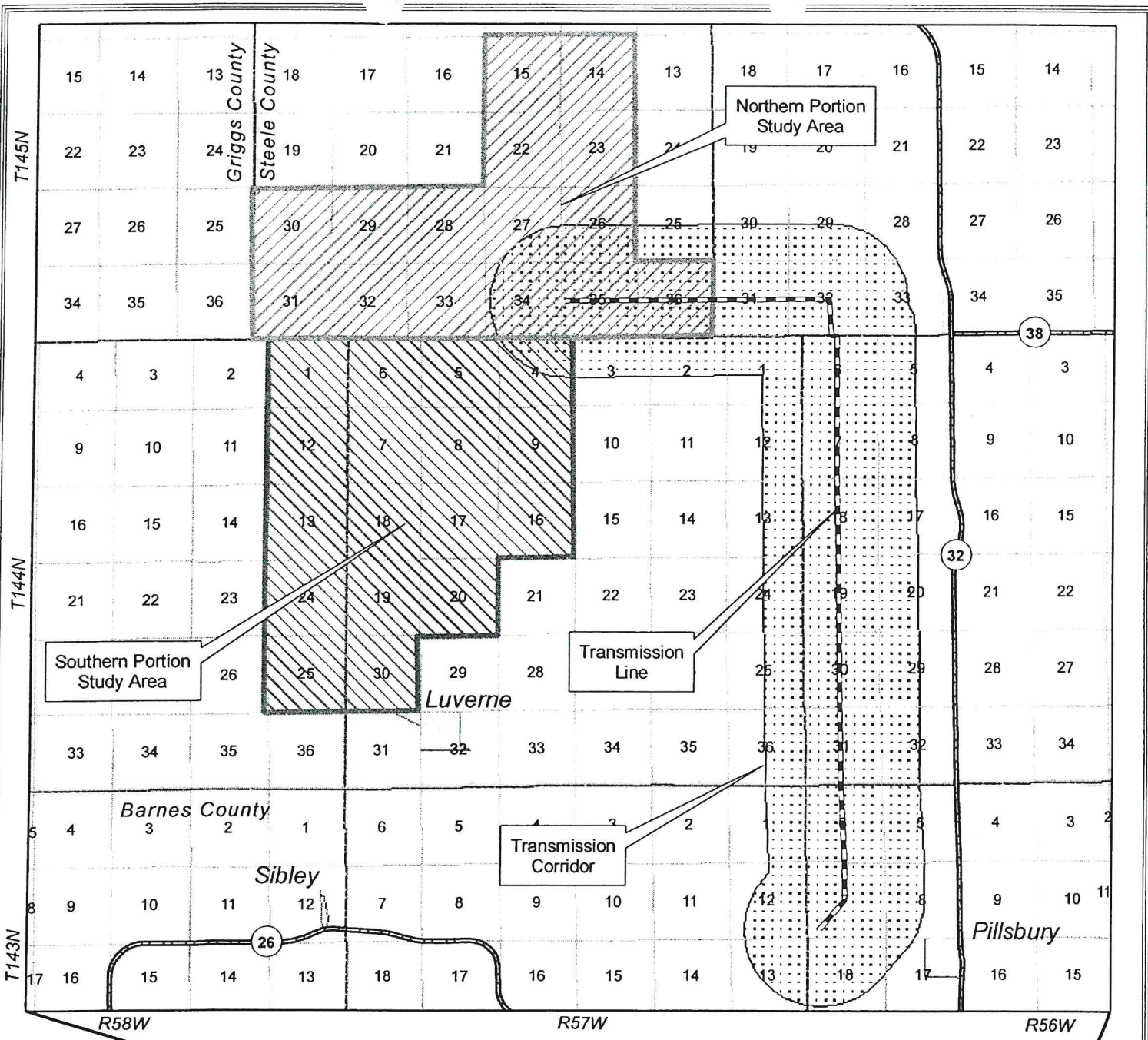

*Luverne Wind Farm
M-Power, LLC
&
National Wind, LLC*

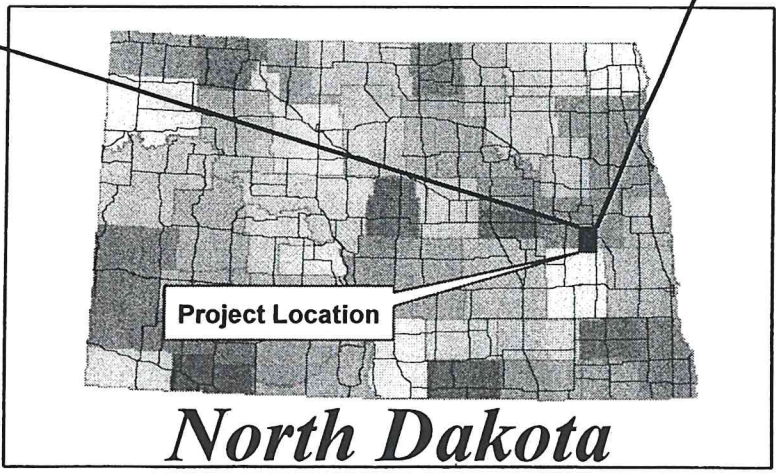

North Dakota

