

November 4, 2015

Jerry Lein, Public Utility Analyst
North Dakota Public Service Commission
600 East Boulevard Avenue, Dept. 408
Bismarck, ND 58505



Dear Mr. Lien:

Referenced is your letter dated September 18, 2015, received by Basin Electric on September 23, 2015, regarding North Dakota PSC Case Nos. PU-07-169, PU-07-671, and PU-08-75. Specifically, your letter provides a list of actions recommended in post-inspection reports for follow-up to confirm compliance with the listed commission orders. The information requests are enumerated below, with responses in ***bold italics*** immediately following.

1. PU-07-169. Written documentation that noxious weed and vegetation monitoring have occurred in accordance with the application. (Order Point 13).
Surveys/inspections of right-of-way vegetation and for noxious weeds were conducted by Basin Electric staff during October 2011, October 2012, and October 2013. No issues were identified and no additional reclamation work was recommended.
2. PU-07-169. Tree and Shrub Mitigation Specification No. 17 requires a survival rate of 75 percent after three years and if the survival rate is less than 75 percent, the Commission may order additional planting(s). ***The tree and shrub plantings were completed in spring 2011 with tree and shrub survival rate reports sent to the PSC fall of 2011 and fall of 2012. The fall 2012 report observed survival rates of approximately 92%. Additional surveys must be completed to establish a survival rate of 75%, however. Basin Electric will complete this work during the 2016 growing season.***
3. PU-07-169. Final as-built drawings for both substations and microwave towers. (Order Point 19) ***As-built drawings for the Rhame Substation, East Rainey Butte and Rhame Microwave Towers are attached. The Northern terminus of the transmission line is the existing Belfield Substation, which is owned and operated by Western Area Power Administration.***

- 97 PU-08-75 Filed 11/05/2015 Pages: 8
Response to Sept. 18, 2015 letter re post construction inspection report
- 119 PU-07-671 Filed 11/05/2015 Pages: 8
Response to Sept. 18, 2015 letter re post construction inspection report
- 120 PU-07-169 Filed 11/05/2015 Pages: 8
Response to Sept. 18, 2015 letter re post construction inspection report
Basin Electric Power Cooperative

November 4, 2015

Page 2

4. PU-07-671. Written documentation that noxious weed and vegetation monitoring have occurred in accordance with the application. (Order Point 14).
Surveys/inspections of right-of-way vegetation and for noxious weeds were conducted by Basin Electric staff November 2011, November 2012, November 2013, July through November 2014, and October 2015. The transmission line right-of-way shows no evidence of noxious weeds; right-of-way vegetation is doing well and no additional reclamation was recommended.

5. PU-08-75. Tree and Shrub Mitigation Specification No. 17 requires a survival rate of 75 percent after three years. ***The Tree and Shrub Survival Rate Report for 2015 was submitted to the PSC on October 30, 2015, indicating a current survival rate of approximately 88%. The final (third year) tree and shrub inventory and survival rate report is scheduled for completion during 2016.***

If you have any questions, comments or concerns regarding this letter or the enclosures, please contact me at 701.557.5495.

Sincerely,

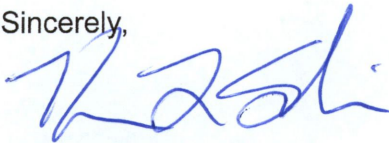

Kevin L. Solie. P.E.
Environmental Administrator

/ser

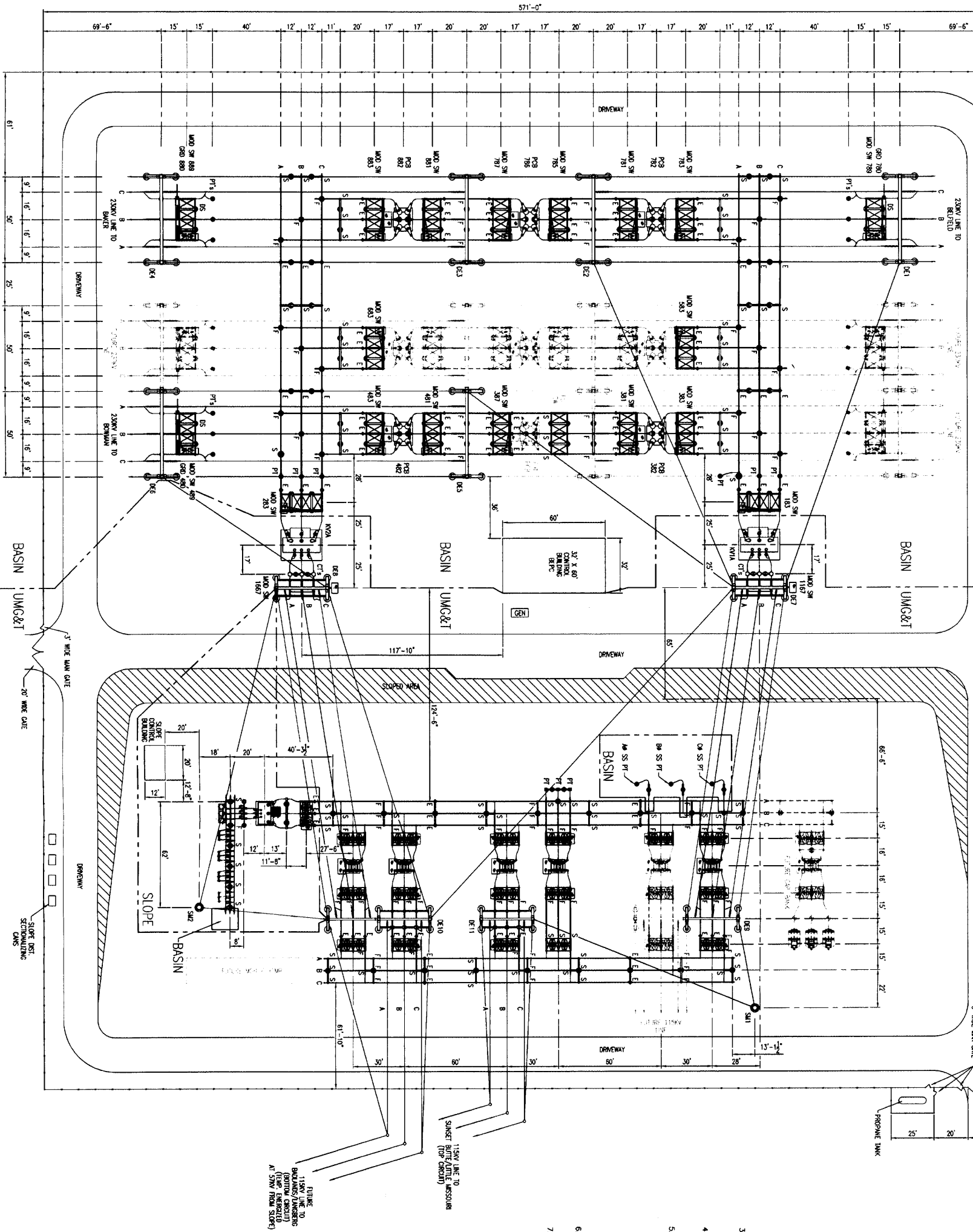

571'-0"

REV	DESCRIPTION	DATE	DWN	APP	DPR
A	ISSUED FOR CONSTRUCTION, FINAL	09/22/09	HY	APPR	DPR

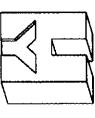
**HAMBLY
YOUNG**
 1245 DANNER DRIVE AURORA, OHIO 44202 (330) 562-8444 FAX (330)

- 6. P.L.A. BUS
- 7. P.L.A. BUS
- 5. WTT
- 4. OXID. DIS.
- 3. ST/ELE OR
- 2. ST/ELE OR
- 1. A. B. C. D. E. F. G. H. I. J. K. L. M. N. O. P. Q. R. S. T. U. V. W. X. Y. Z.



SCALE 1" = 200'

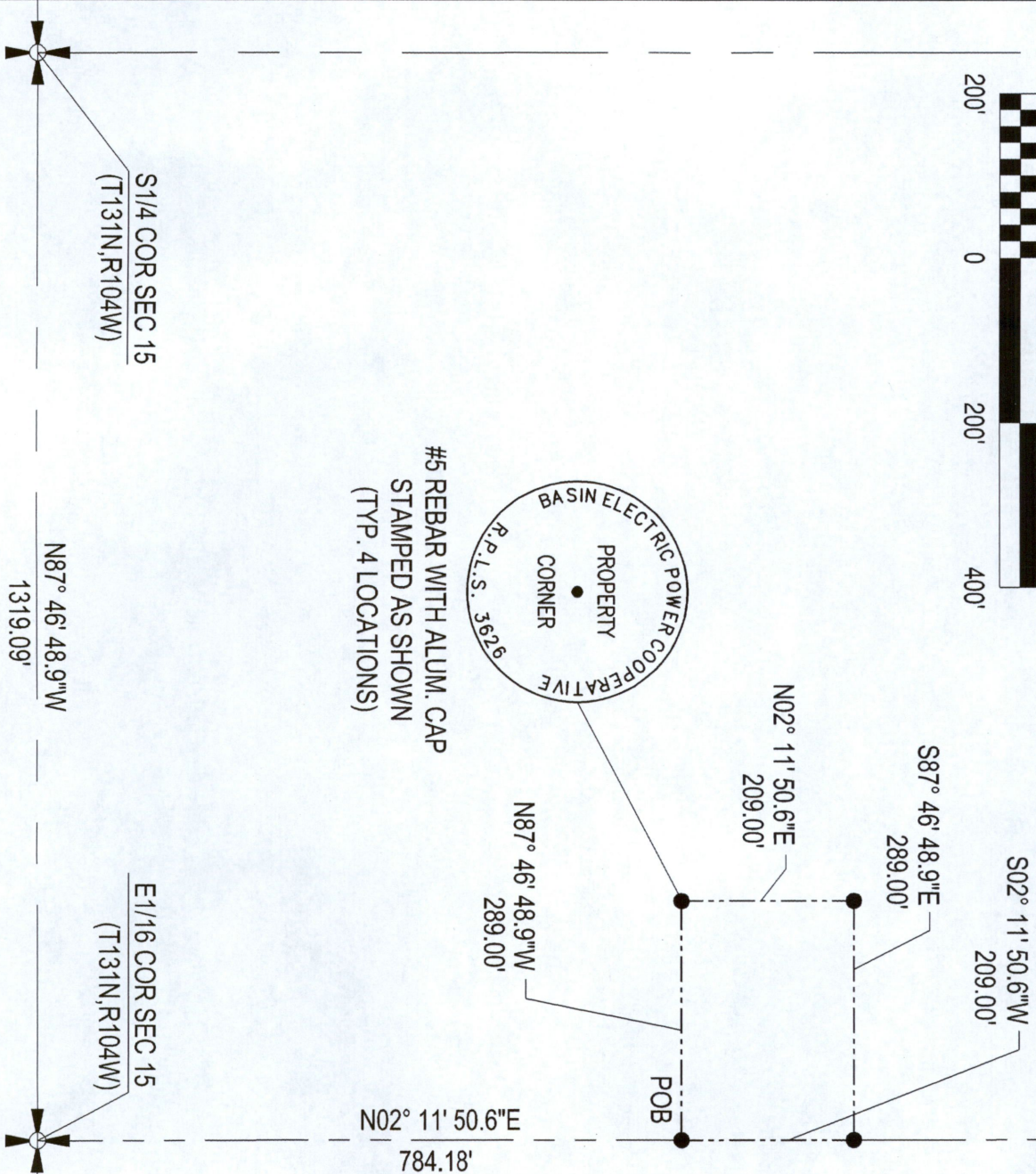
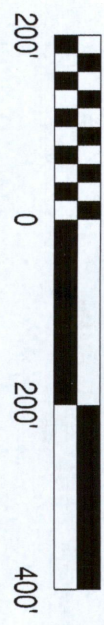

#5 REBAR WITH ALUM. CAP
STAMPED AS SHOWN
(TYP. 4 LOCATIONS)

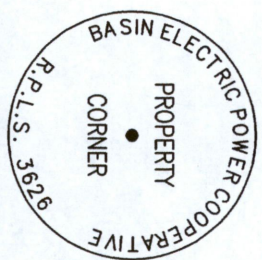

THIS DOCUMENT ORIGINALLY ISSUED AND SEALED BY MATT W. WEEKS,
LS NO. 3626 ND IS STORED AT BASIN ELECTRIC ENGINEERING
HEADQUARTERS, FIRST FLOOR FLAT FILES. THIS MEDIA SHOULD NOT BE
CONSIDERED A CERTIFIED DOCUMENT.

COMMENCING AT THE SOUTH EAST CORNER OF THE W1/2 OF THE SE1/4 OF SAID
SAID W1/2 OF THE SE1/4 A DISTANCE OF 784.18 FEET TO THE POINT OF BEGINNING
W1/2 OF THE SE1/4 A DISTANCE OF 289.00 FEET TO A POINT; THENCE N02° 11' 50
DISTANCE OF 209.00 FEET TO A POINT; THENCE S87° 46' 48.9"E PARALLEL TO THE
FEET TO THE EAST LINE OF SAID W1/2 OF THE SE1/4; THENCE S02° 11' 50.6"W A
209.00 FEET TO THE POINT OF BEGINNING.

SAID DESCRIBED PARCEL CONTAINS 1.387 ACRES MORE OR LESS.

BEARINGS ARE BASED ON ND STATE PLANE NAD 83 SOUTH ZONE (3302) DISTAN

SURVEYOR'S CERTIFICATE

I, MATTHEW L. WEEKS, A REGISTERED LAND SURVEYOR IN THE STATE OF NORTH
DAKOTA, CERTIFY THAT THIS SURVEY, PLAN OR REPORT WAS PREPARED BY ME OR UNDER
MY SUPERVISION AND THE INFORMATION PRESENTED HERE IS TRUE AND CORRECT
TO THE BEST OF MY KNOWLEDGE AND BELIEF. ANY ALTERATION OF THIS DOCUMENT WILL VOID
THIS CERTIFICATE.

MATTHEW L. WEEKS, R.L.S. 3626
BASIN ELECTRIC POWER COOPERATIVE
1717 EAST INTERSTATE AVENUE
BISMARCK, ND 58503

STATE OF NORTH DAKOTA } S.S.
COUNTY OF _____ }

I, _____, A
WITHIN AND FOR SAID COUNTY, DO HEREBY CERTIFY THAT ON THIS ____ DAY OF ____
A.D., 20____, PERSONALLY APPEARED BEFORE ME
TO ME WELL KNOWN TO BE THE SAME PERSON
IN AND WHO EXECUTED THE WITHIN AND FOREGOING INSTRUMENT AND ACKNOWLEDGE
SAME FREELY AND VOLUNTARILY.
MY COMMISSION EXPIRES ____ 20____ NOTARY PUBLIC, ____ COUNTY

REV.	DESCRIPTION	DRWN	DSGN	APPD	DATE

FACILITY: TELECOM
 LOCATION/UNIT: 190
 CONTRACT/DESIGNATION: _____

PROPERTY
 RHAME MICF

BASIN POWER
 A Touchstone

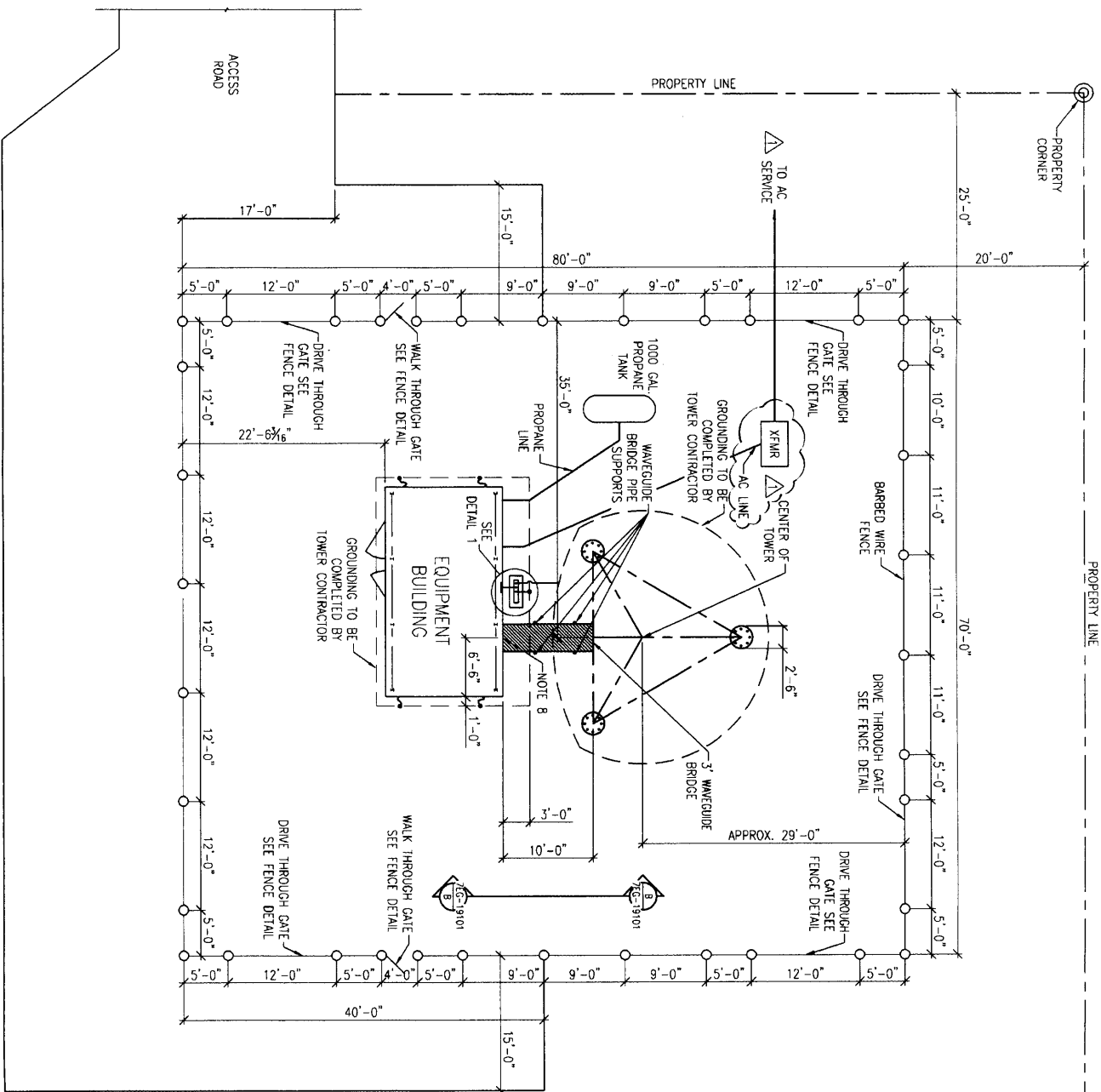

SITE LAYOUT
SCALE: 1/8"=1'-0"

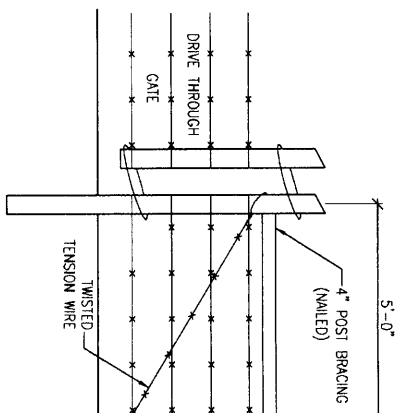
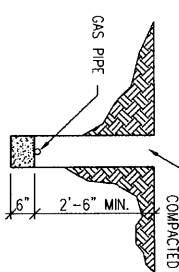
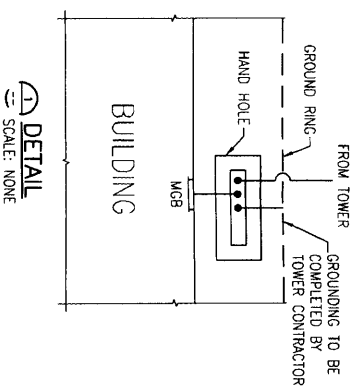
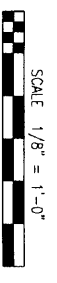

REV.	DESCRIPTION	BY	DATE
1	ADD AC SERVICE LINE & XTMR	A. DAVIS J. SHELDON	10/6/08
0B	REVISE FENCE, DETAIL 1 & NOTES	A. DAVIS J. SHELDON	7/22/08
0A	REVISE FENCE, DETAILS & WAVEGUIDE ICE BRIDGE	A. DAVIS J. SHELDON	4/2/09

REFERENCE DRAWINGS

- BASIN DRAWING NBR:
- 7CA-19103 WAVEGUIDE BRIDGE ATTACHMENT
- 7EG-19101 SITE GROUNDING DETAILS
- 7SC-19101 BUILDING FOUNDATION PLAN AND SEC

