

R 70W

R 69W

MANITOBA, CANADA

R 68W

NORTH DAKOTA, USA

T164N

T163N

T162N

Legend

- Project Boundary
 - County Boundary
 - PLS Township Boundary
 - PLS Section Boundary
 - State Highway
 - County Roads
 - Transmission Line
- Proposed Layout**
- Proposed Turbine
 - Alternate Turbine
 - Proposed Road
 - Alternate Road
 - Proposed Cable
 - Alternate Cable
 - Meteorological Tower
 - Proposed Substation and Interconnection
 - Proposed Construction Yard and O&M Facility
- Avoidance Areas**
- Municipality
 - Woodland and Shelter Belt
 - Watercourses
 - Wetlands
- Exclusion Areas**
- Airport Height Limitation: Prohibits structures, on average, over 372 feet tall
 - Cultural Resources (Historic and Archaeological Sites)
 - North Dakota State Land Department
- Rare and Unique Natural Features**
- Aspen Woodland
 - Calcareous Fen
 - Tallgrass Prairie
 - Few-flowered Spikerush
 - Indianpipe
 - Sheathed Pondweed
 - Chestnut-sided Warbler
- Other Areas**
- Conservation Reserve Program
 - USFWS Wetland Easement
 - Potential Prairie

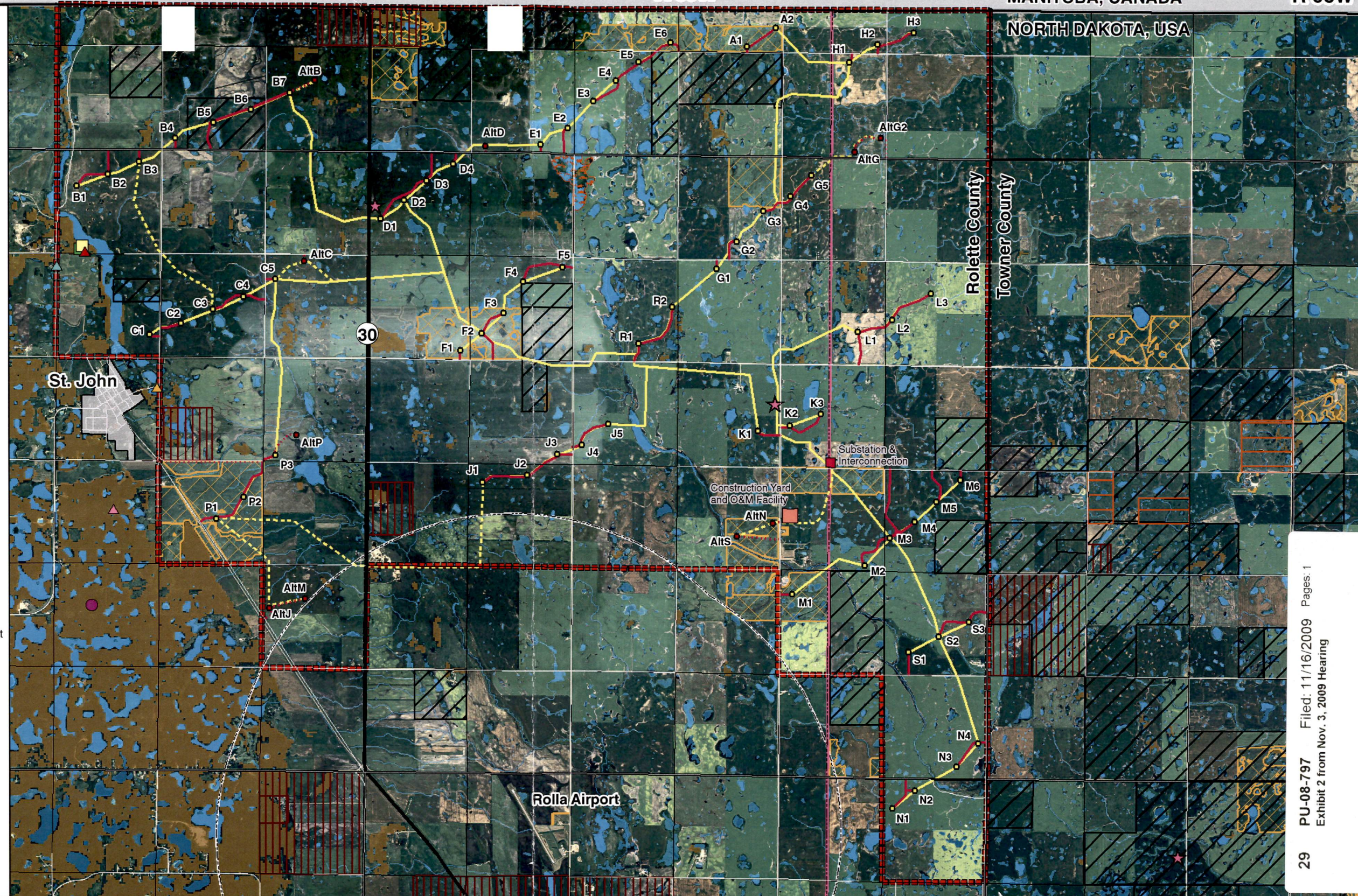

Data Source(s): 2005 USDA-FSA- APFO Digital Ortho Mosaic (2006); U.S. Department of Agriculture, Farm Service Agency (2008); US Fish and Wildlife Service (2008); Province Boundaries, ESRI Data (2005-2008); Muni Boundaries, NDDOT (2008); North Dakota Geologic Survey US PLS System (1994); Roads, NDDOT (2008); Airport Zone Map, Rolla Airport Zoning Board (2006); County Boundaries, North Dakota State Water Commission (2002); North Dakota Natural Heritage Inventory, North Dakota Parks and Recreation Department (2008); Westwood (2009); Sequoia Energy (2009); North Dakota State Land, ND Land Department (2002); USFWS Waterfowl Production Boundaries and USFWS Wetland Easement Boundaries, Dave Bolin and J. Clark Slayter WMD (2007); Conservation Reserve Program, USDA-FSA North Dakota State Office (2006); Woodland and Shelter Belt Area from USFWS, Refuges & Wildlife, Region 6 (2001); National Hydrography Dataset (NHD), USGS, US EPA, USDA Forest Service and other partners (various dates); USFWS, National Wetland Inventory (various dates).

Westwood Professional Services, Inc.
 7699 Anagram Drive
 Eden Prairie, MN 55344

PHONE 952-937-5150
 FAX 952-937-5822
 TOLL FREE 1-888-937-5150

www.westwoodps.com



Border Winds Energy Project

Rolette County, North Dakota

Final Project Layout with Exclusion and Avoidance Areas

29 PU-08-797 Filed: 11/16/2009 Pages: 1
 Exhibit 2 from Nov. 3, 2009 Hearing

Office of Administrative Hearings

EXHIBIT 2