

STATE OF NORTH DAKOTA
PUBLIC SERVICE COMMISSION

Enbridge Pipelines (North Dakota) LLC
Stanley Pump Station Upgrades
Siting Application

Case No. PU-08-812

AFFIDAVIT OF SERVICE BY EMAIL

STATE OF NORTH DAKOTA
COUNTY OF BURLEIGH

Shelly A. Bauske deposes and says that:

she is over the age of 18 years and not a party to this action and, on the 28th day of **October, 2008**, she deposited in the United States Mail, Bismarck, North Dakota, 21 electronic mail messages, each with an attached electronic copy of:

Notice of Filing and Notice of Opportunity for Hearing

The electronic mails were addressed as follows:

See attached list.

Each email address is the respective addressee's last reasonably ascertainable electronic mailing address.

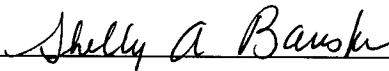

Subscribed and sworn to before me
this 28th day of **October, 2008**.



Notary Public

SEAL

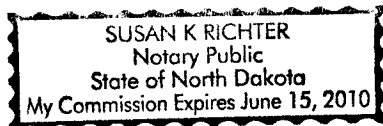

ndaero@nd.gov
Melinda Weninger
Aeronautics Commission
PO Box 5020
Bismarck ND 58502-5020

jmittleider@nd.gov
John Mittleider
Department of Commerce
600 East Blvd
Bismarck ND 58505

jwmorris@flecklaw.com
John Morrison
Fleck Mather & Strutz, Ltd.
PO Box 2798
Bismarck ND 58502-2798

tgrove@greenergy.com
Terry Grove
Great River Energy
P O Box 800
Elk River MN 55330-0800

sanditabor@lignite.com
Sandi Tabor
Lignite Energy Council
PO Box 2277
Bismarck ND 58502-2277

dloer@minnkota.com
David W. Loer
Minnkota Power Cooperative, Inc
Box 13200
Grand Forks ND 58208-3200

tsteinwa@nd.gov
MR TERRY STEINWAND
ND GAME & FISH DEPT
INSIDE MAIL

carla.deutsch@thomson.com
Carla Deutsch
Netscan

beth_jensen@transcanada.com
Beth Jensen
Northern Border Pipeline Company
PO Box 3330
Omaha NE 68103-0330

kjvannin@usgs.gov
K Vannin
U S Geological Survey

apbismarck@ap.org
Phyllis Mensing
Associated Press
PO Box 1018
Bismarck ND 58502-1018

brbjella@flecklaw.com
Brian R. Bjella
Fleck Mather & Strutz, Ltd.
PO Box 2798
Bismarck ND 58502-2798

dsaggau@GREnergy.com
Davic Saggau
Great River Energy
P O Box 800
Elk River MN 55330-0800

nlange@iwla.org
Nancy Lange
Izaak Walton League of America
1619 Dayton Ave Ste 202
St Paul MN 55104

jdwyer@lignite.com
John Dwyer
Lignite Energy Council
PO Box 2277
Bismarck ND 58502-2277

jpaczkowski@state.nd.us
John Paczkowski
N D Water Commission
900 E Boulevard
Bismarck ND 58505

julie.tessier@thomson.com
Julie Tessier
Netscan

jim.melchior@coteau.com
Jim Melchior
North American Coal Corp
2000 Schafer St Ste D
Bismarck ND 58501-1204

john.irby@bismarcktribune.com
John Irby, Editor
The Bismarck Tribune
PO Box 5516
Bismarck ND 58502-5516

news@wdaz.com

WDAZ-TV
PO Box 12639
Grand Forks ND 58208-2639

keith.tiggelaar@wbip.com
Keith Tiggelaar
Williston Basin Interstate Pplne Co
P O Box 5601
Bismarck ND 58506-5601

STATE OF NORTH DAKOTA
PUBLIC SERVICE COMMISSION

**Enbridge Pipelines (North Dakota) LLC
Stanley Pump Station Upgrades
Siting Application**

Case No. PU-08-812

NOTICE OF FILING AND NOTICE OF OPPORTUNITY FOR HEARING

October 22, 2008

On October 13, 2008, Enbridge Pipelines (North Dakota) LLC (Enbridge) filed an application to amend existing corridor or route permits. Enbridge proposes to upgrade the existing Stanley Station in Mountrail County.

The Commission finds the application is complete.

Enbridge asserts that these pipeline facilities will produce minimal adverse effects and requests that the Commission (1) waive provisions of law and rule that require filing of separate applications, separate hearings and certain time schedules; (2) not hold a public hearing, but instead publish a notice of opportunity for hearing; (3) find that the proposed facilities are of such design, location and purpose that it will produce minimal adverse effects; and (4) issue the appropriate amended corridor certificates and amended route permits.

The issues to be considered in this proceeding are:

1. Will the location, construction, and operation of the proposed pipeline facilities produce minimal adverse effects on the environment and upon the welfare of the citizens of North Dakota?
2. Are the proposed pipeline facilities compatible with the environmental preservation and the efficient use of resources?
3. Will the proposed pipeline facilities locations minimize adverse human and environmental impact while ensuring continuing system reliability and integrity and ensuring that energy needs are met and fulfilled in an orderly and timely fashion?
4. Are the proposed pipeline facilities of such design, location, or purpose that they will produce minimal adverse effects so that procedures and time schedules may be waived?

5. Does a demonstrable emergency exist, which requires immediate construction so that adherence to procedures and time schedules would jeopardize the utility's system?
6. Is it appropriate for the Commission to waive any procedures and time schedules as requested in the application?

Those interested are invited to comment on the application in writing. Persons desiring a hearing must file a written request identifying their interest in the proceeding and the reasons for requesting a hearing. Comments and requests for hearings must be received by **December 3, 2008**. If deemed appropriate, the Commission can determine the matter without a hearing.

For more information contact the Public Service Commission, State Capitol, Bismarck, North Dakota 58505, 701-328-2400; or Relay North Dakota 1-800-366-6888 TTY. If you require any auxiliary aids or services, such as readers, signers, or Braille material please notify Darrell Nitschke, Executive Secretary, at least 24 hours in advance.

PUBLIC SERVICE COMMISSION



		
Tony Clark Commissioner	Susan E. Wefald President	Kevin Cramer Commissioner

Exhibit B.2

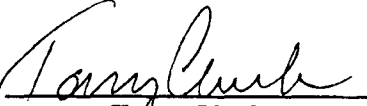

--- ENBRIDGE PROPERTY BOUNDARY
--- EXISTING ENBRIDGE PIPELINE

1 INCH = 2,000 FEET
SCALE = 1:24,000

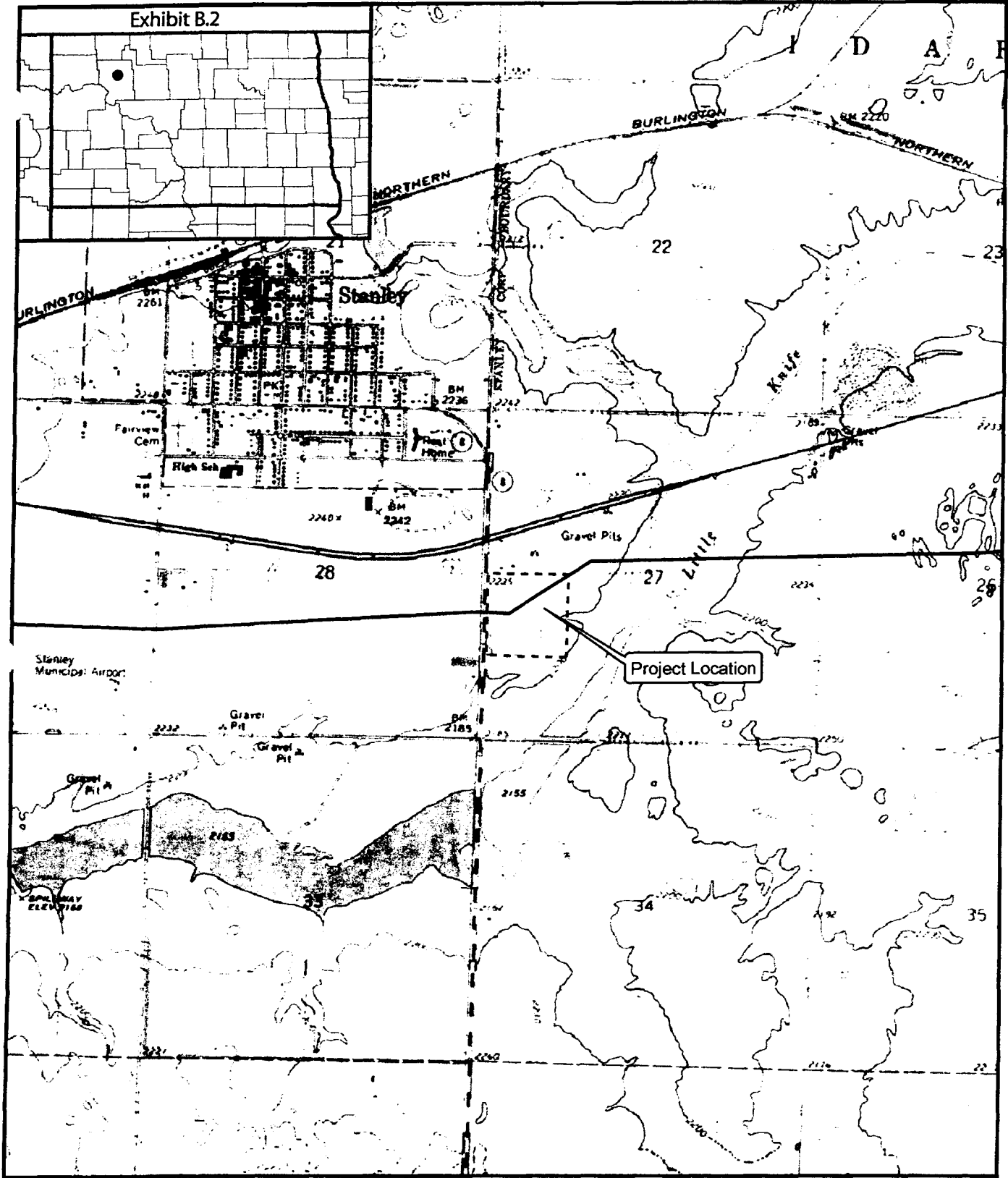
0 250 500 750 1,000 Meters
0 1,000 2,000 4,000 Feet

ENBRIDGE PIPELINES (NORTH DAKOTA) LLC
STANLEY STATION INJECTION UPGRADE PROJECT
Project Location Topographical Map
T156N, R91W, Section 27, Mountrail County, North Dakota