

**Robinson Lake:  
A Class III Cultural Resource Inventory  
for a Proposed Pipeline Corridor in  
Mountrail County, North Dakota**

NDSHPO #08-1277

Prepared for:  
Merjent, Inc.  
Minneapolis, Minnesota  
on behalf of Whiting Petroleum Company

Principal Investigator:  
Damita Hiemstra

Prepared by:  
Ed Stine and Aaron Barth  
Metcalf Archaeological Consultants, Inc.  
Bismarck, North Dakota

December 2008

## Abstract

Whiting Petroleum Company proposes to construct a 16.25 miles long oil pipeline between their Robinson Lake Processing Plant and the Enbridge Pipeline Stanley Pumping Station in Mountrail County, North Dakota. This oil pipeline will be located 45 feet east of a natural gas pipeline that the company constructed in the summer of 2008. Merjent, Inc., on behalf of Whiting Petroleum Company, contacted Metcalf Archaeological Consultants, Inc. to conduct a cultural resource inventory of the pipeline corridor and a block immediately east and south of the Enbridge Pumping Station. There is no federal support or licensing associated with the proposed project. The North Dakota Public Service Commission will review the Whiting Petroleum Company application for the pipeline permit.

The cultural resource inventory was conducted by Damita Hiemstra, serving as Principal Investigator, along with Aaron Barth, Brett Ewald, Ed Stine and Garrett Williams between September 24 and October 10, 2008. The inventory covered a corridor approximately 16.25 miles long and 120 feet wide located on either side of a natural gas pipeline that was constructed in the summer of 2008 (237 acres). The inventory corridor was 40 feet west of the existing natural gas pipeline center, and 80 feet east of the same. In addition a 240-acre block east and south of the Enbridge Pumping Station was inventoried resulting in a total of 477 acres of inventory.

The 240-acre block is located in T. 156N, R. 91W, Section 27 and the project corridor is located as follows:

- T. 153N, R. 91W, sections 2, 3, 10, 11 and 14
- T. 154N, R. 91W, sections 2, 11, 14, 23, 26 and 35
- T. 155N, R. 91W, sections 2, 11, 14, 23, 26 and 35
- T. 156N, R. 91W, sections 26 and 35.

The inventory resulted in the documentation of 17 sites, six isolated finds and the revisit of two previously documented sites. Construction of the natural gas pipeline impacted three sites, 32MN762, 32MN763 and 32MN764, that are potentially eligible for listing on the National Register of Historic Places. These sites will be avoided during construction of the oil pipeline. Table 1 provides a list of the cultural resources encountered during the inventory.

<b>Table 1: Robinson Lake Survey Sites</b>			
<b>Site #</b>	<b>Description/# of Features</b>	<b>NR Eligibility Recommendation</b>	<b>Treatment Recommendation</b>
32MN759	Road bed/1	No	No avoidance
32MN760	Historic/4	No	Avoid , Feature 2 possible grave
32MN761	Historic/2	No	No avoidance
32MN762	Pre-contact/5 and Historic/7	Undetermined	Avoid

<b>Table 1: Robinson Lake Survey Sites</b>			
<b>Site #</b>	<b>Description/# of Features</b>	<b>NR Eligibility Recommendation</b>	<b>Treatment Recommendation</b>
32MN763	Pre-contact Stone Circle/1	Undetermined	Avoid
32MN764	Pre-contact Stone Circles/3	Undetermined	Avoid, reroute surveyed
32MN765	Pre-contact Stone Circles/2	Undetermined	Avoid
32MN766	Historic Foundations/7	No	Avoid, Feature 2 possible grave
32MN767	Pre-contact Stone Circle/1	Undetermined	Avoid
32MN768	Pre-contact Stone Circle/1	Undetermined	Avoid
32MN769	Pre-contact Cairn/1	Undetermined	Avoid
32MN770	Pre-contact Stone Circle/1	Undetermined	Avoid
32MN771	Pre-contact Cairn/1	Undetermined	Avoid
32MN772	Pre-contact Stone Circles/4	Undetermined	Avoid
32MN773	Pre-contact Cairn/1	Undetermined	Avoid
32MN774	Historic Foundation/3	No	No avoidance
32MN775	Architectural Corral/1	No	No avoidance
32MN460	Pre-contact Stone Circles/4	Undetermined	Avoid
32MN461	Pre-contact Stone Circles/12	Undetermined	Avoid
32MNx12	Pre-contact isolate	No	No avoidance
32MNx385	Pre-contact isolate	No	No avoidance
32MNx459	Pre-contact isolate	No	No avoidance
32MNx541	Pre-contact isolate	No	No avoidance
32MNx543	Pre-contact isolate	No	No avoidance
32MNx544	Pre-contact isolate	No	No avoidance

The majority of the sites were encountered within the 240-acre block and have not been impacted by any construction. All of the National Register of Historic Places eligible/potentially eligible sites will be avoided by this project. Provided that these sites, as detailed in the above table, are avoided a finding of *No Adverse Affect* is recommended for the proposed undertaking.

## Table of Contents

Abstract .....	ii
List of Tables .....	v
List of Figures .....	v
Introduction .....	1
Project Location .....	1
Project Setting .....	3
Research Goals .....	3
Files Search .....	4
Field Methods .....	4
Results .....	5
32MN759 .....	7
32MN760 .....	8
32MN761 .....	10
32MN762 .....	12
32MN763 .....	15
32MN764 .....	17
32MN765 .....	18
32MN766 .....	20
32MN767 .....	22
32MN768 .....	23
32MN769 .....	23
32MN770 .....	23
32MN771 .....	24
32MN772 .....	25
32MN773 .....	26
32MN774 .....	27
32MN775 .....	29
32MN460 .....	32
32MN461 .....	34
32MNx12 .....	35
32MNx385 .....	35
32MNx459 .....	35
32MNx541 .....	36
32MNx543 .....	36
32MNx544 .....	36
Evaluation of Research .....	36
Summary and Recommendations .....	36
References Cited .....	39
Appendix A: Project Photographs .....	A-1
Appendix B: Project Maps .....	B-1
Appendix C: Files Search Results .....	C-1

## List of Tables

Table 1: Robinson Lake Survey Sites .....	ii, 5, 37
---	-----------

## List of Figures

Figure 1: Project location .....	2
Figure 2: Sketch map of site 32MN759 .....	7
Figure 3: Sketch map of site 32MN760 .....	9
Figure 4: Sketch map of site 32MN761 .....	10
Figure 5: Sketch map of site 32MN762 .....	13
Figure 6: Sketch map of site 32MN763 .....	16
Figure 7: Sketch map of site 32MN764 .....	17
Figure 8: Sketch map of site 32MN765 .....	19
Figure 9: Sketch map of site 32MN766 .....	20
Figure 10: Sketch map of site 32MN767, 32MN768 and 32MN769 .....	22
Figure 11: Sketch map of site 32MN770 .....	24
Figure 12: Sketch map of site 32MN771 .....	25
Figure 13: Sketch map of site 32MN772 .....	26
Figure 14: Sketch map of site 32MN773 .....	27
Figure 15: Sketch map of site 32MN774 .....	28
Figure 16: Sketch map of site 32MN775 .....	30
Figure 17: Sketch map of site 32MN460 .....	33
Figure 18: Sketch map of site 32MN461 .....	35
Figure 19: View to the north over existing pipeline and sites 32MN760 and 32MN761 .....	A-2
Figure 20: View to the north over gas pipeline and 32MN764, Feature 1 .....	A-2
Figure 21: View to the north over 32MN765, Feature 1 .....	A-3
Figure 22: View to the west over 32MN767 .....	A-3
Figure 23: View to the west-northwest over 32MN768 .....	A-4
Figure 24: View to the northwest over 32MN771, Feature1 .....	A-4
Figure 25: View to the northeast over Features 1 and 2, 32MN775 .....	A-5
Figure 26: View to the southwest over Features 1 and 2, 32MN775 .....	A-5
Figure 27: Location of proposed project area and site 32MN759 .....	B-2
Figure 28: Location of the proposed project area and sites 32MN760, .....	B-3
32MN761, 32MN762, 32MN763 and 32MNx12	
Figure 29: Location of the proposed project area and site 32MNx459 .....	B-4
Figure 30: Location of the proposed project area and sites 32MNx459, .....	B-5
32MNx385, 32MNx541 and 32MNx543	
Figure 31: Location of the proposed project area and sites 32MN764 and 32MNx544 .....	B-6
Figure 32: Location of the proposed project area and sites 32MN461, 32MN765, .....	B-7
32MN766, 32MN767, 32MN768, 32MN769, 32MN770, 32MN771, 32MN772, 32MN773, 32MN774 and 32MN775	



## **Introduction**

Whiting Petroleum Company (Whiting) is proposing to construct a 17-mile long, 8-inch wide pipeline in order to transport oil between their Robinson Lake Processing Plant to the Enbridge Pipeline Stanley Pumping Station, in Mountrail County, North Dakota. This oil-carrying pipeline will be constructed adjacent to, and run parallel along, an existing natural gas pipeline that was built in the summer of 2008. The field survey was designed to inventory a corridor that covered both pipelines.

Merjent, Inc. (Merjent) on behalf of Whiting contacted Metcalf Archaeological Consultants, Inc. (MAC) to conduct a cultural resource inventory of the pipeline corridor and a block immediately east and south of the Enbridge Pumping Station. There is no federal support or licensing associated with the proposed project. The North Dakota Public Service Commission will review the Whiting application for the pipeline permit.

The oil pipeline will be east of the existing natural gas pipeline with a 12-to-20 foot interval between the pipelines. The exception to this route is at the north end where the oil line will continue north and then veer easterly across Section 27 (T. 156N/R. 91W) to the Enbridge Pumping Station using a to-be-determined route avoiding all cultural resources.

The inventory covered a corridor approximately 16.25 miles long and 120 feet wide located on either side of natural gas pipeline that was constructed in the summer of 2008 (237 acres). The inventory corridor was 40 feet west of the existing natural gas pipeline center, and 80 feet east of the same. In addition a 240-acre block east and south of the Enbridge Pumping Station was inventoried resulting in a total of 477 acres of inventory.

## **Project Location**

The project corridor begins at Whiting's Robinson Lake Processing Plant and proceeds north for approximately 17.5 miles terminating approximately one-quarter mile south of the intersection of State Highway 8 and US Highway 2 immediately south of the community of Stanley (Figure 1). The 240-acre block is located in T. 156N, R. 91W, Section 27 and the project corridor is located as follows:

- T. 153N, R. 91W, sections 2, 3, 10, 11 and 14
- T. 154N, R. 91W, sections 2, 11, 14, 23, 26 and 35
- T. 155N, R. 91W, sections 2, 11, 14, 23, 26 and 35
- T. 156N, R. 91W, sections 26 and 35.

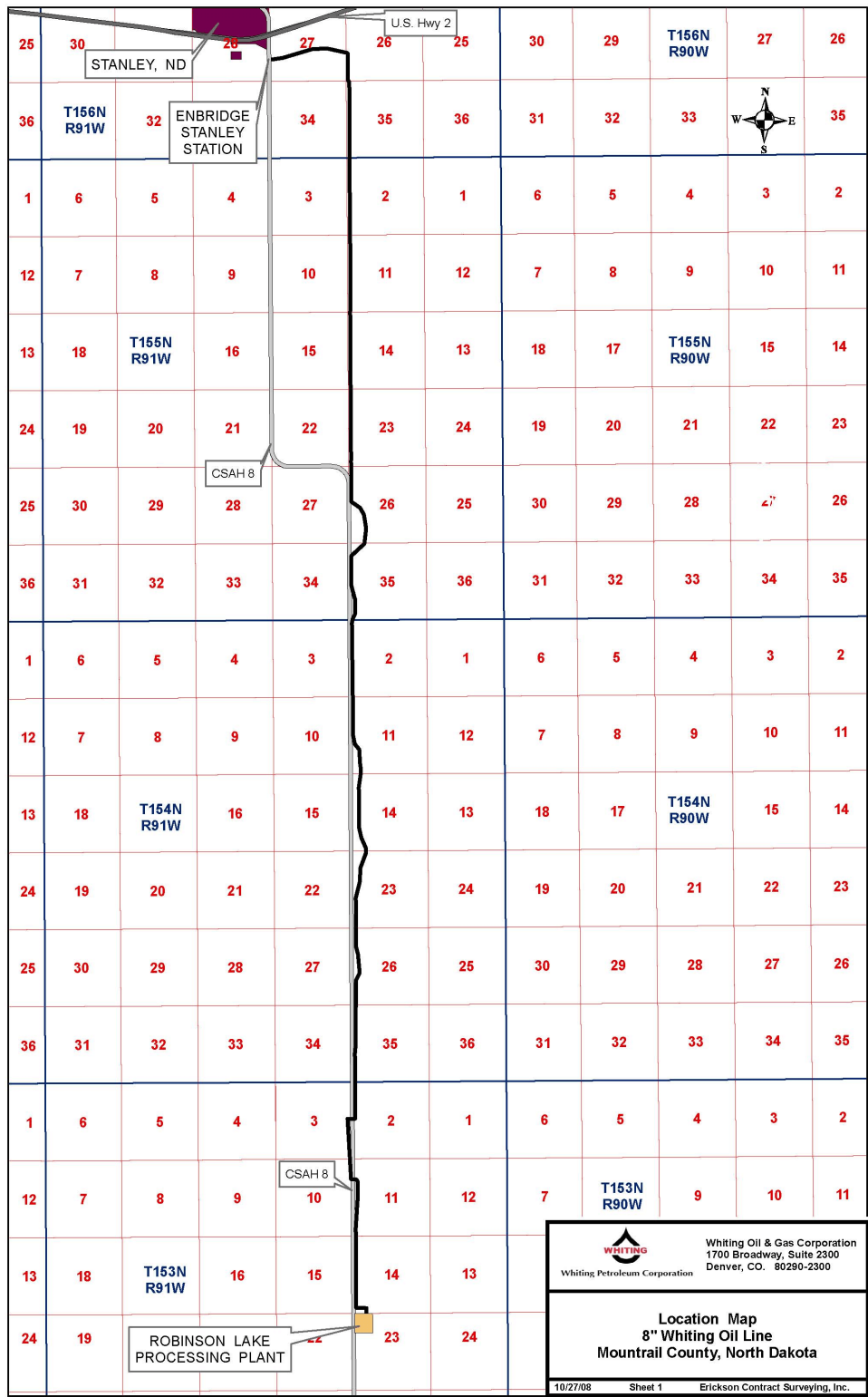

Figure 1 Project location.

## **Project Setting**

The project area is located within the Garrison Study Unit (Unit #6) as defined in the *North Dakota Comprehensive Plan for Historic Preservation: Archeological Component* (SHSND 1990: 6.1-6.39). A good overview of the archaeology and physiography of the area is available in that document. The project area is part of the Great Plains Province (VanderBusch 1991:3) and is characterized by gently rolling to rolling knob and kettle terrain with numerous small hills and pothole lakes. The principal drainage in the area is provided by the Little Knife River, a tributary to the Missouri River. The Missouri River is approximately ten miles to the southwest of the south end of the project corridor, near the confluence of the Little Knife and the Missouri rivers. Both banks of the Little Knife River are part of the block inventory at the north end of the project.

Soils within the corridor are part of the William-Zahl and Zahl-Williams Association with dark gray, loam topsoil typically about five inches thick (VanderBusch 1991:57). These soils are developed on glacial till plains and numerous rocks and cobbles are present on the surface. Where plowed, there is little undisturbed Holocene sediment. The majority of the corridor passes through plowed farmland. Although, when including the 240-acre block, slightly over half of the inventory was in undisturbed native prairie. In native prairie ground surface visibility (GSV) generally ranged from 5 to 25%; however, the project corridor was immediately adjacent to a recently installed pipeline which had a 20m wide corridor where the grass had been removed and had nearly 100% GSV. Surface visibility was also increased by the presence of various rodent and badger burrowing back dirt piles. In the plowed fields visibility ranged from 5 to 10% in areas enrolled in the Conservation Reserve Program (CRP) and was 30 to 50% in harvested crop land.

The native prairie vegetation consists of mixed grasses including blue grama grass, needle-and-thread grass and western wheatgrass. Patches of buck brush, herbaceous sage and various forbs are also present. The sloughs, potholes and other wetlands host a variety of reeds and marsh grasses. Area fauna includes white tail deer and jack rabbit; predators such as fox, coyote and badgers, and fur bearers such as ermine, mink and muskrat. The area has an abundance of upland game birds and a variety of ducks were noted on the Little Knife River. In the past the area would have hosted elk and bison; bison being especially numerous and regularly utilized by native populations.

## **Research Goals**

There is no federal support or licensing associated with the proposed project. The North Dakota Public Service Commission will review the Whiting application for a pipeline permit, as mandated in the North Dakota Century Code and administrated by the North Dakota Administrative Code, Article 69-06. This project was inventoried to locate any cultural resources within the area of potential effect. An additional goal was to allow Whiting to plan construction so as to avoid any cultural resources. A re-route for site avoidance was inventoried in one case.

## **Files Search**

On August 15, 2008 Amy Sakariassen, on behalf of Merjent, conducted a search of the State Historical Society of North Dakota's site and manuscript files. On September 9, 2008 the results of the search were submitted to the North Dakota State Historic Preservation Office (NDSHPO) for review (NDSHPO # 08-1277). A copy of the results was also provided to MAC and the results were plotted on project maps. The project maps are provided in Appendix B and the results are provided in Appendix C. The search revealed two sites, 32MN460 and 32MN461, that are in the inventory block. Portions of the block have also been surveyed in the past but there has been no inclusive survey to date. No sites are on record within the project corridor.

## **Field Methods**

The inventory was conducted by Damita Hiemstra, serving as Principal Investigator, along with Aaron Barth, Brett Ewald, Garrett Williams, and Ed Stine between September 24 and October 10, 2008. It was accomplished using parallel zig-zag pedestrian transects spaced at 20m intervals along the project corridor and across the project block. The inventory corridor was 40 feet west of the existing natural gas pipeline center, and 80 feet east of the same. Within this corridor was a 65 foot wide band where the grass had been removed resulting in nearly 100% GSV.. Special attention was paid to areas with enhanced GSV such as the afore mentioned band. The locations of two previously recorded sites were also thoroughly examined during the inventory. During the inventory Merjent was kept apprised of field results and Merjent consulted with Paul Picha, Chief Archeologist with the NDSHPO.

When an artifact or feature was encountered the location was marked with a pin flag and the surrounding area was closely scrutinized to determine the nature of the find. For this project a site was defined as the presence of six or more artifacts or one feature. An isolated find was defined as five or fewer artifacts without the presence of a feature. No artifacts were collected in the field. When a site was encountered the site, and its features, were plotted on the appropriate USGS 7.5' quadrangle map and a sketch map was generated with the aid of a Garmin GPS unit. Photographs of the site and features were taken, pertinent field notes were maintained and site forms were filled out. The site forms were filed with the NDSHPO. Copies of the photos, field notes, site forms, shovel probe forms and maps are on file at the MAC Bismarck office.

As a result of consultation with the NDSHPO it was decided that limited shovel probe excavations along the proposed centerline of the oil pipeline corridor be conducted at two locations. The proposed centerline passes very near features or artifacts at two of the newly recorded sites and the probes were excavated to determine if any significant cultural deposits were present at sites 32MN762 and 32MN763. Shovel probes were 40cm in diameter and were excavated into underlying Pre-Holocene sediments (glacial till). The probes were spaced at 10m intervals. Shovel probe forms detailing the probe depth, stratigraphy and any other relevant data were completed for each probe. As very few artifacts were discovered in the probes no artifacts were collected. Rather, relevant information about the artifacts was recorded, the artifacts were placed back in the probe from which they were recovered and then the probe was backfilled with the screened soil.

## Results

Six isolated finds and 17 sites were documented during the course of the inventory. In addition, two previously recorded sites were revisited. All of the isolated finds are pre-contact pieces of lithic flaking debris and all are recommended as not eligible for the National Register of Historic Places (NRHP). Of the 17 sites one is architectural (a corral), one is a portion of a road bed and five are historic foundations/depressions, presumably the remains of farmsteads. One of these historic sites also has a pre-contact component consisting of stone circles and a cairn. The ten remaining sites are all pre-contact sites; three cairn sites and seven stone circle sites. The two previously recorded sites are also stone circle sites. The following table lists the sites, a brief description, potential eligibility and avoidance recommendations.

<b>Table 1: Robinson Lake Survey Sites</b>			
<b>Site #</b>	<b>Description/# of Features</b>	<b>NR Eligibility Recommendation</b>	<b>Treatment Recommendation</b>
32MN759	Road bed/1	No	No avoidance
32MN760	Historic/4	No	Avoid, Feature 2 possible grave
32MN761	Historic/2	No	No avoidance
32MN762	Pre-contact/5 and Historic/7	Undetermined	Avoid, fence during construction
32MN763	Pre-contact Stone Circle/1	Undetermined	Avoid, fence during construction
32MN764	Pre-contact Stone Circles/3	Undetermined	Avoid, reroute surveyed
32MN765	Pre-contact Stone Circles/2	Undetermined	Avoid
32MN766	Historic Foundations/7	No	Avoid, Feature 2 possible grave
32MN767	Pre-contact Stone Circle/1	Undetermined	Avoid
32MN768	Pre-contact Stone Circle/1	Undetermined	Avoid
32MN769	Pre-contact Cairn/1	Undetermined	Avoid
32MN770	Pre-contact Stone Circle/1	Undetermined	Avoid
32MN771	Pre-contact Cairn/1	Undetermined	Avoid
32MN772	Pre-contact Stone Circles/4	Undetermined	Avoid
32MN773	Pre-contact Cairn/1	Undetermined	Avoid
32MN774	Historic Foundation/3	No	No avoidance
32MN775	Architectural Corral/1	No	No avoidance
32MN460	Pre-contact Stone Circles/4	Undetermined	Avoid

<b>Table 1: Robinson Lake Survey Sites</b>			
<b>Site #</b>	<b>Description/# of Features</b>	<b>NR Eligibility Recommendation</b>	<b>Treatment Recommendation</b>
32MN461	Pre-contact Stone Circles/12	Undetermined	Avoid
32MNx12	Pre-contact isolate	No	No avoidance
32MNx385	Pre-contact isolate	No	No avoidance
32MNx459	Pre-contact isolate	No	No avoidance
32MNx541	Pre-contact isolate	No	No avoidance
32MNx543	Pre-contact isolate	No	No avoidance
32MNx544	Pre-contact isolate	No	No avoidance

The majority of sites documented during the inventory consisted of stone circles and/or cairn sites. Circular arrangements of rocks (stone circles) are a common feature of archaeological sites on the Northern Plains. The circles tend to range in size from 1.2-to-12.2m. These circles are generally viewed as representing the use of stones to weigh down the outer edges of conical tents (tipis). This view, that many if not most stone circles were the result of holding down tipi edges, is supported by historic and ethnographic accounts and by archaeological fieldwork. The smaller circles have been interpreted as sweat lodges or displacement from taking the tipi down among other things. Some stone circles are also thought to have been associated with council/religious gatherings and are sometimes considered important by Tribal elders today. Stone circle sites in the Northern Plains have been identified dating as far back as the Middle Archaic (4,500 - 3,000 BP).

Rock cairns were constructed for a variety of purposes. Prehistorically they are known to have functioned as protective caps over human burials and various kinds of caches, as commemorative markers, trail markers, offering piles, supports for simple post/pole structures, big game drive line markers, and the storage of selected rock for cooking, construction and sweat bathing (Gregg 1985:94-95). Historically rock cairns have been used as survey markers, fence post supports, and simple piles from rock clearing in adjacent fields. Clusters of rocks are also often spread around utility pole anchors to keep cattle from disturbing the anchors. After the fact, these clusters resemble collapsed cairns. Other uses/origins both prehistorically and historically are possible.

There are inherent problems with investigating stone feature sites. Due to the shallow nature of stone circle sites bone preservation is often poor and stratigraphic separation of components is usually impossible. Artifacts are often recovered only from the root mat in the upper 10cm or so. Stone circle sites often have a very sparse artifact scatter in association probably due to short term use by semi-nomadic groups that may have kept personal possessions at a minimum to avoid the weight burdens of repeated moves. Cairns generally have few to no artifacts present outside of the immediate feature and often none in or under the feature proper. If the cairn serves as a burial cap the best course of action is avoidance rather than excavation but until a particular cairn has been tested there is often no way to determine if it is in fact a burial cap.

**32MN759** is comprised of an old road bed, likely a bend in Highway 8 prior to highway road improvements (Figure 2 and Appendix B, page B-2). The bed itself is a crown-and-ditched bed measuring approximately 20m across from ditch to ditch. No surface treatment (i.e., gravel, pavement, etc.) was noted. The date of use of this roadbed is not established. The bend appears to have been abandoned prior to 1981 as the topographic map shows no such bend.

While the highway systems in North Dakota have played (and continue to play) a valuable role in commerce and rural development, the portion of the highway represented by this abandoned segment can provide little research potential. Nonetheless, the majority of this site will be avoided. The pipeline's impact will be minimal at approximately 80 feet (width) of disturbance at either end of the road bed bend. The road bed's significance will not be altered by the construction of the proposed pipeline. The road bed is recommended as not eligible for the NRHP and no avoidance is recommended. As noted the majority of the site will be avoided in any case.

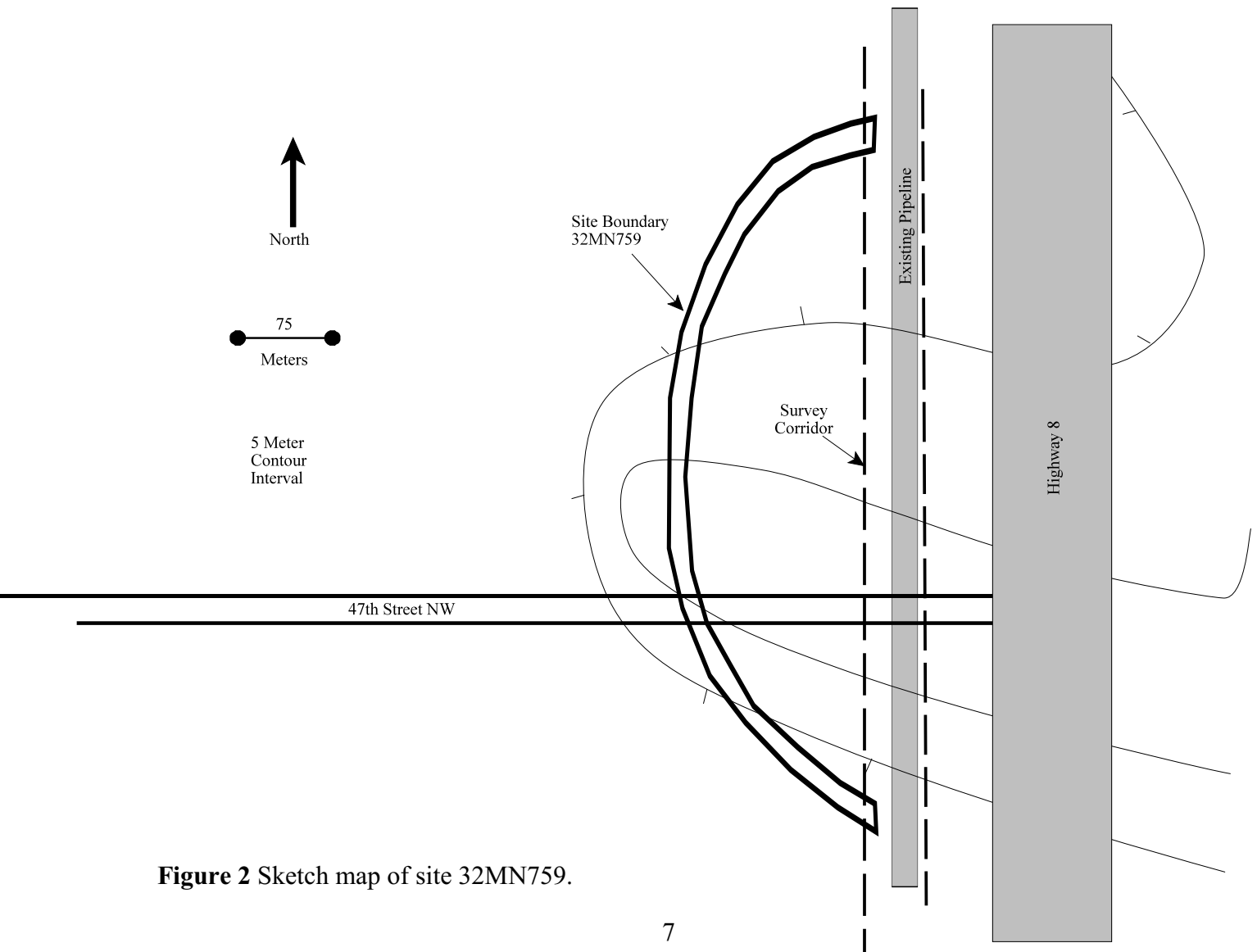

**Figure 2** Sketch map of site 32MN759.

**32MN760** is comprised of three depressions, one stone feature and a historic cultural material scatter. The site has an angled fence running through it from the northeast to the southwest as well as a newer stock pond on the southeast edge of the site (Figure 3 and Appendix B, page B-3).

The first depression (Feature 1) measures 5m in diameter and is approximately 0.5m deep. Rocks removed from the fence line and adjacent crop land have been piled up on the north side of Feature 1. Feature 2 has an unknown origin although its location near the historic depressions implies an historic origin with buck-brush growing in the central feature area (implying cultural disturbance in the immediate area). Feature 2 is a rock-lined area measuring 6.5m east-west by 2.0m north-south. The eastern side appears squared-off with the entire feature consisting of one course high, tightly spaced cobbles. Feature 2 lies on the south-facing slope overlooking the stock pond. Feature 2 may be an unusual foundation platform or may be related to graves, Native American activities or another special use. Avoidance of this feature during construction is recommended due to its questionable origin. Feature 3 is a smaller depression than Feature 1, measuring 2m in diameter and 0.5m in depth. This depression is surrounded by a slight depression which in turn is surrounded by a slightly bermed area in an “L” shape to the south and east. A second round bermed area lies to the southwest of the deeper depression. This Feature may be the remnants of a house with the deeper depression representing a cold storage or cellar area. Feature 4 is another depression measuring 3m in diameter and 0.5m in depth. An additional slight depression lies 4m to the northeast of Feature 4, however it is not definitely cultural in origin.

The significance of this site is minimal for research potential. Feature 1 has been disturbed by the piling of rocks on its north side and possibly during the construction of the nearby fence. The site has been stripped of the superstructure existing above the depressions (features 3 and 4) with the majority of the domestic debris associated with the site also removed. The remaining fragments give a snapshot of temporal association but the site does not hold unusual items in which to gather additional information on the occupants.

On October 9, 2008 Michael L. Sondeland conducted a Deed Search for the SW/SW/SW of Section 23, T. 154 N., R. 91 W. of the records in the Mountrail County Courthouse, Stanley, North Dakota. According to the records, the United States Government granted the land to Kaisa Kuffal on August 2, 1910 and on March 14, 1922 Kuffal granted the land to the Farmers Trust Company. The Farmers Trust Company granted the land to the County of Mountrail on September 27, 1928 and held the land until the early 1940s. On February 11, 1942 the County of Mountrail granted the land to Carl W. Niemitalo. John and Mayme Niemitalo took over the land on February 24, 1965 and then Vaughn Niemitalo and John Niemitalo, Jr. took possession of and have held the land since August 5, 1988. On October 13, 2008 Aaron L. Barth entered these names in to the North Dakota Biography Index. With each name the search engine returned with “No matches found.”

Since archival research did not reveal the historic archaeological component of the property as having an important association with an event or historic trends, we recommend the historic component of the site as *not eligible* according to Criterion A (NRB #15:12). As there are no standing structures Criterion C does not apply. As research did not generate any people in which

a scholarly judgment can be made, we recommend that it is not eligible under Criterion B (NRB #15:15). Lacking a state plan dealing with historic sites and having no research questions that excavations could answer, with the possible exception of Feature 2, the site does not appear to be eligible under Criterion D. It appears that the information potential is exhausted regarding the historical component of the site. We recommend that the historical component of this site is *not eligible* for the NRHP according to Criterion D (NRB #15:21).

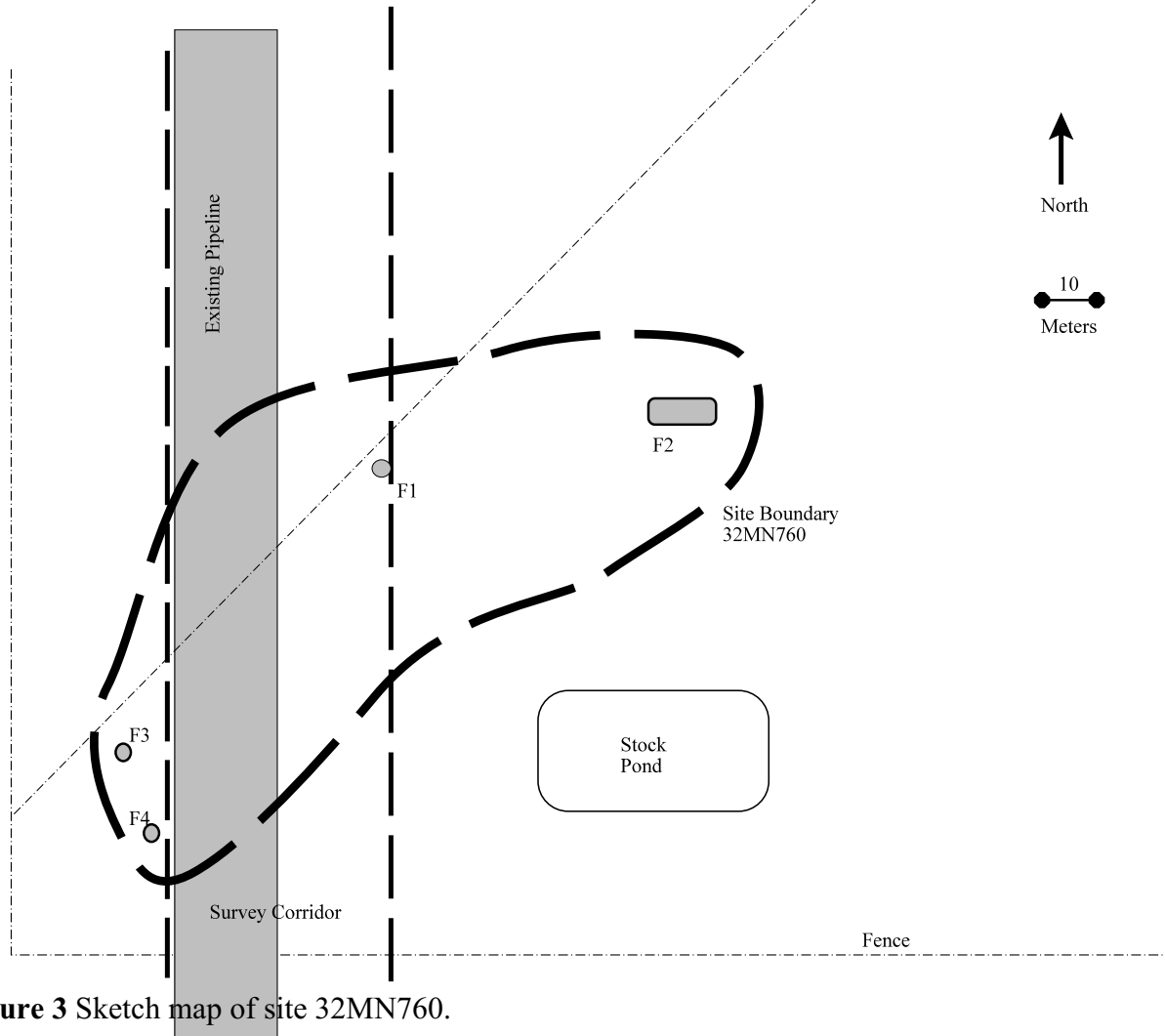

**Figure 3** Sketch map of site 32MN760.

Feature 2 may be a pre-contact component of the site and subsurface testing would be necessary in order to determine its function and to make a recommendation regarding possible NRHP eligibility under Criteria A or D. Alternately it could be part of the historic component. Because of the possibility that the Feature is a burial cap (either pre-contact or historic) subsurface testing is not necessarily recommended, rather avoidance of Feature 2 seems to be the best option. State Burial Laws should be considered before the feature is disturbed.

**32MN761** is comprised of two depressions and a single historic artifact (Figure 4 and Appendix B, page B-3). The first depression (Feature 1) measures 4m in diameter and is approximately 1.5m deep. There is a slight berm on the west side of the Feature as well as a slight “opening” or shallower area to the north. Feature 2 is a depression measuring 3.0m east-west by 3.5m north-south with a depth of approximately 0.5m. The site lies in a low area surrounded by hills just south of the section line. A single artifact was located between the two features. Little indication remains of this site’s original function. The lack of cultural material suggests there were outbuildings rather than a primary historic dwelling at the site. However, if an historic dwelling was on the site an alternative interpretation might suggest that the site was extensively cleaned up in the past in addition to the majority of debris and superstructure being removed.

Research potential for this site, beyond what has already been surveyed, is minimal. The site has been stripped of the superstructure existing above the depressions. The sole artifact does little to indicate temporal association from which to gather additional information on the occupants. Since the site rests on a section line, archival research produced two disparate chains of ownership.



**Figure 4** Sketch map of site 32MN761.

On October 9, 2008 Michael L. Sondeland conducted a Deed Search at the Mountrail County Courthouse, Stanley, North Dakota, for the SW/SW/SW of Section 23, T. 154 N., R. 91 W. and the NW/NW/NW of Section 26, T. 154 N., R. 91 W.

The Deed Search for the SW/SW/SW of Section 23, T. 154 N., R. 91 W. revealed the following chain of ownership. According to the records, the United States Government granted the land to Kaisa Kuffal on August 2, 1910 and on March 14, 1922 Kuffal granted the land to the Farmers Trust Company. The Farmers Trust Company granted the land to the County of Mountrail on September 27, 1928 who held the land until the early 1940s. On February 11, 1942 the County of Mountrail granted the land to Carl W. Niemitalo. John and Mayme Niemitalo took over the land on February 24, 1965 and then Vaughn Niemitalo and John Niemitalo, Jr., took possession of and have held the land since August 5, 1988. On October 13, 2008 Aaron L. Barth entered these names into the North Dakota Biography Index. With each name the search engine returned with “No matches found.”

The Deed Search for the NW/NW/NW of Section 26, T. 154 N., R. 91 W. revealed the following chain of ownership. According to the records, the United States Government granted the land to Prida Crisdina Jurva on September 21, 1911. On March 29, 1912 Toivo & Miiija Jurva granted the land to Amanda Husa and seven years later Amanda Husa granted the land to John P. Husa on August 19, 1919. At some point between 1919 and 1942 the land was transferred from John P. Husa to the Federal Land Bank of St. Paul, Minnesota, as the land changed ownership from this Federal Land Bank to A. S. Jorgensen on December 21, 1942. Adolph & Emma Jorgensen transferred the land to Elroy and Emojean Jorgensen on April 13, 2007.

On October 13, 2008 Aaron L. Barth entered each name into the North Dakota Biography Index to see if any of the individuals who owned this land had biographical or family sketches in any local or regional county histories. The only name to generate an archival result was John Peter Husa (a.k.a., “John P. Husa”). Mr. Husa was born in 1859 and originally hailed from Tornio, Finland. As was the national and international historical trend at the time, Husa was one of the many Scandinavians who abandoned their native countries and immigrated to America. Husa came to America in August 1880, worked in the copper mines of Michigan for a while and then migrated west, moving into North Dakota with his wife, Amanda Jurva (originally from Calumet, Michigan), in 1885.

Approximately two years after the “Dakota Boom” of 1883, Husa filed for a homestead near Brocket, Ramsey County in northeastern North Dakota. In 1911 the family moved west again, this time across the state, to a farm approximately a mile south of Belden, Mountrail County, North Dakota. Amanda Husa was granted the deed on March 29, 1912. Amanda Jurva Husa passed away in 1931. Thirteen years later, in 1944, John Peter Husa passed away. John and Amanda had 11 children.

The Husa family is a singular representation of the broader Scandinavian immigration into America, and they also represent a component of the larger Scandinavian settlement in the

northeastern and northwestern portions of the state. However, we recommend that the site is not eligible under Criterion A, as research did not reveal if the features observed are associated with the actual farmstead site, and at this point direct associations between the features and with the Husa's is speculative (NRB #15, 1997:12). We recommend the site as *not eligible* under Criterion B since research did not indicate that John or Amanda Husa were doctors, involved in politics, or merchants significant in the field of medicine or commerce (NRB #15, 1997:15). Criterion C does not apply since the site is lacking a standing structure. As for Criterion D, we are not aware of a research design that would suggest there contains more, as yet unknown data, to link the site with the Husa family and Scandinavian settlement in North Dakota beyond what has already been learned from the pedestrian survey and archival research (NRB #15, 1997:21).

Site integrity is fair in that the site is stable and does not appear to be subject to erosion or other disturbance. The site has obviously undergone some "clean-up" in that there are very few artifacts remaining in the area and the superstructures and debris from their dismantling have been hauled away. The site is recommended as not eligible for the NRHP and no avoidance by this project is recommended.

**32MN762** is comprised of both historic and prehistoric features (Figure 5 and Appendix B, page B-3). The historic features include a dump, three foundations, one well and two depressions. The prehistoric features include four stone circles and one rock cairn.

Feature 1 (the dump) measures 30m east-west by 12m north-south with an undetermined depth. The dump has been utilized repeatedly over the years with older items visible under more modern items. Observed within the dump were lumber, appliances, telephone poles, metal, glass, rubber, a bed frame, cement, a ceramic toilet, lawn mowers (non-mechanical), car parts, tires, mattress springs and one Hazel-Atlas sun-colored amethyst bottle dating between 1920-1964. The majority of the items on the surface appear to be from between the 1930s to the 1970s. The dump faces the south and has a slight divot in the northern edge where trucks have been backed up to the feature.

Feature 7 is a depression measuring 4m in diameter and approximately 1m in depth. Feature 8 is a stone and cement foundation. The inner wall, measuring 3m north-south by 2m east-west, is comprised of stones set in a cement matrix. The inner wall stands approximately 1.2m tall. The outer foundation is made of cement and at one time held a wooden-frame, as evidenced by impressions in the cement. The outer foundation surrounds the first wall and measures 5.5m in length and 3m in depth. A 2.5m gap between the two walls is visible on the northwestern corner. Piles of brush and limbs block most of the feature. A general depression exists to the east of the stone wall, ending at the fresh pipeline scar approximately 10.5m to the east. These two features lie to the west of the existing pipeline scar.

Features 9-12 are located across a small draw to the south of the first eight features. Feature 9 is an historic cement and boulder/cobble foundation measuring 10.5m east-west by 5m north-south. The southwest corner consists of cement while the west and north sides are lined with large orange lichen-covered boulders. The east wall and the eastern portion of the south wall consist of smaller cobbles. Feature 10, a cement-lined well, lies near Feature 9's southern wall. This well consists of a 1.5m diameter, 1m deep circular depression filled with carriage parts, fencing, one metal bucket and one metal wheel.

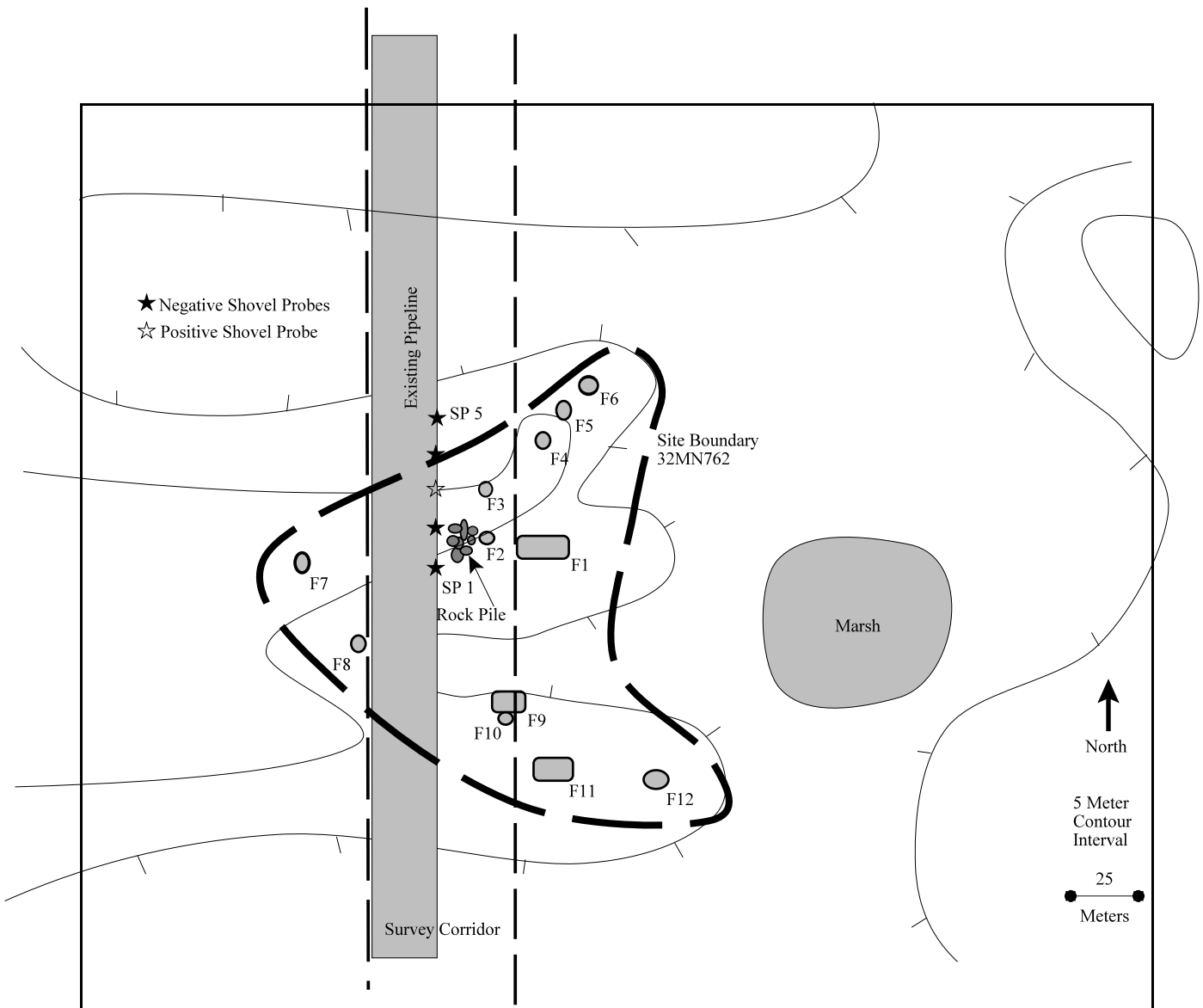

**Figure 5** Sketch map of site 32MN762.

Feature 11 is a stone and earthen berm foundation measuring 3.6m north-south by 10.5m east-west. A small opening, likely the doorway, lies on the northern wall near the northwest corner. The bermed foundation is approximately 0.5m above the surrounding ground surface. Two artifacts were observed near Feature 11: a fragment of whiteware and one sun-colored amethyst bottle with a "3" stamped on the base. Between Feature 11 and Feature 12 a metal farm implement was observed. Feature 12 is a depression measuring 3m east-west by 4.5m north-south. The depth of this depression is unknown as the feature has been utilized for fieldstone piling with the rock mound setting higher than the original ground surface. A slight berm lies on the east side of the depression.

The prehistoric features lie on the first rise to the north near the dump and to the east of the pipeline scar. Feature 2 is a stone circle measuring 4m in diameter and consists of 32 well-sodded in, basketball sized rocks. There is a 2m gap on the south side of Feature 2. A large boulder pile, the boulders having been cleared from the recent pipeline construction, lies immediately to the west of the feature. One of those boulders lies 20cm from the edge of Feature 2. Feature 3 is also a stone circle lying approximately 8m east of the pipeline scar. The circle measures 6m in diameter and consists of 44 well-sodded in stones. Feature 4 is a stone circle measuring 4.5m in diameter and consists of 88 stones. Feature 5 is a stone circle measuring 5m in diameter and consists of 44 stones. Feature 6 is a rock cairn measuring 1m in diameter and has 11 visible stones in a single course. Slight mounding is evident on the Feature. Five SP's were excavated along the proposed pipeline centerline through the prehistoric component of the site. The probes were spaced at 10m intervals and were excavated into Pre-Holocene sediments (glacial till). Only one, SP #3, yielded historic cultural material; ten pieces of scrap metal and two pieces of glass, obviously part of the historic component.

The significance of this site is unknown but the prehistoric component is potentially eligible for the NRHP. The historic features have been imposed upon the older, prehistoric site and have impacted the prehistoric component to the site to an unknown degree. The historic features such as the dump, and the variety of construction techniques used at this site, imply multiple occupation episodes, or alternatively a very long occupation. While the site has been stripped of the superstructure existing above the depressions, the quantity of historic debris in and around the features indicates diagnostic items are present.

On October 9, 2008 Michael L. Sondeland conducted a Deed Search for the W/NW/NW of Section 26, T. 154 N., R. 91 W. at the Mountrail County Courthouse, Stanley, North Dakota. According to the records, the United States Government granted the land to Prida Crisdina Jurva on September 21, 1911. On March 29, 1912 Toivo & Miija Jurva granted the land to Amanda Husa and seven years later, on August 19, 1919, Amanda Husa granted the land to John P. Husa. At some point between 1919 and 1942 the land was transferred from John P. Husa to the Federal Land Bank of St. Paul, Minnesota, as the land changed ownership from this Federal Land Bank to A. S. Jorgensen on December 21, 1942. Adolph & Emma Jorgensen transferred the land to Elroy and Emojean Jorgensen on April 13, 2007.

Aaron L. Barth entered each name in to the North Dakota Biography Index on October 13, 2008 to see if any of the individuals who owned this land had biographical or family sketches in any local or regional county histories. The only name to generate an archival result was John Peter Husa (a.k.a., “John P. Husa”). Mr. Husa was born in 1859 and originally hailed from Tornio, Finland. As was the national and international historical trend at the time, Husa was one of the many Scandinavians/Europeans who abandoned their native countries and immigrated to America. Husa came to America in August 1880, worked in the copper mines of Michigan for a while and then migrated westward, moving into North Dakota with his wife, Amanda Jurva (originally from Calumet, Michigan), in 1885.

Husa filed for a homestead near Brocket, Ramsey County, in northeastern North Dakota approximately two years after the “Dakota Boom” of 1883. In 1911 the family moved to the western part of the state to a farm approximately a mile south of Belden. On March 29, 1912 Amanda Husa was granted the deed to a portion of the land that was surveyed in September/October 2008. Amanda Jurva Husa passed away in 1931. Thirteen years later, John Peter Husa passed away in 1944. John and Amanda had 11 children.

The Husa family is a singular representation of the broader Scandinavian immigration into America. They also represent a component of the larger Scandinavian settlement in the northeastern and northwestern portions of the state. However, we recommend that the site is not eligible under Criterion A, as research did not yet reveal whether the features observed were associated with the actual Husa farmstead site, and at this point direct associations between the features and with the Husa family is speculative (NRB #15:12). We recommend the site as *not eligible* under Criterion B since research did not indicate that John or Amanda Husa were doctors, involved in politics, or merchants significant in the field of medicine or commerce (NRB #15:15). Criterion C does not apply since the site is lacking a standing structure. As for Criterion D, we are not aware of a research design that would suggest the site contains more, as yet unretrieved data to link it with the Husa family and Scandinavian settlement in North Dakota beyond what has already been learned from the pedestrian survey and archival research (NRB #15:21). We recommend that the historic component of the site is *not eligible* under Criterion D.

While the historic component of this site is recommended as not eligible, the prehistoric component is considered potentially eligible and avoidance, with fencing during construction, is recommended. A reroute of the pipeline to the east was considered for the protection of these features, but sensitive wetlands lie immediately to the east of the site.

**32MN763** is comprised of one prehistoric feature and two artifacts (Figure 6 and Appendix B, page B-3). Feature 1 is a stone circle consisting of 62 stones in a 6m diameter circle. The stones are well sodded in and no large gaps are evident. The two artifacts found during the inventory of this site include one Tongue River silicified sediment (TRSS) core fragment and one Knife River flint (KRF) projectile point mid-section. In addition, one KRF tertiary flake was encountered during subsequent SPs in Probe #3.

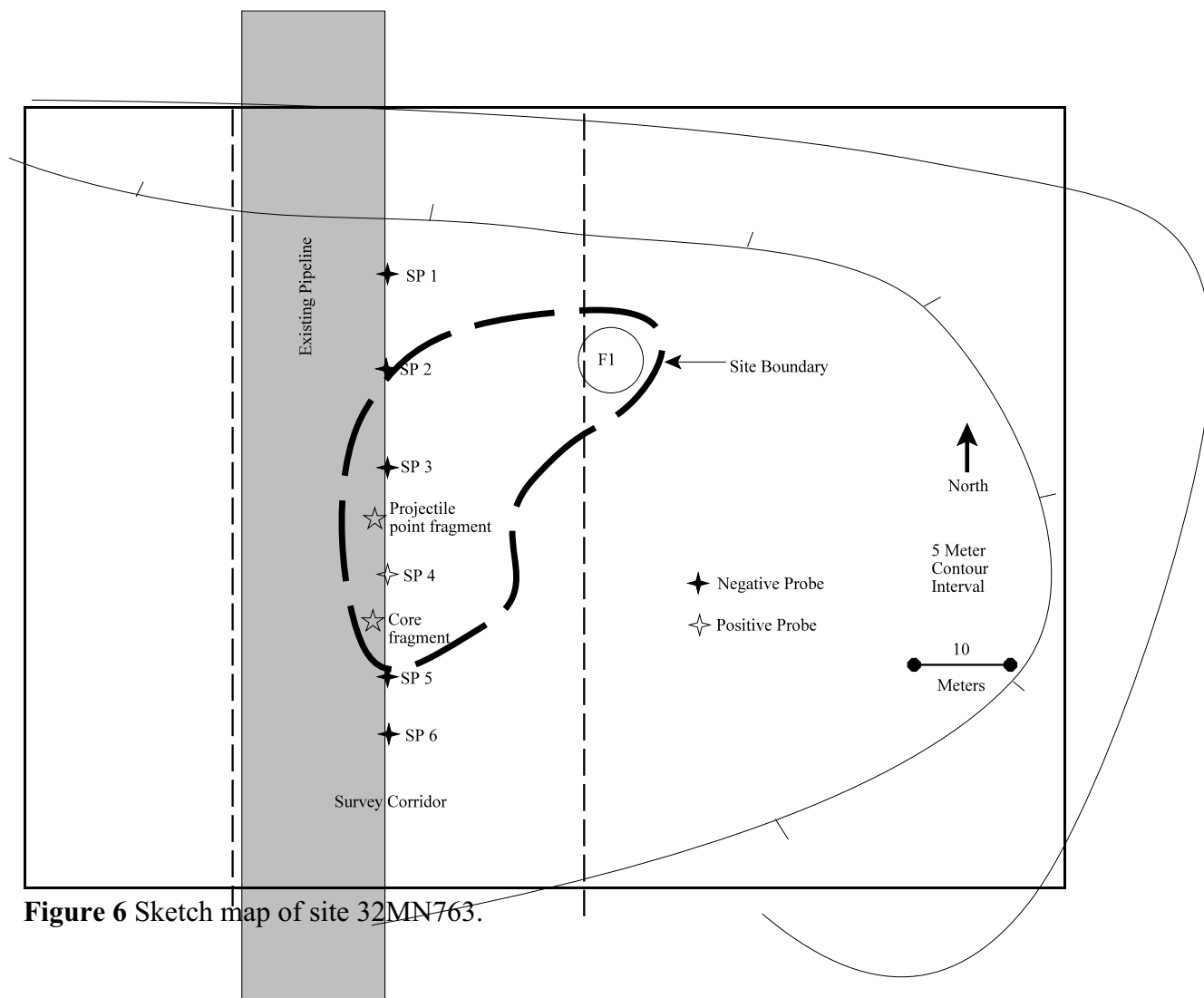

**Figure 6** Sketch map of site 32MN763.

Six SP's were excavated north-south along the proposed project centerline. The probes were spaced 10m apart and each probe was approximately 40cm in diameter. The probes were excavated into glacial till. Shovel Probe 4 contained one KRF flake in the upper 20cm. The remaining SP's were negative for cultural material.

Site integrity is fair to good. Construction from the existing gas pipeline may have impacted the site. Although as presently defined, Feature 1 at the site is approximately 20m east of those construction activities. Two lithic artifacts were observed in the gas line construction corridor and a third was recovered immediately adjacent to that corridor on the proposed centerline of the proposed oil pipeline. Based on observed cultural materials, and on the results of the limited probing, it appears that the cultural material associated with the site is sparse and not varied, being limited to lithic material only. Thus it appears that impact to the site was limited and integrity may still be fairly good.

Until full evaluative testing has been conducted we recommend that this site is potentially eligible for the NRHP. It appears that the centerline, as planned, can be used with very limited impact to the site provided that Feature 1 is avoided. We recommend that temporary fencing is

installed to prevent construction activities from encroaching on Feature 1.

**32MN764** consists of three stone circles one of which (Feature 1) has been disturbed by blade work associated with the recent pipeline project. A strip approximately 20m wide has been bladed between Feature 1 and features 2 and 3 (Figure 7 and Appendix B, page B-6). No cultural material was noted in this stripped area. Features 2 and 3 abut and appear to share approximately 12 rocks in forming their rings. Feature 1 is 5.5m in diameter and is composed of 40 well sodded rocks. Feature 2 is composed of 34 rocks, is open to the west and is somewhat oval in shape with dimensions of 6.5m east-west by 6.0m north-south. Feature 3 has similar dimensions as Feature 2 and appears to be double coursed along its north edge. Feature 3 also shares rocks with Feature 2 along Feature 2's north edge. Feature 3 is composed of 56 well sodded, granite rocks.

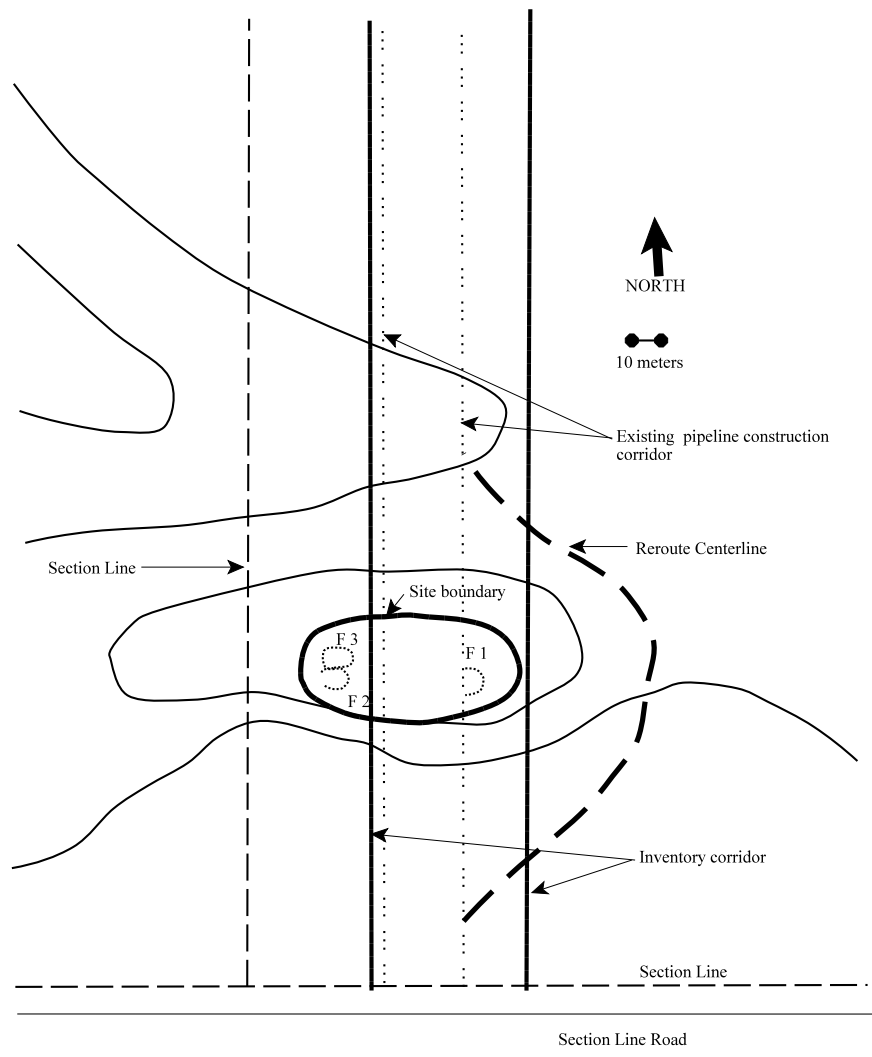
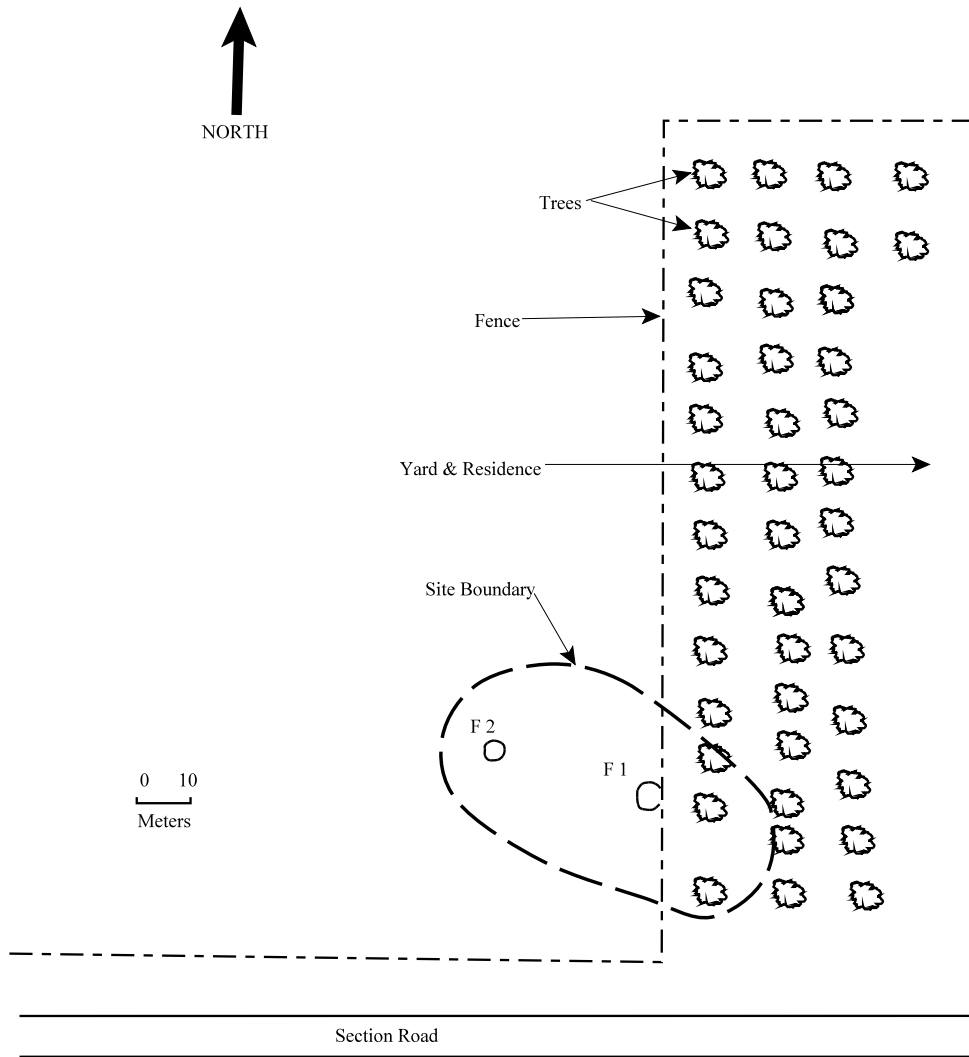

**Figure 7** Sketch map of site 32MN764.

Site integrity appears to be fair at best. The construction of the gas pipeline has clearly impacted Feature 1 and it is unknown if other stone circles have been obliterated by that construction. Features 2 and 3 are somewhat unusual in that they appear to share a portion of a wall and both are somewhat oval in shape. It is possible that they represent an effigy although no discernable image/shape was evident. The site is recommended as potentially eligible for the NRHP and could be important to area Tribes. Site avoidance is recommended. A site avoidance route providing a 30m buffer zone for Feature 1 was inventoried to the east of the site and is recommended for this project.

**32MN765** is comprised of two features, both stone circles (Figure 8 and Appendix B, page B-7). Feature 1 measures approximately 6m in diameter and is composed of 72 well sodded, granite rocks. The eastern edge of the circle has been disturbed by the installation of a fence line. Feature 2 is located approximately 25m to the west-northwest of Feature 1. It measures approximately 5m in diameter and is composed of 95 well sodded, granite rocks. No artifacts were observed in association with the features. This site was documented in the block survey east of the Stanley Station. Eight other stone circle/cairn sites were documented and two other previously recorded stone circle sites were revisited within the survey block. It is unknown what relationship, if any, they bear with each other.

Site integrity is fair to good. Feature 1 has been impacted by fence construction and it is possible that other features were impacted by tree planting and residential landscaping; a yard and residence are present immediately east of the site. The site is recommended as potentially eligible for the NRHP and avoidance is recommended. The final corridor route to the Stanley Station will take into account the sites documented within the block and will avoid these sites.



**Figure 8** Sketch map of site 32MN765.

**32MN766** is comprised of seven features located within the 240-acre survey block east of the Stanley Station (Figure 9 and Appendix B, page B-7). There are three depressions (Feature 1, Feature 5 and Feature 6), three historic stone features (Feature 2, Feature 3, and Feature 4), and one historic rock pile and trash dump (Feature 7). Feature 1 is a depression measuring 3m in diameter and is approximately 0.5m deep. Feature 2 is a rock alignment just northwest of Feature 1. Feature 2's location near the historic depressions and historic stone features suggest it is of an historic origin. The feature size (1 X 2 meters) would appear to be too small to have functioned as a foundation and is a size that could potentially mark an internment/grave. Feature 3 is a rectangular stone foundation with approximately 134 visible and sodded in stones. It has an opening on the southern edge. Feature 3's west wall measures approximately 7m north-south and the east wall measures approximately 5m north-south. Feature 3's north wall measures 4.5m east-west. Feature 4 is a stone foundation with approximately 122 visible and sodded in stones. It measures approximately 5m north-south and 7m east-west and has an opening on the northern edge. Feature 5 and Feature 6 are depressions measuring 2m in diameter and are approximately 0.25m deep. Feature 7 is a modern stone pile and trash dump measuring approximately 12m in diameter. The cultural material observed was located in Feature 7. Broken glass, burned lumber, and pieces of metal and plastic are piled within the large modern stone pile.

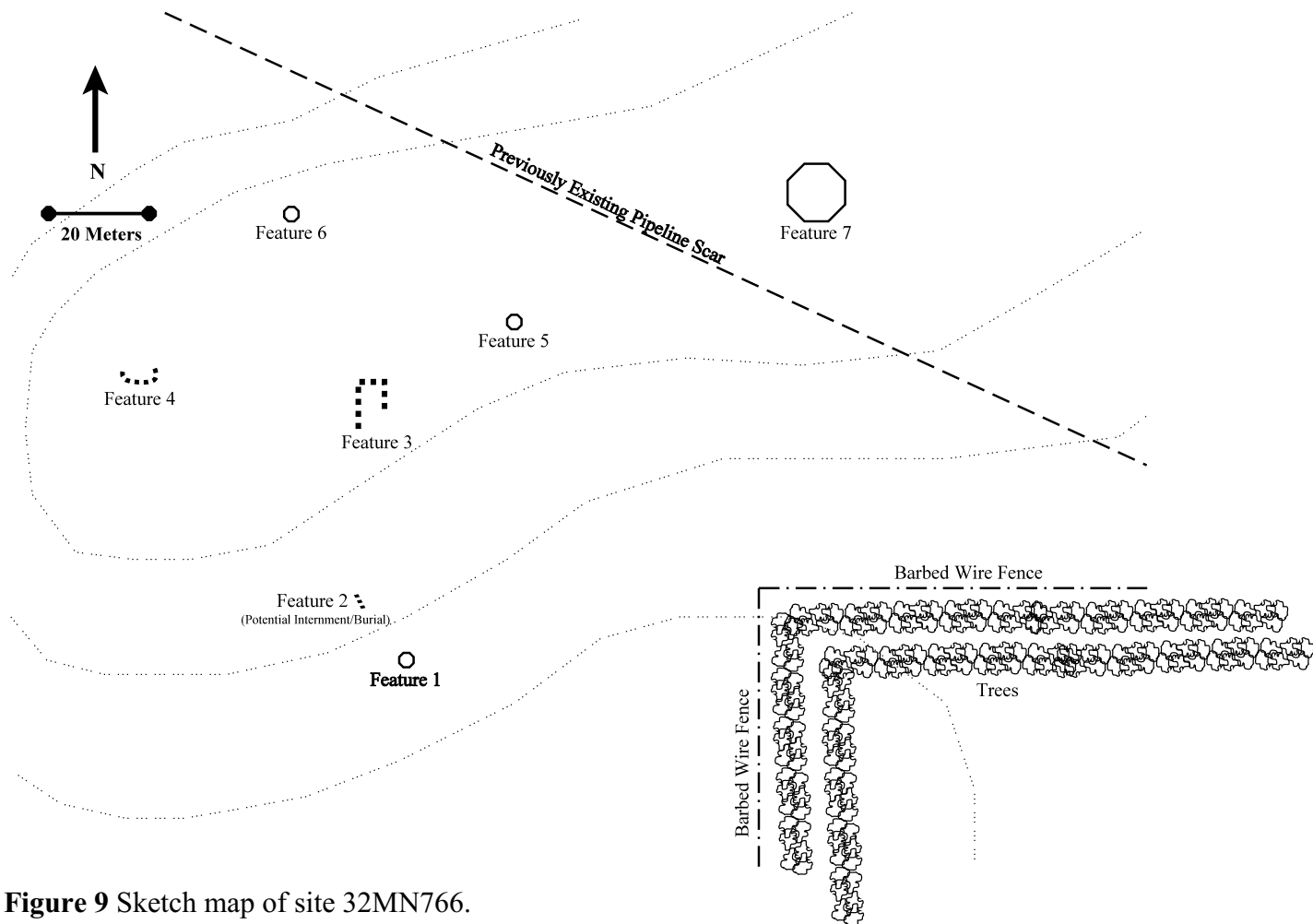

**Figure 9** Sketch map of site 32MN766.

32MN766 is one of three historic/architectural sites recorded during the inventory. This and/or any of the other historic sites may be related and all may be related to a recent residence that lacks the 50 year age requirement for the NRHP. As it lacks the age requirement the residence was not recorded as part of the inventory.

On October 20, 2008 Michael L. Sondeland conducted a Deed Search for the W/SW/SE of Section 27, T. 156 N., R. 91 W. of the records in the Mountrail County Courthouse, Stanley, North Dakota. According to the records, the United States Government granted the land to Warren Thompson on November 18, 1908. The Mountrail County Sheriff granted the land to The Savings and Loan & Trust Company on May 25, 1911. Almost a year and a half later, The Savings and Loan & Trust Company granted the land to Ross L. Olson on October 30, 1912 and Mr. Olson granted the land to Grant S. Youmans on March 3, 1917. Again, The Savings and Loan & Trust Company regained possession of the land. On April 9, 1919 The Savings and Loan & Trust Company granted the land to Charles E. Larsen and six days later Mr. Larsen granted the land to William Stevens. Nine years later Mountrail County took possession of the land on July 26, 1928 and then the county granted the land to E. O. Holmgren on August 16 of that year. On July 3, 1945 E. O. and Betsy Holmgren granted the land to Ethel C. Witt and the land was granted to M. M. Kincannom on January 11, 1950. On March 30, 1981 the land transferred ownership to Jerald and Marie Harstad and on November 23 of that year the land was granted to Timothy and Lori Gustafson. The Gustafsons filed a Quit Claim Deed and the land returned to Jerald and Marie Harstad on May 24, 1982. The Jerald D. Harstad Estate transferred ownership to Marie Harstad on September 11, 2003. Marie Harstad filed a Quit Claim Deed on September 22, 2003 and the land was granted to the Marie Harstad Living Trust.

On October 23 Aaron L. Barth checked the names against the North Dakota Biography Index search engine. The only name to generate an archival result was a Jerald Harstad, the individual who took possession of the land less-than 50 years ago with Marie Harstad on March 30, 1981.

Since archival research did not reveal the site as having a traceable association with an event or historic trend, we recommend it as *not eligible* under Criterion A (NRB #15:12). As research did not produce any names or histories in which a scholarly judgment could be made, we recommend that it is *not eligible* under Criterion B (NRB #15:15). As there are no standing structures, Criterion C does not apply.

According to Criterion D, “the property must have, or have had, information to contribute to our understanding of human history or prehistory,” and “the information must be considered important” (NRB #15:21). It appears doubtful that important information can be obtained through subsurface testing as North Dakota has not developed a context with important research questions that could be answered through excavations. As noted above, the primary concern is Feature 2, as its size suggests that it may be a marker for a burial. North Dakota State Board Law (Century Code 23-06-27) understandably protects any burial from being disturbed, and thus, we recommend the site be avoided.

**32MN767** is comprised of a single stone circle (Feature 1) measuring 6m in diameter. The stone circle is very well sodded and 74 granitic rocks are visible. An additional five rocks are visible in the center. The site is located on a bench/spur of a large hill approximately 330m east of the Little Knife River and within the survey block east of the Stanley Station (Figure 10 and Appendix B, page B-7). A cairn site is located approximately 75m to the north and a large stone circle site is located 120m to the northeast on the crest of the hill. Eight other stone circle/cairn sites are also present within the survey block. It is unknown what relationship, if any, they bear with each other.

Site integrity is high as the feature and surrounding area are undisturbed and are not subject to erosion. The site is recommended to be potentially eligible for the NRHP but some form of testing would be necessary in order to make a final determination. In lieu of testing avoidance is recommended. The pipeline corridor route through this section will be planned so as to avoid this and the other sites documented.

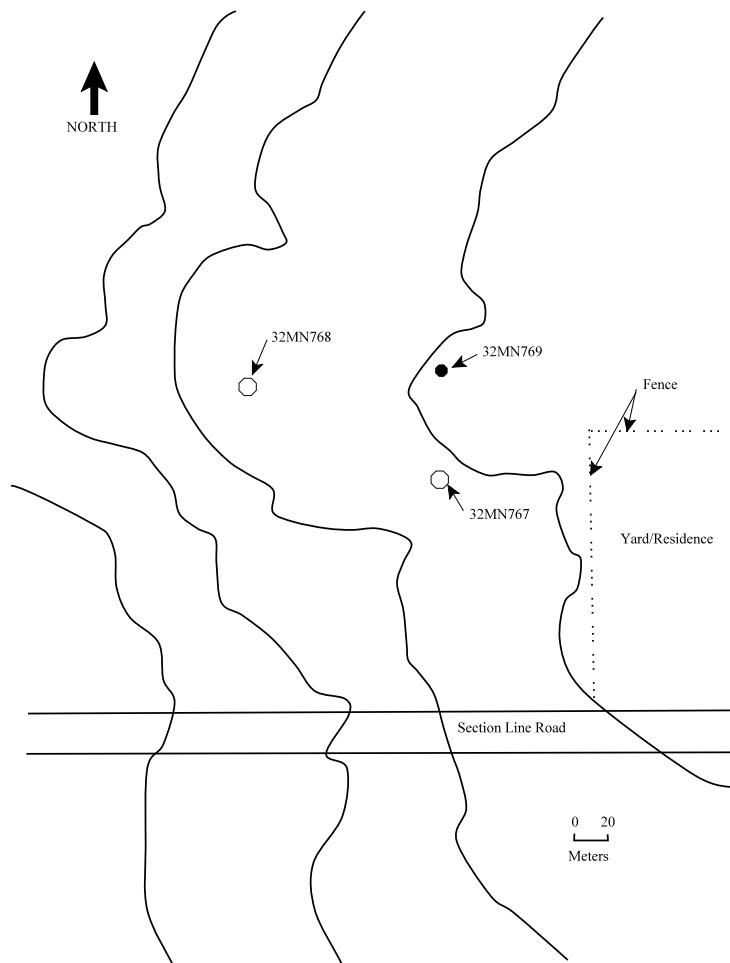

**Figure 10** Sketch map of sites 32MN767, 32MN768 and 32MN769.

**32MN768** is comprised of a single stone circle (Feature 1) measuring 6m in diameter. The stone circle is very well sodded and 55 granitic rocks are visible. The site is located on a bench of a large hill approximately 200m east of the Little Knife River within the survey block east of the Stanley Station (Figure 10 and Appendix B, page B-7). There is a large stone circle site, 32MN461, approximately 180m to the east on the crest of the hill. It is not known if there is any relationship between these stone circle sites.

Site integrity is high and the area is undisturbed with only minor impact due to cattle grazing. The site is recommended as potentially eligible for the NRHP but testing would be needed to make a definite recommendation regarding eligibility. In lieu of testing site avoidance is recommended. The pipeline route through this section will be planned so as to avoid this and the other sites documented.

**32MN769** is comprised of a single cairn (Feature 1) measuring 1.5m north-to-south and 2m east-to-west. The cairn is well sodded and 17 granitic rocks are visible. Additional completely buried rocks are also likely. The site is located on a bench of a large hill approximately 300m east of the Little Knife River within the survey block east of the Stanley Station (Figure 10 and Appendix B, page B-7). There is a large stone circle site, 32MN461, approximately 75m to the northeast on the crest of the hill. It is possible that the two sites are related but a definite relationship cannot be confirmed. Two other cairn sites were documented within this block. Both are over 450m distant and on distinctly different landforms. The function of the cairn is unknown but it is of a size that would not preclude it from being a burial cap. The cairn location is quite visible from the west and it is possible that it functioned as a marker although the relatively nearby hill crest may have served better for such a function.

Site integrity is high as the area is undisturbed beyond slight impact due to cattle grazing. The site is recommended as potentially eligible for the NRHP and in lieu of testing avoidance is recommended. The pipeline route through this section will be planned so as to avoid this and the other sites documented.

**32MN770** is comprised of a single stone circle (Feature 1) measuring 6m in diameter. The stone circle is well sodded and 40 granitic rocks are visible. The site location is approximately 600m east of the Little Knife River within the survey block east of the Stanley Station (Figure 11 and Appendix B, page B-7). The site is located just east of a recently constructed residence and it is possible that additional circles were destroyed by landscaping although no evidence of such is present. It is approximately 150m east of site 32MN765 which is on the west edge of the same resident's property. Site 32MN461, the large stone circle site on the crest of a prominent hill is approximately 170m to the north. The possibility exists that there is a relationship between the two sites.

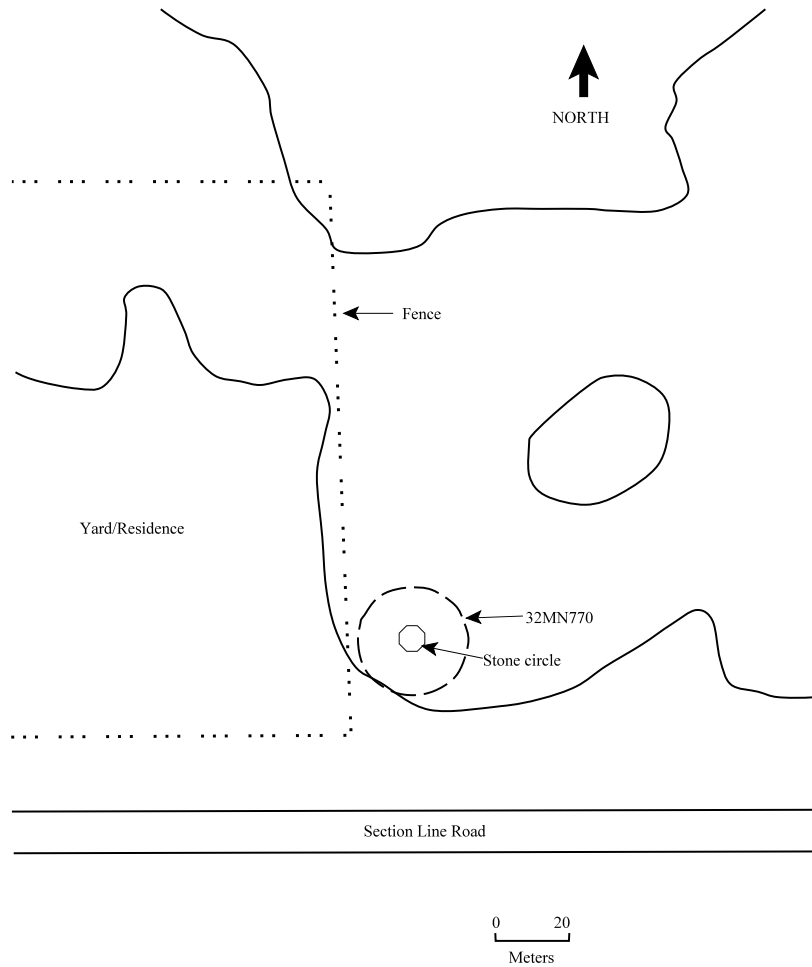

**Figure 11** Sketch map of site 32MN770.

The site integrity appears to be high in that there is no obvious disturbance of the site area. The site is recommended as potentially eligible for the NRHP. Evaluative testing would be needed to confirm eligibility and in lieu of testing avoidance of the site is recommended. The pipeline route through this section will be planned so as to avoid this and the other sites documented.

**23MN771** is comprised of a single cairn (Feature 1) measuring 1m north-to-south and 2m east-to-west. The cairn is well sodded and 24 granitic rocks are visible. The site is located on a slight spur of uplands above the Little Knife River which is approximately 200m to the west within the survey block east of the Stanley Station (Figure 12 and Appendix B, page B-7). There is a large stone circle site, 32MN461, approximately 275m to the south on the crest of a prominent hill. It is unlikely that the two sites are related as they are separated by a large deep drainage cut, but a relationship cannot be ruled out. The other documented stone circle sites are even more distant. Two other cairn sites were documented within this block. Both are over 450m distant and on distinctly different landforms. The function of the cairn is unknown but it is of a size that is consistent with the use as a burial cap. The cairn location is quite visible from the west and it is possible that it functioned as a marker however it is down slope enough that it would not have been visible from the east.

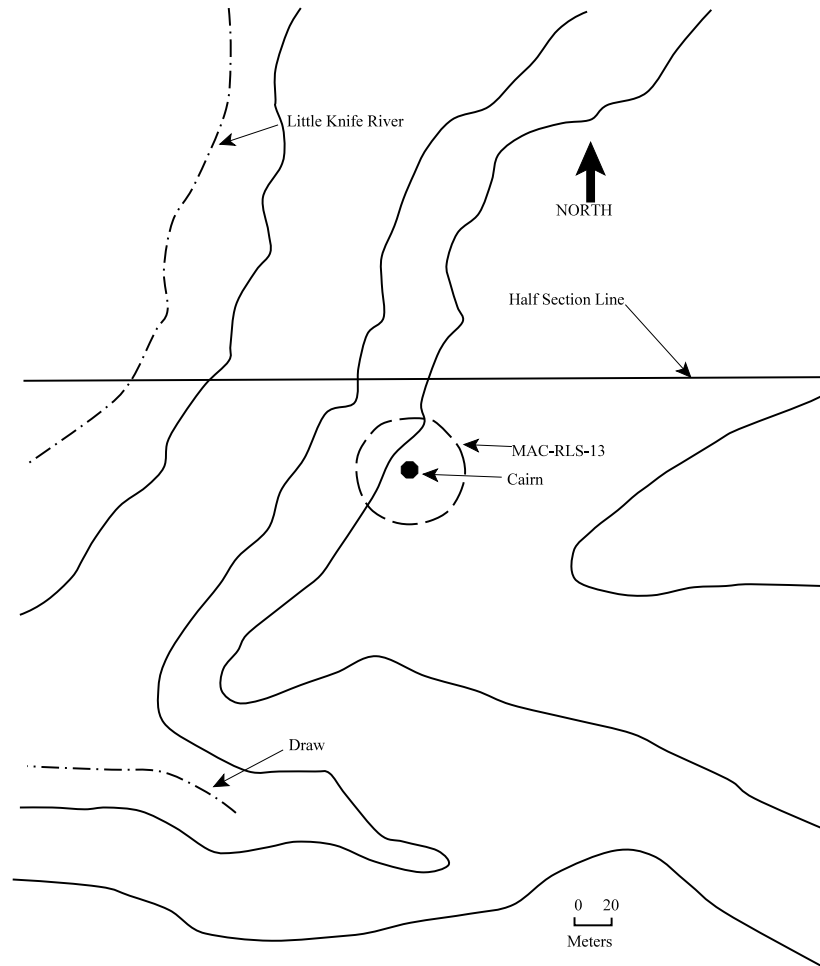

**Figure 12** Sketch map of site 32MN771.

Site integrity is very good as the site area is undisturbed other than slight impact from cattle grazing. The site is recommended as potentially eligible for the NRHP and site avoidance is recommended. The pipeline route through this section will be planned so as to avoid this and the other sites documented.

**32MN772** is comprised of four stone circles on a terrace of the Little Knife River (Figure 13 and Appendix B, page B-7). The Little Knife River is located approximately 50m to the east. All of the circles were well-sodded and constructed from local granitic rocks. Feature 1 measures 4m in diameter and has 39 visible rocks. Feature 2 measures 4.5m in diameter and includes 47 visible rocks. Feature 3 measures 3.5m in diameter and has 33 rocks. Feature 4 measures 4m in diameter and 21 rocks were visible. There are several buried pipelines in the area but none of the features have been impacted. There are two other sites on the west side of the Little Knife River within the project block, 32MN460, a previously recorded stone circle site and 32MN773, a cairn site.

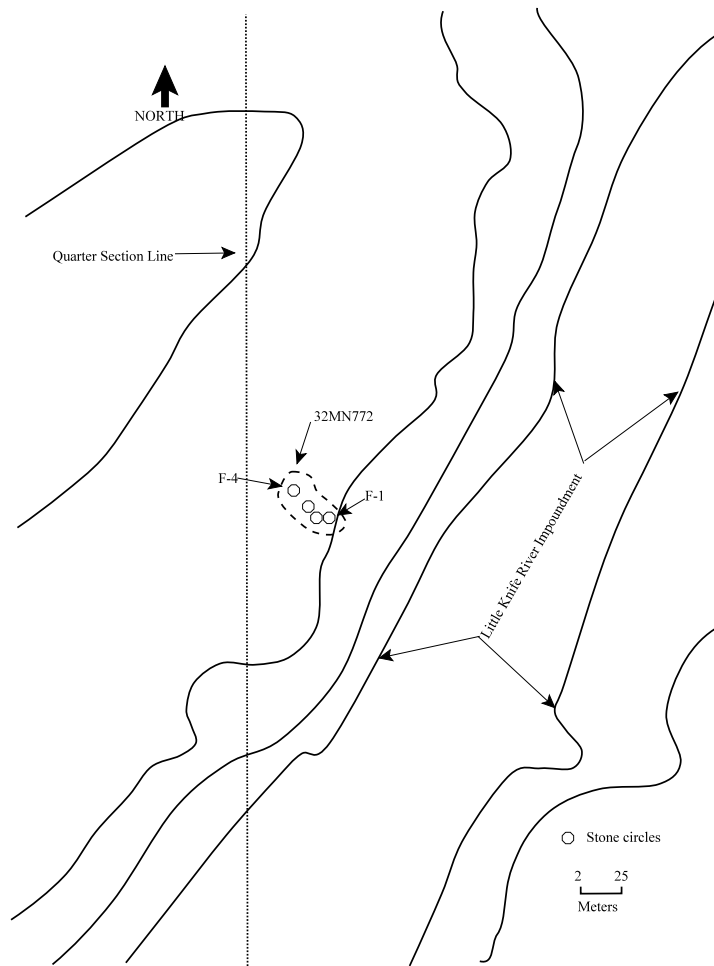

**Figure 13** Sketch map of site 32MN772.

Overall site integrity is good in that none of the features and the majority of the site area are undisturbed beyond cattle grazing. Several buried pipelines have been installed in the general area but no features were impacted. The site is recommended to be potentially eligible for the NRHP but evaluative testing would be necessary to make a definitive recommendation regarding eligibility. In lieu of testing site avoidance is recommended. The pipeline route through this section will be planned so as to avoid this and the other sites documented.

**32MN773** is comprised of a single cairn (Feature 1) measuring approximately 1.5m in diameter with 29 visible granitic rocks. The site is located on a terrace approximately 70m west of the Little Knife River (Figure 14 and Appendix B, page B-7). It is in an area of extensive pipeline activity and the cairn may possibly be associated with the pipeline construction although small rock piles are generally not left behind after pipeline installation. The cairn is somewhat smaller than would be expected for use as a burial cap although additional buried rocks surrounding the feature may be present. Its location on a terrace would allow for increased deposition over time at the site. This cairn is located nearly equidistant (200m) between two stone circle sites, 32MN772 to the south and 32MN460 to the northwest. It could be related to either of these sites.

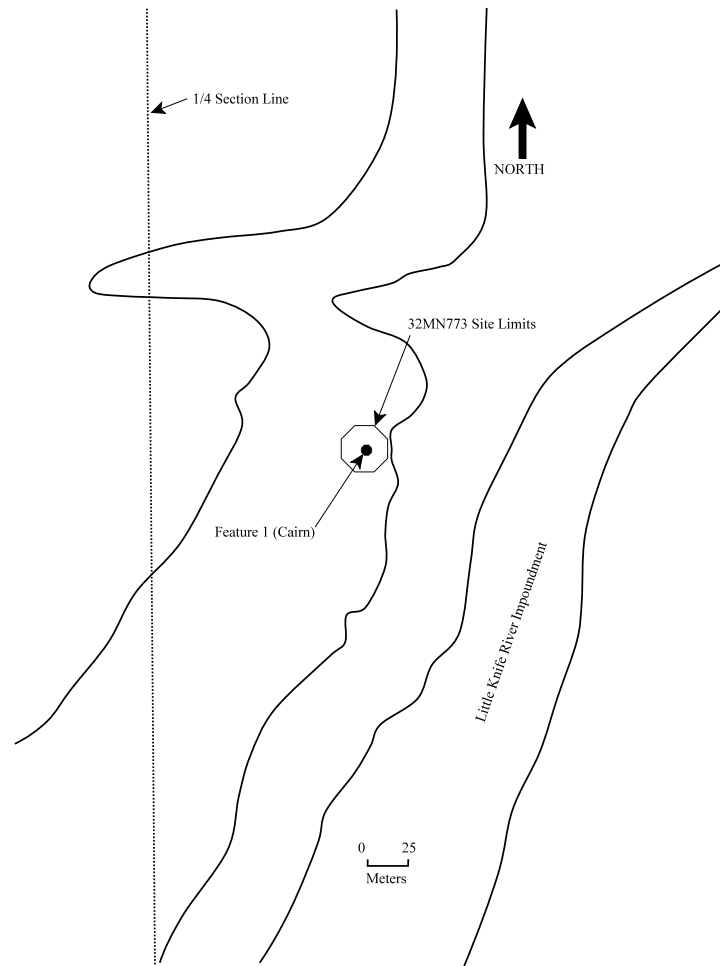

**Figure 14** Sketch map of site 32MN773.

Site integrity is fair. The area has been disturbed by past pipeline installation and it is unclear if the cairn is the result of construction activities or if it is prehistoric in origin. Regardless of origin the feature proper appears to be undisturbed. The site is recommended as potentially eligible for the NRHP and in lieu of evaluative testing site avoidance is recommended. The pipeline route through this section will be planned so as to avoid this and the other sites documented.

**32MN774** is comprised of three historic archaeological features located on uplands overlooking the Little Knife River approximately one half mile to the west (Figure 15 and Appendix B, page B-7). Feature 1 is a poured concrete slab measuring 4m east-west and 9m north-south. Feature 2 is a stationary automotive body. Feature 3 is an historic dump measuring 5m east-west and 7m north-south. Cultural materials in and around Feature 1 consisted of 100+ rusted and burned nails and several pieces of burned lumber. Feature 2's cultural materials were mainly confined to the stationary automotive body itself, the straight-6 cylinder motor still in the frame, but *sans* tires and wheels. Feature 3's cultural materials consisted of a miscellany of stones, bottles, chicken wire and cut granite and/or marble bricks.

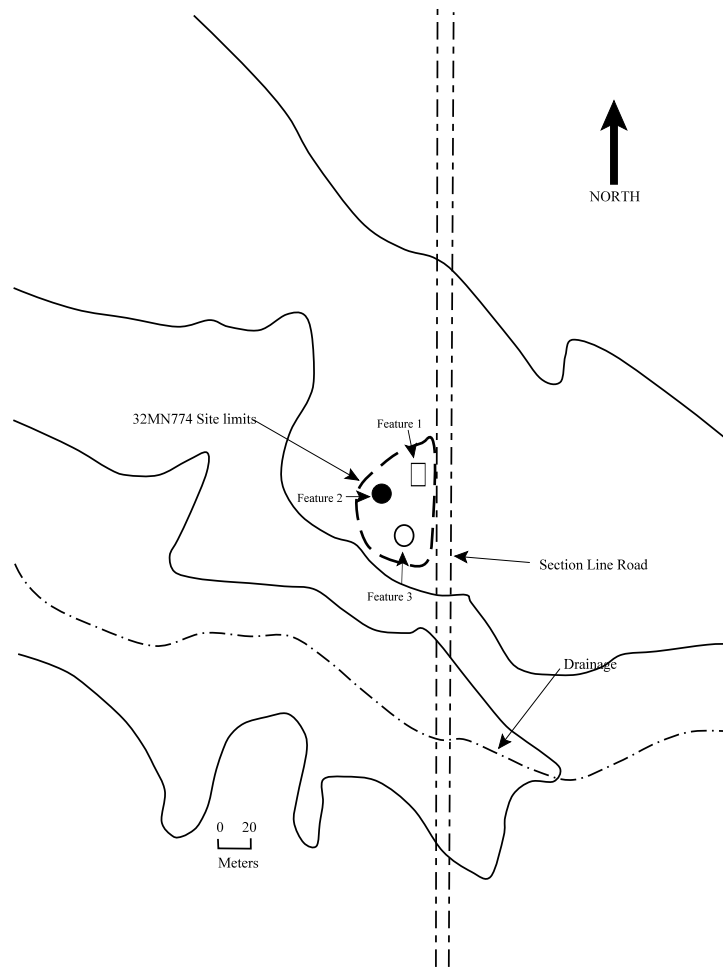

**Figure 15** Sketch map of site 32MN774.

On October 20, 2008 Michael L. Sondeland conducted a Deed Search for the SE/NE/SE of Section 27, T. 156 N., R. 91 W. of the records in the Mountrail County Courthouse, Stanley, North Dakota. According to the records, the United States Government granted the land to Edward Porter on May 5, 1908. Edward and Malissa J. Porter granted the land to Opfer Investment Company on August 27, 1912 and this investment company granted the land to John E. Strong on May 16, 1913. The land was granted to Paul R. LaBrant on December 19, 1927. Rose B. LaBrant took possession of the land on April 9, 1959 and Rose issued a Quit Claim Deed and granted the land to Adah M. Lattin on May 16, 1983. On October 14, 1983 Adah M. Lattin issued a Quit Claim Deed and granted the land to Grace H. Reiste. The Warranty Deed was granted to David J. Reiste on May 13, 1996.

On October 23, 2007 Aaron L. Barth submitted these names to the North Dakota Biography Index, and “Paul R. LaBrant” was the only name to generate an archival result. According to the Mountrail County Historical Society (1979), Paul R. LaBrant was born November 17, 1883 and originally hailed from farms near Spencer and Dickens, Iowa. In 1906, at the age of 23, he homesteaded around the Stanley, North Dakota area. Ida M. Batschelet, Paul’s first wife, was

born near Wilton, Iowa and homesteaded about 18 miles south of Stanley that same year. Paul courted Ida for a time and they married September 16, 1908. Originally, Paul built a house in Stanley and maintained various businesses including a harness and shoe repair, a tire shop and a grocery store. Eventually Paul built a house south of Stanley where he farmed. Ida LaBrant passed away in 1933 and Paul married Rose Batschelet (presumably related to Ida) in 1936.

Archival research revealed Paul LeBrant as being an early settler within Stanley, North Dakota, but the historic archaeological component is arguably not the best representation of this historic settlement trend. While the property retains certain aspects of integrity, including location and setting, its design, materials, workmanship, feeling and association have been compromised due to the fire that destroyed the standing structure.

According to the short biography, Paul LaBrant operated various businesses before farming but this site is unlikely the best symbol of either. To be eligible under Criterion A, “the property must have an important association with the event or historic trends and it must retain historic integrity” (NRB #15:12). The property is also recommended as *not eligible* under Criterion B, as “research has not revealed specific information about the person’s activities and their impact” (NRB #15:15). As there are no standing structures, Criterion C does not apply. We are not aware of a state wide research design that might offer a way to yield more information from what is already known. Furthermore, we recommend that the historical component of this site is *not eligible* under Criterion D (NRB #15:21). Thus, we recommend that the information potential is exhausted regarding the historical component of the site. We recommend that this site is not eligible for the NRHP and no site avoidance measures are recommended.

**32MN775** is composed of two features, a shed and a corral, likely used for farming or ranching. Feature 1 is a simple plan, one unit, wood outbuilding measuring 1.5m north-south by 1.5m east-west. Feature 2 is a wood corral measuring approximately 17m east-west and 13m north-south. The site is located on uplands overlooking the Little Knife River approximately 700m to the west (Figure 16 and Appendix B, page B-7). It is situated 180m east of a recently constructed residence.

Feature 1 is a simple plan, one unit outbuilding (a shed) measuring 1.5m north-south by 1.5m east-west (Appendix A, page A-5, Figures 25 and 26). Feature 1 rests on the surface soil rather than having any type of foundation proper. It is made of wood-frame construction and sided with horizontal drop- or German-siding, meaning each board has a concave upper edge that fits into a corresponding groove in the lower edge of the board above (Harris 1998: 104 & 152). The junction of each corner is cased in vertical siding. A batten door is on the southern wall, constructed with seven vertical planks held together by horizontal battens (Harris 1998: 24-25). Feature 1 measures approximately 2.5m tall on its southern elevation and approximately 2m tall on its northern elevation; the shed roof pitching accordingly to the north. The shed roof rafters are framed with 2"-x-4" lumber and covered with plywood.

Feature 2 is a wood corral measuring approximately 17m east-west, and 13m north-south.

The corral is of post-and-rail fence design and has vertical posts of various sizes set into the ground. These posts are interconnected by horizontal fencing, primarily of 2"-x-6" lumber (Harris, 1998: 256). A livestock “chute,” or ramp, measuring 1.5m east-west by 1.5m north-south, is located in the southeast corner of the corral.

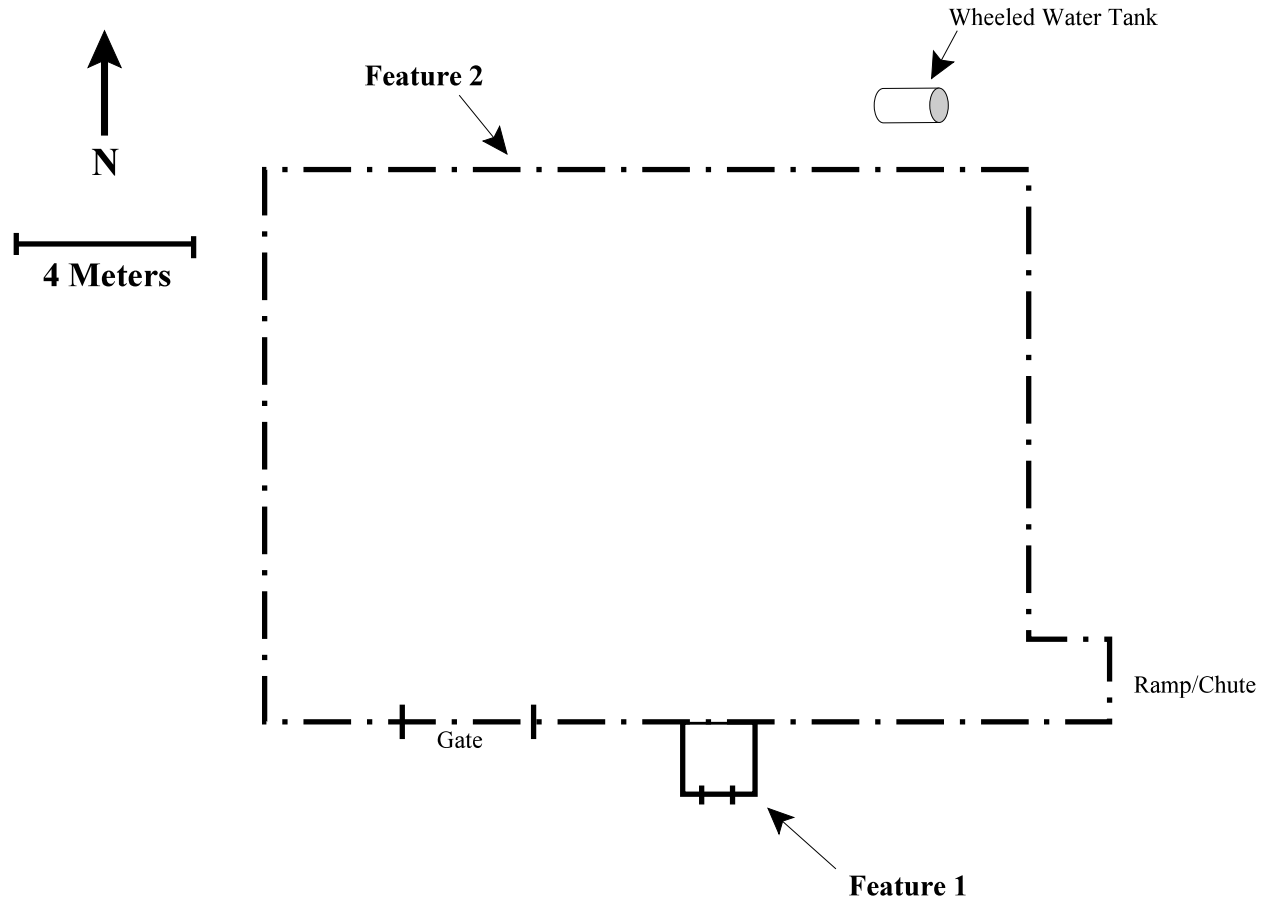

**Figure 16** Sketch map of site 32MN775.

On October 20, 2008 Michael L. Sondeland conducted a Deed Search for the SW/SE/SE of Section 27, T. 156 N., R. 91 W. of the records in the Mountrail County Courthouse, Stanley, North Dakota. According to the records, the United States Government granted the land to Edward Porter May 5, 1908. Edward and Malissa J. Porter granted the land to Opfer Investment Company on August 27, 1912 and this investment company granted the land to John E. Strong on May 16, 1913. The land was granted to Paul R. LaBrant on December 19, 1927. Rose B. LaBrant took possession of the land on April 9, 1959 and Rose issued a Quit Claim Deed and granted the land to Adah M. Lattin on May 16, 1983. On October 14, 1983 Adah M. Lattin issued a Quit Claim Deed and granted the land to Grace H. Reiste. The Warranty Deed was granted to David J. Reiste on May 13, 1996.

On October 23, 2007 Aaron L. Barth submitted these names to the North Dakota Biography Index, and like site 32MN774, “Paul R. LaBrant” was the only name to generate an archival result. According to the Mountrail County Historical Society (1979), Paul R. LaBrant was born November 17, 1883 and was raised on farms near Spencer and Dickens, Iowa. He homesteaded around the Stanley, North Dakota area in 1906 at the age of 23. Ida M. Batschelet, Paul’s first wife, was born near Wilton, Iowa and homesteaded about 18 miles south of Stanley that same year. Paul courted Ida for a time and they married September 16, 1908. Paul built a house in Stanley and maintained various businesses including a harness and shoe repair, a tire shop and a grocery store. Eventually, Paul built a house south of Stanley where he farmed. Ida LaBrant passed away in 1933 and Paul married Rose Batschelet (presumably related to Ida) in 1936.

Feature 1 retains several aspects of integrity including design, materials and workmanship, but to varying degrees, lacks the aspects of location, setting, feeling and association. Feature 1 does reflect what might be referred to as more utilitarian function rather than high-brow aesthetic design. The design, in turn, reflects the materials, the physical elements combined to make this a shed. The workmanship is reflected in the physical evidence, symbolizing, perhaps, that “rugged individualism” Frederick Jackson Turner once said was so necessary to the eventual settling of the American West. However, since Feature 1 rests on wood skids and posts rather than a foundation proper, there is reason to suspect that its current location is not its original (at least not definitively), thus destroying any kind of relationship it may have had with historic associations. Similar to this reasoning, the setting as capable of accurately reflecting the designer’s historic concept of nature and aesthetics is questionable. The aspect of feeling is lacking, as the physical features, taken together, do not convey the property’s historic character, as the temporal associations have been disturbed.

Feature 2 retains several aspects of integrity including location and setting, design, materials and workmanship, but to varying degrees, lacks certain aspects of feeling and association. With the vertical posts set in the ground, Feature 2 does reflect what might be referred to as more utilitarian function rather than high-brow aesthetic of location and design. The design, in turn, reflects the materials, the physical elements combined to make this corral. The workmanship as well is reflected in this physical evidence, symbolizing, perhaps, that “rugged individualism” Frederick Jackson Turner once said was so necessary to the eventual settling of the American West. However, the aspect of feeling is lacking, as the physical features, taken together, do not convey the property’s historic character, as the temporal associations have likely been disturbed. As for association, research did not reveal a direct link between the property and an important historic event or person (NRB #15, 1997: 44-45).

According to the short biography, Paul LaBrant operated various businesses before farming, but this site is unlikely the best symbol of either. To be eligible under Criterion A, a feature or “property must have an important association with the event or historic trends and it must retain historic integrity” (NRB #15:12). Research did not reveal a direct link between the property and an important historic event. The site is recommended as *not eligible* under Criterion A. Both features are also recommended as *not eligible* under Criterion B, as “research has not revealed specific information about the person’s activities and their impact” (NRB #15:15). In order for an architectural

structure to be eligible under Criterion C, it must embody distinctive characteristics of a type, period or method of construction, represent the work of a master and possess high artistic value. We recommend that the site does not suggest this and is *not eligible* under Criterion C. We are not aware of any state wide research design that might offer a way to yield more information from what is already known, and therefore we recommend the site as *not eligible* under Criterion D (NRB #15:21). No site avoidance measures are recommended.

**32MN460** is a stone circle site comprised of four features. The site is located on a rise overlooking the Little Knife River approximately 275m to the west and immediately overlooking a seasonal drainage to the south (Figure 17 and Appendix B, page B-7). This site was originally recorded in 1990 by Oliver and Burbidge of the University of North Dakota Anthropology Department. The features are 4m, 5m, 4.5m and 5m, respectively. The site area is carpeted with granite rocks which when coupled with high grass made it difficult to discern the individual features. On August 26, 2008 it was revisited by MAC as part of a forty acre inventory and is reported in *Enbridge Stanley Station: A Class III Cultural Resource Inventory in Mountrail County, North Dakota* (Stine 2008). A site form update was filed at that time although there was no readily apparent change from the original recording. The UTM coordinates of the features were recorded with a Garmin GPS unit and the site was remapped at that time. This is one of two stone circle sites documented west of the Little Knife River within the project block.

The site has good integrity as the area is relatively undisturbed. The site is recommended as potentially eligible for the NRHP but evaluative testing would be necessary in order to accurately assess eligibility. In lieu of testing avoidance is recommended. The pipeline route through this section will be planned so as to avoid this and the other sites documented.

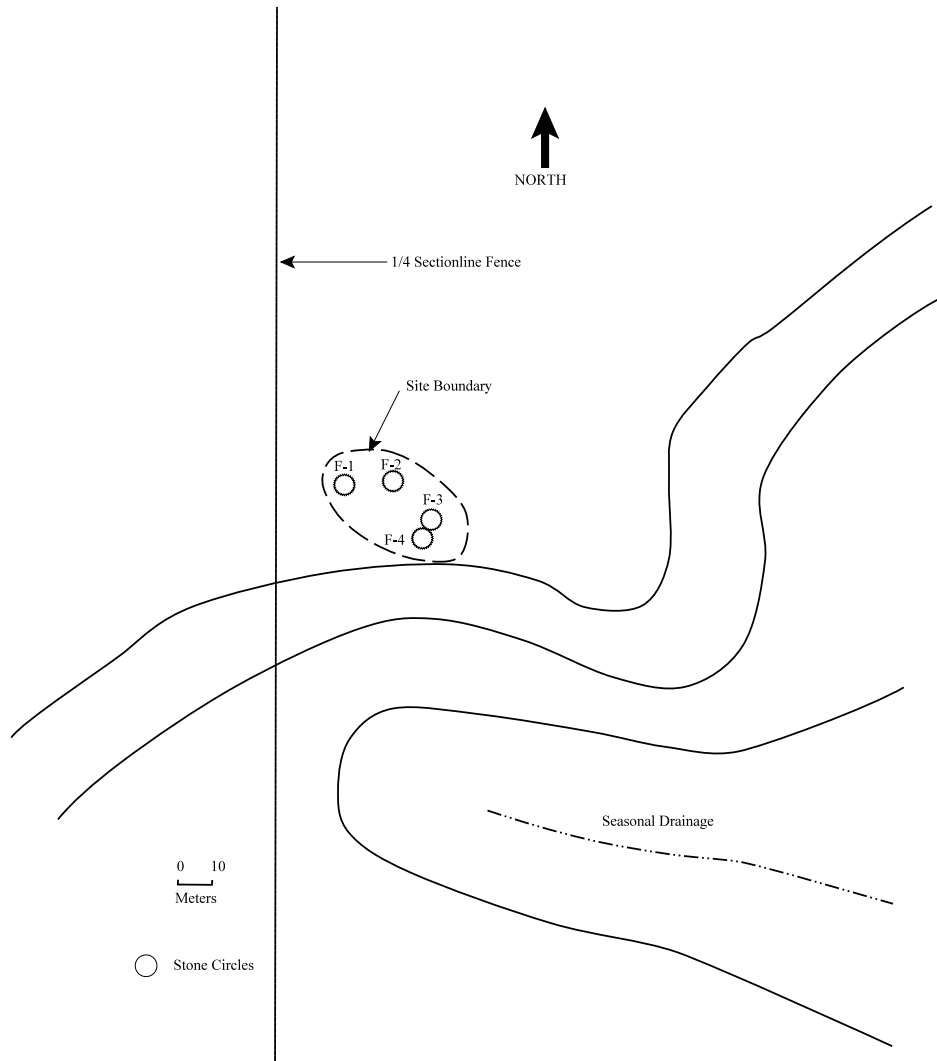

**Figure 17** Sketch map of site 32MN460.

**32MN461** was first recorded in 1990 by Burbidge of the University of North Dakota Anthropology Department. When recorded 19 stone circles were identified. They ranged from 2.5-to-7m in diameter (Feature 17 was listed as 17m in diameter but this is probably a typo). During the re-visit of the site 12 stone circles were identified (Figure 18 and Appendix B, page B-7). Overall the site description is unchanged although locations of identified circles do not correspond well with positions on the original site sketch map. The original site form noted that vegetation was dense at the time of the inventory. This statement holds true to the current revisit. All of the stone circles are very well sodded and many were nearly obscured by vegetation and the degree of sodding. Nine of the circles originally documented could not be relocated due to excessively tall and dense vegetation east of a fence line. None of the circles identified during the revisit can be, with any certainty, directly correlated with those originally mapped. During the revisit more circles were identified along the north and west edges of the site and fewer were identified south and east. The site area was mapped and expanded to include newly identified features. The stone circles ranged from 4.0-to-7.0m in diameter, were well sodded and likely have some completely buried rocks. Given the degree of sodding it is possible, although admittedly unlikely, that some circles have been completely buried since the site was first recorded 18 years ago. It is quite possible that there are some completely buried circles unidentifiable during either survey of the site.

No cultural materials were observed when the site was originally recorded. Two pieces of lithic flaking debris were observed during the current project revisit. They include a secondary gray chert flake and a heavily patinated petrified wood core/tested raw material.

The site is situated on the crest of a large hill overlooking the Little Knife River approximately 200m to the west and a seasonal drainage 60m to the north. The nine other circles and cairn sites documented in the inventory block are all visible from this site and the possibility of a relationship between 32MN461 and any of these other sites cannot be discounted.

The site has good integrity with disturbance limited to cattle grazing and small mammal burrowing. There are a series of buried pipelines nearby but none seem to cross the site area. The site is recommended as potentially eligible for the NRHP. Evaluative testing would be needed to make a more definitive eligibility recommendation. In lieu of testing site avoidance is recommended. The pipeline route through this section will be planned so as to avoid this and the other sites documented.

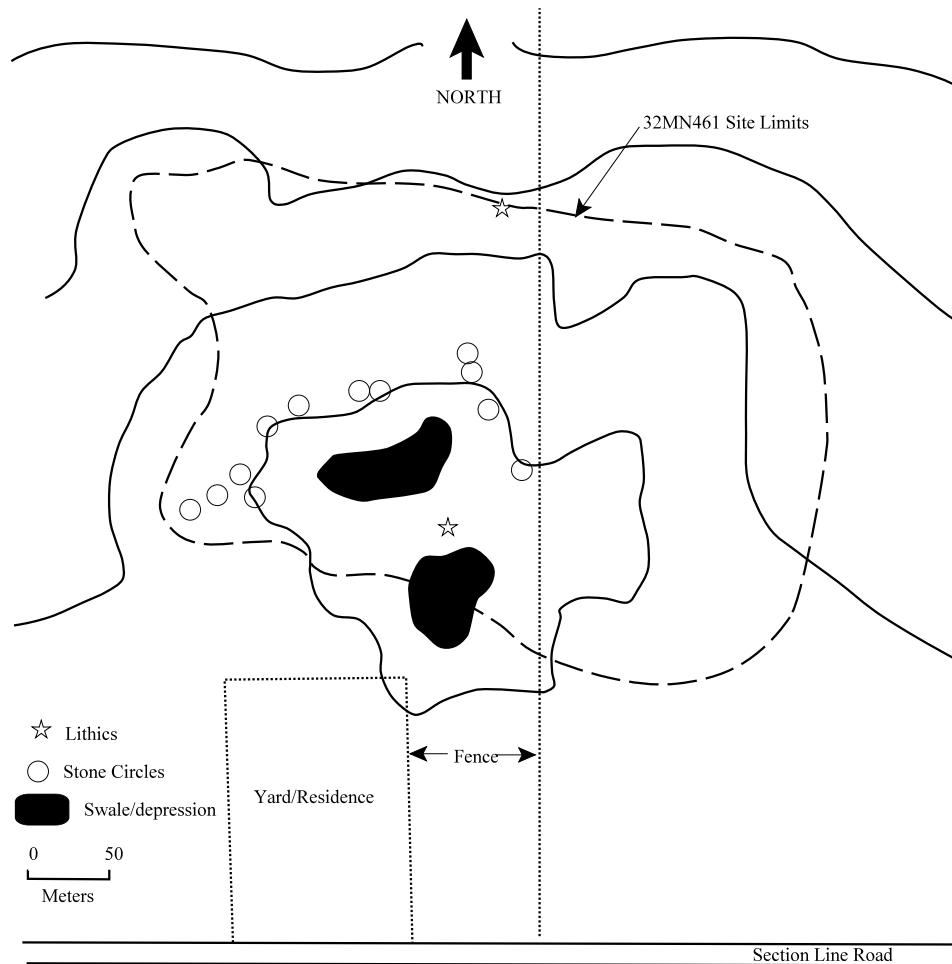

**Figure 18** Updated sketch map of 32MN461.

**32MNx12** is an isolated find consisting of two KRF artifacts, a tertiary flake and a core fragment. The isolate was documented along the gas pipeline scar in an area with numerous potholes and sloughs (Appendix B, page B-3). Ground surface visibility was nearly 100% in the corridor at the time of the inventory. We recommend that this isolate is not eligible for the NRHP and no avoidance is recommended.

**32MNx385** is an isolated find consisting of one KRF flake fragment. The isolate was documented along the recent gas pipeline scar (Appendix B, page B-5). Ground surface visibility was nearly 100% in the corridor at the time of the inventory. We recommend that this isolate is not eligible for the NRHP and no avoidance is recommended.

**32MNx459** is an isolated find consisting of a secondary KRF flake, possibly utilized. The isolate was documented along the recent gas pipeline scar (Appendix B, page B-4 and B-5). Ground surface visibility was nearly 100% in the corridor at the time of the inventory. We recommend that this isolate is not eligible for the NRHP and no avoidance is recommended.

*32MNx541* is an isolated find consisting of a secondary Swan River chert (SRC) flake. The isolate was documented in a plowed field adjacent to the recent gas pipeline scar (Appendix B, page B-5). Ground surface visibility was approximately 20% in the field and nearly 100% in the pipeline scar. We recommend that this isolate is not eligible for the NRHP and no avoidance is recommended.

*32MNx543* is an isolate consisting of a single KRF tool fragment, possibly a broken end scraper. The isolate was documented in a plowed field adjacent to the recent gas pipeline scar (Appendix B, page B-5). Ground surface visibility was approximately 30 to 70% in the field and nearly 100% in the pipeline scar. We recommend that this isolate is not eligible for the NRHP and no avoidance is recommended.

*32MNx544* is an isolate consisting of a single SRC secondary flake. The isolate was documented in a plowed field adjacent to the recent gas pipeline scar (Appendix B, page B-6). Ground surface visibility was approximately 30 to 60% in the field and nearly 100% in the pipeline scar. We recommend that this isolate is not eligible for the NRHP and no avoidance is recommended.

## **Evaluation of Research**

The purpose of the inventory was to identify any cultural resources within the project corridor and project block so that the resources could be avoided by a proposed oil pipeline. The pipeline followed immediately east of a recently installed gas line making identification of the route very clear during the inventory. The scar from the recent pipeline also provided good GSV along the corridor length. Approximately half of the inventory acreage was in a block of native prairie east of the Stanley Station. With the exception of a small strip along the east edge of previously recorded site, 32MN461, field conditions were more than adequate. Grasses were ungrazed, dense, and high in that location. Fortunately that portion of the block and site had been inventoried in 1990 by the University of North Dakota Anthropology Department. Nineteen sites and six isolated finds were documented or revisited during the course of the inventory and our objectives were achieved.

## **Summary and Recommendations**

The inventory resulted in the identification of 17 previously undocumented sites as well as the revisit of two previously documented sites. Six isolated finds were also encountered. Four of the sites (all historic) and all six isolates are recommended as not eligible for the NRHP and no avoidance is recommended. These locations are: 32MN759, 32MN761, 32MN774, 32MN775, 32MNx12, 32MNx385, 32MNx459, 32MNx541, 32MNx543 and 32MNx544. Two other historic sites, 32MN760 and 32MN766, are also recommended as not eligible for the NRHP but each has a suspected human grave within the site limits and avoidance of the possible graves is obviously recommended. Three potentially eligible sites, 32MN762, 32MN763 and 32MN764, are located within or immediately adjacent to the project corridor. Fencing off of the site's features during

construction is recommended at 32MN762 and 32MN763. A reroute was inventoried to the east of 32MN764 and provides a 30m buffer between the site and the edge of the proposed construction corridor. The remaining sites are located within a 240-acre block east of the Stanley Station, the pipeline terminus. The pipeline route through this block was left to be decided on after this inventory had been completed in order to use the inventory data for site avoidance. Sites to be avoided within the block are 32MN765 through 32MN773, 32MN460 and 32MN461. The sites and treatment recommendations are listed in Table 1, page 5 of this report. For convenience it is also included below.

Provided that the sites, as discussed above and in Table 1, are avoided a finding of *No Adverse Affect* is recommended for this undertaking as surveyed, mapped and described herein.

<b>Table 1: Robinson Lake Survey Sites</b>			
<b>Site #</b>	<b>Description/# of Features</b>	<b>NR Eligibility Recommendation</b>	<b>Treatment Recommendation</b>
32MN759	Road bed/1	No	No avoidance
32MN760	Historic/4	No	Avoid , Feature 2 possible grave
32MN761	Historic/2	No	No avoidance
32MN762	Pre-contact/5 and Historic/7	Undetermined	Avoid, fence during construction
32MN763	Pre-contact Stone Circle/1	Undetermined	Avoid, fence during construction
32MN764	Pre-contact Stone Circles/3	Undetermined	Avoid, reroute surveyed
32MN765	Pre-contact Stone Circles/2	Undetermined	Avoid
32MN766	Historic Foundations/7	No	Avoid, Feature 2 possible grave
32MN767	Pre-contact Stone Circle/1	Undetermined	Avoid
32MN768	Pre-contact Stone Circle/1	Undetermined	Avoid
32MN769	Pre-contact Cairn/1	Undetermined	Avoid
32MN770	Pre-contact Stone Circle/1	Undetermined	Avoid
32MN771	Pre-contact Cairn/1	Undetermined	Avoid
32MN772	Pre-contact Stone Circles/4	Undetermined	Avoid
32MN773	Pre-contact Cairn/1	Undetermined	Avoid
32MN774	Historic Foundation/3	No	No avoidance
32MN775	Architectural Corral/1	No	No avoidance
32MN460	Pre-contact Stone Circles/4	Undetermined	Avoid
32MN461	Pre-contact Stone Circles/12	Undetermined	Avoid

<b>Table 1: Robinson Lake Survey Sites</b>			
<b>Site #</b>	<b>Description/# of Features</b>	<b>NR Eligibility Recommendation</b>	<b>Treatment Recommendation</b>
32MNx12	Pre-contact isolate	No	No avoidance
32MNx385	Pre-contact isolate	No	No avoidance
32MNx459	Pre-contact isolate	No	No avoidance
32MNx541	Pre-contact isolate	No	No avoidance
32MNx543	Pre-contact isolate	No	No avoidance
32MNx544	Pre-contact isolate	No	No avoidance

There is always the potential during construction to encounter previously unknown cultural resources or human remains. In the event an unanticipated discovery is encountered, we recommend the following measures to minimize the potential impacts.

- Construction crews should stop work in the vicinity (100 ft in all directions from discovery) and notify the consulting archaeologist who will investigate the discovery and notify the Chief Archaeologist at North Dakota State Historic Preservation Office (NDSHPO). If the discovery consists of human remains NDSHPO will notify the North Dakota State Health Department, law enforcement and Tribal Representatives.
- Work will be prohibited in the vicinity of the unanticipated discovery until all appropriate contacts, consultation, evaluations, dispositions, treatments and authorizations have been obtained.

## References Cited

- Gregg, Michael L. Cynthia Kordecki, David D. Kuehn, and Kenneth Vander Steen  
1985 *Southwest Pipeline Archeology: Initial Survey of Selected Tracts*. University of North Dakota Archeological Research, Department of Anthropology, University of North Dakota, Grand Forks, North Dakota
- Harris, Cyril M.  
1998 *American Architecture: An Illustrated Encyclopedia*. New York, NY: W. W. Norton and Company
- Mountrail County Historical Society  
1979 *Tales of Mighty Mountrail: A History of Mountrail County, North Dakota Vol. I*  
Dallas, Texas: Taylor Publishing Company
- North Dakota Biography Index visited on October 13, 2008:  
<http://www.lib.ndsu.nodak.edu/ndirs/databases/bio.php>
- State Historical Society of North Dakota (SHSND)  
1990 *North Dakota Comprehensive Plan for Historic Preservation: Archeological Component*  
Archeology and Historic Preservation Division, State Historical Society of North Dakota, Bismarck, North Dakota
- United States Department of the Interior  
1997 *National Register Bulletin 15: How to Apply the National Register Criteria for Evaluation*  
Washington, D.C.
- Vander Busch, Darrell  
1991 *Soil Survey of Mountrail County, North Dakota*. United States Department of Agriculture. Soil Conservation Service, in Cooperation with North Dakota Agricultural Experiment Station, North Dakota Cooperative Extension Service, North Dakota State Soil Conservation Committee, and United States Department of the Interior, Bureau of Indian Affairs

**Appendix A:**  
Project Photographs



**Figure 19** View to the north over existing pipeline and sites 32MN760 and 32MN761 (image 903).



**Figure 20** View to the north over gas pipeline and 32MN764, Feature 1 (image 452).



**Figure 21** View to the north over 32MN765, Feature 1 (image 454).



**Figure 22** View to the west over 32MN767 (image 461).



**Figure 23** View to the west-northwest over 32MN768 (image 462).



**Figure 24** View to the northwest over 32MN771, Feature 1 (image 466).

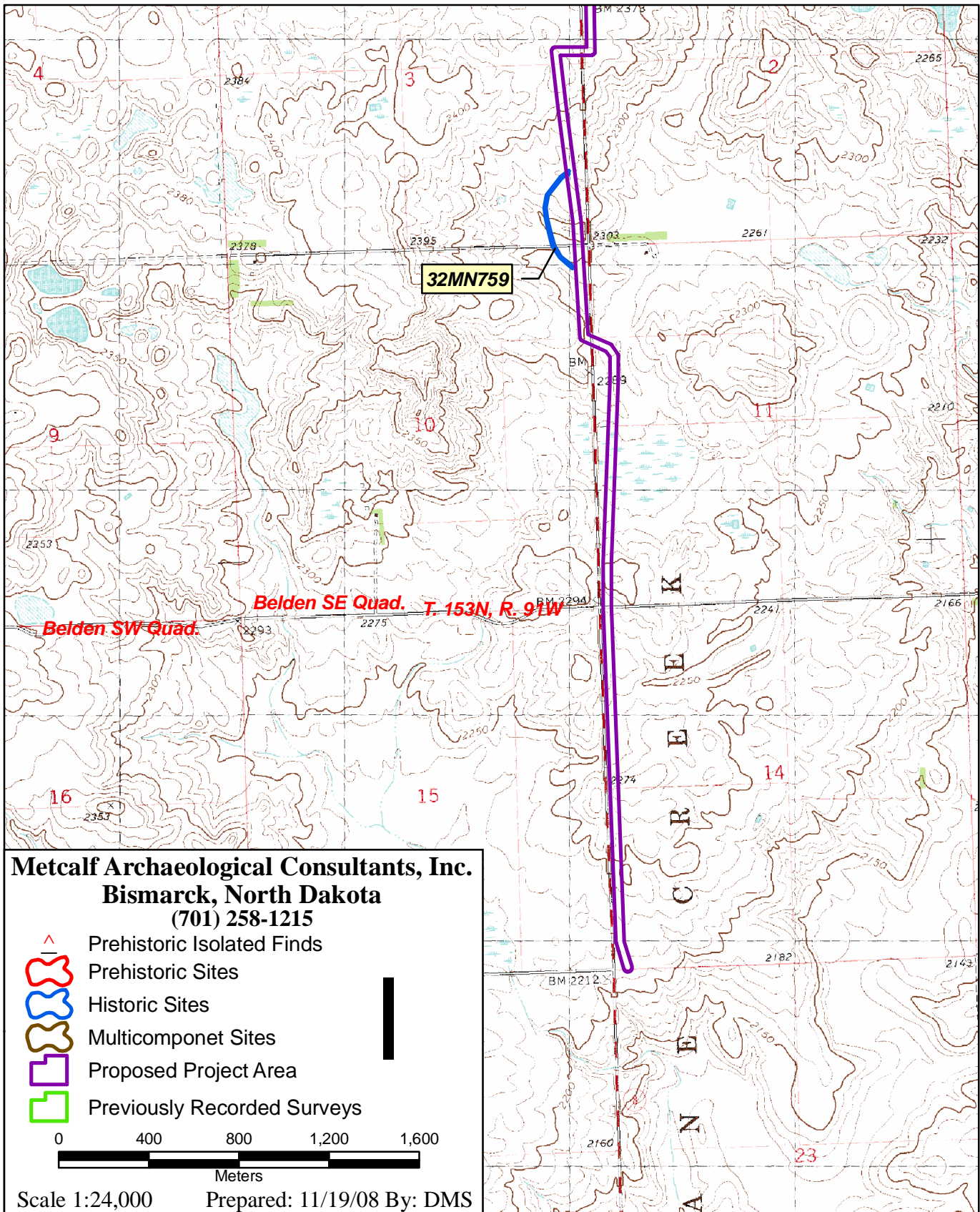

**Figure 25** View to the northeast over Features 1 and 2, 32MN775 (image 479).

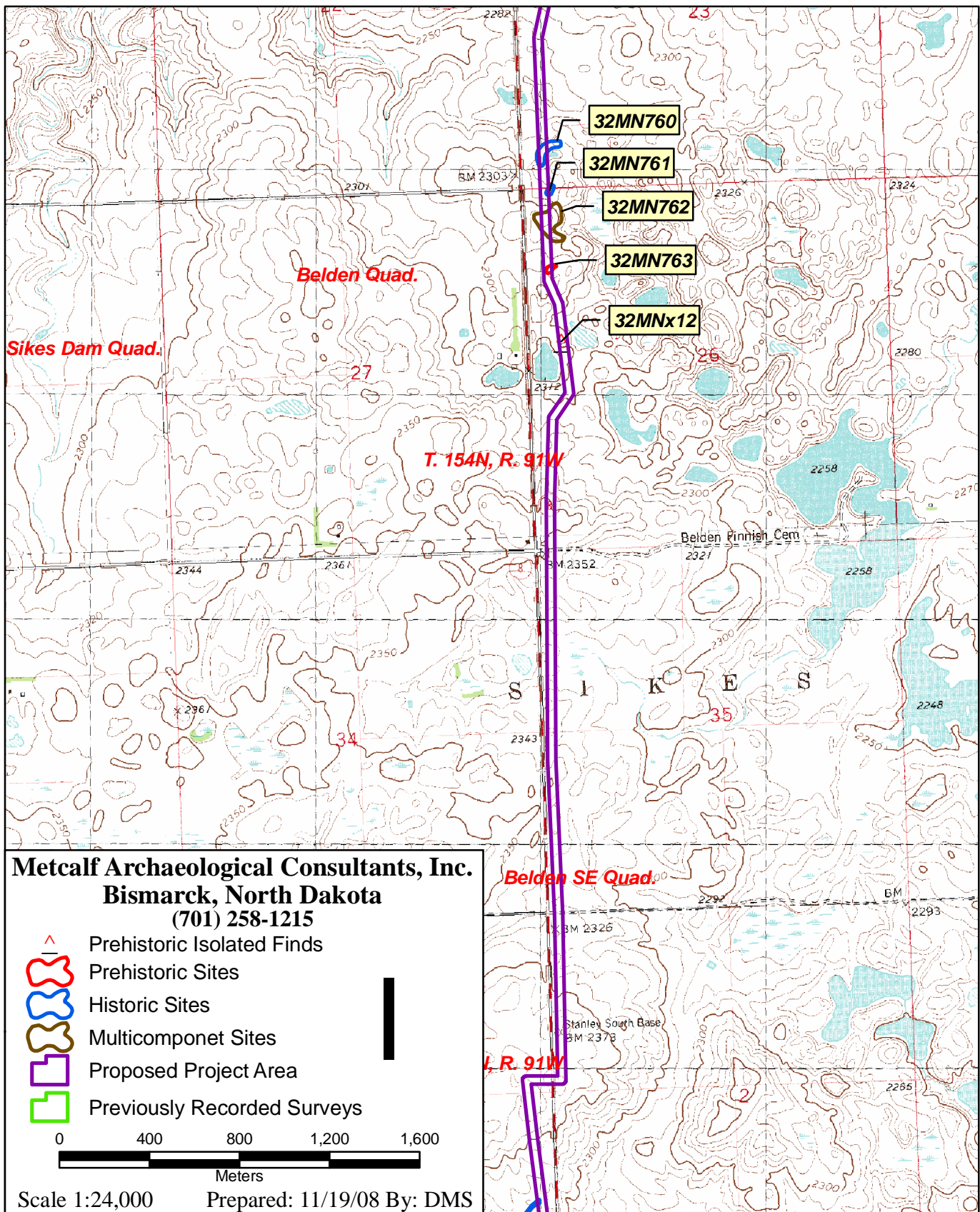

**Figure 26** View to the southwest over Features 1 and 2, 32MN775 (image 480).

**Appendix B:**  
Project Maps



**Figure 27:** Location of the proposed project area and site 32MN759 as depicted on the USGS 7.5' Belden SE (1981) quadrangle map.



**Figure 28:** Location of the proposed project area and sites 32MN760, 32MN761, 32MN762, 32MN763, and 32MNx12 as depicted on the USGS 7.5' Belden (1981) and Belden SE (1981) quadrangle maps.

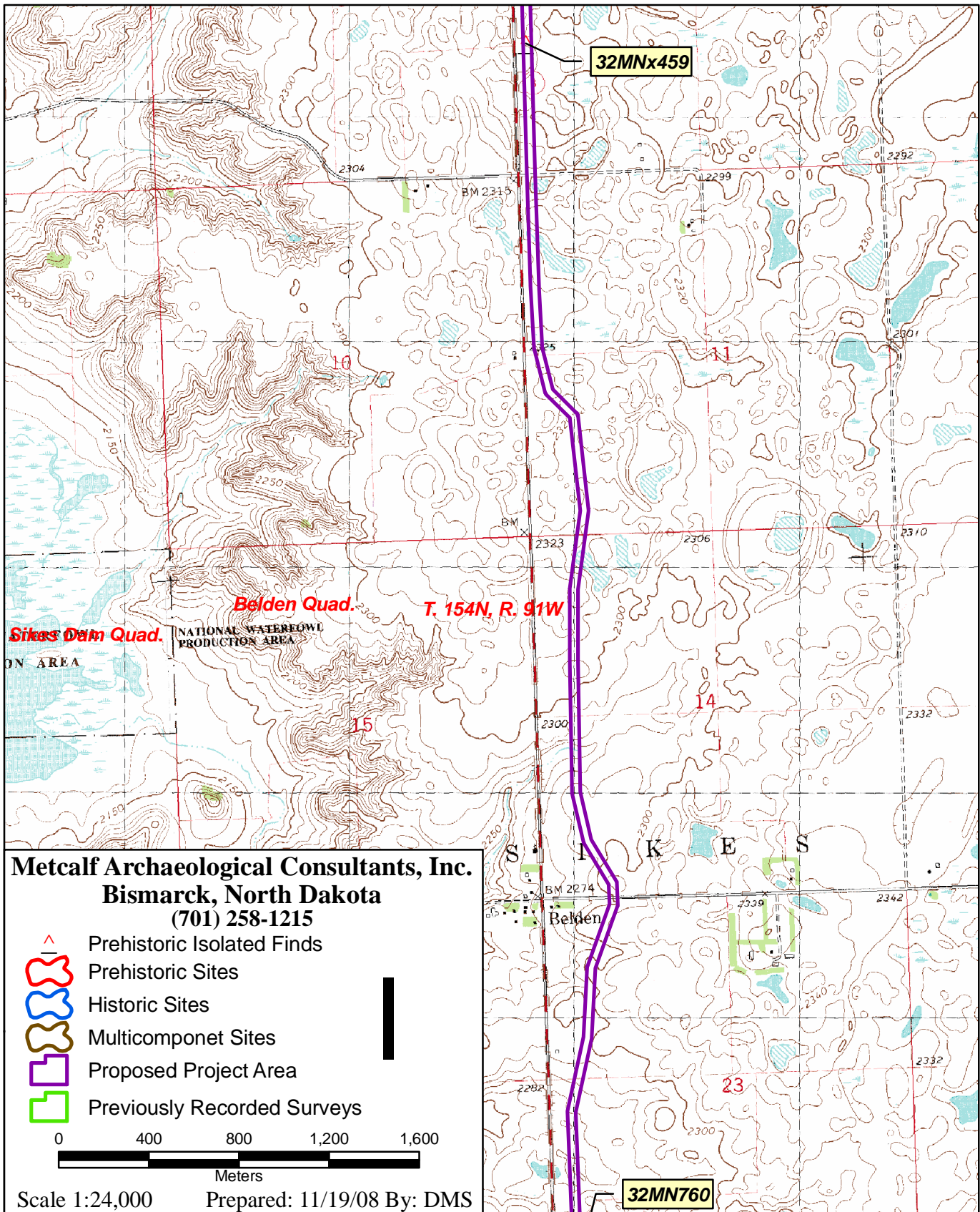

**Figure 29:** Location of the proposed project area and site 32MNx459 as depicted on the Belden (1981) quadrangle map.

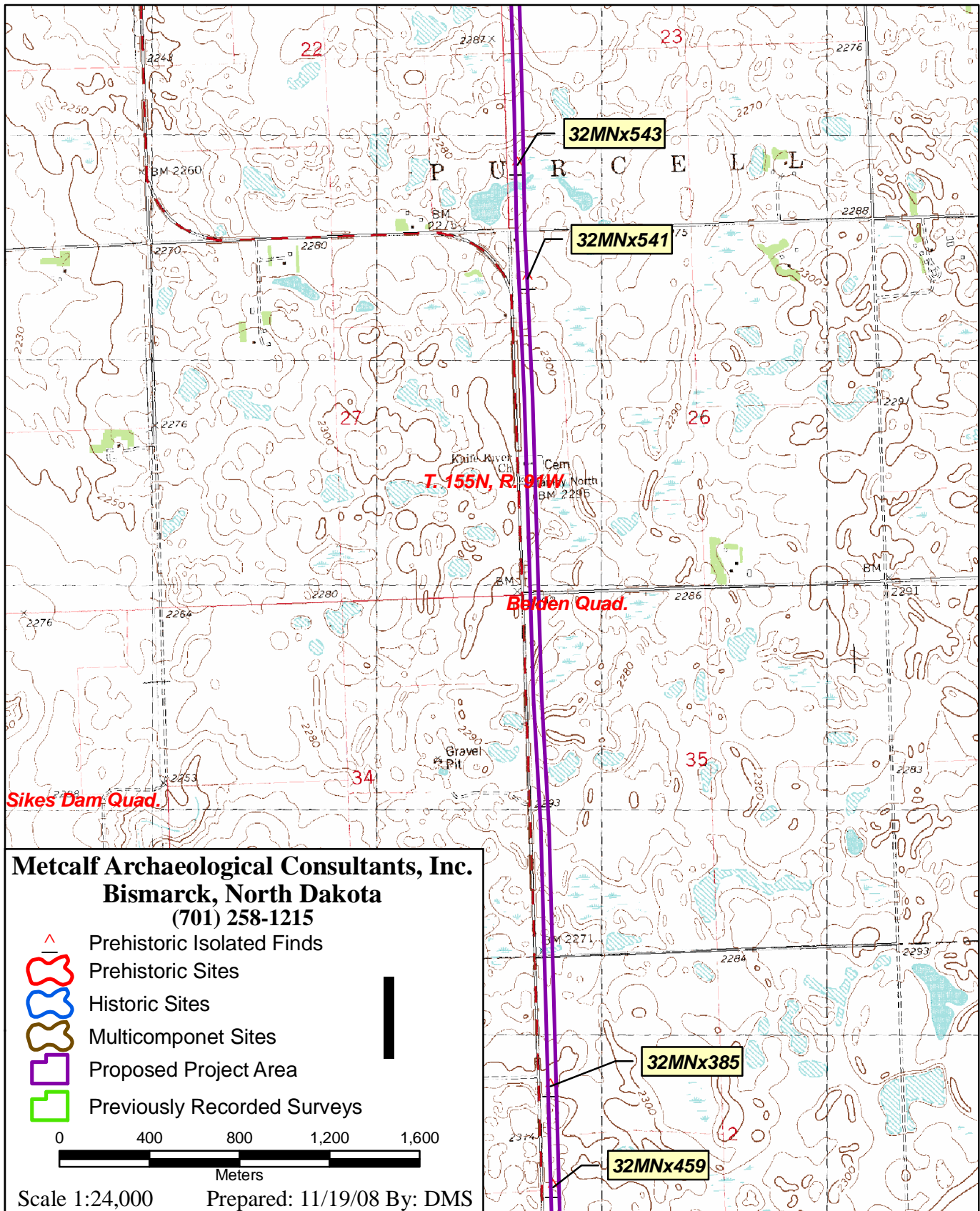

**Figure 30:** Location of the proposed project area and sites 32MNx459, 32MNx385, 32MNx541, and 32MNx543 as depicted on the USGS 7.5' Belden (1981) quadrangle map.

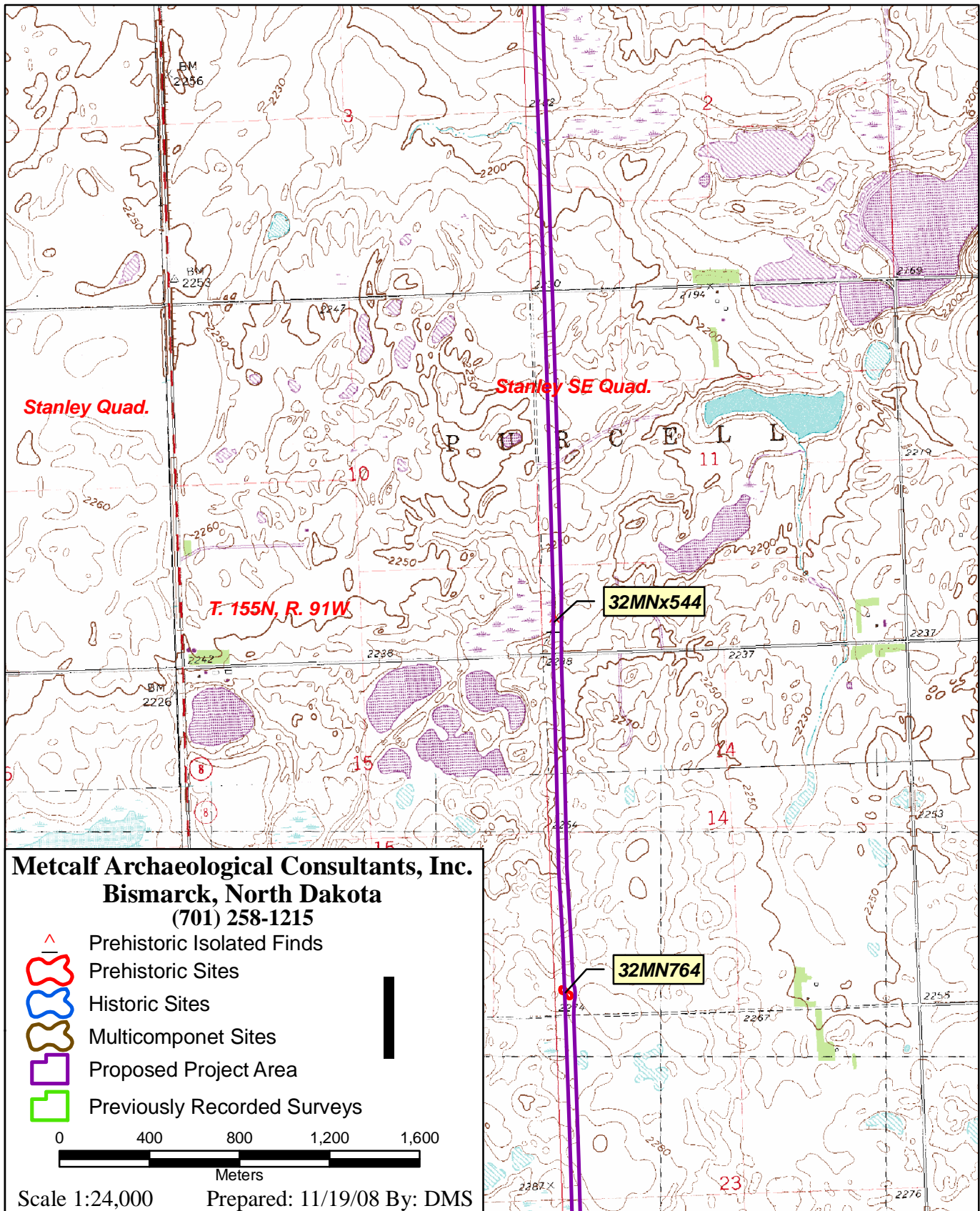

**Figure 31:** Location of the proposed project area and sites 32MN764 and 32MNx544 as depicted on the USGS 7.5' Belden (1981) and Stanley SE (1969) photorevised (1981) quadrangle maps.

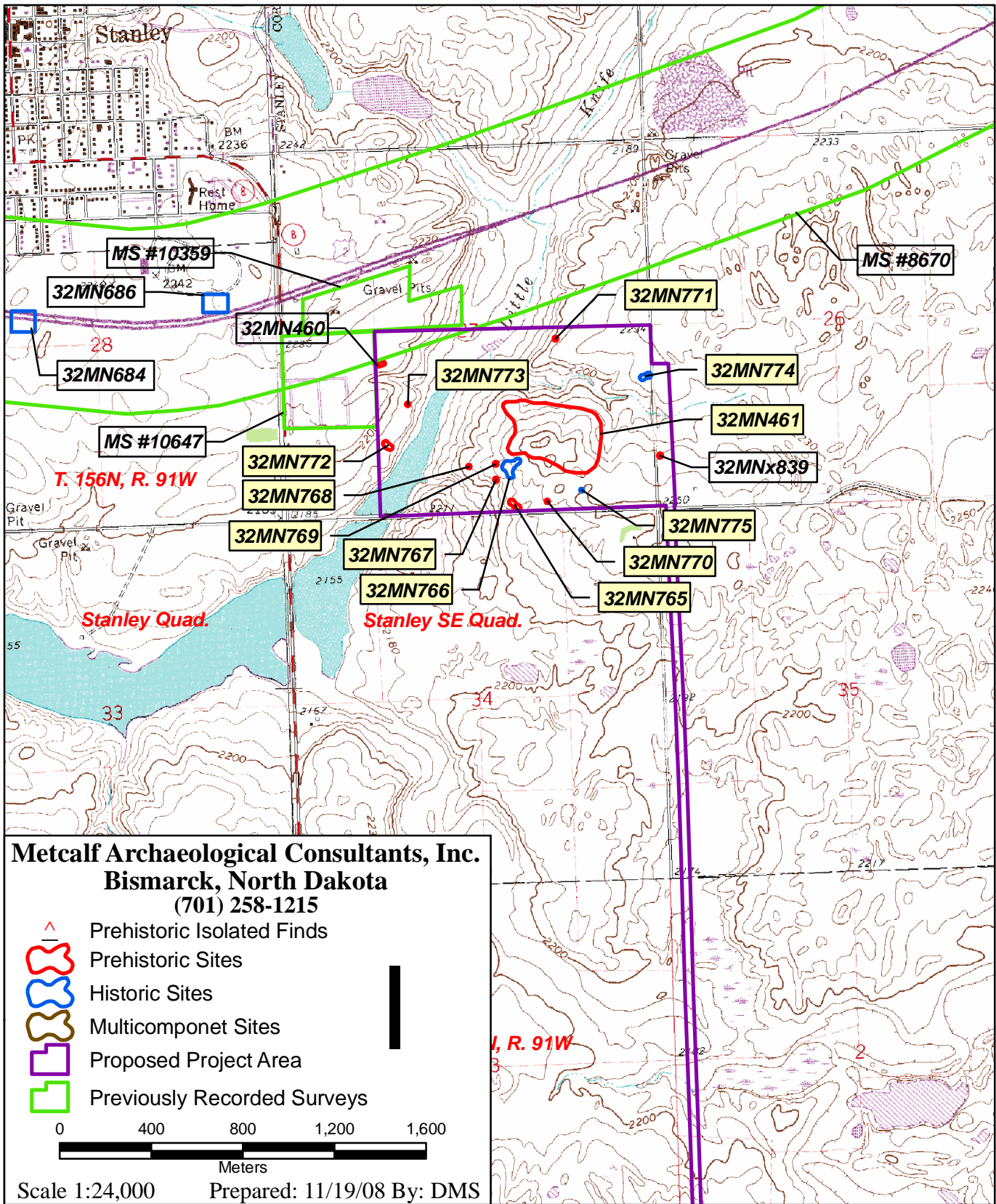

**Figure 32:** Location of the proposed project area and sites 32MN461, 32MN765, 32MN766, 32MN767, 32MN768, 32MN769, 32MN770, 32MN771, 32MN772, 32MN773, 32MN774, and 32MN775 as depicted on the USGS 7.5' Stanley SE (1969 photorevised 1981) quadrangle map.

**Appendix C:**  
Files Search Results

T/R-Sec.	SITS #	Historic	Prehistoric	Recorder, Date	MS #
153/91-2	no sites/no surveys				
153/91-3	no sites/no surveys				
153/91-10	no sites/no surveys				
153/91-11	no sites/no surveys				
153/91-14	no sites/no surveys				
153/91-15	no sites/no surveys				
153/91-22	32MNx112		cultural material scatter	Hecker, 1938	8770 9380
153/91-23	no sites/no surveys				
154/91-2	no sites/no surveys				
154/91-3	no sites/no surveys				
154/91-10	no sites/no surveys				
154/92-11	no sites/no surveys				
154/91-14	no sites/no surveys				
154/91-15	no sites/no surveys				
154/91-22	no sites/no surveys				
154/91-23	no sites/no surveys				
154/91-26	no sites/no surveys				
154/91-27	no sites				10276
154/91-34	no sites				10276
154/91-35	no sites/no surveys				
155/91-2	no sites				10359
155/91-3	no sites				6449
155/91-10	no sites/no surveys				
155/91-11	no sites				10359
155/91-14	no sites				311 10359
155/91-15	no sites/no surveys				
155/91-22	no sites/no surveys				

T/R-Sec.	SITS #	Historic	Prehistoric	Recorder, Date	MS #
155/91-23	no sites/no surveys				
155/91-26	no sites/no surveys				
155/91-27	no sites/no surveys				
155/91-34	no sites/no surveys				
155/91-35	no sites/no surveys				
156/91-26	32MNx839		chipped stone	Tyberg, 2007	261 8670 10359
156/91-27	32MN460		stone circle	Stine, 2008	261 8670 10359
	32MN461		pit, stone circle	Burbridge, 1990	10647
156/91-28	32MN632	Stanley Grandstand		Perkl and Mitchell, 2001	261 5986 8670 10324
	32MN633	Flickertail Village		Mitchell, 2001	
	32MN684	Marantha Assembly of God		Van Hale, 1999	
	32MN685	Our Saviors Free Lutheran		Van Hale, 1999	
	32MN686	Saint Margaret Catholic		Van Hale, 1999	
	32MN702	Nelson Farmstead		Mitchell, 2001	
	32MN750	Fred Alger House, stone house		Fandrich, 2007	
	32MN751	Marlene Sonderson Duplex		Fandrich, 2007	
	32MN752	Alda Rice House		Fandrich, 2007	
	32MN755	Jay and Myrtle Smith Property		Fandrich, 2007	
	32MNX818	Lyle Aho		BM, 1997	
32MNX823	house - 105 7 <sup>th</sup> Ave. SE, Stanley		BM, 1997		

T/R-Sec.	SITS #	Historic	Prehistoric	Recorder, Date	MS #
156/91-33	no sites				6449 9450
156/91-34	no sites				6449
156/91-35	no sites				10359

Manuscript List	
Manuscript #	Reference
261	Franke, N. 1976 North Dakota Highway Department Projects No. F-7-002 ( ) 054 and F-4-002 ( ) 089 Negative Declaration Survey Report
311	Fox, R. 1978 Jellestad-Federal #1-14 Oil Well and Access Road Survey, Mountrail Co., ND
5986	Lubinski, P. 1992 Tioga to Stanley Water Pipeline in Mountrail and Williams Counties, North Dakota: A Class III Cultural Resource Inventory
6449	Borchert, J. 1995 North Dakota Department of Transportation Safety Project Cultural Resource Review 1992-1994
8670	Perkl, B. Et al 2001 Cultural Resources Investigations Along U.S. Highway 2 in Ward, Mountrail, and Williams Counties, North Dakota Vol. 1 & 2
8770	Christensen, B. 2004 STATEOP -428: David McNamara Pit Class III Inventory Report Mountrail Co., ND
9380	Stine, E. 2005 McNamara Pit: A Class III Cultural Resource Inventory in Mountrail Co., ND
9450	Bluemle, W. 2005 Stanley Pit Expansion: A Class III Intensive Cultural Resource Inventory in Mountrail Co., ND
10276	Klinner, D. 2007 Behr 11-34H Well Pad: A Class III Cultural Resource Inventory, Mountrail Co., ND
10324	Fandrich, B. 2008 Stanley, North Dakota: A Historic District Evaluation of Buildings Along Portions of Main Street and 6 <sup>th</sup> Avenue, Mountrail, Co.
10359	Tyberg, J. And Fariello, K. 2007 Class III Cultural Resources Inventory of the Stanley Pipeline and Gas Plant Mountrail Co., ND

Manuscript List	
Manuscript #	Reference
10647	Stine, E. 2008      Enbridge Stanley Station: A Class III Cultural Resource Inventory in Mountrail Co., ND