

Attachment 6-

**KLJ Memorandum: Desktop Aquatic Resource Delineation – Update to March 2017
Report and July 2019 Memorandum**

59 **PU-19-144** Filed: 4/15/2020 Pages: 6
**Attachment 6 - KLJ Memorandum - Desktop Aquatic
Resource Delineation**

EDF Renewable Development, Inc.

267 **PU-08-932** Filed: 4/15/2020 Pages: 6
**Attachment 6 - KLJ Memorandum - Desktop Aquatic
Resource Delineation**

EDF Renewable Development, Inc.

ATTACHMENT 6



4585 Coleman Street
Bismarck, ND 58503-0431
701 355 8400
KLIENG.COM

Memorandum

Date: 2/5/2020
To: Whom it May Concern
Copy to:
From: Ashley Ross, Environmental Planner
Merricourt Wind Power Project
RE: Desktop Aquatic Resource Delineation
Update to March 2017 Report and July 2019 Memorandum

Remarks

KLJ conducted a supplemental desktop aquatic resource delineation on January 29, 2020 for the Merricourt Wind Power Project. The desktop delineation was conducted in accordance with the 1987 United States Army Corps of Engineers (USACE) Wetland Delineation Manual. A Level 1 routine determination was utilized for wetland identification. United States Fish and Wildlife Service (USFWS) National Wetland Inventory (NWI) maps, Natural Resources Conservation Service (NRCS) Web Soil Survey (WSS) data, and aerial imagery were reviewed as part of the desktop delineation. All available aerial imagery (National Agriculture Imagery Program (NAIP) for years 2014, 2015, 2016, 2018, and 2019 and Google Earth Pro aerial images) were reviewed to determine the frequency of wetland signatures within the study areas. Specific wetland signatures analyzed as part of the delineation include:

- Altered Pattern
- Crop Stress
- Drowned Out
- Normal Vegetative Cover or No Soil Wetness
- Not Cropped
- Soil Wetness Signature
- Standing Water
- Wetland Signature (Certain characteristic wetland vegetation types readily identified and interpreted as a wetland signature.)

The desktop aquatic resource delineation analyzed seven parcels, totaling approximately 0.81 acre. No wetland signatures were identified within the study areas; therefore, no aquatic resources were desktop delineated.

Please refer to the attached aquatic resource delineation maps.

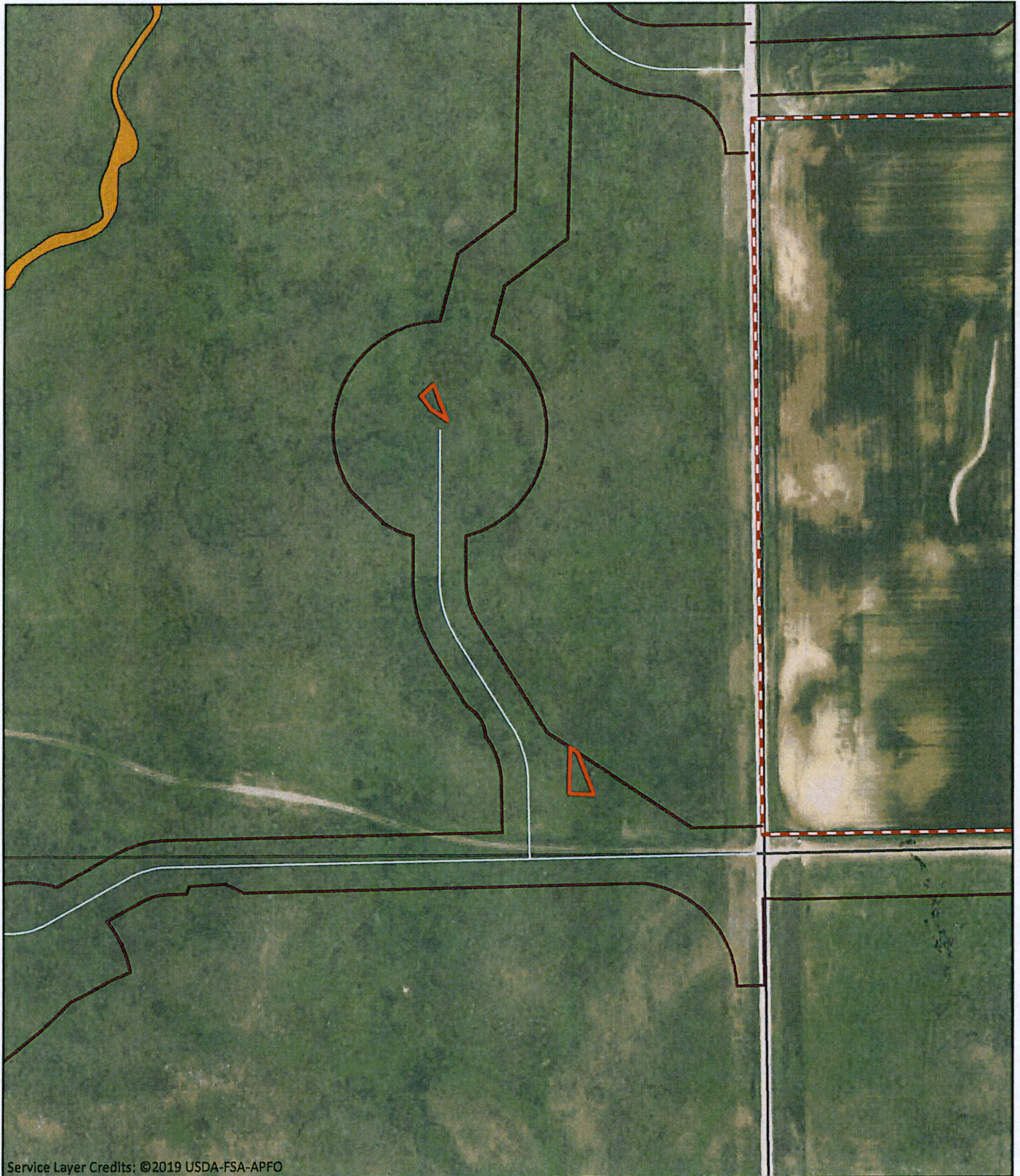

Service Layer Credits: ©2019 USDA-FSA-APFO

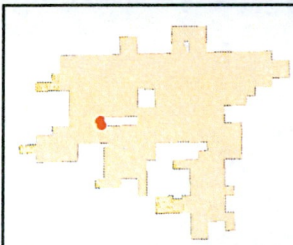

**Merricourt Wind Power Project
McIntosh and Dickey Counties
North Dakota**
Wetland Delineation & USFWS NWI

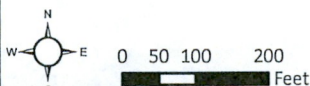

-  2020 Office Study Area
-  Construction Disturbance
-  Final Project Boundary
-  Wetland Delineation Boundary
-  Previously Delineated Wetlands
-  Access Roads

KLJ Project Number: 1609132.1
Date Created: 2/5/2020 Created By: JDP





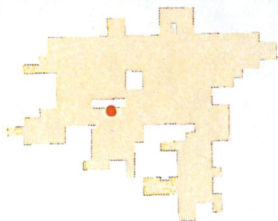

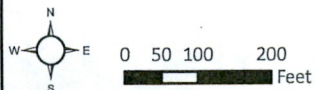

Service Layer Credits: ©2019 USDA-FSA-APFO



Merricourt Wind Power Project
McIntosh and Dickey Counties
North Dakota
 Wetland Delineation & USFWS NWI



-  2020 Office Study Area
-  Construction Disturbance
-  Final Project Boundary
-  Wetland Delineation Boundary
-  Previously Delineated Wetlands
-  Access Roads

KLJ Project Number: 1609132.1
 Date Created: 2/5/2020 Created By: JDP

Document Location: \\klj-solutions.com\dfs\Data\Projects\Power\EDF\1609132\2019\Wetlands\1609132_NWI 2020.mxd

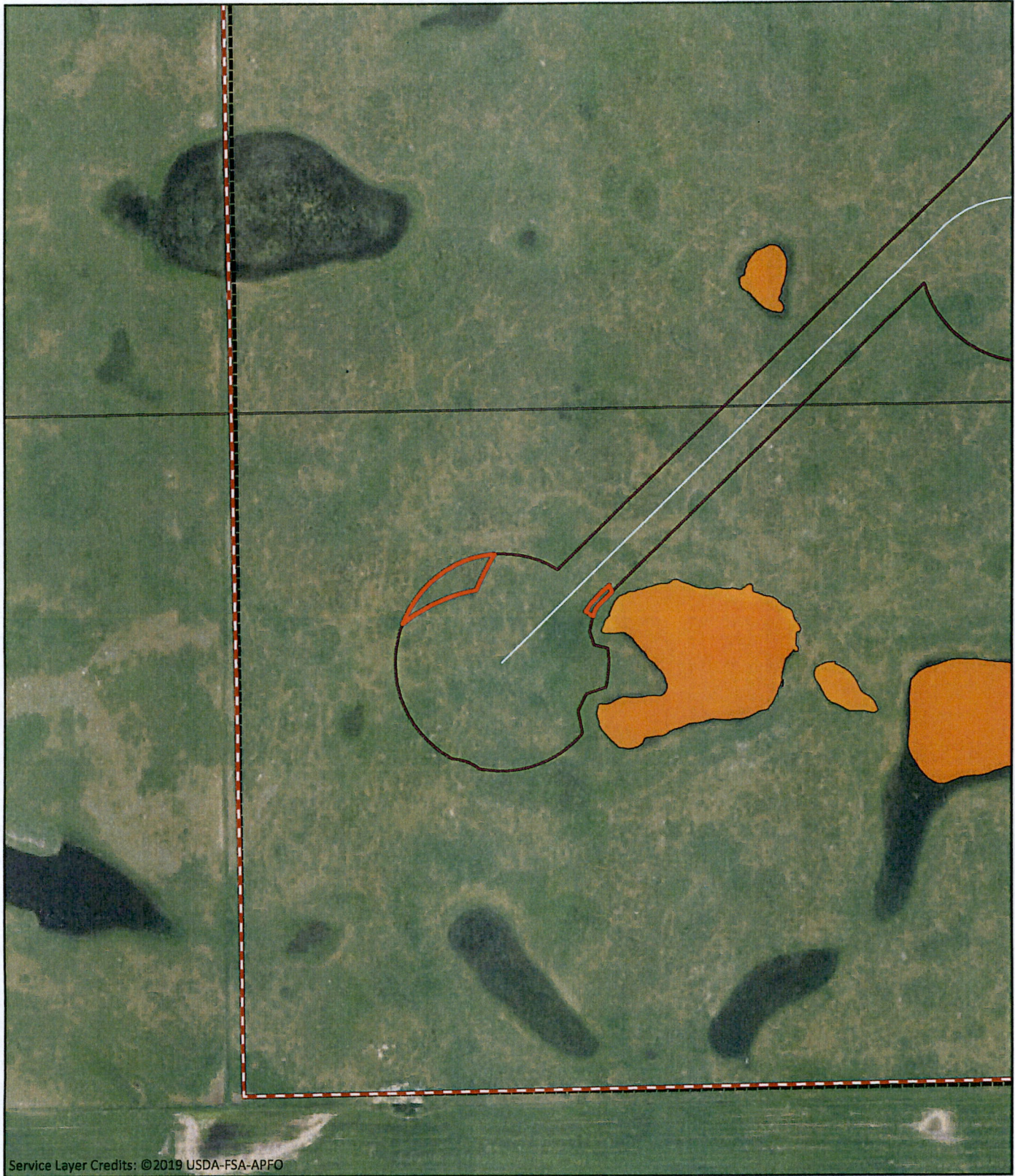

Service Layer Credits: © 2019 USDA-FSA-APFO

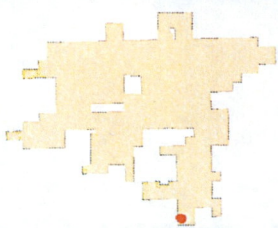

**Merricourt Wind Power Project
McIntosh and Dickey Counties
North Dakota**
Wetland Delineation & USFWS NWI

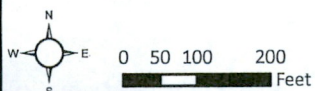

-  2020 Office Study Area
-  Construction Disturbance
-  Final Project Boundary
-  Wetland Delineation Boundary
-  Previously Delineated Wetlands
-  Access Roads

KLJ Project Number: 1609132.1
Date Created: 2/5/2020 Created By: JDP

Document Location: \\klj-solutions.com\dfs\Data\Projects\Power\EDF\1609132\2019\Wetlands\1609132_NWI 2020.mxd



Service Layer Credits: ©2019 USDA-FSA-APFO

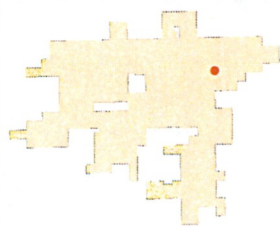

Merricourt Wind Power Project
McIntosh and Dickey Counties
North Dakota
 Wetland Delineation & USFWS NWI



0 50 100 200
 Feet



-  2020 Office Study Area
-  Construction Disturbance
-  Final Project Boundary
-  Wetland Delineation Boundary
-  Previously Delineated Wetlands
-  Access Roads

KLJ Project Number: 1609132.1
 Date Created: 2/5/2020 Created By: JDP

Document Location: \\klj-solutions.com\dfs\Data\Projects\Power\EDF\1609132\2019\Wetlands\1609132_NWI 2020.mxd