

**Lein, Jerry R.**

---

**From:** David Moeller (ALLETE) [dmoeller@allete.com]  
**Sent:** Monday, September 14, 2009 3:10 PM  
**To:** -Info-Public Service Commission; Lein, Jerry R.; Bendish, Annette M.  
**Cc:** Jim Atkinson (ALLETE); Ron Gullicks (MP); Franklyn Frederickson (MP)  
**Subject:** Supplemental site map PU-09-151  
**Attachments:** BisonWind\_SiteLayout\_ANSIE.PDF

As requested, attached is an additional site layout map of the Bison I.

Let us know if you have additional questions.

Sincerely,

David Moeller  
Minnesota Power

**35** **PU-09-151** Filed: 9/14/2009 Pages: 2  
**Additional Site Layout Map**

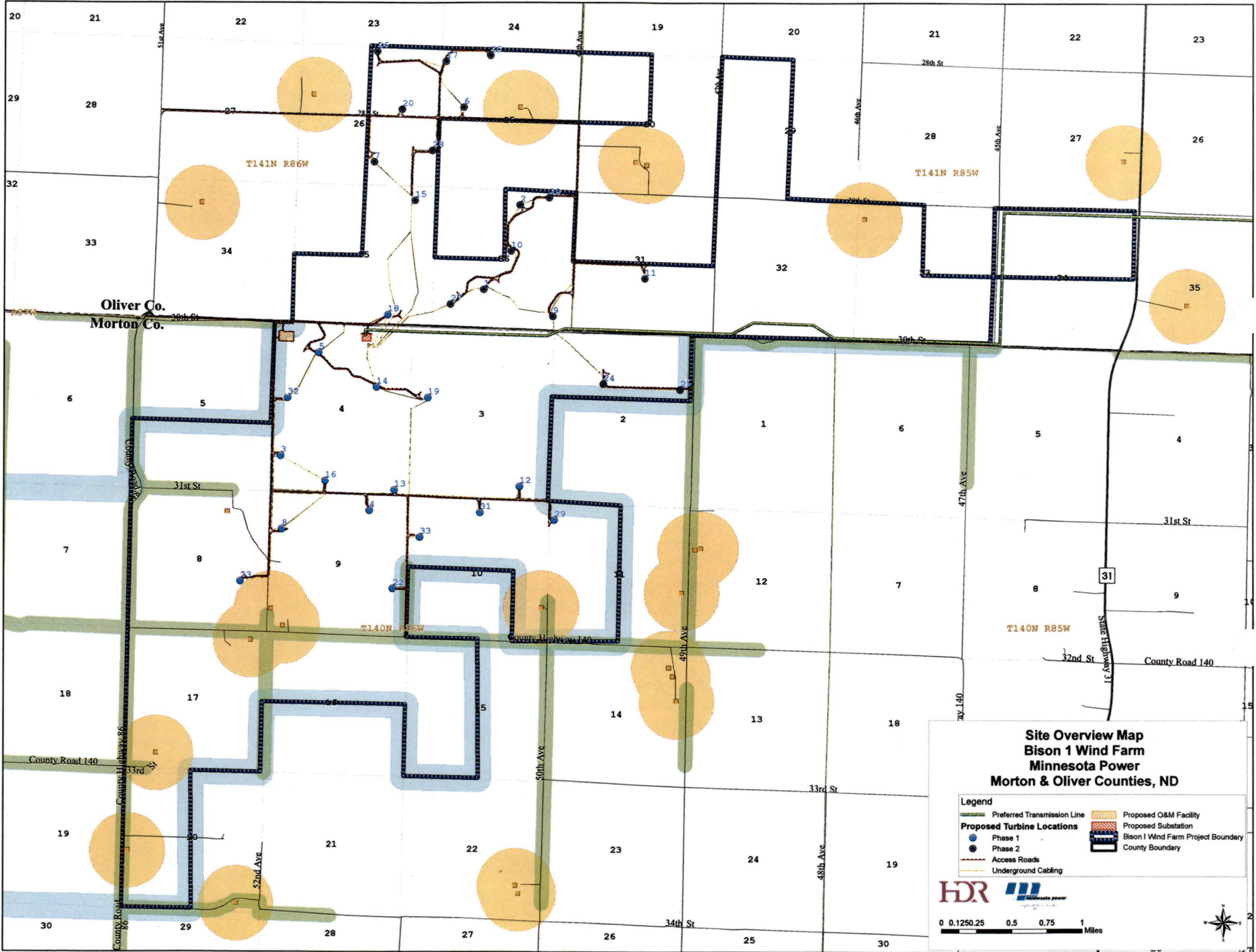

### Site Overview Map Bison 1 Wind Farm Minnesota Power Morton & Oliver Counties, ND

Legend	
	Preferred Transmission Line
	Proposed Turbine Locations
	Phase 1
	Phase 2
	Access Roads
	Underground Cabling
	Proposed O&M Facility
	Proposed Substation
	Bison 1 Wind Farm Project Boundary
	County Boundary

0 0.1250.25 0.5 0.75 1  
 Miles

Map Date: 10/12/2010 10:48 AM  
 File Path: G:\Projects\Bison1\MapDocs\Bison1\_SiteOverview\_Map.mxd  
 Scale: 1:100000