

October 8, 2009

Mr. Patrick Fahn
North Dakota Public Service Commission
600 East Boulevard Avenue, Dept. 408
Bismarck, ND 58505-0480

**RE: Hawthorn Oil Transportation
(North Dakota), Inc.**

Dear Pat:

Below is a list of additional information needed for the Hawthorn Pipeline Application, as you indicated yesterday:

- The maximum design flow rate of the line is 60,000 barrels per day.
- Surface Structures
 - A block valve, pig launcher, and a meter will be placed at the beginning of the line. The exact location has not yet been determined. This block valve may also operate as the block valve on the west side of the river crossing of the Little Knife River in Section 27-T156N-R91W.
 - There will be a block valve on the east side of the Little Knife River located in SE/4 of Section 27-T156N-R91W. The exact location has not yet been determined.
 - There will be a pig receiver, a meter, and a block valve at the terminus of the line.
- There will only be one pumping station, and it will be located at the Bridger Oil, Inc. Facility on Bridger property, which constitutes the beginning of the proposed pipeline. The pump will be owned and operated by Bridger.

I attached to this letter a copy of the Design Data Report and a map suitable for newspaper publication.

Should you have any questions, please advise.

Sincerely,
LAWRENCE BENDER

LB/bae
4631299_1.DOC

Attorneys & Advisors
main 701.221.4020
fax 701.221.4040
www.fredlaw.com

Fredrikso
200 North
Bismarck,
58501-3879

8 **PU-09-153** Filed: 10/8/2009 Pages: 3
**Supplemental Information for Application Including
Map**

Hawthorn Oil Transportation (North Dakota), Inc.

Lawrence Bender, Atty, Fredrikson&Byron

Design Data Report
for:
The Hawthorn Oil Pipeline Project
In Mountrail County, North Dakota

- The pipeline will begin at an oil storage facility in Section 27-T156N-R91W, Mountrail County, and will go to an oil storage facility in Section 14-T156N-R91W, Mountrail County.





- Design and Dimensions of the Pipeline
 - Approximately 6.0 miles long
 - Eight-inch diameter steel crude oil pipeline
 - Typical pressure of 475 Psig
 - Typical temperature of 60 degrees Fahrenheit
 - Typical flowrate of 1166 gallons per minute
 - Maximum flowrate of 60,000 barrels per day
 - Anticipated to transmit up to 14,600,000 barrels per year

- Construction Procedures
 - Applicable requirements of the U.S. Department of Transportation, the U.S. Department of Labor, and the Occupational Safety and Health Administration will be followed.
 - All applicable state-level regulations will be followed.

Hawthorn Oil Pipeline

Mountrail County, ND

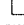
Location Map and One-mile-wide Corridor

- Legend
-  Proposed Pipeline
 -  One-mile-wide Corridor
 -  Section
 -  City

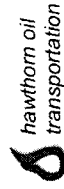

October 2009

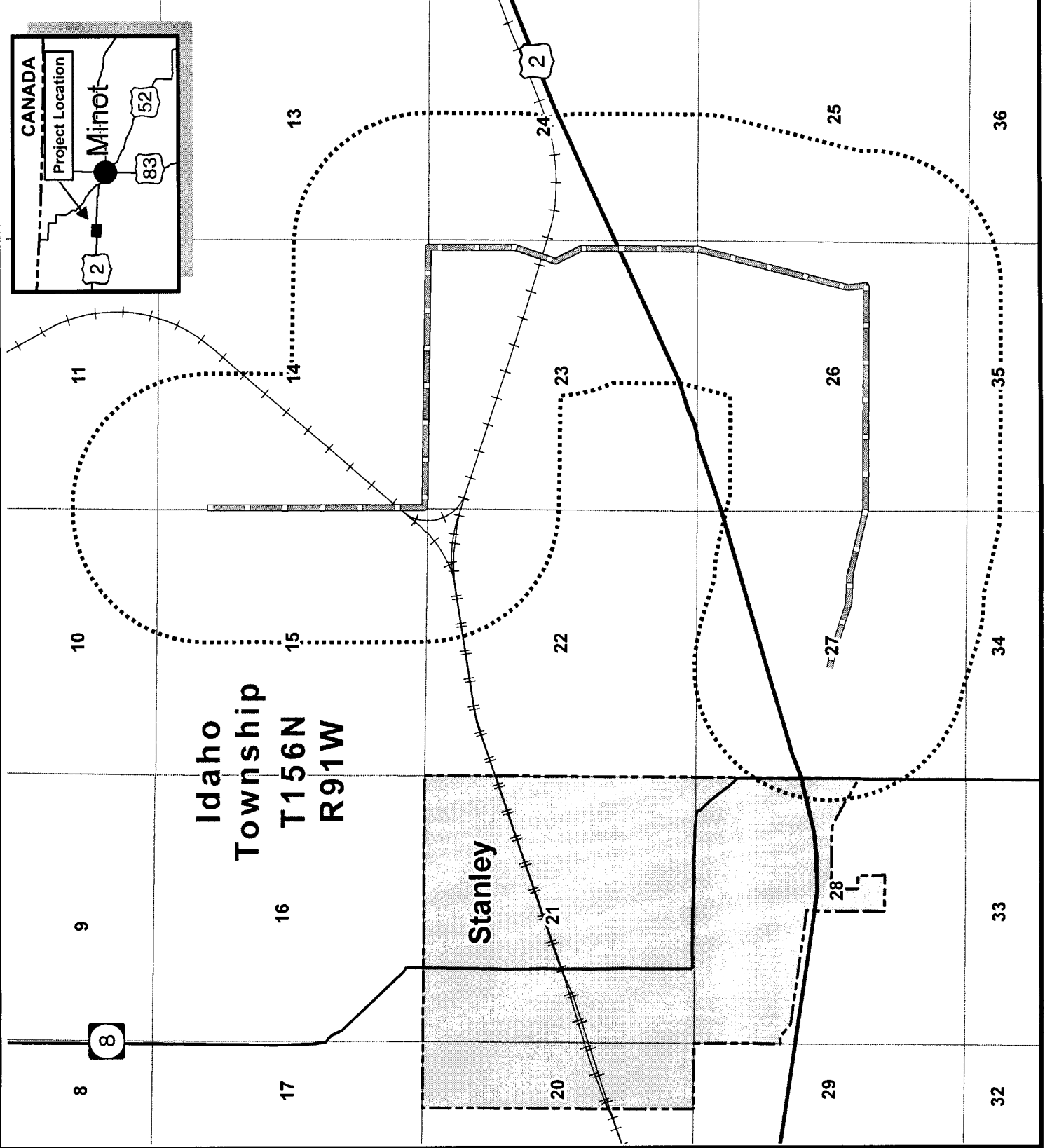
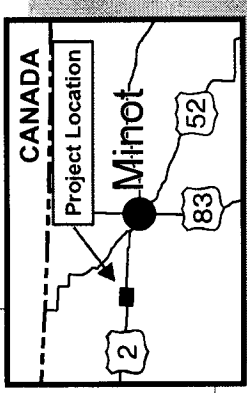

**Idaho Township
T156N
R91W**

Stanley