

October 2, 2009

RECEIVED

OCT 05 2009

PUBLIC SERVICE COMMISSION

Darrell Nitschke, Executive Secretary  
North Dakota Public Service Commission  
600 E. Boulevard, Dept. 408  
Bismarck, ND 58505-0480

Subject: Letter of Intent to File an Application for a Certificate of Site Compatibility

Dear Secretary Nitschke:

In accordance with Section 49-22-07.1 NDCC and Chapter 69-06-03 of the North Dakota Public Service Commission (PSC)'s administrative rules, NextEra Energy Resources, LLC (NextEra Energy) respectfully submits one original and ten (10) copies of this Letter of Intent to File an Application for a Certificate of Site Compatibility (Certificate).

The Certificate would authorize the construction of the Baldwin Wind Energy Center (Project) in Burleigh County, North Dakota. This Project would consist of up to 99 megawatts (MW) This Project would interconnect and deliver power into the Western Area Power Administration (Western) system.

NextEra Energy is requesting that the PSC waive, pursuant to Section 49-22-07.2, NDCC, and Chapter 69-06-06, NDAC, the requirement to file the Letter of Intent one year prior to the filing of the Application for the Certificate. The reason for this request is that the Project must be in-service by December 31, 2010 in order to serve our customers' needs. NextEra Energy plans to file the application on or about November 1, 2009, and would seek to have the Certificate issued by May 1, 2010.

The following information is provided to meet Section 69-06-03-02, NDAC, requirements for content of the Letter of Intent:

**1. Description of size and type of facility and the area to be served:**

The proposed Project would be constructed on up to 21 square miles of leased private property approximately four miles southeast of Wilton, North Dakota. The Project would consist of up to 66 wind turbine generators as well as meteorological towers, access roads, underground collection lines, a substation, and operations and maintenance facilities. The proposed Project would contribute up to 99MW of renewable energy to the power grid.

**2. A map of the study area for the propose site or corridor:**

See attached map showing the proposed general location of the Project.

**3. The anticipated construction and operation schedule:**

Construction of the Project is expected to begin on June 1, 2010 with completion by December 31, 2010.

1 PU-09-668 Filed: 10/5/2009 Pages: 3  
Letter of Intent

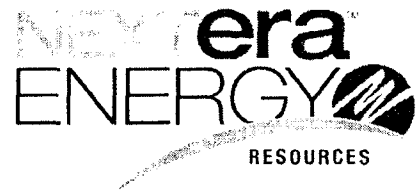

**4. *An estimate of the total cost of construction:***

NextEra Energy estimates the cost of constructing the proposed Project at approximately \$200 million.

Please contact me at (561) 691-7240 or [Scott.Scovill@nexteraenergy.com](mailto:Scott.Scovill@nexteraenergy.com) with any questions or comments.

Sincerely,

A handwritten signature in cursive script that reads "Scott Scovill".

Scott Scovill  
Director, NextEra Energy

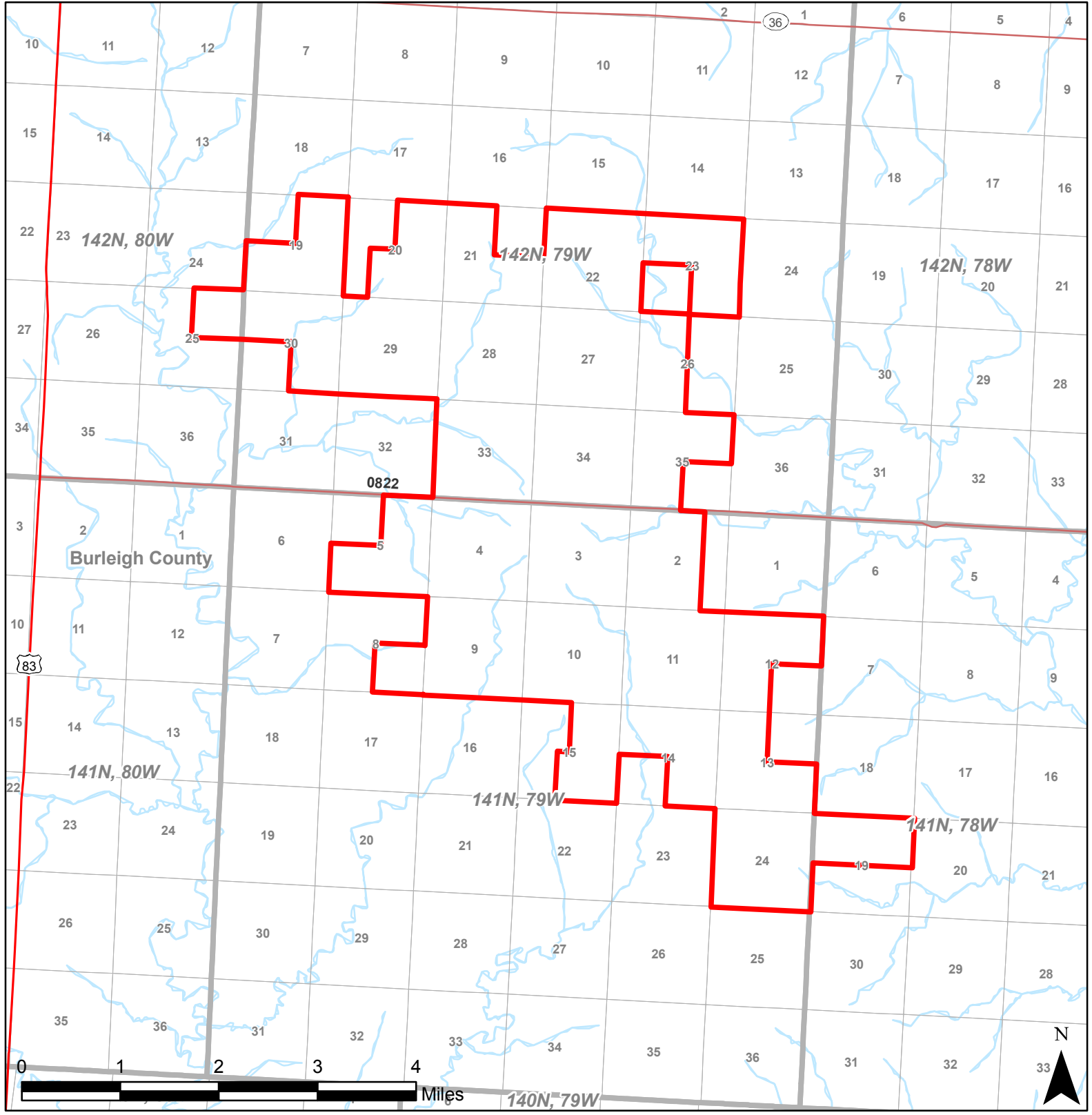

**FIGURE 1**  
**PROJECT LOCATION MAP**  
 BURLEIGH COUNTY,  
 NORTH DAKOTA  
 SEPTEMBER 2009

**Legend**

- Proposed Project Area
- Primary Limited Access
- Primary US & State Highways
- Secondary State & County
- Lake
- River
- PLSS Township Boundary
- PLSS Section Boundary
- County Boundary

**OVERVIEW MAP**

