

STATE OF NORTH DAKOTA
PUBLIC SERVICE COMMISSION

**Otter Tail Power Company
230 kV Electric Transmission Line –
Sargent Cty
Siting Application**

Case No. PU-09-674

AFFIDAVIT OF SERVICE REGULAR, EMAIL OR INSIDE MAIL

STATE OF NORTH DAKOTA
COUNTY OF BURLEIGH

Janet Marquart deposes and says that:

she is over the age of 18 years and not a party to this action and, on the **27th** day of **January, 2010**, she deposited in the United States Mail, Bismarck, North Dakota, **14** envelopes by first class mail, fully prepaid, securely sealed and each containing a photocopy; **6** envelopes by Inside Mail; and **45** electronic mail messages, each with an attached electronic copy of:

Notice of Opportunity for Hearing on Waiver of Application

The envelopes and electronic mails respectively were addressed as follows:

See attached list.

Each post office address shown is the respective addressee's last reasonably ascertainable post office address and each email address is the respective addressee's last reasonably ascertainable electronic mailing address.

Subscribed and sworn to before me
this **27th** day of **January, 2010**.

SEAL

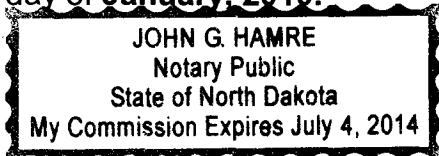

Janet Marquart

John G. Hamre

Notary Public

**STATE OF NORTH DAKOTA
PUBLIC SERVICE COMMISSION**

**Otter Tail Power Company
230 kV Electric Transmission Line - Sargent County
Siting Application**

Case No. PU-09-674

NOTICE OF OPPORTUNITY FOR HEARING ON WAIVER APPLICATION

January 27, 2010

On January 12, 2010, Otter Tail Power Company filed for a waiver of procedures and time schedules, requesting that the Commission waive the requirement of the filing of an application for a certificate of corridor compatibility and route permit and public hearing, and forthwith issue a certificate and route permit authorizing the construction and relocation of approximately 0.53 miles of 230 kilovolt (kV) electric transmission line now located in water near Fiala Lake in Sargent County. Otter Tail asserts that the proposed reroute will produce only minimal adverse effects and that a demonstrable emergency exists that requires construction before the existing line structures can be damaged by spring ice flows. The proposed reroute is west and south of Foreman in Section 14 of Township 130 North (Foreman), Range 56 West as shown on the attached map.

The issues to be considered in this proceeding are:

1. Will the location, construction, and operation of the proposed transmission line produce minimal adverse effects on the environment and upon the welfare of the citizens of North Dakota?
2. Is the proposed transmission line compatible with the environmental preservation and the efficient use of resources?
3. Will the proposed transmission line reroute minimize adverse human and environmental impact while ensuring continuing system reliability and integrity and ensuring that energy needs are met and fulfilled in an orderly and timely fashion?
4. Is the proposed transmission line of such length, design, location, or purpose that it will produce minimal adverse effects so that procedures and time schedules may be waived?

5. Does a demonstrable emergency exist which requires immediate construction so that adherence to procedures and time schedules would jeopardize the utility's system?
6. Is it appropriate for the Commission to waive any procedures and time schedules as requested in the application?

Those interested are invited to comment on the application in writing. Persons desiring a hearing must file a written request identifying their interest in the proceeding and the reasons for requesting a hearing. Comments and requests for hearings must be received by **February 22, 2010**. If deemed appropriate, the Commission can determine the matter without a hearing.

For more information, contact the Public Service Commission, State Capitol, Bismarck, North Dakota 58505, 701-328-2400; or Relay North Dakota 1-800-366-6888 TTY. If you require any auxiliary aids or services, such as readers, signers, or braille materials please notify the Commission.

PUBLIC SERVICE COMMISSION

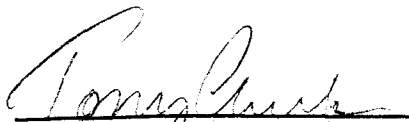

Tony Clark
Commissioner



Kevin Cramer
Chairman



Brian P. Kalk
Commissioner

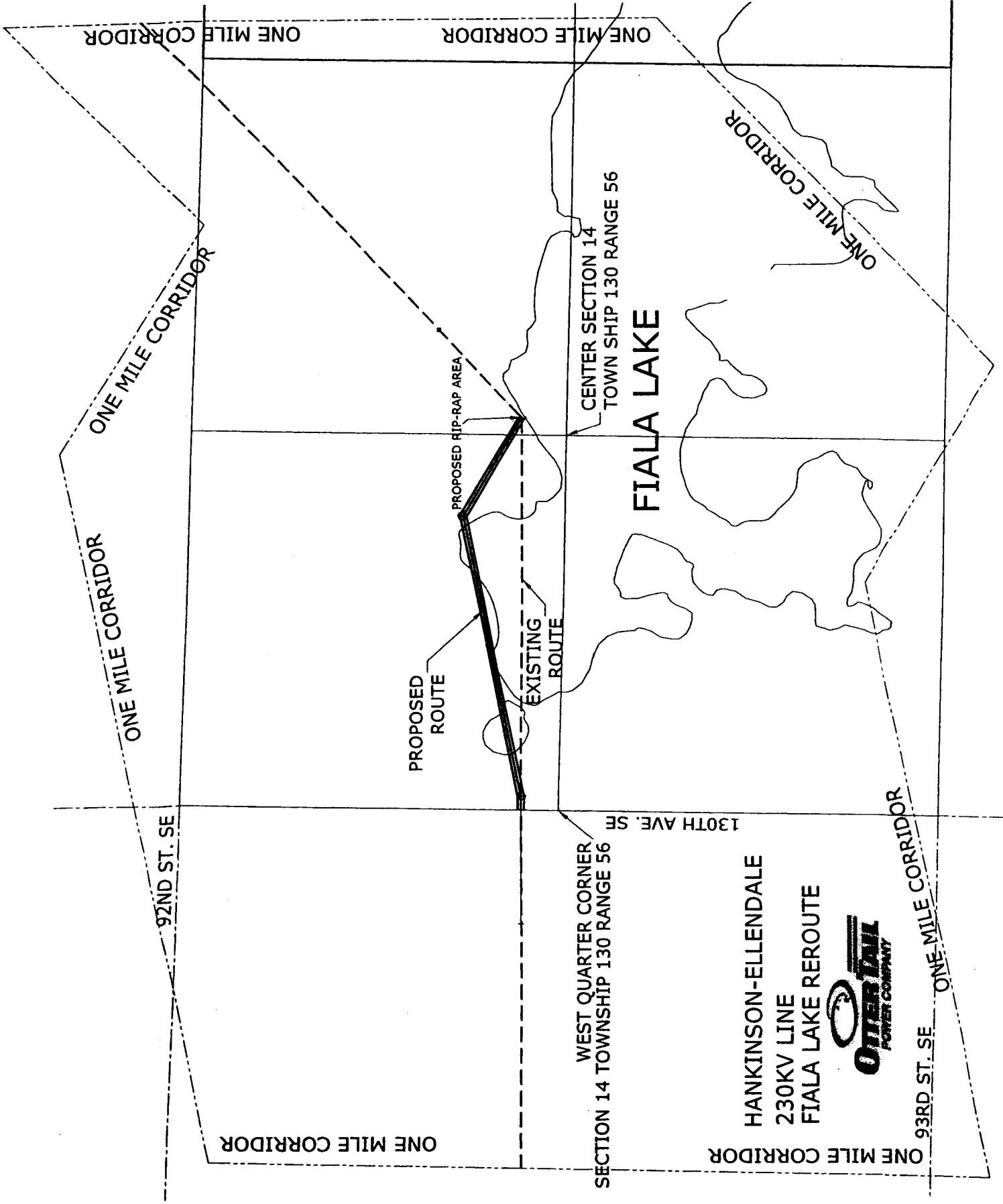

ONE MILE CORRIDOR

ONE MILE CORRIDOR

ONE MILE CORRIDOR

ONE MILE CORRIDOR

ONE MILE CORRIDOR

92ND ST. SE

PROPOSED ROUTE

PROPOSED RIP-RAP AREA

EXISTING ROUTE

CENTER SECTION 14
TOWN SHIP 130 RANGE 56

FIALA LAKE

WEST QUARTER CORNER
SECTION 14 TOWNSHIP 130 RANGE 56

130TH AVE. SE

HANKINSON-ELLENDALE
230KV LINE
FIALA LAKE REROUTE



93RD ST. SE

ONE MILE CORRIDOR

ONE MILE CORRIDOR

ONE MILE CORRIDOR

Todd Lindquist
Corp of Engineers
PO Box 527
Riverdale ND 58565-0527

Dept of Career and Technical Education
State Capitol
Bismarck ND 58505

Merlan Paaverud, Jr.
Historical Society
North Dakota Heritage Center
Bismarck ND 58505

CITY OF FORMAN
MAYOR
349 MAIN ST PO BOX 122
FORMAN ND 58032

Thomas Hanson
ND Assoc of Soil Conservation Dist
3310 University Drive
Bismarck ND 58504-7564

MR LARRY KOTCHMAN
ND FOREST SERVICE
MOLBERG CENTER 307 1ST STREET EAST
BOTTINEAU ND 58318

MR ED MURPHY
ND GEOLOGICAL SURVEY
INSIDE MAIL

Mike Haupt
ND Land Department
1707 N 9th St
Bismarck ND 58501

~~MARK BRING
OTTER TAIL POWER COMPANY
215 S CASCADE ST
FERGUS FALLS MN 56537~~

*Sent via
Certified
mail*

COMMISSIONERS, BOARD OF
Sargent County
355 MAIN ST S, STE 1
FORMAN ND 58032-4149

COUNTY AUDITOR
SARGENT COUNTY
355 MAIN ST S
FORMAN ND 58032-4149

Dale Frink
State Engineer
ND Water Commission 900 East Boulevard
Bismarck ND 58505

State Health Department
State Capitol
Bismarck ND 58505

BILL AMERMAN
STATE REPRESENTATIVE
PO BOX 43
FORMAN ND 58032-0043

JERRY KELSH
STATE REPRESENTATIVE
PO BOX 27
FULLERTON ND 58441-0027

JIM DOTZENROD
STATE SENATOR
507 5TH ST
WYNDMERE ND 58081-4217

Chief of Resource Management
Theodore Roosevelt National Park
P O Box 7
Medora ND 58645-0007

Valerie Naylor
Theodore Roosevelt Nat'l Park
PO Box 7
Medora ND 58645

Steve Williams
U S Forest Service
240 W Century Ave
Bismarck ND 58501-1494

District Chief
U S Geological Survey
821 E Interstate Ave
Bismarck ND 58501

District Engineer
US Army Engineer District Omaha
106 S 15th St
Omaha NE 68102-1618

pseppanen@fageninc.com
Paul Seppanen

pamradtkerussell@gmail.com
PAMELA RADTKE RUSSELL

goehring@nd.gov
Doug Goehring
Agriculture Department
State Capitol
Bismarck ND 58505

carp1091@qwestoffice.net
Robert Colton
Carpenters Union
217 S Mandan St
Bismarck ND 58504-5516

bbjella@crowleyfleck.com
Brian R. Bjella
Crowley Fleck PLLP
PO Box 2798
Bismarck ND 58502-2798

colson@nd.gov
Carol Olson
Department of Human Services
State Capitol
Bismarck ND 58505

ndquarter@nd.gov
John Hoeven
Governor's Office
State Capitol
Bismarck ND 58505

kmaini@wi.rr.com
Kavita Maini
KM ENERGY CONSULTING LLC
961 N LOST WOODS RD
OCONOMOWOC WI 53066

sanditabor@lignite.com
Sandi Tabor
Lignite Energy Council
PO Box 2277
Bismarck ND 58502-2277

taltmann@mrenergy.com
TASHA ALTMANN
MISSOURI RIVER ENERGY SERVICES
3724 W AVERA DR
SIOUX FALLS SD 57108

askstan@midstatetel.com
Stanley Wright

Box 97
Stanley ND 58784-0097

ndaero@nd.gov
Melinda Weninger
Aeronautics Commission
PO Box 5020
Bismarck ND 58502-5020

wboeshans@bnicoal.com
Wade Boeshans
BNI Coal, Ltd.
1637 Burnt Boat Dr.
Bismarck ND 58503

bschmidt@kwh.com
Brad Schmidt
Cass County Electric Coop
4100 32nd Ave SW
Fargo ND 58104

jmittleider@nd.gov
John Mittleider
Department of Commerce
600 East Blvd
Bismarck ND 58505

jengleso@nd.gov
Jeff Engleson
Energy Development Impact Office
1707 N 9th St
Bismarck ND 58501

dsaggau@GREnergy.com
David Saggau
Great River Energy
P O Box 800
Elk River MN 55330-0800

johndwyer@lignite.com
John Dwyer
Lignite Energy Council
PO Box 2277
Bismarck ND 58502-2277

amanda.filiowich@minot.af.mil
Captain Amanda Filiowich
Minot Air Force Base

don.ball@mdu.com
Don Ball
Montana-Dakota Utilities Co
400 North 4th Street
Bismarck ND 58502-1457

dave.goodin@mdu.com
Dave Goodin
Montana-Dakota Utilities Co
400 North 4th Street
Bismarck ND 58502-1457

jay.fuhrer@nd.usda.gov
Jay Fuhrer
NATURAL RESOURCE CONSERVATION SVC
PO BOX 1458
BISMARCK ND 58502-1458

shuperb@q.com
Ron Shupe
ND Chapter of the Wildlife Society

tsteinwa@nd.gov
Terry Steinwand
ND GAME & FISH DEPT
INSIDE MAIL

lmcevers@nd.gov
Lisa K Fair-McEvers
ND Labor Dept
600 E Blvd Ave
Bismarck ND

candie@ndpelsboard.org
Candie Robinson
ND State Board of Registration for Professional Engin
PO Box 1357
Bismarck ND 58502

pat@ndta.net
Patricia Gisinger
North Dakota Telephone Assoc
PO Box 2614
Bismarck ND 58502-2614

sagonna.thompson@xcelenergy.com
SaGonna Thompson
NORTHERN STATES POWER COMPANY

john.brodbeck@shell.com
JOHN BRODBECK
SHELL ENERGY NORTH AMERICA
340 E MAPLE AVE, STE 204A
LANGHORNE PA 19047

leann.eckroth@bismarcktribune.com
LeAnn Eckroth
The Bismarck Tribune
PO Box 5516
Bismarck ND 58502-5516

ipaczkowski@nd.gov
John Paczkowski
N D Water Commission
900 E Boulevard
Bismarck ND 58505

hfuglest@ndarec.com
Harlan Fugelsten
ND Assn Rural Electric Cooperatives
PO Box 727
Mandan ND 58554-0727

fziegler@nd.gov
Francis Ziegler, P.E.
ND Department of Transportation
State Highway Building
Bismarck ND 58505

mdaley@nd.gov
Maren Daley
ND Job Service
P.O. Box 5507 INSIDE MAIL
Bismarck ND 58506-5507

kevin.nelson@ulteig.com
Kevin Nelson
ND State Board of Registration for Professional En
PO Box 1357
Bismarck ND 58502

dprchal@nd.gov
Doug Prchal
North Dakota Parks & Rec
1600 E Century Ave, Ste. 3 INSIDE MAIL
Bismarck ND 58503-0649

kari.v.zipko@xcelenergy.com
Kari Zipko
NORTHERN STATES POWER COMPANY

jennifer.sanner@xcelenergy.com
JENNIFER SANNER
NORTHERN STATES POWER COMPANY

shewson@nd.gov
Sara Hewson
State Tax Department
State Capitol
Bismarck ND 58505

jkapsner@vogellaw.com
John Kapsner
The Vogel Law Firm
P O Box 2097
Bismarck ND 58502-2097

kjvannin@usgs.gov
K Vannin
U S Geological Survey

jeffrey_towner@fws.gov
Jeffrey Towner
US FISH & WILDLIFE SERVICE
3425 MIRIAM AVE
BISMARCK ND 58501-7926

jshaffer@usgs.gov
JILL SHAFFER
US GEOLOGICAL SURVEY
8711 37TH ST SE
JAMESTOWN ND 58401

tprice@wapa.gov
Thomas Price
Western Area Power Administration
PO Box 1173
Bismarck ND 58502-1173

dave.sederquist@xcelenergy.com
Dave Sederquist
Xcel Energy
PO Box 2747
Fargo ND 58108-2747