

Bridger Pipeline LLC

455 NORTH POPLAR
P.O. BOX 2360
CASPER, WY 82602
307-237-9301
307-237-3164 FAX

RECEIVED

OCT 22 2010

PUBLIC SERVICE COMMISSION

October 18, 2010

Patrick Fahn, Director
Compliance and Competitive Markets Division
Public Service Commission
State Capitol
Bismarck, ND 58505

Re: Case No. PU-09-750
Bridger Pipeline LLC
Crude Oil Pipeline
McKenzie, Dunn, Billings Co., ND

Dear Mr. Fahn:

Enclosed please find a copy of approved Permit #4299 from Billings Co., ND for Bridger Pipeline LLC's Four Bears pipeline. Also enclosed is a copy of an e-mail dated October 15, 2010 from Dana Wanner, Billings Co. Deputy Tax Director confirming permit approval and fulfillment of all requirements of Permit #4299.

We respectfully request permission to begin construction of Bridger Pipeline LLC's Four Bears pipeline in Billings Co., ND under Case No. PU-09-750. Please contact me upon your receipt of this information with the Commission's decision.

Thank you for your time and consideration.

Sincerely,



Debra M. Bell
Land Supervisor
Bridger Pipeline, LLC

Enclosures: as stated

53 PU-09-750 Filed: 10/22/2010 Pages: 16
Billings County Permit #4299 and fulfillment of all requirements

Bridger Pipeline LLC

Debra M. Bell

Deb Bell

From: Dana Wanner [dawanner@nd.gov]
Sent: Friday, October 15, 2010 2:07 PM
To: 'Deb Bell'
Subject: RE: Contractors' info needed for county permits

Good afternoon Deb,

I am writing to let you know that we have received your application for a pipeline permit #4299. The application was approved on August 10, 2010 and I have received the easements from the landowners and a copy of the contractor's name, number, address and insurance number. You have fulfilled all of the requirements required of permit #4299.

Thanks
Dana Wanner
Billings County Deputy Tax Director
701.623.4810
Medora ND 58645

NO 4299

APPLICATION FOR PIPELINE PERMIT

(If crossing or encroaching on County Right-of-Way or section lines, a construction Right-of-Way Permit must accompany this permit)
Billings County, North Dakota

APPROVED

Owner Name: Bridger Pipeline LLC

Address: P.O Drawer 2360; Casper, WY 82602

Phone: (307) 237-9301

(X) Local Agent: Bruce Chappell

Address: c/o Quality Inn, 71 W. Museum Drive, Dickinson, ND 58601

Phone: (406) 860-1798

Indicate (X) which of the above should receive the completed permit.

Give the section, township and range of route:

The pipeline is to be installed below ground, starting from NW1/4, Section 15, T141N, R98W and continue in Sections 10, 11, 12, and 1 T141N, R98W until it is into Dunn County Section 6 T141N R97W.

The route is depicted on Figure 1 Vicinity Map which is enclosed with this application. A list of county roads and section lines impacted by the project is also enclosed.

Describe the general use of the pipeline:

Bridger's Four Bears Pipeline is approximately 77 miles long and will span through three counties: Billings, Dunn, and McKenzie. The 12-inch crude oil segment will connect the two existing Bridger and Belle Fourche pipelines and will have a truck receiving point approximately 16.5 miles west of the Four Bears Bridge. Upon completion, this system will provide pipeline transportation of McKenzie and Mountrail crude oil volume to three major crude markets: (1) Guernsey, Wyoming via the Little Missouri system and the Butte pipeline system; (2) Clearbrook, Minnesota via the existing pipeline systems operated by Bridger, Belle Fourche and Enbridge; or (3) to the Mandan Refinery via Tesoro's crude pipeline. This market flexibility is critical to assure the best overall value is obtained for ND's crude oil production. The pipeline will have a capacity of 40,000 barrels per day or the daily equivalent of over 190 standard size crude cargo tanker roundtrip loads. Pipeline transportation is the safest, most economic mode of transportation and will reduce traffic on county, State, and Federal roads. In Billings County there will be approximately 3.4 miles of pipe which reduces truck traffic on US Highway 85 and miles on multiple county roads.

The following information must be included with this application before a permit will be approved and issued:

1. **A map indicating the pipeline route, any county roads or right-of-ways you intend to use and compressor stations, if any.**

The route is depicted on Figure 1 Vicinity Map which is enclosed with this application. No compressors are associated with this project. A valve station and pipeline pig traps may be installed at each of the pipeline connections points.

Billings County Roads Crossed by the Four Bears Pipeline Route			
Legal Description	Coordinates	Road Name	Description of Road
North Section 15 T141N R98W	47.03844° N 103.092° W	26 th St SW	Scoria
Section 10 T141N R98W	47.041389° N 103.08225° W	Private Drive	Scoria
West Section 11 T141N R98W	47.043361° N 103.075167° W	122 nd Ave SW	Two Track Vegetated
West Section 12 T141N R98W	47.051694° N 103.054028° W	121 st Ave SW	Scoria
North Section 12 T141N R98W	47.052944° N 103.0495° W	25 th St SW	Two Track Vegetated
East Section 1 T141N R98W	47.059472° N 103.032667° W	120 th Ave SW County Line	No Road

2. **Name and address of the contractor, include his ND contractor license number.**

TBD

3. **Name of contractor bonding company and bond or insurance number.**

TBD

4. **Copies of all easements or letters of consent obtained for private landowners.**

Copies of all easements are enclosed for your files.

5. **Proposed dates of commencement and completion**

Proposed project commencement is August 2010 with completion expected during 2011.

6. **Size of line (diameter): Length of line: Pressure:**

The steel pipe will have a nominal 12-inch diameter. The outside diameter is 12.75 inches with 0.250 pipeline specification wall thickness. Note however that all road crossings and

selected stream crossings will be directionally bored using 12.75 inch OD steel pipe with 0.375 inch wall thickness with a Powercrete coating.

Of the approximately 77 miles of the project's route, 3.4 miles of the route will be in Billings County.

The maximum operating pressure of this line will be 1440 psig. Average initial operating pressure will be 750 psig.

7. **This application shall be accompanied by a \$25.00 fee.**

A check for \$25.00 has therefore been enclosed.

The Billings County Board of County Commissioners will review this application and will either approve it as submitted or require a public hearing before the Billings County Planning and Zoning Commission.

Billings County has road restrictions and roads with various load limits on them. Please contact the appropriate County Commissioner for current information.

DISTRICT 1: Townships 143N & 144N, Ranges 98W-102W
Allan T. Thompson
1241 Highway 85 • Fairfield ND 58627
(701) 575-4937

DISTRICT 2: Townships 141N & 142N, Ranges 98W-102W
Mike Kasian
2984 122nd Avenue • Belfield, ND 58622
(701) 575-4782 Work • (701) 677-5589 Home

DISTRICT 3: Townships 137N-140N, Ranges 100W-102W
Jim Arthaud
PO Box 197 • Medora, ND 58645
(701) 575-8242 Office • (701) 623-4461 Home

AUTHORIZED SIGNATURE  TITLE: AGENT

The above application, being in compliance with all of the requirements therein, is hereby approved.

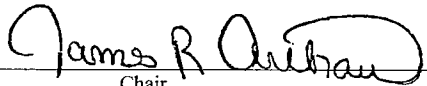
DATE: 8/10/10 COMMISSIONER: 
Chair

Based on the above approved application, the applicant therein is hereby issued a Pipeline Permit.

Date: 8/10/10 
County Zoning Inspector

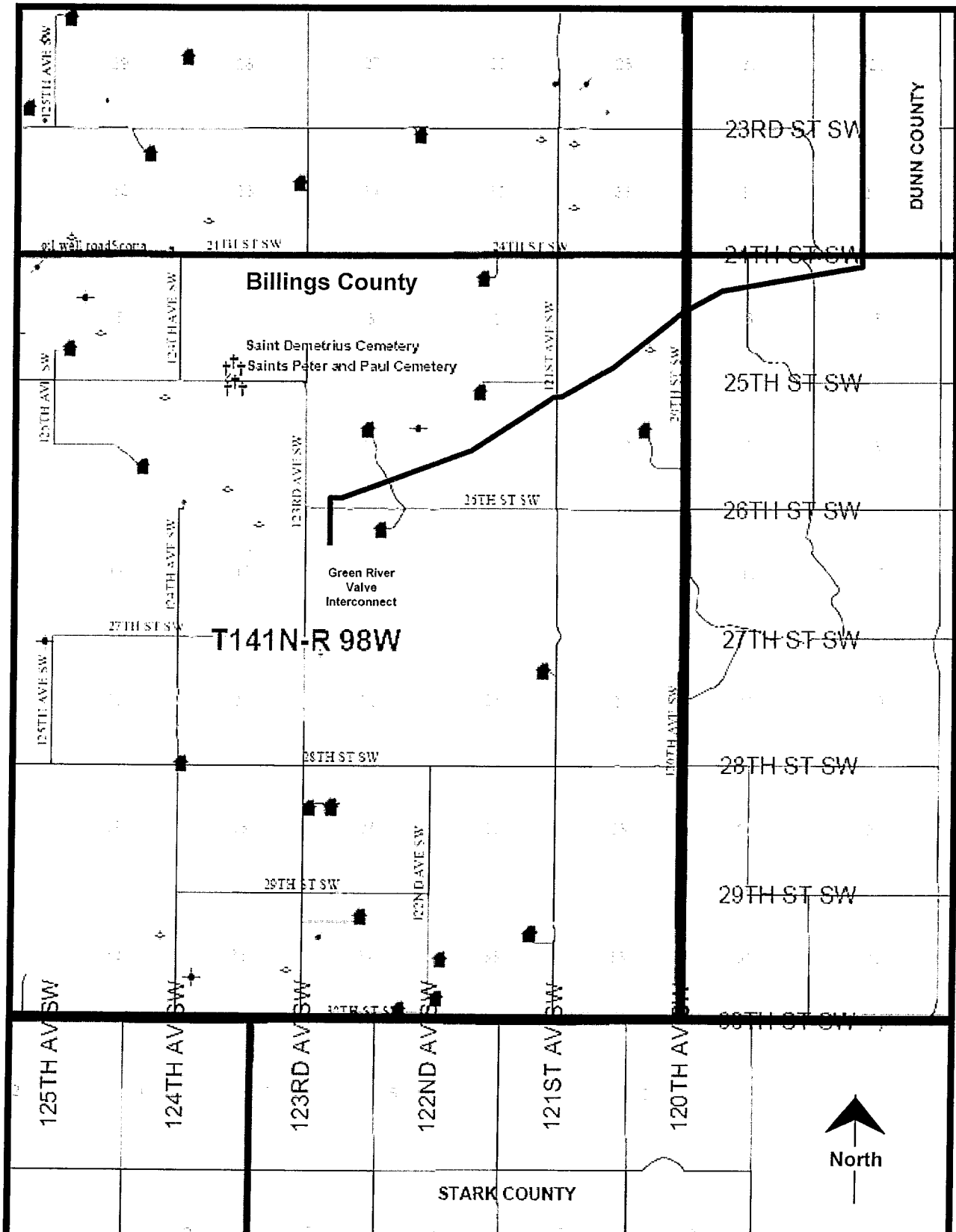

Bridger Pipeline LLC
 455 North Poplar Street
 Casper, Wyoming 82602
 307-237-9301

Figure 1 – Project Vicinity
 12-inch Crude Oil FourBears Segment
 June 2010 – Revision 0

w/ pipeline # 4299

**COUNTY HIGHWAY DEPARTMENT
CONSTRUCTION IN COUNTY RIGHT-OF-WAY PERMIT
(used in conjunction with Pipeline Permit)**



The Board of Billings County Commissioners, in the state of North Dakota, hereby grant permission to Bridger Pipeline LLC to place, construct and thereafter maintain a pipeline, on County road right-of-way at the following location(s):

Billings County Roads Crossed by the Four Bears Pipeline Route			
Legal Description	Coordinates	Road Name	Description of Road
North Section 15 T141N R98W	47.03844° N 103.092° W	26 th St SW	Scoria
Section 10 T141N R98W	47.041389° N 103.08225° W	Private Drive	Scoria
West Section 11 T141N R98W	47.043361° N 103.075167° W	122 nd Ave SW	Two Track Vegetated
West Section 12 T141N R98W	47.051694° N 103.054028° W	121 st Ave SW	Scoria
North Section 12 T141N R98W	47.052944° N 103.0495° W	25 th St SW	Two Track Vegetated
East Section 1 T141N R98W	47.059472° N 103.032667° W	120 th Ave SW County Line	No Road

1. The pipeline shall be placed at a minimum depth of 48 inches below the surface of the ground.
2. The pipeline shall be placed under county roads by means of pipe or boring tool pushed under the surface of the road, at a minimum depth of 48 inches under the lowest part of the ditch.
3. Above ground fixtures shall be located off the road right-of-way or on the right-of-way line.
4. All trenches and other excavations shall be carefully backfilled in such a manner as to eliminate settlement, and the surface of the ground shall be returned to its original condition.
5. It is understood and agreed that Billings County will not be liable for any costs in connection with the future required relocation of the facility due to road improvement.
6. Installation, maintenance, relocation, and removal of said facilities on county right-of-way shall be done in a manner satisfactory to, and subject to supervision by the County Engineer for the County Highway Department.
7. Billings County shall not be liable for damage to said facilities resulting from reconstruction or maintenance of the right-of-way. Applicant and/or its successors shall hold the County harmless for injury to persons or damage to property resulting from the location of said facilities on county right-of-way. Applicant and/or its successors are responsible for any and all claims of damage, personal injury, or bodily injury that might result from their activities in crossing any existing road or section line in Billings County. Furthermore, the applicant and/or its successors agree to indemnify and hold harmless

Billings County for any and all claims of damage, either personal injury or property or any type of claim for damages of any nature whatsoever, whether valid or invalid, that is made against Billings County on account of the activities conducted by the applying company and/or its successors in crossing any existing road or section line.

8. Applicant and/or its successors shall promptly remove said facilities from county right-of-way or shall relocate or adjust said facility, at its sole cost and expense when requested to do so by the County. When the applying company and/or its successors uses an existing road or section line easement, the applying company shall be responsible to pay for all costs of moving, relocating, or reconstructing the facility, should Billings County deem it necessary or advisable, in its sole discretion, to repair or reconstruct existing roads or to build new roads on section lines or off section lines as allowed by North Dakota State law. Should the applicant and/or its successors fail to take necessary steps to relocate, or reconstruct its facility, the county may take steps to have the same accomplished, and the applying company agrees to reimburse the county for all expenses incurred by Billings County in moving, relocating or reconstruction of the facility so the existing roads may be repaired or reconstructed, or new roads may be built on the section line or off the section line as allowed by North Dakota law.
9. If at any time Billings County wants to excavate in this area and if it should require the said facility to be moved, it will be at the expense of the applying company and/or its successors.
10. Applicant and/or its successors shall repair or replace highway structures and appurtenances, and any existing facilities located on, over or under highway right-of-way, which may be damaged as a result of the installation and maintenance of said facilities on highway right-of-way, including but not limited to slumping in of trenches, collapse of pipe, etc.
11. A GPS'd drawing of proposed location must be placed on file with Billing County Auditor and must show at a minimum the location of the proposed facility from a section or quarter line, section, township and range where the said facility will be placed.
12. The applicant plans to bury a pipeline facility that will follow or cross an existing section line or road easement which is further detailed as the following: (type, size, product carried in pipeline, etc.)

Bridger's Four Bears Pipeline is approximately 77 miles long and will span through three counties: Billings, Dunn, and McKenzie. The 12-inch crude oil segment will connect the two existing Bridger and Belle Fourche pipelines. Upon completion, this system will provide pipeline transportation of crude oil volume to three major crude markets: (1) Guernsey, Wyoming via the Little Missouri system and the Butte pipeline system; (2) Clearbrook, Minnesota via the existing pipeline systems operated by Bridger, Belle Fourche and Enbridge; or (3) to the Mandan Refinery via Tesoro's crude pipeline. This market flexibility is critical to assure the best overall value is obtained for ND's crude oil production. The pipeline will have a capacity of 40,000 barrels per day or the daily equivalent of over 190 standard size crude cargo tanker roundtrip loads. Pipeline transportation is the safest, most economic mode of transportation and will reduce traffic on County, State, and Federal roads. In Billings County there will be approximately 3.4 miles of pipe which reduces truck traffic on US Highway 85 and miles on multiple county roads. The pipeline is to be installed below ground, starting from NW1/4, Section 15, T141N, R98W and continue in Sections 10, 11, 12, and 1 T141N, R98W until it is into Dunn County Section 6 T141N R97W.

**This application shall be accompanied by a \$25.00 fee.

Bruce Chappell on behalf of Bridger Pipeline LLC

Applicant (Representative, Company)

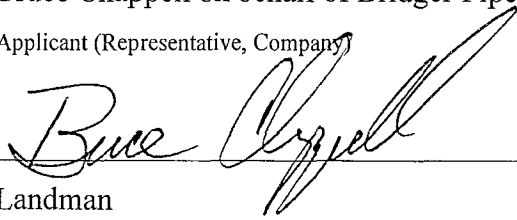

Landman

Applicant Address (Address, City, State, Zip)

c/o Quality Inn, 71 W. Museum Drive

Dickinson, ND 58601

(406) 860-1798 - Phone Number of Applicant

Approved by



Chairman, County Board of Commissioners

8/10/10 Date

Attest:



County Auditor

Revised 11/17/2008

BILLINGS COUNTY, ND

TWP/RANGE	DISTRICT
-----------	----------

137-100	<p>DISTRICT 3 Jim Arthaud, Commissioner 701-623-4461 Jeff Iverson, District 3 Foreman 701-575-4661</p>
137-101	
137-102	
138-100	
138-101	
138-102	
139-100	
FRYBURG	
139-101	
139-102	
140-100	
140-101	
140-102	

141-98	<p>DISTRICT 2 Mike Kasian, Commissioner 701-677-5589 Roy Krivoruchka, District 2 Foreman 701-575-4782</p>
141-99	
141-100	
141-101	
141-102	
142-98	
142-99	
142-100	
142-101	
142-102	

143-98	<p>DISTRICT 1 Allan "Ted" Thompson, Commissioner 701-575-4937 Jim Haag, District 1 Foreman 701-575-4546</p>
143-99	
143-100	
143-101	
143-102	
144-98	
144-99	
144-100	
144-101	
144-102	
MEDORA	

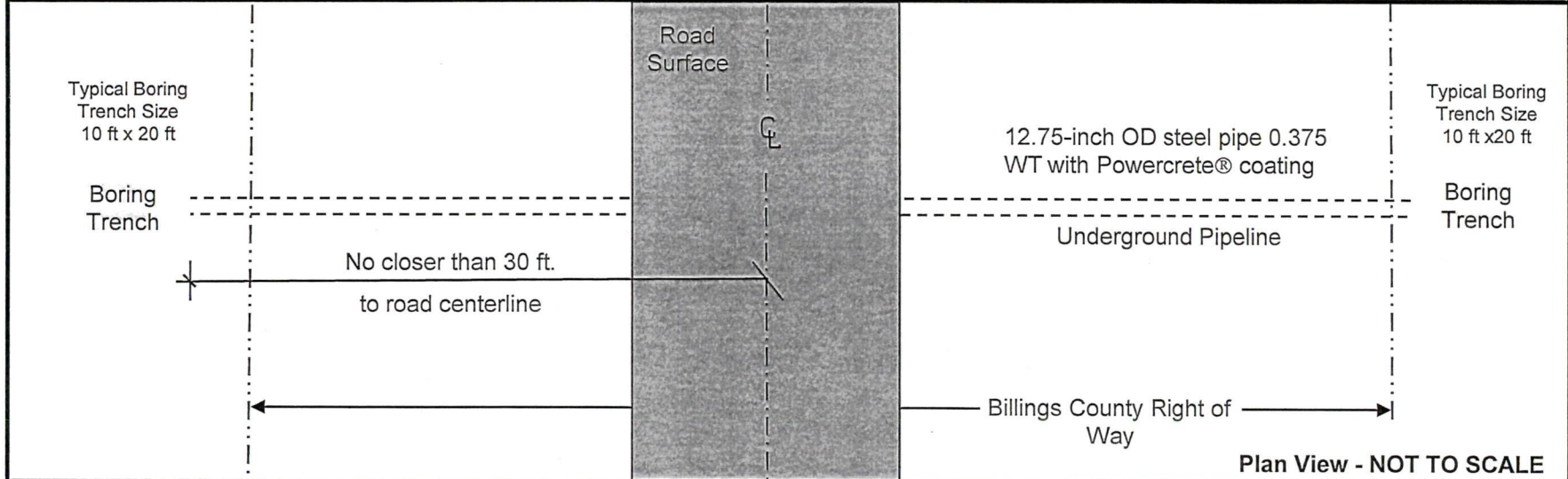
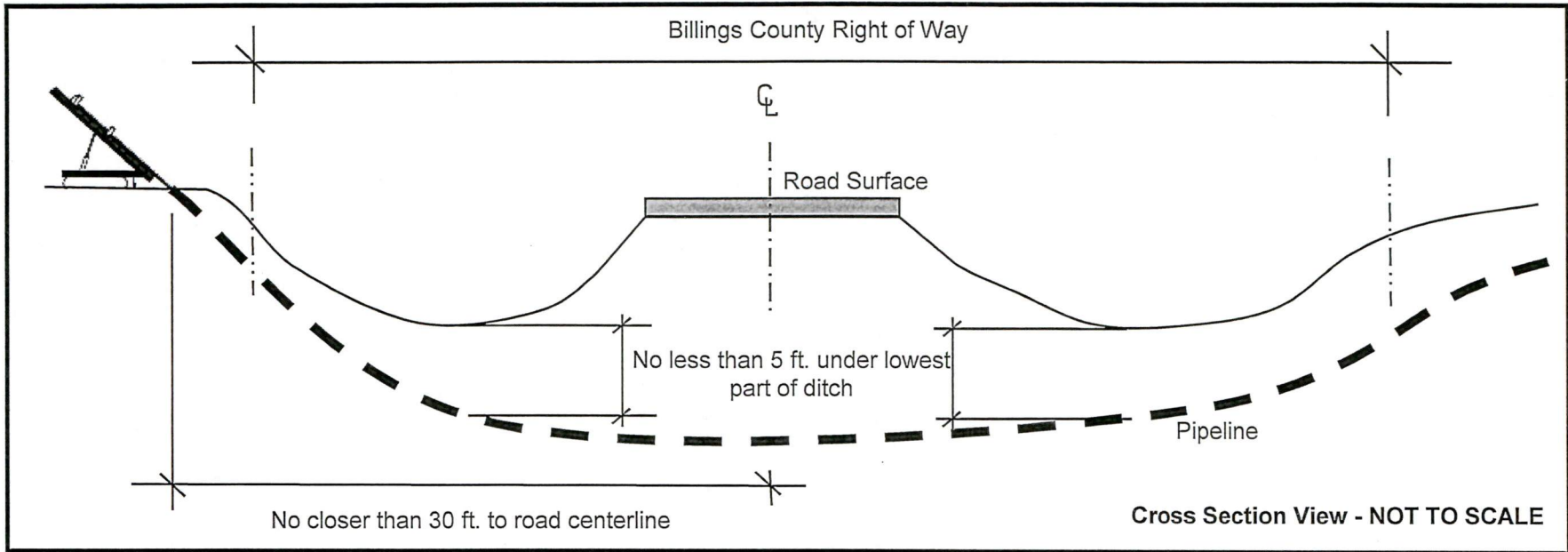

Bridger Pipeline LLC
 455 North Poplar Street
 Casper, Wyoming 82602
 307-237-9301

Cross Section and Plan View
 Paved Road Crossing
 Four Bears 12-inch Crude Line

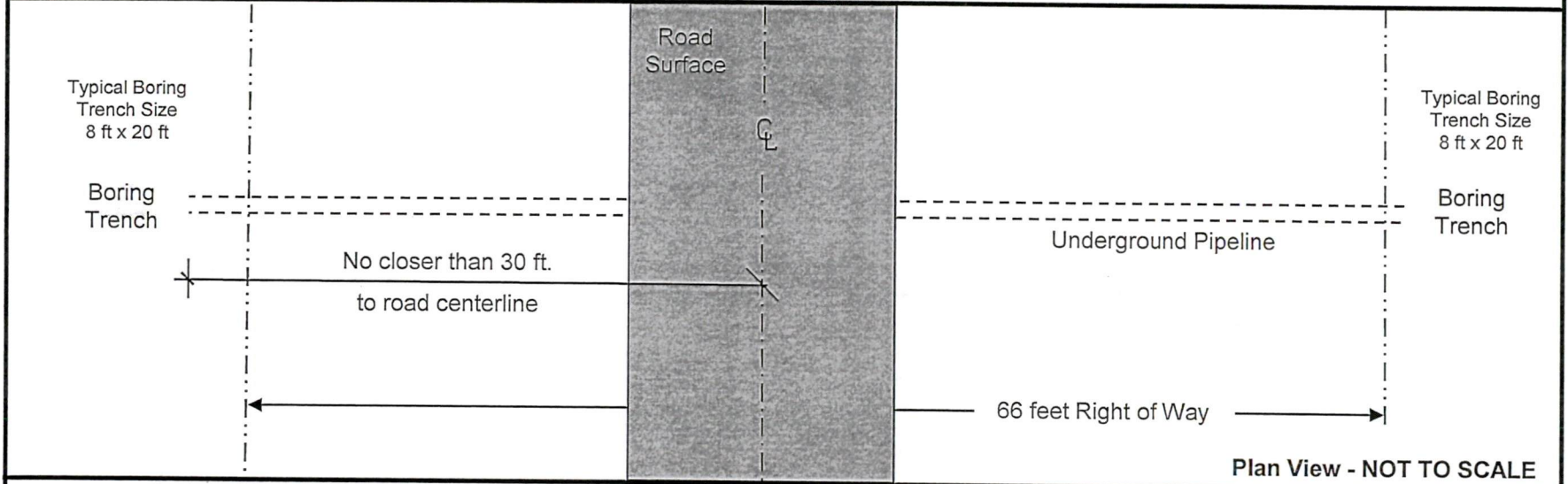
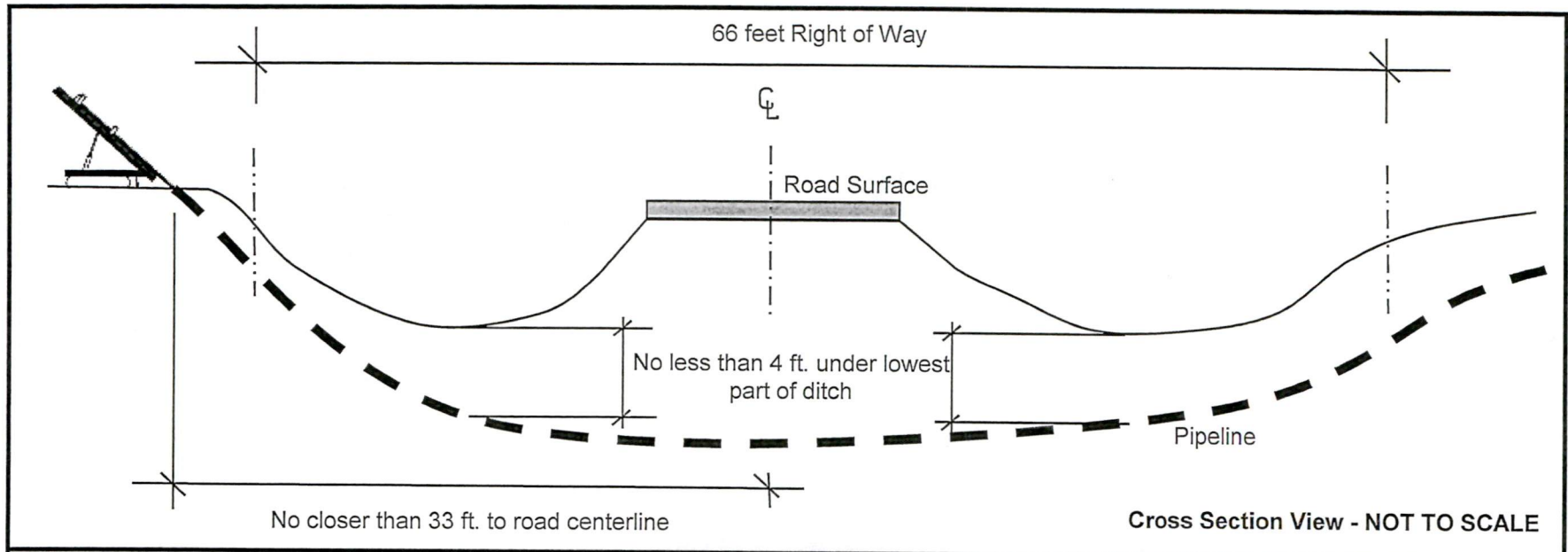

*Bridger Pipeline LLC
455 North Poplar Street
Casper, Wyoming 82602
307-237-9301*

**Cross Section and Plan View
Gravel Road Crossing
Four Bears 12-inch Crude Line**

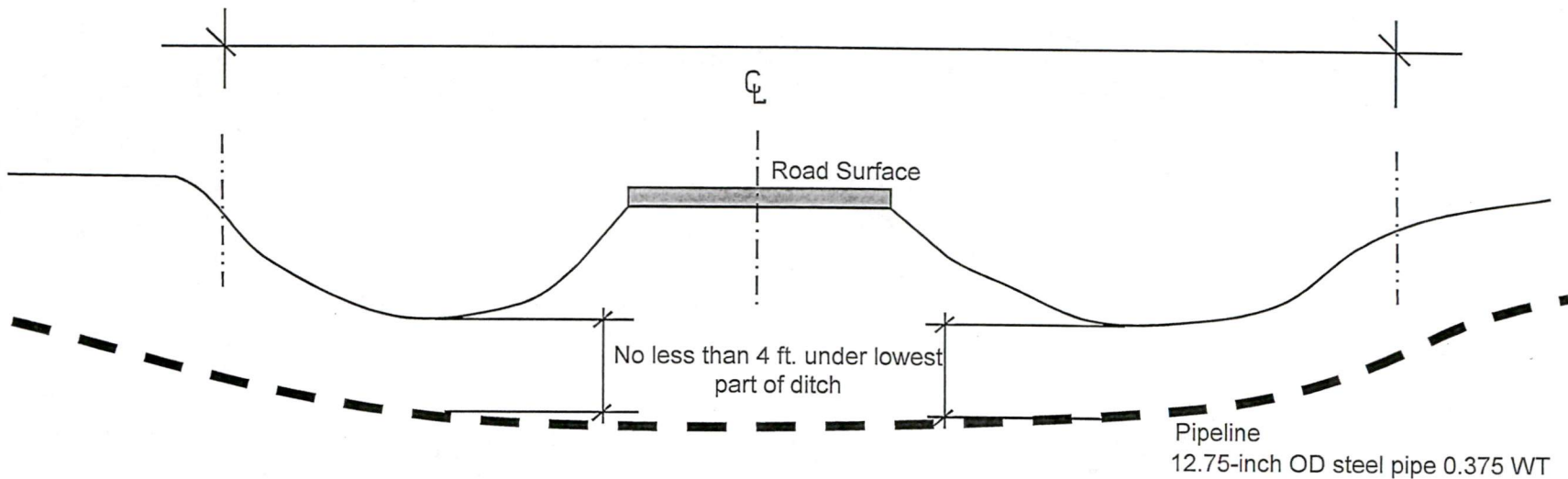

Note: Per PSC Requirements pipeline shall be buried to a minimum depth from the ground surface to the top of the pipe of

- 48 inches in rangeland
- 48 inches for cultivated land
- 48 inches at the bottom of the ditch for road crossings
- 72 inches across undeveloped section lines



*Bridger Pipeline LLC
455 North Poplar Street
Casper, Wyoming 82602
307-237-9301*

Cross Section and Plan View
Open Cut Road Crossings
Four Bears 12-inch Crude Line

Application for Special/Conditional Use Permit

I, Bridger Pipeline LLC, P.O. Drawer 2360, Casper, WY 82602, hereby apply for a Conditional/Special Use Permit, for the County of Billings.

Current Use: Cropland & Pasture land (Agricultural Zoned)

Proposed Use: Crude Oil Pipeline

Section: 1,10, 11, 12, 15

Township: 141N

Range: 98W

Total Acres: 40.85 (3.4 miles of length with a 100' right of way)

Please state in detail the reason for applying for this Permit

Reason:

The proposed Bridger Four Bear's pipeline is approximately 77 miles long and will span through three counties: Billings, Dunn, and McKenzie. The 12 inch crude oil segment will connect to existing Bridger and Belle Fourche pipelines and will have truck receiving point approximately 15 miles west of the Four Bears Bridge. Upon completion, this system will provide pipeline transportation of McKenzie, Dunn, and Mountrail crude oil production to 3 major crude markets: 1) Guernsey, WY; 2) Clearbrook, MN; and 3) The Mandan Refinery. This market flexibility is critical to assure the best overall value is obtained for ND's crude oil production. The pipeline will create a safe, most economic mode of transportation of the crude oil, and will reduce traffic on County, State, and Federal Roads. 

Application requests will review by the Billings County Zoning Inspector, followed by a public hearing before the Zoning Board, and the approval of the request by the Billings County Commissioners.

Signature: _____

Owner of Property applying for Application

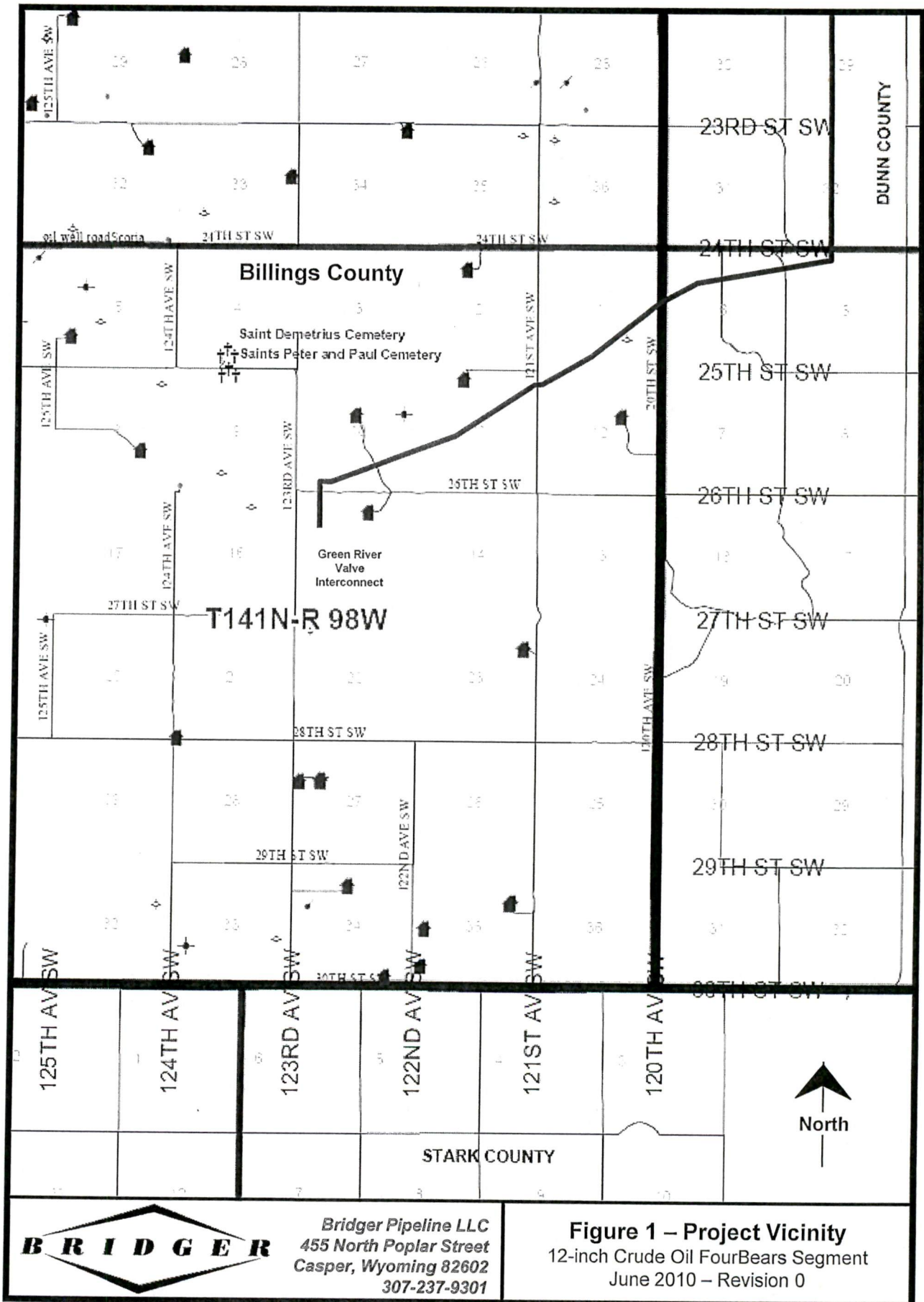

Bridger Pipeline LLC
455 North Poplar Street
Casper, Wyoming 82602
307-237-9301

Figure 1 – Project Vicinity
12-inch Crude Oil FourBears Segment
June 2010 – Revision 0