

BAKKEN OIL EXPRESS Rail Hub

Eland, North Dakota

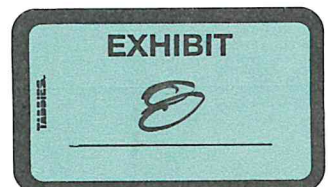

Owner: Bakken Oil Express, LLC
Chairman: Gerry O'Shaughnessy
General Manager: Steve Magness

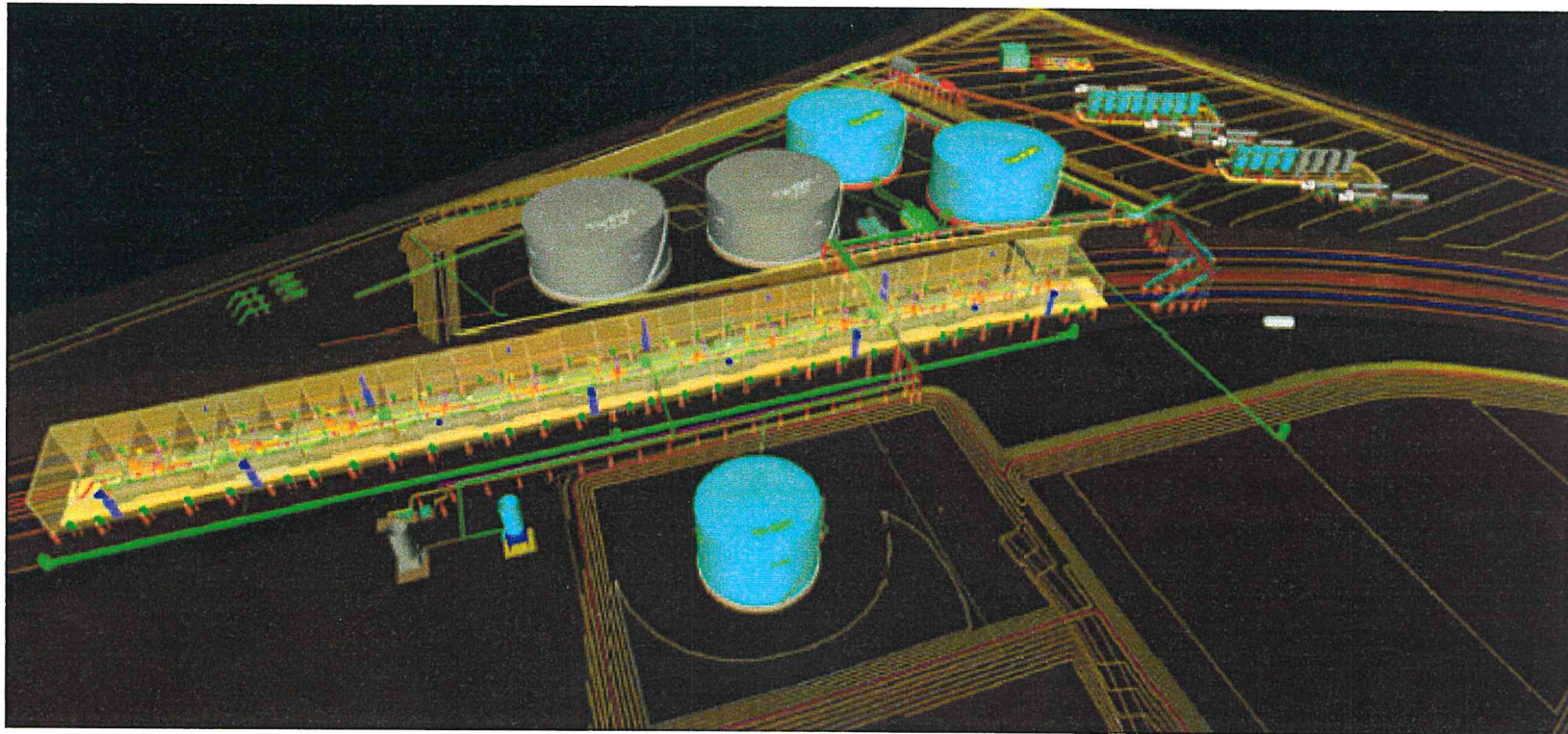

BAKKEN OIL EXPRESS Rail Hub



Eland, North Dakota

- North Dakota Crude Oil Terminal Rail Hub
- Strategically located on the BNSF South Line @ ELAND
- Surrounded by the Bakken and Three Forks fields
- Supporting the Producers needs to move high quality North Dakota crude oil to high valued markets

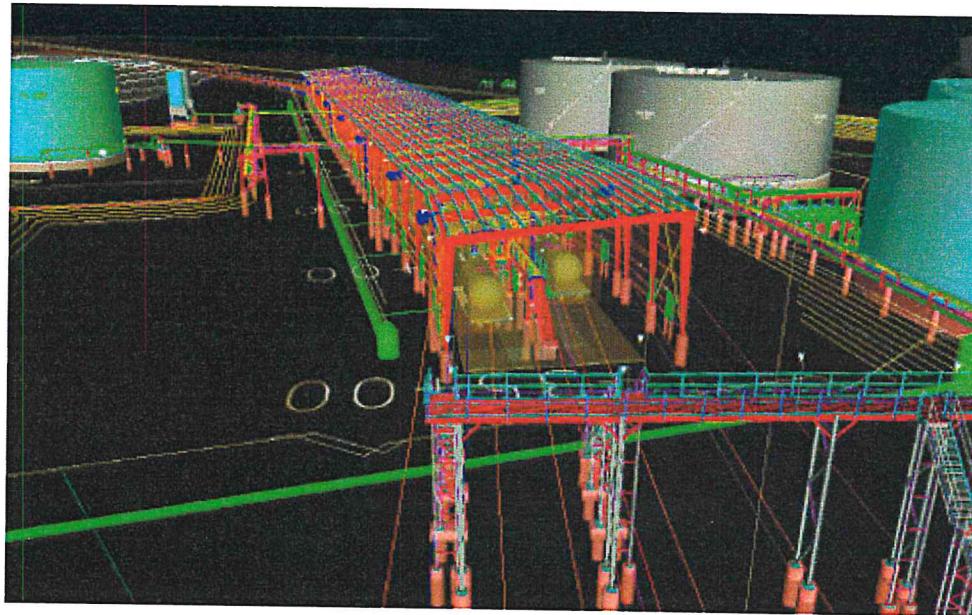

BAKKEN OIL EXPRESS Rail Hub



Eland North Dakota

- A State Of The Art designed for:
 - Operating efficiency
 - Rail Options
 - Tank Flexibility
 - Constructability
 - Compressed construction schedule
 - Shop fabrication
 - Shipper expectations
 - Accurate measurement
 - Quality of products
 - Industry Standards
 - DOT, FRA, ASME, NFPA, OSHA, EPA
 - Safety
 - Covered operations
 - Environmental
 - Spill containment
 - Vapor control

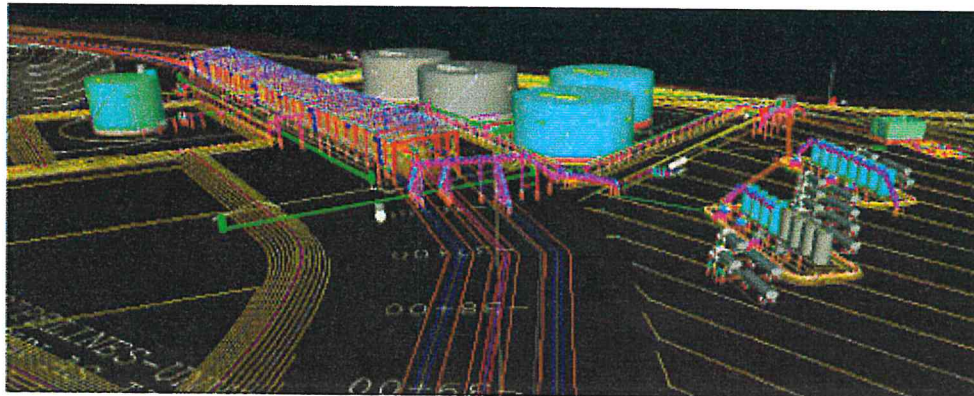

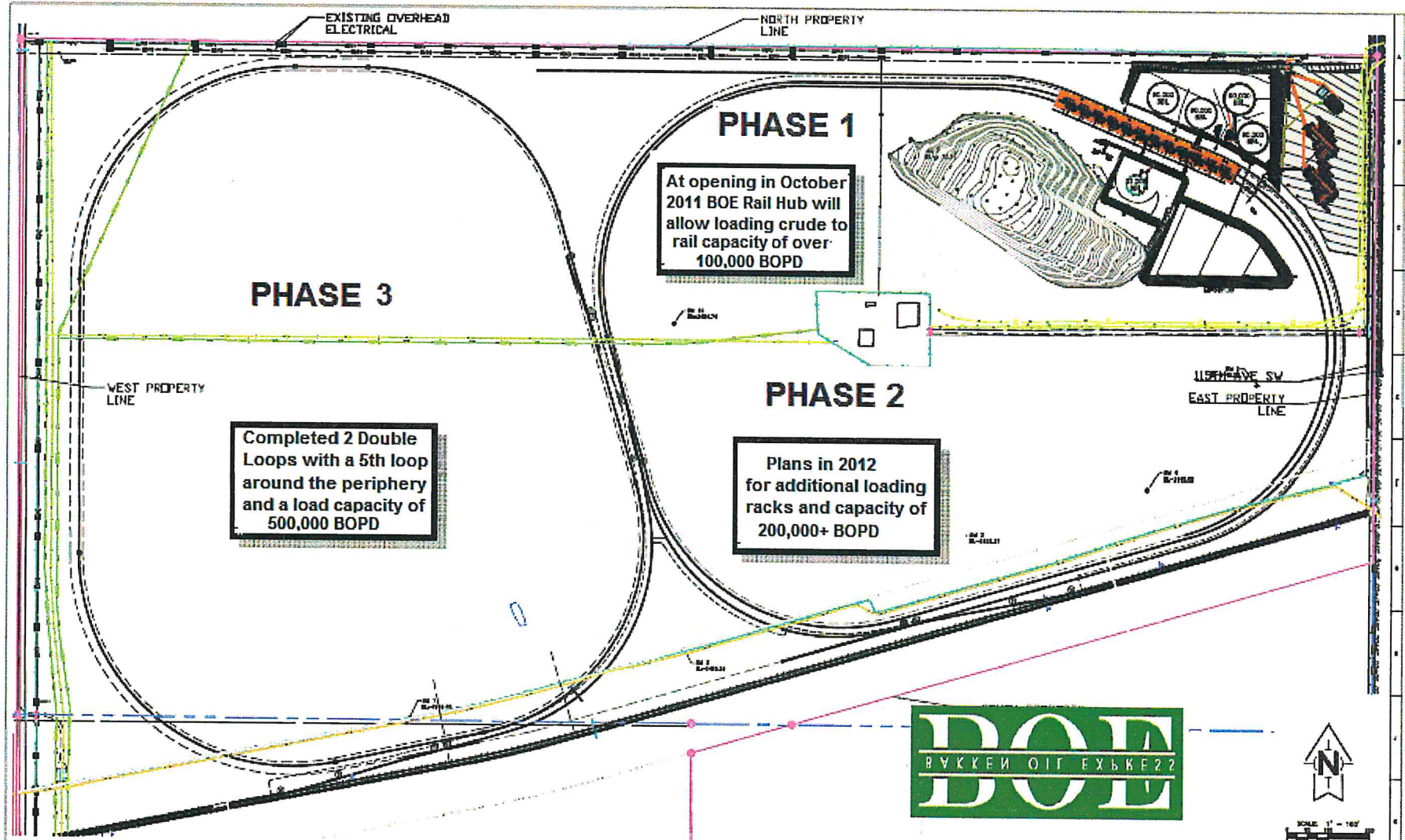

NO.	DATE	REVISIONS	BY	AP.	NO.	DATE	REVISIONS	BY	AP.	NO.	DATE	REVISIONS	BY	AP.	NO.	DATE	REVISIONS	BY	AP.
1					1					1					1				

MKEC MIDDLEBURY ENGINEERING CONSULTANTS, INC. 1111 East 27th St. Suite 400 Middlebury, OH 44660 Phone: 419-938-2200 Fax: 419-938-2201 www.mkec.com		EDOG LOGISTICS, LLC 1111 East 27th St. Suite 400 Middlebury, OH 44660 Phone: 419-938-2200 Fax: 419-938-2201 www.edog.com		RAIL LOADING FACILITY OVERHAUL SITE PLAN SHEET NO. EDD-1-101 OF 102 DATE: 11/11/11 SCALE: 1" = 100'	
-----------------------------------------------------------------------------------------------------------------------------------------------------------------------------	--	------------------------------------------------------------------------------------------------------------------------------------------------	--	---------------------------------------------------------------------------------------------------------------------	--

BAKKEN OIL EXPRESS Rail Hub

Eland, North Dakota

- Schedule

- First oil in by truck September 20, 2011



- First rail cars received October 10, 2011
- First unit train loaded and shipped October 31
- November 1, 2011 BOE Rail Hub completion facility capable of 100,000 BPD



BAKKEN OIL EXPRESS Rail Hub



Eland, North Dakota

- Crude Receiving Capabilities 2011:
 - 6 truck un-load bays;
 - LACT units with Micro-motion meters, 400 BBL tanks, BS&W measurement, 45 minutes unload time per truck, 21,000 BPD with capacity to 30,000 BPD
 - Pipeline receiving station
 - Pipeline meter station, PD meters, Pig receiver, 15,000 BPD with capacity to 30,000 BPD
- Crude Storage 2011
 - 3 cone roof storage tanks with internal floaters, ringwall foundation, secondary containment, cathodic protection, High level alarms, Radar Level
 - 1-32,000 BBL tank with mixer
 - 2-90,000 BBL tanks cone roof
- Crude Shipping capabilities 2011
 - 12 rail car covered loading rack, micro-motion measurement, BSW measurement, Overfill protection, Vapor containment, 55 minutes pumping time per car, 100,000 BPD capacity
 - Two complete rail-loops
 - Loop #1 (Outer loop) 7,637 Feet,
 - Loop #2 (Inner loop) 7,740 Feet
 - Bad Car tracks for each loop (446 feet each) holds 6 cars each bad order track

BAKKEN OIL EXPRESS Rail Hub



Eland, North Dakota

- Additional Crude Receiving Capabilities 2012:
 - 6 additional truck un-load bays;
 - LACT units with Micro-motion meters, 400 BBL tanks, BS&W measurement, 45 minutes unload time per truck, 21,000 BPD with capacity to 30,000 BPD
 - Pipeline receiving station
 - Pipeline meter station, PD meters, Pig receiver, with such capacity as additional pipeline requires
- Additional Crude Storage 2012
 - 2 additional 90,000 BBL cone roof storage tanks with internal floaters, ringwall foundation, secondary containment, cathodic protection, High level alarms, Radar Level
- Additional Crude Shipping capabilities 2012
 - Second 12 rail car covered loading rack, micro-motion measurement, BSW measurement, Overfill protection, Vapor containment, 55 minutes pumping time per car, 100,000 BPD capacity

BAKKEN OIL EXPRESS Rail Hub



Eland, North Dakota

- Environmental Compliance

- Cone Roof Tanks with internal floaters
- All Tanks with secondary containment, leak detection, cathodic protection, radar level gauges, High level alarms
- Tank Dikes with clay liners
- Vapor control on rail loading rack with high efficiency flare
- SPCCC plan, FRP plan
- HAZWOPER trained operations

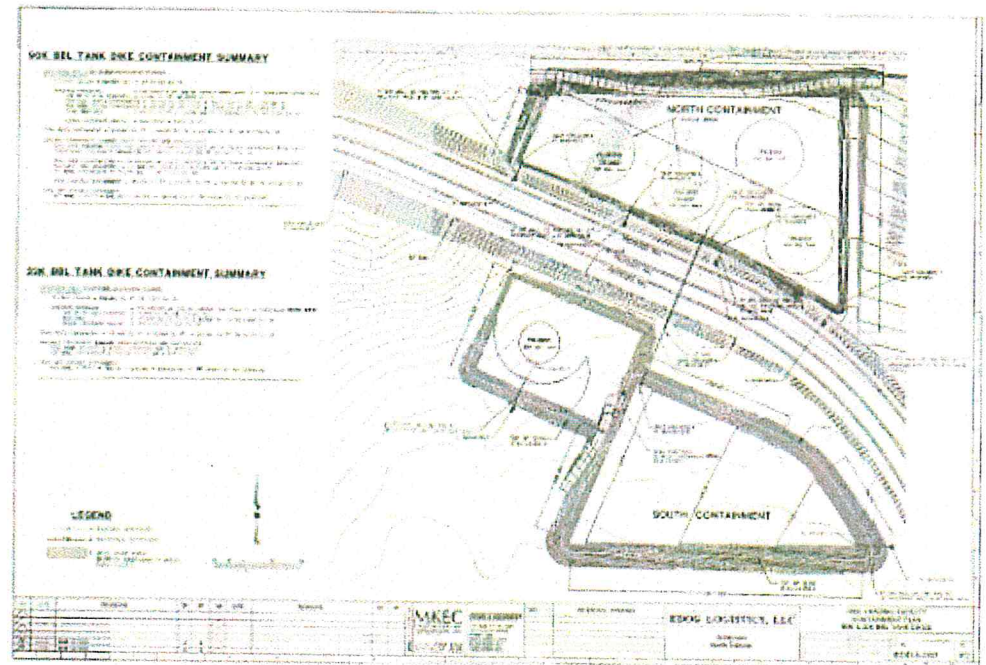

BAKKEN OIL EXPRESS Rail Hub

Eland, North Dakota



- Operator Strobel Starska Transfer

- Experienced with operating ND Crude to rail operations
- Experienced with Class 1 BNSF Rail Scheduling & Operations
- Experienced with running car repairs
- Training and operating procedures for crude oil to rail operations



STROBEL
STAROSTKA
T R A N S F E R

- Terminal Operations
 - Safety
 - Measurement
 - Quality
 - Scheduling
- Switching cars
- Logistics Management
 - Oil Receipts
 - Oil Deliveries
 - Rail Car Logistics
- Rail Car Repairs