

Exam Date:08/18/2010

Walhalla Bean Company

Page: 1

Examiner: 2

Box 67

Walhalla , ND

County:

Phone: 701-549-3721

CCC Number:

Location/Container Numbers/Comments	Section	Capacity
<b>PART A - ADDITIONAL SPACE TO BE INCLUDED UNDER LICENSE</b>		
006N	M	772
006S	M	772
102	M-J	318,328
		<b>Total:</b> 319,872

**PART B - SPACE TO BE DELETED UNDER LICENSE**

303	D	38,199
101	F	38,914
		<b>Total:</b> 77,113

**PART C - ALL SPACE TO BE INCLUDED UNDER LICENSE**

A	328,000
B	160,000
C	169,000
D	139,000
F	257,000
M	128,000
M-J	319,000
S	66,000
<b>Total:</b> 1,566,000	

**PART D - TOTAL CAPACITY BY FUNCTIONAL UNIT**

McVille	1210	S	66,000
Merrifield	1147	M M-J	447,000
Walhalla	505	A B C D F	1,053,000
			<b>Total:</b> 1,566,000

### NDPSC Bin Capacity Chart

Exam Date:08/18/2010

Walhalla Bean Company  
 Box 67  
 Walhalla , ND  
 County:

Status	Section	Bin Number	Bin Type	Base Point	Diameter or Bu/Ft (Irreg).		Side wall	Add for Hopper	Ded. for Obst.	Effective Depth	Add for Peak	Depth for Capac.	Bushels per Foot	Base Pack%	Bushel Capacity with Pack
					Length	Width									

## Facility: McVile

### Section: S

S	001	Peaked	Stein Seed Co- top of	14.500	0.000	0.000	15.00	2.20	0.00	17.200	0.900	18.1	132.7	5.50	2,534
S	002	Peaked	Stein Seed Co- top of	14.500	0.000	0.000	15.00	2.20	0.00	17.200	0.900	18.1	132.7	5.50	2,534
S	005	Peaked	Stein Seed Co- top of	14.500	0.000	0.000	15.00	2.20	0.00	17.200	0.900	18.1	132.7	5.50	2,534
S	006	Peaked	Stein Seed Co- top of	14.500	0.000	0.000	15.00	2.20	0.00	17.200	0.900	18.1	132.7	5.50	2,534
S	007	Peaked	Stein Seed Co- top of	16.000	0.000	0.000	25.00	2.30	0.00	27.300	1.000	28.3	161.6	5.80	4,838
S	008	Peaked	Stein Seed Co- top of	16.000	0.000	0.000	25.00	2.30	0.00	27.300	1.000	28.3	161.6	5.80	4,838
S	009	Peaked	Stein Seed Co- top of	16.000	0.000	0.000	25.00	2.30	0.00	27.300	1.000	28.3	161.6	5.80	4,838
S	010	Peaked	Stein Seed Co- top of	16.000	0.000	0.000	25.00	2.30	0.00	27.300	1.000	28.3	161.6	5.80	4,838
S	011	Peaked	Stein Seed Co- top of	16.000	0.000	0.000	25.00	2.30	0.00	27.300	1.000	28.3	161.6	5.80	4,838
S	012	Peaked	Stein Seed Co- top of	16.000	0.000	0.000	25.00	2.30	0.00	27.300	1.000	28.3	161.6	5.80	4,838
S	013	Peaked	Stein Seed Co- top of	12.500	0.000	0.000	15.00	1.80	0.00	16.800	0.800	17.6	98.6	5.00	1,822
S	014	Peaked	Stein Seed Co- top of	12.500	0.000	0.000	15.00	1.80	0.00	16.800	0.800	17.6	98.6	5.00	1,822
S	015	Peaked	Stein Seed Co- top of	12.500	0.000	0.000	15.00	1.80	0.00	16.800	0.800	17.6	98.6	5.00	1,822
S	016	Peaked	Stein Seed Co- top of	12.500	0.000	0.000	15.00	1.80	0.00	16.800	0.800	17.6	98.6	5.00	1,822
S	017	Peaked	Stein Seed Co- top of	16.000	0.000	0.000	25.00	2.30	0.00	27.300	1.000	28.3	161.6	5.80	4,838
S	018	Peaked	Stein Seed Co- top of	16.000	0.000	0.000	25.00	2.30	0.00	27.300	1.000	28.3	161.6	5.80	4,838
S	019	Peaked	Stein Seed Co- top of	16.000	0.000	0.000	25.00	2.30	0.00	27.300	1.000	28.3	161.6	5.80	4,838
S	020	Peaked	Stein Seed Co- top of	16.000	0.000	0.000	25.00	2.30	0.00	27.300	1.000	28.3	161.6	5.80	4,838

Bin count: 18

Facility: McVile Section: S Total: **65,804**

To Even: **66,000**

## NDPSC Bin Capacity Chart

Exam Date:08/18/2010

Walhalla Bean Company  
Box 67  
Walhalla , ND  
County:

Examiner: 2

Status	Section	Bin Number	Bin Type	Base Point	Diameter or Bu/Ft (Irreg).		Side wall	Add for Hopper	Ded. for Obst.	Effective Depth	Add for Peak	Depth for Capac.	Bushels per Foot	Base Pack%	Bushel Capacity with Pack
					Length	Width									

## Facility: Merrifield

### Section: M

	M	001	Flat	Merrifield ceiling ht. 18.8'	0.000	98.00	19.00	11.50	0.00	0.00	11.500	0.000	11.5	1496.8	10.0	18,934
	M	002	Flat	Merrifield ceiling ht. 18.8'	0.000	98.00	19.00	11.50	0.00	0.00	11.500	0.000	11.5	1496.8	10.0	18,934
	M	003	Flat	Merrifield ceiling ht. 18.8'	0.000	98.00	19.00	11.50	0.00	0.00	11.500	0.000	11.5	1496.8	10.0	18,934
	M	004	Flat	Merrifield ceiling ht. 18.8'	0.000	80.00	19.00	11.50	0.00	0.00	11.500	0.000	11.5	1221.9	10.0	15,457
	M	005	Flat	Merrifield ceiling ht. 18.8'	0.000	80.00	19.00	11.50	0.00	0.00	11.500	0.000	11.5	1221.9	10.0	15,457
Added	M	006N	Peaked	top of sidewall	12.300	80.00	19.00	5.000	2.00	0.00	7.000	0.700	7.7	95.5	5.00	772
Added	M	006S	Peaked	top of sidewall	12.300	0.000	0.000	5.000	2.00	0.00	7.000	0.700	7.7	95.5	5.00	772
	M	007	Peaked	top of sidewall hopper tank	15.000	0.000	0.000	15.00	2.30	0.00	17.300	0.900	18.2	142.1	5.50	2,728
	M	101	Quonset	Merrifield ceiling ht 17.8'	0.000	91.00	42.50	11.00	0.00	0.00	11.000	0.000	11.0	2963.8	10.0	35,863

**Bin count: 9**

**Facility: Merrifield Section: M Total: 127,851**

To Even: 128,000

### Section: M-J

Added	M-J	102	Flat	Merrifield ceiling ht 17.8'	0.000	300.0	150.0	8.000	0.00	0.00	8.000	0.000	8.0	36173.6	10.0	318,328
-------	-----	-----	------	-----------------------------	-------	-------	-------	-------	------	------	-------	-------	-----	---------	------	---------

**Bin count: 1**

**Facility: Merrifield Section: M-J Total: 318,328**

To Even: 319,000

Exam Date:08/18/2010

Walhalla Bean Company  
Box 67  
Walhalla , ND  
County:

Page: 3

Status	Section	Bin Number	Bin Type	Base Point	Diameter or Bu/Ft (Irreg).		Side wall	Add for Hopper	Ded. for Obst.	Effective Depth	Add for Peak	Depth for Capac.	Bushels per Foot	Base Pack%	Bushel Capacity with Pack
					Length	Width									

## Facility: Walhalla

### Section: A

A	001	Square	top of bin at sidewall	0.000	10.10	10.10	14.00	0.00	0.00	14.000	0.000	14.0	82.0	5.50	1,211
A	002	Square	top of bin at sidewall	0.000	10.00	10.00	14.00	0.00	0.00	14.000	0.000	14.0	80.4	5.50	1,188
A	003	Square	top of bin at sidewall	0.000	10.00	10.00	14.00	0.00	0.00	14.000	0.000	14.0	80.4	5.50	1,188
A	004	Square	top of bin at sidewall	0.000	10.00	10.00	18.00	0.00	0.00	18.000	0.000	18.0	80.4	5.50	1,527
A	005	Square	top of bin at sidewall	0.000	10.00	10.00	18.00	0.00	0.00	18.000	0.000	18.0	80.4	5.50	1,527
A	006	Square	top of bin at sidewall	0.000	10.00	10.00	18.00	0.00	0.00	18.000	0.000	18.0	80.4	5.50	1,527
A	007	Square	top of bin at sidewall	0.000	10.00	10.00	19.00	0.00	0.00	19.000	0.000	19.0	80.4	5.50	1,612
A	008	Square	top of bin at sidewall	0.000	10.00	10.00	19.00	0.00	0.00	19.000	0.000	19.0	80.4	5.50	1,612
A	009	Square	top of bin at sidewall	0.000	10.00	10.00	18.00	0.00	0.00	18.000	0.000	18.0	80.4	5.50	1,527
A	010	Square	top of bin at sidewall	0.000	10.00	10.00	18.00	0.00	0.00	18.000	0.000	18.0	80.4	5.50	1,527
A	011	Square	top of bin at sidewall	0.000	6.000	6.000	17.00	0.00	0.00	17.000	0.000	17.0	28.9	2.50	503
A	012	Flat	grainwall ht. 12.0' center	9.000	39.50	32.90	11.00	0.00	0.00	11.000	3.200	14.2	1044.7	10.0	16,319
A	013	Flat	grainwall ht. 27.1' catwalk	8.000	50.00	40.00	24.00	0.00	0.00	24.000	2.900	26.9	1607.7	10.0	47,572
A	014	Flat	grainwall ht. 27.1' catwalk	8.000	50.00	40.00	24.00	0.00	0.00	24.000	2.900	26.9	1607.7	10.0	47,572
A	015	Flat	grainwall ht. 27.1' catwalk	8.000	50.00	40.00	24.00	0.00	0.00	24.000	2.900	26.9	1607.7	10.0	47,572
A	016	Flat	bag warehouse	0.000	150.0	30.00	12.00	0.00	0.00	12.000	0.000	12.0	3617.4	10.0	47,750
A	017	Flat	grainwall ht. 12.0' overhead	14.000	118.8	68.80	8.500	0.00	0.00	8.500	5.600	14.1	6570.3	10.0	101,905
A	101	Square	top of sidewall over color	0.000	13.00	7.000	21.00	1.40	0.00	22.400	0.000	22.4	73.2	5.50	1,730
A	102	Square	top of sidewall over color	0.000	13.00	8.000	21.00	1.40	0.00	22.400	0.000	22.4	83.6	5.80	1,982

## NDPSC Bin Capacity Chart

Exam Date:08/18/2010

Walhalla Bean Company  
Box 67  
Walhalla , ND  
County:

Page: 4

Status	Section	Bin Number	Bin Type	Base Point	Diameter or Bu/Ft (Irreg).		Side wall	Add for Hopper	Ded. for Obst.	Effective Depth	Add for Peak	Depth for Capac.	Bushels per Foot	Base Pack%	Bushel Capacity with Pack
					Length	Width									
<b>Bin count:</b>		<b>19</b>											<b>Facility: Walhalla Section: A Total:</b>	<b>327,351</b>	
														<b>To Even:</b>	<b>328,000</b>

**Section: B**

B	101	Flat	1995 bulk wrhse east of	12.800	198.5	58.50	8.900	0.00	0.00	8.900	5.800	14.7	9334.6	10.0	150,941
B	102	Peaked	hopper tank north of flat 101	17.000	0.000	0.000	20.00	2.30	0.00	22.300	1.000	23.3	182.5	5.80	4,499
B	103	Peaked	hopper tank north of flat 101	17.000	0.000	0.000	20.00	2.30	0.00	22.300	1.000	23.3	182.5	5.80	4,499
<b>Bin count:</b>		<b>3</b>											<b>Facility: Walhalla Section: B Total:</b>	<b>159,939</b>	
														<b>To Even:</b>	<b>160,000</b>

**Section: C**

C	201	Peaked	eave at sidewall	14.000	0.000	0.000	12.00	2.20	0.00	14.200	0.800	15.0	123.7	5.50	1,958
C	202	Peaked	eave at sidewall	14.000	0.000	0.000	12.00	2.20	0.00	14.200	0.800	15.0	123.7	5.50	1,958
C	203	Peaked	eave at sidewall	14.000	0.000	0.000	12.00	2.20	0.00	14.200	0.800	15.0	123.7	5.50	1,958
C	204	Peaked	eave at sidewall	14.000	0.000	0.000	12.00	2.20	0.00	14.200	0.800	15.0	123.7	5.50	1,958
C	205	Peaked	eave at sidewall	14.000	0.000	0.000	12.00	2.20	0.00	14.200	0.800	15.0	123.7	5.50	1,958
C	206	Peaked	eave at sidewall	14.000	0.000	0.000	12.00	2.20	0.00	14.200	0.800	15.0	123.7	5.50	1,958
C	209	Flat	3D - west grainwall ht. 10.0'	11.400	118.8	58.60	8.000	0.00	0.00	8.000	4.800	12.8	5596.2	10.0	78,794
C	210	Flat	3D east grainwall ht. 10.5'	11.000	119.4	58.50	8.000	0.00	0.00	8.000	4.600	12.6	5614.9	10.0	77,823
<b>Bin count:</b>		<b>8</b>											<b>Facility: Walhalla Section: C Total:</b>	<b>168,365</b>	
														<b>To Even:</b>	<b>169,000</b>

Exam Date:08/18/2010

Walhalla Bean Company  
Box 67  
Walhalla , ND  
County:

Page: 5

Status	Section	Bin Number	Bin Type	Base Point	Diameter or Bu/Ft (Irreg).		Side wall	Add for Hopper	Ded. for Obst.	Effective Depth	Add for Peak	Depth for Capac.	Bushels per Foot	Base Pack%	Bushel Capacity with Pack
					Length	Width									

## Facility: Walhalla

### Section: D

D	301	Flat	christian bldng grain wall	0.000	178.5	58.80	11.00	0.00	0.00	11.000	0.000	11.0	8437.1	10.0	102,089
D	304	Quonset	Karel quonset	0.000	98.50	37.50	12.00	0.00	0.00	12.000	0.000	12.0	2751.7	10.0	36,324
<b>Bin count:</b>		<b>2</b>											<b>Facility: Walhalla Section: D Total:</b>	<b>138,413</b>	
													<b>To Even:</b>	<b>139,000</b>	

### Section: F

F	102	Flat	stremik building	0.000	96.00	48.00	8.000	0.00	0.00	8.000	0.000	8.0	3704.2	10.0	32,597
F	106	Flat	eagan white wrhse	0.000	79.60	41.80	10.50	0.00	0.00	10.500	0.000	10.5	2674.7	10.0	30,892
F	107	Flat	eagan white wrhse	0.000	63.70	20.50	10.50	0.00	0.00	10.500	0.000	10.5	1049.7	10.0	12,124
F	108	Flat	eagan white wrhse	0.000	63.70	20.50	10.50	0.00	0.00	10.500	0.000	10.5	1049.7	10.0	12,124
F	109	Flat	eagan white wrhse	0.000	41.80	103.0	10.50	0.00	0.00	10.500	0.000	10.5	3460.9	10.0	39,973
F	110	Flat	eagan white wrhse	0.000	95.70	20.50	10.50	0.00	0.00	10.500	0.000	10.5	1577.0	10.0	18,215
F	111	Flat	eagan white wrhse	0.000	95.70	20.50	10.50	0.00	0.00	10.500	0.000	10.5	1577.0	10.0	18,215
F	112	Flat	eagan white wrhse	0.000	49.00	30.00	5.000	0.00	0.00	5.000	0.000	5.0	1181.7	10.0	6,500
F	113	Flat	eagan white wrhse	0.000	40.00	51.70	5.000	0.00	0.00	5.000	0.000	5.0	1662.4	10.0	9,143
F	114	Quonset	Bjornstad building addition	0.000	88.00	41.00	12.00	0.00	0.00	12.000	0.000	12.0	2724.9	10.0	35,969
F	115	Quonset	Bjornstad building addition	0.000	96.00	42.00	12.00	0.00	0.00	12.000	0.000	12.0	3054.9	10.0	40,325
<b>Bin count:</b>		<b>11</b>											<b>Facility: Walhalla Section: F Total:</b>	<b>256,077</b>	
													<b>To Even:</b>	<b>257,000</b>	

Overall Licensed Bin Capacity for:

Walhalla Bean Company

Bin count: 71

**Licensed Capacity:**  
(includes pack)

1,562,128 Bu.

**Licensed Capacity (to even):**  
(includes pack and section totals are  
rounded up to next highest 1000)

1,566,000 Bu.

WALHALLA BEAN CO.  
SECTION M  
MERRIFIELD N.D.

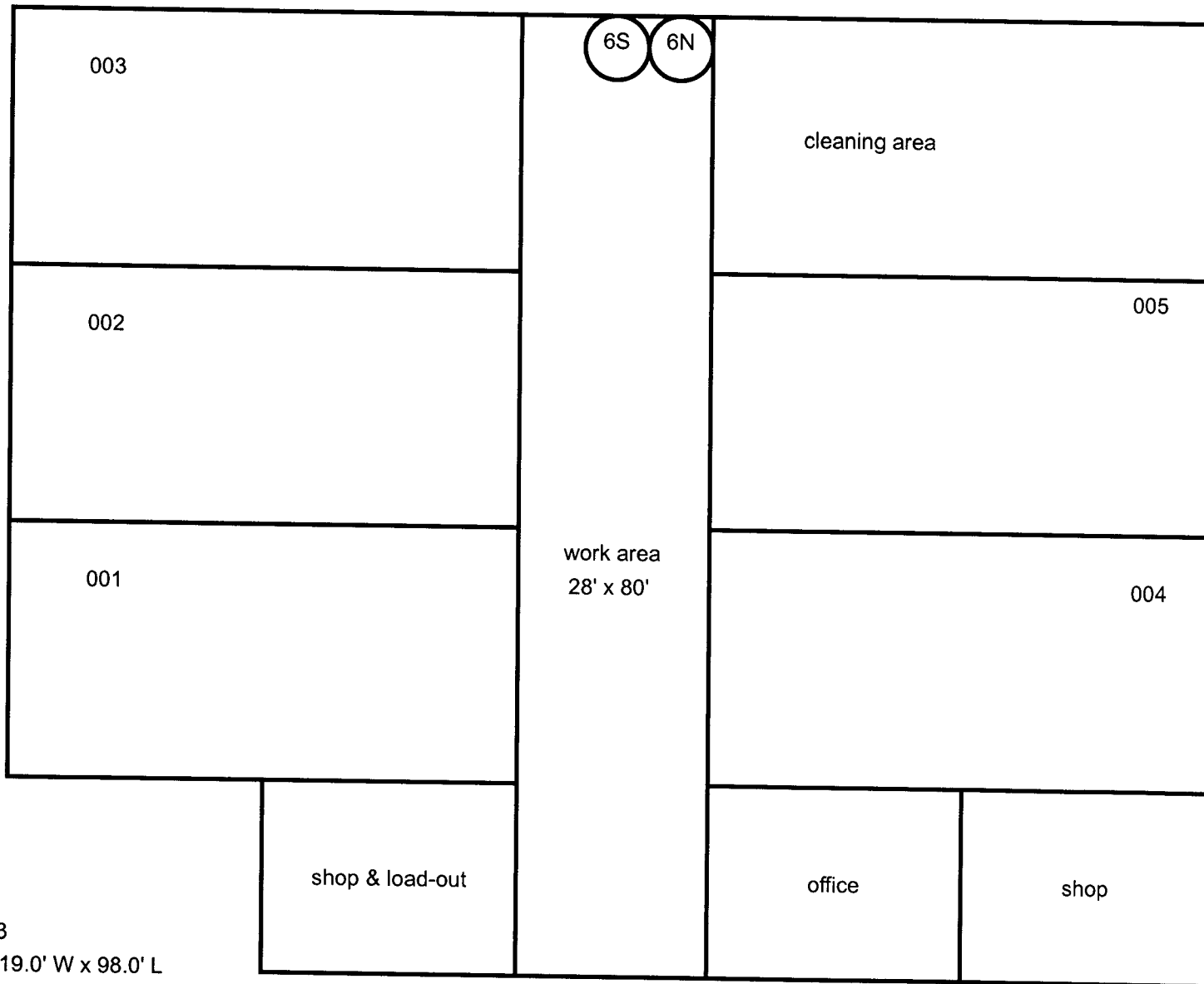

bins 1-2-3  
width 19.0' W x 98.0' L  
overhead ceiling to floor  
18.8'  
capacity calculated with  
11.5' grain depth

bins 4-5  
19.0W x 80.0'L  
overhead ceiling to floor  
18.8'

SECTION M-J 102 consists of Johnson leased flat located  
west of truck stop on 32nd Ave Grand Forks  
300,000 bu. 300'L x 150'W x 8' grain depth