

**Public Service Commission**  
600 East Boulevard Ave – Dept 408  
Bismarck, ND 58505-0480  
701-328-4097 – phone  
701-328-2410 – fax  
srichter@nd.gov

# Memo

**To:** Brian Larson  
**From:** Michael McNamee, Grain Warehouse Inspector  
Licensing Division  
**Date:** 9/9/2010  
**Re:** Bin Documents

---

Brian,

Enclosed is a copy of the bin documents I prepared for Co-op Elevator of McClusky. We will adjust your license capacity to include the space identified in these documents. The licensed capacity for McClusky, including the 92,000 bushels of ground storage will be 394,000 bushels.

If you have any questions, please let me know. I can be reached at 1-701-527-7389. Thank you.



Enclosure(1)

Exam Date:08/30/2010

Co-op Elevator of McClusky

Page: 1

Examiner: 1

PO Box 469  
McClusky, ND  
County:

Status	Section	Bin Number	Bin Type	Base Point	Diameter or Bu/Ft (Irreg).	Length	Width	Side wall	Add for Hopper	Ded. for Obst.	Effective Depth	Add for Peak	Depth for Capac.	Bushels per Foot	Base Pack%	Bushel Capacity with Pack
--------	---------	------------	----------	------------	-------------------------------	--------	-------	--------------	----------------------	----------------------	--------------------	--------------------	------------------------	------------------------	---------------	------------------------------

## Facility: McClusky

### Section: A

A	101	Peaked	top of sidewall - deduct 15'	36.000	0.000	0.000	39.00	0.00	0.00	39.000	2.200	41.2	818.2	10.0	37,081
A	102	Peaked	top of sidewall - deduct 15'	36.000	0.000	0.000	39.00	0.00	0.00	39.000	2.200	41.2	818.2	10.0	37,081
A	103	Peaked	top of sidewall	47.110	0.000	0.000	42.75	0.00	0.00	42.750	2.800	45.6	1401.2	10.0	70,285
A	104	Peaked	top of sidewall	47.110	0.000	0.000	42.75	0.00	0.00	42.750	2.800	45.6	1401.2	10.0	70,285

Bin count: 4

Facility: McClusky Section: A Total: **214,732**To Even: **215,000**

### Section: B

B	001	Square	work floor	0.000	11.30	7.600	44.50	0.00	0.00	44.500	0.000	44.5	69.0	5.20	3,231
B	002	Square	work floor	0.000	6.000	4.700	28.00	0.00	0.00	28.000	0.000	28.0	22.7	2.00	649
B	003 T	Square	work floor	0.000	2.700	1.500	16.00	0.00	0.00	16.000	0.000	16.0	3.3	2.00	54
B	003 B	Square	work floor - top 16'	0.000	7.600	2.700	15.50	0.00	0.00	15.500	0.000	15.5	16.5	2.00	261
B	004	Square	work floor	0.000	5.800	2.700	16.00	0.00	0.00	16.000	0.000	16.0	12.6	2.00	206
B	005	Square	work floor	0.000	11.30	4.600	28.00	0.00	0.00	28.000	0.000	28.0	41.8	3.50	1,211
B	006	Square	work floor	0.000	10.30	5.400	26.00	0.00	0.00	26.000	0.000	26.0	44.7	3.50	1,203
B	007	Square	work floor	0.000	11.30	5.300	44.50	0.00	0.00	44.500	0.000	44.5	48.1	4.20	2,230
B	009	Square	work floor	0.000	11.30	5.300	44.50	0.00	0.00	44.500	0.000	44.5	48.1	4.20	2,230
B	010 T	Irregular	work floor 10.3 x 5.4 less	16.500	0.000	0.000	9.000	0.00	0.00	9.000	0.000	9.0	16.5	2.00	152
B	010 B	Square	work floor - top 9'	0.000	10.30	5.400	17.00	0.00	0.00	17.000	0.000	17.0	44.7	3.50	787
B	011	Square	work floor	0.000	11.30	4.600	44.50	0.00	0.00	44.500	0.000	44.5	41.8	3.50	1,925

Exam Date:08/30/2010

Co-op Elevator of McClusky

Page: 2

Examiner: 1

PO Box 469  
McClusky, ND  
County:

Status	Section	Bin Number	Bin Type	Base Point	Diameter or Bu/Ft (Irreg.)	Length	Width	Side wall	Add for Hopper	Ded. for Obst.	Effective Depth	Add for Peak	Depth for Capac.	Bushels per Foot	Base Pack%	Bushel Capacity with Pack
--------	---------	------------	----------	------------	-------------------------------	--------	-------	--------------	----------------------	----------------------	--------------------	--------------------	------------------------	------------------------	---------------	------------------------------

## Facility: McClusky

### Section: B

B	012	Square	work floor		0.000	5.400	4.700	31.50	0.00	0.00	31.500	0.000	31.5	20.4	2.00	656
B	013	Square	work floor		0.000	5.400	4.700	31.50	0.00	0.00	31.500	0.000	31.5	20.4	2.00	656
B	014	Square	work floor		0.000	11.30	4.700	44.50	0.00	0.00	44.500	0.000	44.5	42.7	3.50	1,967
B	015	Square	work floor		0.000	11.30	7.600	44.50	0.00	0.00	44.500	0.000	44.5	69.0	5.20	3,231
B	ORB	Square	work floor		0.000	5.000	4.700	28.00	0.00	0.00	28.000	0.000	28.0	18.9	2.00	540
B	101 T	Square	work floor belw dst floor		0.000	11.50	11.40	36.00	0.00	0.00	36.000	0.000	36.0	105.4	6.20	4,029
B	101 B	Square	work floor belw dst floor -		0.000	11.30	8.600	9.500	0.00	0.00	9.500	0.000	9.5	78.1	5.50	783
B	102 T	Square	work floor belw dst floor -		0.000	11.60	11.50	36.00	0.00	0.00	36.000	0.000	36.0	107.2	6.20	4,098
B	102 B	Square	work floor belw dst floor -		0.000	11.60	8.600	9.500	0.00	0.00	9.500	0.000	9.5	80.2	5.50	804
B	103 T	Square	work floor belw dst floor -		0.000	11.60	11.50	36.00	0.00	0.00	36.000	0.000	36.0	107.2	6.20	4,098
B	103 B	Square	work floor belw dst floor -		0.000	11.60	8.600	9.500	0.00	0.00	9.500	0.000	9.5	80.2	5.50	804
B	104 T	Square	work floor belw dst floor		0.000	11.50	11.40	36.00	0.00	0.00	36.000	0.000	36.0	105.4	6.20	4,029
B	104 B	Square	work floor belw dst floor -		0.000	11.40	8.600	9.500	0.00	0.00	9.500	0.000	9.5	78.8	5.50	790
B	105 T	Square	work floor belw dst floor		0.000	11.50	11.40	36.00	0.00	0.00	36.000	0.000	36.0	105.4	6.20	4,029
B	105 B	Square	work floor belw dst floor -		0.000	11.40	8.600	9.500	0.00	0.00	9.500	0.000	9.5	78.8	5.50	790
B	106 T	Square	work floor belw dst floor -		0.000	11.60	11.50	36.00	0.00	0.00	36.000	0.000	36.0	107.2	6.20	4,098
B	106 B	Square	work floor belw dst floor -		0.000	11.60	8.600	9.500	0.00	0.00	9.500	0.000	9.5	80.2	5.50	804
B	107 T	Square	work floor belw dst floor -		0.000	11.60	11.50	36.00	0.00	0.00	36.000	0.000	36.0	107.2	6.20	4,098
B	107 B	Square	work floor belw dst floor -		0.000	11.60	8.600	9.500	0.00	0.00	9.500	0.000	9.5	80.2	5.50	804
B	108 T	Square	work floor belw dst floor		0.000	11.50	11.40	36.00	0.00	0.00	36.000	0.000	36.0	105.4	6.20	4,029

Exam Date:08/30/2010

Co-op Elevator of McClusky  
PO Box 469  
McClusky, ND  
County:

Page: 3

Examiner: 1

Status	Section	Bin Number	Bin Type	Base Point	Diameter or Bu/Ft (Irreg.)	Length	Width	Side wall	Add for Hopper	Ded. for Obst.	Effective Depth	Add for Peak	Depth for Capac.	Bushels per Foot	Base Pack%	Bushel Capacity with Pack
--------	---------	------------	----------	------------	-------------------------------	--------	-------	--------------	----------------------	----------------------	--------------------	--------------------	------------------------	------------------------	---------------	------------------------------

## Facility: McClusky

### Section: B

B	108 B	Square	work floor belw dst floor -	0.000	11.30	8.600	9.500	0.00	0.00	9.500	0.000	9.5	78.1	5.50	783
B	201	Peaked	eave	0.000	0.000	0.000	0.000	0.00	0.00	0.000	0.000	0.0	0.0	4.00	0
B	202	Peaked	eave	0.000	0.000	0.000	0.000	0.00	0.00	0.000	0.000	0.0	0.0	4.00	0

Bin count: 35

Facility: McClusky Section: B Total: **60,059**To Even: **61,000**

### Section: C

C	001	Square	work floor	0.000	4.700	4.200	24.00	0.00	0.00	24.000	0.000	24.0	15.9	2.00	390
C	002 T	Square	work floor	0.000	9.200	6.200	19.00	0.00	0.00	19.000	0.000	19.0	45.9	4.00	907
C	002 B	Square	work floor - top 19'	0.000	9.300	9.200	25.00	0.00	0.00	25.000	0.000	25.0	68.8	5.20	1,809
C	003	Square	work floor	0.000	9.600	9.200	44.00	0.00	0.00	44.000	0.000	44.0	71.0	5.20	3,286
C	004 T	Irregular	work floor 11 x 9.6 less 5.7	54.700	0.000	0.000	8.000	0.00	0.00	8.000	0.000	8.0	54.7	4.50	458
C	004 B	Square	work floor - top 8'	0.000	11.00	9.600	22.00	0.00	0.00	22.000	0.000	22.0	84.9	5.80	1,976
C	005	Square	work floor	0.000	9.300	9.200	44.00	0.00	0.00	44.000	0.000	44.0	68.8	5.20	3,184
C	006	Square	work floor	0.000	11.00	9.300	27.00	0.00	0.00	27.000	0.000	27.0	82.2	5.50	2,341
C	007	Square	work floor	0.000	9.300	9.300	44.00	0.00	0.00	44.000	0.000	44.0	69.5	5.20	3,217
C	010	Square	work floor	0.000	9.600	9.300	44.00	0.00	0.00	44.000	0.000	44.0	71.8	5.20	3,323
C	011	Square	work floor	0.000	9.400	4.200	31.50	0.00	0.00	31.500	0.000	31.5	31.7	2.50	1,024
C	012	Square	work floor	0.000	9.300	9.300	44.00	0.00	0.00	44.000	0.000	44.0	69.5	5.20	3,217
C	0TB	Square	work floor	0.000	9.200	3.000	13.50	0.00	0.00	13.500	0.000	13.5	22.2	2.00	306

Client ID: 913

### NDPSC Bin Capacity Chart

08/31/2010 03:28:59 PM

Exam Date:08/30/2010

Co-op Elevator of McClusky

Page: 4

Examiner: 1

PO Box 469  
McClusky , ND  
County:

Status	Section	Bin Number	Bin Type	Base Point	Diameter or Bu/Ft (Irreg.)	Length	Width	Side wall	Add for Hopper	Ded. for Obst.	Effective Depth	Add for Peak	Depth for Capac.	Bushels per Foot	Base Pack%	Bushel Capacity with Pack
--------	---------	------------	----------	------------	-------------------------------	--------	-------	--------------	----------------------	----------------------	--------------------	--------------------	------------------------	------------------------	---------------	------------------------------

Bin count: 13

Facility: McClusky Section: C Total: 25,438

To Even: 26,000

**Overall Licensed Bin Capacity for:**

Co-op Elevator of McClusky

Bin count: 52

**Licensed Capacity:**  
(includes pack)

300,229 Bu.

**Licensed Capacity (to even):**  
(includes pack and section totals are  
rounded up to next highest 1000)

302,000 Bu.

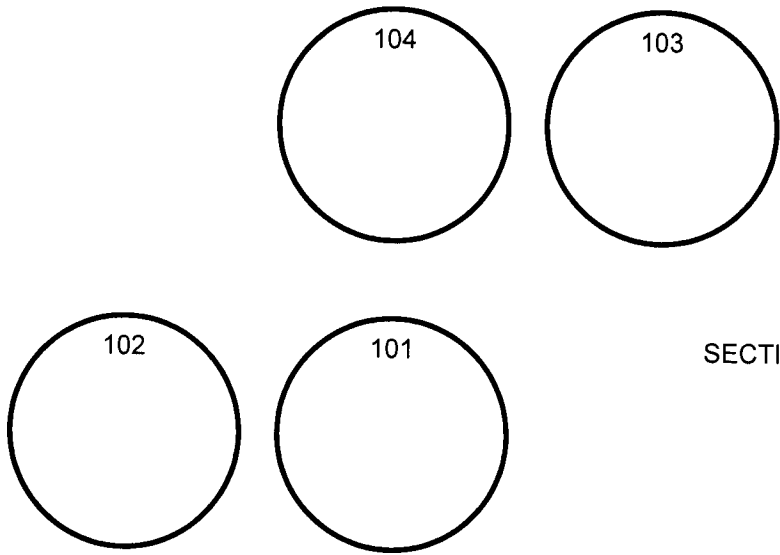

SECTION A

SECTION A

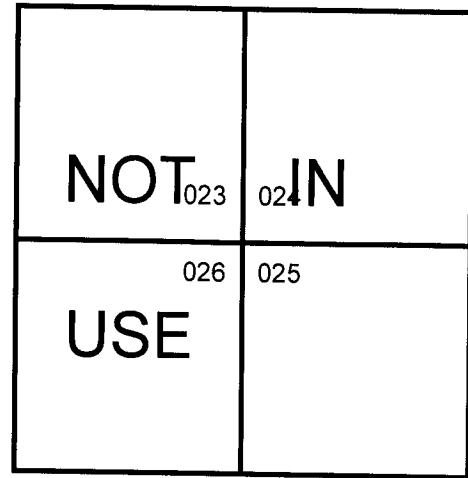

150' east

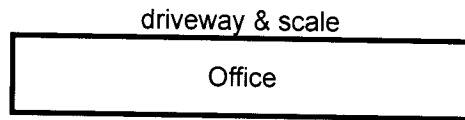

SECTION C

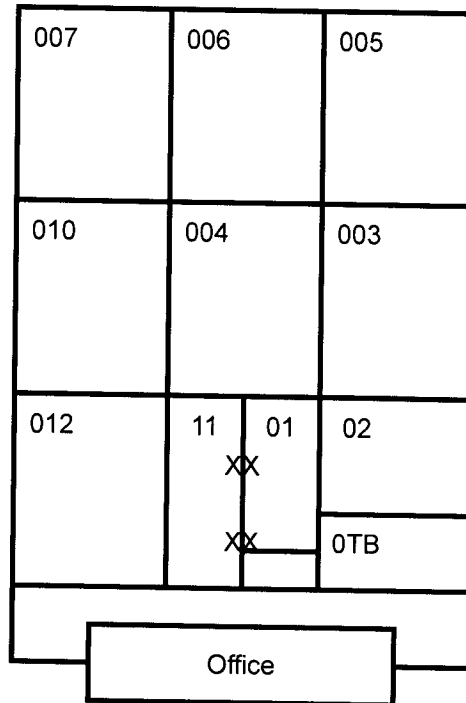

SECTION D

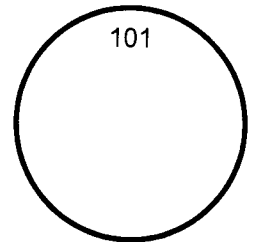

leased from Stein

120' east

CO-OP ELEVATOR OF McCLUSKY  
McCLUSKY N.D.