



817 Vandalia Street
Suite 100
St Paul, MN 55114

RECEIVED

JUL 06 2012

PUBLIC SERVICE COMMISSION

July 3, 2012

Mr. Darrell Nitschke
Executive Secretary
North Dakota Public Utilities Commission
600 E. Boulevard, Dept. 408
Bismarck, ND 58505-0480

RE: PU 10-630 Plains Pipeline L.P.: Bakken North Crude Oil Pipeline, Williams Co., ND

Mr. Nitschke:

On February 1, 2012, Plains Pipeline, L.P. (Plains), received a Certificate of Corridor Compatibility (#127) and a Route Permit (#136) for its Bakken North Pipeline project from the Public Service Commission (Case No. PU 10-630). Plains is seeking authorization for one minor route modifications as fully described in the enclosed documents. Please find one original and three copies of the following route amendment application to existing permits for Case No. PU 10-630: Bakken North Crude Oil Pipeline Project.

Upon your review, should you have questions or seek additional information please contact me at 651-282-0650 or via e-mail at wmccarthy@go2e3.com.

Best Regards,

For

William F. McCarthy
E3 Environmental, LLC

Enclosures- (4) North Dakota Public Utilities Commission Route Amendment Application

CC: (I) I. Jim Fleetwood, Plains Pipeline
(II) M. Walcavich
(III) E3 Project Files

57 PU-10-630 Filed: 7/6/2012 Pages: 8
Request for route modifications - updated

Plains Pipeline, L.P.

Case No. PU-10-630
Plains Pipeline, L.P.
Crude Oil Pipeline – Williams County
Siting Application – Route Amendment

Introduction

On February 1, 2012, Plains Pipeline, L. P. (Plains), received a Certificate of Corridor Compatibility (# 127) and a Route Permit (#136) for its Bakken North Pipeline project from the Public Service Commission (Case No. PU-10-630). This pertains to the construction of a crude oil pipeline located in Williams County, North Dakota (Project). As stated under North Dakota Century Code, Section 49-22-07, a utility may not begin construction of a transmission facility in the state without first having obtained a route permit. The facility must be constructed, operated, and maintained in conformity with the permit and any terms, conditions, or modifications of the permit. All permitting requirements were met at that time and construction preparations of the pipeline were initiated.

Plains initiated construction of the project on or about May 23, 2012. Normal construction sequence includes centerline staking of the approved alignment. On or about May 30, 2012, the centerline staking of the route identified two previously unknown encroachments into the approved workspace and alignment. Bear Paw Energy (BPE) had completed centerline staking of a gathering line prior to construction. Plains successfully negotiated a settlement with BPE to address this encroachment and this issue has been resolved without modification to the Plains alignment or workspace. The second encroachment involved an 8-inch steel pipeline that has been installed by Hiland. The installation of Hiland's line occurred after the siting and easement procurement by Plains but prior to May 30, 2012. In the interest of minimizing collateral impacts to the environment and project schedule, Plains is requesting a minor route modification to accommodate the Hiland 8-inch steel line.

Plains has engineered a foreign line crossing to accommodate the Hiland 8-inch steel line encroachment. This will require a minor modification of the original alignment entailing an off-set of approximately 10 feet for an approximate length of 781 feet. Plains requests the approval of this minor route modification to facilitate the installation and future operations of this pipeline.

This request will not result in any modification to previously reported facility type, size or design including above ground facilities.

This request shall conform to all previously approved mitigation measures as well as right-of-way preparation and reclamation measures.

This request shall not impact any Exclusion or Avoidance Areas and shall conform with the Siting Criteria as previously reported.

All supporting attachments have been previously filed with the Commission except for the engineering detail of the proposed off-set alignment.

Case No. PU-10-630
Plains Pipeline, L.P.
Crude Oil Pipeline – Williams County
Siting Application – Route Amendment

Project Location

The proposed route amendment occurs between MP 16.9 and 17.1 which is located in T156N, R102W, Sections 9 and 16, Williams County, North Dakota.

Route Amendment

Plains requests Commission approval of a minor route modification to accommodate construction workspace requirements and future operating needs to accommodate a foreign pipeline crossing. Please refer to the attached engineering drawing for additional details. The proposed route deviation includes:

- 10 foot offset west of the approved alignment, to include consistent and equal offsets to:
 - Construction right of way; and
 - Permanent right of way.
- Length of route modification:
 - 781 feet
 - Beginning at Station 899+67
 - Ending at Station 907+48

Route Analysis and Findings

The requested route modification and all associated workspace will occur entirely within the area previously surveyed for natural and cultural resources. These environmental survey limits coincide with the boundaries of the Certificate of Corridor Compatibility previously issued for the Project.

The requested route modification shall not result in new or additional impacts to natural or cultural resources and shall conform with the results and conclusions as previously reported.

Attachments:

Re-route Engineering Drawing

Figure M2 - route overview (previously filed with original application)

Re-route Overview – original alignment and survey corridor (previously filed as late exhibit)

Figure SC-4 – mapped natural resources within re-route area (previously filed with amended route)

Figure SC-CR-04 – mapped cultural resources within re-route area (previously filed with amended route)

2:18563 PLANS ALL INCHES - Station North C. Station MD/Steel Map From Client/Inchmap-04-27-12.dwg, 11/17/12, 6/21/2012 11:11:20 AM

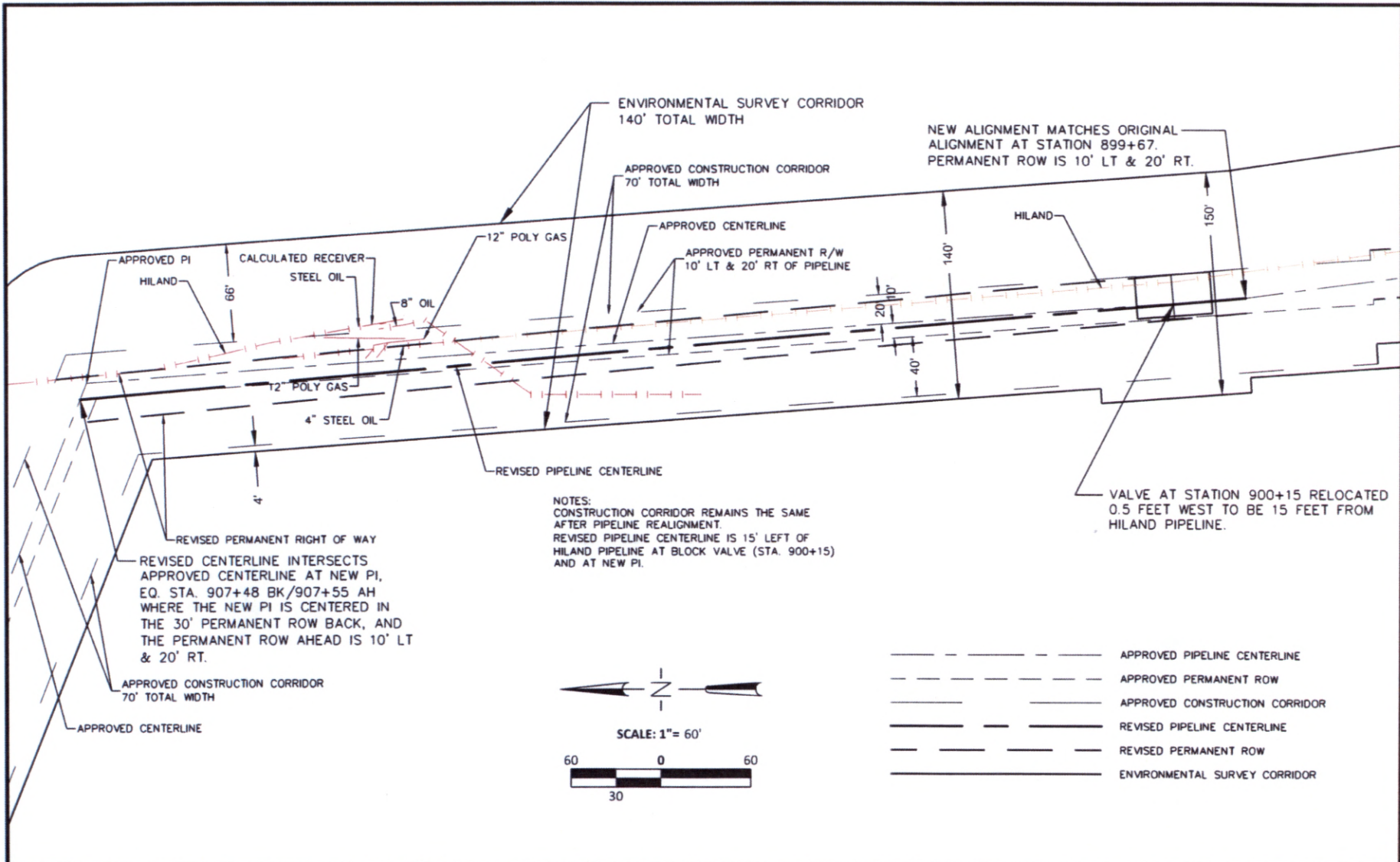

NOTES:
 CONSTRUCTION CORRIDOR REMAINS THE SAME AFTER PIPELINE REALIGNMENT.
 REVISED PIPELINE CENTERLINE IS 15' LEFT OF HILAND PIPELINE AT BLOCK VALVE (STA. 900+15) AND AT NEW PI.

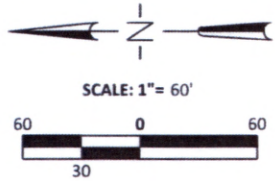

- APPROVED PIPELINE CENTERLINE
- APPROVED PERMANENT ROW
- APPROVED CONSTRUCTION CORRIDOR
- REVISED PIPELINE CENTERLINE
- REVISED PERMANENT ROW
- ENVIRONMENTAL SURVEY CORRIDOR

SCALE	HORZ 1"=100'	VERT	
DRN	BES	BK:	JOB NO. 16143
CHK	RSS	PAGE:	DATE: 6/8/12
REVISIONS			
6-14-12 SCALE CHANGE TO SHOW VALVE			
6-15-12 ADDL. NOTES FOR CLARIFICATION			
6-20-12 ADD ENVIRONMENTAL SURVEY AREA			

INBERG-MILLER ENGINEERS

	124 East Main Street Riverton, WY 82501 307-856-8136	1120 East C Street Casper, WY 82601 307-577-0606	250 Family Boulevard Cheyenne, WY 82007 307-635-6827	257 Alan Road Powell, WY 82435 307-784-7170	193 Flaming Gorge Way Green River, WY 82935 307-875-4384
--	--	--	--	---	--

PAALP

**BAKKEN NORTH
 WILLIAMS COUNTY ND**

SHEET **1** OF **1**

Any use, reuse, or CADU adaptation of this drawing other than for the specific purpose intended, by anyone, without written authorization from the engineer, will be at the Client's risk and full legal responsibility.



-  Valve
-  Bakken North Mainline (6-13-11)
-  Federal Lands
-  State Lands

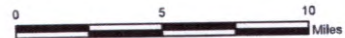

Figure M2
Plains All American Pipeline
Bakken North Project
Proposed Pipeline
Siting Criteria

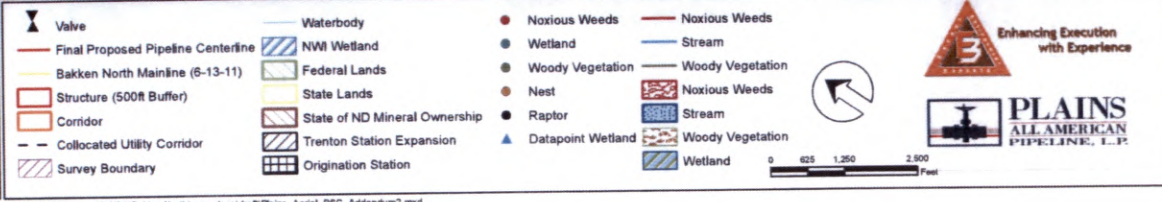
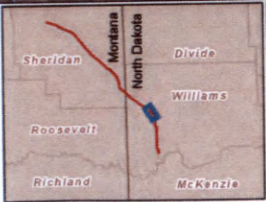

Figure SC-4
Plains All American Pipeline
Bakken North Project
Proposed Pipeline
Siting Criteria



<ul style="list-style-type: none"> Valve Final Proposed Pipeline Centerline Bakken North Mainline (6-13-11) Structure (500ft Buffer) Corridor 	<ul style="list-style-type: none"> Adjacent to existing/proposed corridor Survey Boundary Federal Lands State Lands State of ND Mineral Ownership Trenton Station Expansion Origination Station 	<ul style="list-style-type: none"> CR Site CR Site (Class I) CR Site (10/21/11) 	
---	---	---	------

Figure SC-CR-04
Plains All American Pipeline
Bakken North Project
Proposed Pipeline
Siting Criteria