

NORTHAMERICAN
COAL
CORPORATION
FALKIRK MINE

THE FALKIRK MINING COMPANY
2801 1st St. SW
P.O. Box 1087
Underwood, ND 58576-1087
(701) 442-5751 • Fax (701) 250-2473

RECEIVED
MAR - 7 2011
32493
NORTH DAKOTA
PUBLIC SERVICE COMMISSION

March 4, 2011

FROM DIRECTOR - RECLAMATION DIV.

Mr. James R. Deutsch
Reclamation Director
ND State Public Service Commission
600 East Boulevard, Dept. 408
Bismarck, ND 58505

Date: _____

Action: _____

Info. Only: _____

Info & File: _____

RE: Affidavit of Publication for Revision 21, Renewal #3, to Permit NAFK-9503

Dear Mr. Deutsch:

Please find enclosed copies of the Affidavit of Publication for Revision 21, Renewal #3, to Falkirk's Mining Permit NAFK-9503. The publication was published for four consecutive weeks on January 13th, 20th, 27th, and February 3rd, 2011 in The Bismarck Tribune, The Underwood News, The McLean County Independent and The Washburn Leader News.

If you have any questions or comments, please contact me at 250-2424.

Sincerely,

THE FALKIRK MINING COMPANY



Diana Edinger
Executive Assistant

DGE
Attachments



Classified Advertising Invoice

Bismarck Tribune
PO BOX 4001
LaCrosse, WI 54602-4001
In State 701-250-8218
Toll free 800-472-2273

THE FALKIRK MINING COMPANY
2801 1ST ST SW
PO BOX 1087
UNDERWOOD ND 58576

Customer: 60018525
Phone: (701) 250-2472
Date: 02/03/2011

CREDIT CARD PAYMENT (circle one)



Card #: _____
Exp Date: _____
Signature: _____
Credit card users: Fax to 701-223-6584

CashAmt

PLEASE DETACH AND RETURN TOP PORTION WITH YOUR PAYMENT

Table with columns: Date, Date, Times Run, Description, Lines, Class Code, Order Amt, Net Amt Due. Row 1: 01/13/11, 02/03/11, 4, Bismarck Tribune, 1.00, Legals, 9,888.00, 9,888.00

Affidavit of Publication

State of North Dakota) SS County of Burleigh
Before me, a Notary Public for the State of North Dakota
personally appeared CL who being duly sworn, deposes
and says that he (she) is the Clerk of Bismarck Tribune Co.,
and that the publication(s) were made through the
Bismarck Tribune on the following dates:
1/13, 20, 27, 2/3 Signed Calmer Gundz
sworn and subscribed to before me this 9th
day of February 2011

Notary Public in and for the State of North Dakota

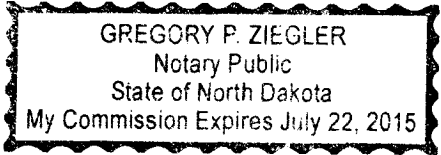

Please return invoice or put order number on check. Thank You.

Table with 2 columns: Remarks, Total Due: 9,888.00

Bismarck Tribune
www.bismarcktribune.com
PO BOX 4001
LaCrosse, WI 54602-4001

**NOTICE OF FILING A PERMIT RENEWAL AND REVISION
TO CONDUCT SURFACE COAL MINING OPERATIONS**

The Falkirk Mining Company, P.O. Box No. 1087, Underwood, North Dakota 58576-1087, as applicant, has filed renewal and revision applications for Surface Coal Mining Permit NAFK-9503, covering portions of Sections 7, 8, 18, 19, and 30, T145N, R82W and Sections 10, 11, 13, 14, 15, 21, 22, 23, 24, 25, 26, 27, 28, 33, 34, 35, and 36, T145N, R83W and Sections 4, 5, and 9, T144N, R83W in McLean County, North Dakota, which contains 12,386.4 acres. Renewal No. 3 to Permit NAFK-9503 will extend the permit term another five years until April 15, 2016. Revision No. 21 identifies the next five-year coal removal subarea and updates mining and reclamation plans and other information in the permit. The permit area is located southwest of Underwood, North Dakota. The map shows the location of the City of Underwood, North Dakota, and the boundaries of the permit area. The names of The United States Geological Survey Quadrangle Map, which contains the area described and shown on the map, is Washburn.

The owners of the surface and coal in the permit area are as follows:

TRACT 1

T145N-R82W-Section 7:
SURFACE OWNERSHIP:
COAL OWNERSHIP:

NE1/4, E1/2NW1/4
The Falkirk Mining Company
Laverna Scheid
The Nokota Company
Linda Louise Schmidt,
Trustee of the Linda L. Schmidt
2007 Revocable Trust
Arthur V. Seay, III
Sidney Ray Lawler

TRACT 2

T145N-R82W-Section 7:
SURFACE OWNERSHIP:
COAL OWNERSHIP:

E1/2SW1/4, SE1/4
The Falkirk Mining Company
LeRoy D. Traxel and Norma Traxel
The Nokota Company
Linda Louise Schmidt, Trustee of the Linda L. Schmidt
2007 Revocable Trust
Arthur V. Seay, III
Sidney Ray Lawler

TRACT 3

T145N-R82W-Section 8:
SURFACE OWNERSHIP:
COAL OWNERSHIP:

**A triangular tract lying within the N1/2NW1/4,
containing .4 acres, more or less**
Great River Energy
Great River Energy

TRACT 4

T145N-R82W-Section 18:
SURFACE OWNERSHIP:
COAL OWNERSHIP:

NE1/4
The Falkirk Mining Company
Laurance L. Heger and Nancy L. Heger
Red Crown Royalties, LLC
Three Forks Oil Corporation
The Nokota Company

TRACT 5

T145N-R82W-Section 18
SURFACE OWNERSHIP:
COAL OWNERSHIP:

E1/2 of Lot 1, Lot 2, E1/2NW1/4
The Falkirk Mining Company
Laurance L. Heger and Nancy L. Heger
Red Crown Royalties, LLC
Three Forks Oil Corporation
The Nokota Company

TRACT 6

T145N-R82W-Section 18:
SURFACE OWNERSHIP:
COAL OWNERSHIP:

W1/2 of Lot 1
The Falkirk Mining Company
Laurance L. Heger and Nancy L. Heger
Red Crown Royalties, LLC
Three Forks Oil Corporation
The Nokota Company

TRACT 7

T145N-R82W-Section 18:
SURFACE OWNERSHIP:
COAL OWNERSHIP:

Lots 3, 4, E1/2SW1/4
The Falkirk Mining Company
United States of America — Bureau of Land Management

TRACT 8

T145N-R82W-Section 19:
SURFACE OWNERSHIP:
COAL OWNERSHIP:

Lots 1; 2, E1/2NW1/4
The Falkirk Mining Company
John C. Samuelson
Loren F. Gradin

TRACT 9

T145N-R82W-Section 19:
SURFACE OWNERSHIP:
COAL OWNERSHIP:

Lots 3, 4, E1/2SW1/4
The Falkirk Mining Company
Janet Steckler
Lucille Gardella
Maurice Heger and Ione Heger
Loren F. Gradin

TRACT 10

T145N-R82W-Section 30:
SURFACE OWNERSHIP:
COAL OWNERSHIP:

Lots 1, 2, E1/2NW1/4
The Falkirk Mining Company
Marian Reinhardt
State of North Dakota — State Land Department

TRACT 11

T145N-R82W-Section 30:
SURFACE OWNERSHIP:

Lots 3, 4, E1/2SW1/4
Roger O. Peterson, Life Estate
Remaindermen:
- Neal Peterson
- Cheryl Gillespie
Roger O. Peterson, Life Estate
Remaindermen:
- Neal Peterson
- Cheryl Gillespie

COAL OWNERSHIP:

TRACT 12

T145N-R83W-Section 13:
SURFACE OWNERSHIP:
COAL OWNERSHIP:

SE1/4

The Falkirk Mining Company
Heger Land Trust Dated 4-30-08,
Deborah Siem, Laurance Heger, and Carl Heger,
Trustees
Richard Ernsdorf
August R. Johnson
Jean Neville, Life Estate
Remaindermen:
- Laurel A. Ross
- Linda J. Dillon
- Robert L. Neville

TRACT 13

T145N-R83W-Section 24:
SURFACE OWNERSHIP:
COAL OWNERSHIP:

NE1/4, less Outlot A

The Falkirk Mining Company
Barbara Lee Jones

TRACT 14

T145N-R83W-Section 24:

Outlot A of the NE1/4, described as follows:
Beginning at a point that is located 1484.0 feet
South of the northeast corner of Section 24,
thence West and parallel with the North section
line a distance of 1972.0 feet to a point, thence
North and parallel with the East section line a
distance of 492.0 feet, thence West and parallel
with the North section line a distance of 668.0 feet
to the quarter section line, thence South along the
quarter section line a distance of 918.0 feet,
thence East and parallel with the North section
line a distance of 668.0 feet, thence North and
parallel with the East section line a distance of
226.0 feet, thence East and parallel with the North
section line a distance of 1972.0 feet to the East
section line of Section 24, thence North along the
East section line a distance of 200 feet to the point
of beginning.
Containing 23.14 acres, more or less.

SURFACE OWNERSHIP:

COAL OWNERSHIP:

The Falkirk Mining Company
Randy Van Asperen
Barbara Lee Jones
Bruce Allen Gradin

TRACT 15

T145N-R83W-Section 24:
SURFACE OWNERSHIP:
COAL OWNERSHIP:

NW1/4

The Falkirk Mining Company
Michael Berg
Barbara Lee Jones
Bruce Allen Gradin

TRACT 16

T145N-R83W-Section 24:
SURFACE OWNERSHIP:
COAL OWNERSHIP:

SW1/4

The Falkirk Mining Company
Barbara Lee Jones
Bruce Allen Gradin

TRACT 17

T145N-R83W-Section 24:
SURFACE OWNERSHIP:
COAL OWNERSHIP:

SE1/4

The Falkirk Mining Company
Carol J. Reinhillier and Thomas R. Reinhillier
Joy M. Ochsner and Gary L. Ochsner
Judith K. Simpferderfer and Jerome D. Simpferderfer
Sylvia Thompson

TRACT 18

T145N-R83W-Section 25:
SURFACE OWNERSHIP:
COAL OWNERSHIP:

NE1/4

The Falkirk Mining Company
John C. Samuelson and Helen K. Samuelson
Shaun Stewart
Erica LeFevers
Chris Stewart
Brett Stewart
Sarah LeFevers

TRACT 19

T145N-R83W-Section 25:
SURFACE OWNERSHIP:
COAL OWNERSHIP:

NW1/4

The Falkirk Mining Company
Rita McCreary and Edward McCreary
William Frederick Lindell and Patricia Lindell

TRACT 20

T145N-R83W-Section 25:
SURFACE OWNERSHIP:
COAL OWNERSHIP:

SW1/4

The Falkirk Mining Company
Jeffrey G. Culver
Harry W. Samuelson, Jr., as Trustee of the
Harry W. Samuelson, Jr. Revocable Trust
Lois Samuelson, as Trustee of the
Lois Samuelson Revocable Trust

TRACT 21

T145N-R83W-Section 25:
SURFACE OWNERSHIP:
COAL OWNERSHIP:

SE1/4

The Falkirk Mining Company
John C. Samuelson and Helen K. Samuelson
Dorothy E. Samuelson

TRACT 22

T145N-R83W-Section 36:
SURFACE OWNERSHIP:
COAL OWNERSHIP:

NE1/4
The Falkirk Mining Company
State of North Dakota — State Land Department
Carol Adams
Sharon Huber
Donald Bender
Paul J. Bender
Brenda Dietrich
Marlin Bender
Martin Bender
LeRoy Bender
The Estate of Elmer Bender
Dean Bender
Rayland Bender
Trent Bender
Nanette Aragon
Hope Witte

TRACT 23

T145N-R83W-Section 36:
SURFACE OWNERSHIP:
COAL OWNERSHIP:

NW1/4
The Falkirk Mining Company
Carol J. Reinhiller and Thomas R. Reinhiller
Joy M. Ochsner and Gary L. Ochsner
Judith K. Simpenderfer and Jerome D. Simpenderfer
Sylvia Thompson
State of North Dakota — State Land Department

TRACT 24

T145N-R83W-Section 13:
SURFACE OWNERSHIP:
COAL OWNERSHIP:

SW1/4
The Falkirk Mining Company
AgriBank, FCB
Adele C. Saylor
Mydred Swanson
Myrtle Breeding
Stanley E. Saylor, Sr.
Norma J. Schacher
Linda G. Hoerner
Elizabeth Reiland

TRACT 25

T145N-R83W-Section 11:
SURFACE OWNERSHIP:
COAL OWNERSHIP:

SW1/4
The Falkirk Mining Company
Arnold J. Schafer and Gretchen M. Schafer, Life Estate
Remaindermen:
- Mary Schafer Conlon
- Macy J. Schafer
- Marty J. Schafer
- Monty R. Schafer
- AgriBank, FCB

TRACT 26

T145N-R83W-Section 11:
SURFACE OWNERSHIP:
COAL OWNERSHIP:

SE1/4
The Falkirk Mining Company
Adele Saylor
Myrtle Breeding
Elizabeth Reiland
Stanley E. Saylor, Sr.
Norma J. Schacher
Linda G. Hoerner

TRACT 27

T145N-R83W-Section 13:
SURFACE OWNERSHIP:
COAL OWNERSHIP:

NE1/4
The Falkirk Mining Company
Heger Land Trust Dated 4-30-08,
Deborah Siem, Laurance Heger, and Carl Heger,
Trustees
State of North Dakota — State Land Department
The Nokota Company
Three Forks Oil Corporation
Red Crown Royalties, LLC

TRACT 28

T145N-R83W-Section 13:
SURFACE OWNERSHIP:
COAL OWNERSHIP:

NW1/4
The Falkirk Mining Company
The Ervin R. Schafer Revocable Trust Dated 10-10-89
W. L. Braun Oil Properties Revocable Trust Dated
10-22-98
Laverna McKelvy
The Estate of Donald D. Schafer
The Falkirk Mining Company

TRACT 29

T145N-R83W-Section 14:
SURFACE OWNERSHIP:
COAL OWNERSHIP:

NE1/4
The Falkirk Mining Company
The Ervin R. Schafer Revocable Trust Dated 10-10-89

TRACT 30

T145N-R83W-Section 14:
SURFACE OWNERSHIP:
COAL OWNERSHIP:

NW1/4
The Falkirk Mining Company
The Adeine L. Schafer Revocable Trust Dated 10-10-89

TRACT 31

T145N-R83W-Section 14:
SURFACE OWNERSHIP:
COAL OWNERSHIP:

SW1/4
The Falkirk Mining Company
Richard Ernsdorf
The Nokota Company
Three Forks Oil Corporation
The Falkirk Mining Company

TRACT 32

T145N-R83W-Section 14:
SURFACE OWNERSHIP:
COAL OWNERSHIP:

SE1/4
The Falkirk Mining Company
August R. Johnson
The Nokota Company
Three Forks Oil Corporation
The Falkirk Mining Company

TRACT 33

T145N-R83W-Section 23:
SURFACE OWNERSHIP:
COAL OWNERSHIP:

E1/2
The Falkirk Mining Company
Rita McCreary and Edward McCreary
William Frederick Lindell and Patricia Lindell

TRACT 34

T145N-R83W-Section 23:
SURFACE OWNERSHIP:
COAL OWNERSHIP:

NW1/4
The Falkirk Mining Company
Jerry Ollenburger
Arlene Schubarth
Jane Ollenburger
Monte Ollenburger

TRACT 35

T145N-R83W-Section 23:
SURFACE OWNERSHIP:
COAL OWNERSHIP:

SW1/4
The Falkirk Mining Company
Barbara J. Hoffer
Eileen C. Zander

TRACT 36

T145N-R83W-Section 26:
SURFACE OWNERSHIP:
COAL OWNERSHIP:

NE1/4
William Frederick Lindell and Patricia Lindell
William Frederick Lindell and Patricia Lindell
Rita McCreary and Edward McCreary

TRACT 37

T145N-R83W-Section 26:
SURFACE OWNERSHIP:
COAL OWNERSHIP:

NW1/4
The Falkirk Mining Company
William Frederick Lindell and Patricia Lindell
Rita McCreary and Edward McCreary

TRACT 38

T145N-R83W-Section 26:
SURFACE OWNERSHIP:
COAL OWNERSHIP:

SW1/4
The Falkirk Mining Company
Anne Carlsen Center for Children
Home on the Range
Dakota Boys Ranch of Minot
Trinity Lutheran Church Foundation
Birka Country Church
First Lutheran Church
Melvin A. Christenson Revocable Trust
Darlene Roach

TRACT 39

T145N-R83W-Section 26:
SURFACE OWNERSHIP:
COAL OWNERSHIP:

SE1/4
The Falkirk Mining Company
William Frederick Lindell and Patricia Lindell
Rita McCreary and Edward McCreary

TRACT 40

T145N-R83W-Section 35:
SURFACE OWNERSHIP:
COAL OWNERSHIP:

NE1/4
The Falkirk Mining Company
The Falkirk Mining Company

TRACT 41

T145N-R83W-Section 35:
SURFACE OWNERSHIP:
COAL OWNERSHIP:

W1/2NW1/4
The Falkirk Mining Company
Anne Carlsen Center for Children
Home on the Range
Dakota Boys Ranch of Minot
Trinity Lutheran Church Foundation
Birka Country Church
First Lutheran Church
Melvin A. Christenson Revocable Trust
Darlene Roach

TRACT 42

T145N-R83W-Section 35:
SURFACE OWNERSHIP:
COAL OWNERSHIP:

E1/2NW1/4
The Falkirk Mining Company
Estate of George W. Swanson

TRACT 43

T144N-R83W-Section 4:
SURFACE OWNERSHIP:
COAL OWNERSHIP:

Lots 1, 2, 3, 4, less the south 40 rods of Lots 1 and 2
The Falkirk Mining Company
Ernest E. Slagg, Life Estate
Remaindermen:
- George L. Swanson and Val Rae Swanson
Adeline M. Slagg
Elda Ann Baisch
Marlys Slagg
Kevin Slagg
Wayne Slagg
Julie Slagg
Steven W. Slagg
Miles J. Slagg
Marsha F. Slagg
Carolynne Currier
Jerald Slagg
Connie Jo Hill
Val Rae Swanson

TRACT 44

T144N-R83W-Section 4:
SURFACE OWNERSHIP:
COAL OWNERSHIP:

The south 40 rods of Lots 1 and 2
The Falkirk Mining Company
State of North Dakota — State Land Department
Adeline M. Slagg
Elda Ann Baisch
Marlys Slagg
Kevin Slagg
Wayne Slagg
Julie Slagg
Steven W. Slagg
Miles J. Slagg
Marsha F. Slagg
Carolynne Currier
Jerald Slagg
Connie Jo Hill
Val Rae Swanson

TRACT 45

T144N-R83W-Section 4:
SURFACE OWNERSHIP:
COAL OWNERSHIP:

SW1/4

The Falkirk Mining Company
 Gertrude E. Burck
 Cleo Kersey
 Kitty Tweeten

TRACT 46

T144N-R83W-Section 4:

SE1/4

SURFACE OWNERSHIP:
COAL OWNERSHIP:

The Falkirk Mining Company
 State of North Dakota — State Land Department
 Elda Ann Baisch
 Carolynne S. Currier and Arch N. Currier
 Steven W. Slagg
 Miles J. Slagg
 Marsha F. Slagg
 Val Rae Swanson
 Jerald A. Slagg
 Connie Jo Hill
 Adeline M. Slagg
 Marlys Slagg
 Kevin Slagg
 Wayne Slagg
 Julie Slagg

TRACT 47

T144N-R83W-Section 5:
SURFACE OWNERSHIP:
COAL OWNERSHIP:

Lots 3 and 4
 Milton L. Holz Nagel Revocable Trust Dated 1-9-95
 Milton L. Holz Nagel Revocable Trust Dated 1-9-95

TRACT 48

T144N-R83W-Section 5:
SURFACE OWNERSHIP:

Lots 1 and 2
 Roger Peterson, Life Estate
 Remaindermen:
 - Neal Peterson
 - Cheryl Gillespie
 Roger Peterson, Life Estate
 Remaindermen:
 - Neal Peterson
 - Cheryl Gillespie

COAL OWNERSHIP:

TRACT 49

T144N-R83W-Section 5:
SURFACE OWNERSHIP:
COAL OWNERSHIP:

SW1/4, less an 8 ac. tract in the SE1/4SW1/4
 Milton L. Holz Nagel Revocable Trust Dated 1-9-95
 Milton L. Holz Nagel Revocable Trust Dated 1-9-95

TRACT 50

T144N-R83W-Section 5:
SURFACE OWNERSHIP:
COAL OWNERSHIP:

an 8 ac. tract in the SE1/4SW1/4
 The Falkirk Mining Company
 The Falkirk Mining Company

TRACT 51

T144N-R83W-Section 5:
SURFACE OWNERSHIP:

SE1/4
 Roger Peterson, Life Estate
 Remaindermen:
 - Neal Peterson
 - Cheryl Gillespie
 Roger Peterson, Life Estate
 Remaindermen:
 - Neal Peterson
 - Cheryl Gillespie

COAL OWNERSHIP:

TRACT 52

T144N-R83W-Section 9:
SURFACE OWNERSHIP:
COAL OWNERSHIP:

NW1/4
 The Falkirk Mining Company
 Marlys D. Allen and Lisa E. Allen
 April Azar
 Jana J. Azar
 WLK Resources, LLC
 Fred S. Wright, Jr.
 Nancy Elizabeth Brooks
 Mary Evelyn King
 Dana Denise Wright
 Major David L. Wright
 Thomas Russell Wright, Jr.
 Fred S. Wright, Jr., Trustee of the Fred S. Wright, Jr. Trust
 Plains Exploration & Production Company
 Henry Lerman
 Irving Lerner
 Linda Petroleum Co.
 Williston Projects, Inc.
 Cotton 4 Mineral Trust
 Cotton 6 Mineral Trust
 George E. Moss, Jr.
 John K. Moss
 Myra Ellen Moss
 Roscoe Moss, III
 Frank Jeppi Bi-Pass Trust
 J & L Hauptman Family Partnership
 Phillip Mandel
 Louis Dorfman
 Myron H. Dorfman
 Singer Bros.
 S&P Co., A Louisiana Partnership
 Fleischaker Mineral Company, LLC
 Teton Properties, LLC
 S D Resources, Ltd.
 A.G.S. Limited Partnership
 Eculirra Oil & Gas, LLC

TRACT 53

T144N-R83W-Section 9:
SURFACE OWNERSHIP:
COAL OWNERSHIP:

NE1/4

The Falkirk Mining Company
 State of North Dakota — State Land Department
 April Azar
 Jana J. Azar
 WLK Resources, LLC
 Fred S. Wright, Jr.
 Nancy Elizabeth Brooks
 Mary Evelyn King
 Dana Denise Wright
 Major David L. Wright
 Thomas Russell Wright, Jr.
 Fred S. Wright, Jr., Trustee of the Fred S. Wright, Jr. Trust
 Plains Exploration & Production Company
 Henry Lerman
 Irving Lerner
 Linda Petroleum Co.
 Williston Projects, Inc.
 Cotton 4 Mineral Trust
 Cotton 6 Mineral Trust
 George E. Moss, Jr.
 John K. Moss
 Myra Ellen Moss
 Roscoe Moss, III
 Frank Jeppi Bi-Pass Trust
 J & L Hauptman Family Partnership
 Phillip Mandel
 Louis Dorfman
 Myron H. Dorfman
 Singer Bros.
 S&P Co., A Louisiana Partnership
 Fleischaker Mineral Company, LLC
 Teton Properties, LLC
 S D Resources, Ltd.
 A.G.S. Limited Partnership
 Eculirra Oil & Gas, LLC

TRACT 54

T145N-R83W-Section 10:
SURFACE OWNERSHIP:
COAL OWNERSHIP:

SW1/4

The Falkirk Mining Company
 Pennington Living Trust Dated 4-28-99

TRACT 55

T145N-R83W-Section 10:
SURFACE OWNERSHIP:
COAL OWNERSHIP:

SE1/4, less 2.55 ac. hwy.
 The Falkirk Mining Company
 MDR Landenberger Family Trust Dated 10-19-02

TRACT 56

T145N-R83W-Section 15:
SURFACE OWNERSHIP:
COAL OWNERSHIP:

NW1/4

The Falkirk Mining Company
 Barbara J. Hoffer
 Eileen C. Zander
 State of North Dakota — State Land Department

TRACT 57

T145N-R83W-Section 15:
SURFACE OWNERSHIP:
COAL OWNERSHIP:

NE1/4, less tracts of 7.21 ac. and 5.75 ac.
 The Falkirk Mining Company
 Estate of George W. Swanson
 State of North Dakota — State Land Department

TRACT 58

T145N-R83W-Section 15:
SURFACE OWNERSHIP:
COAL OWNERSHIP:

5.75 ac. in the NE1/4
 The Falkirk Mining Company
 The Falkirk Mining Company
 State of North Dakota — State Land Department

TRACT 59

T145N-R83W-Section 15:
SURFACE OWNERSHIP:
COAL OWNERSHIP:

7.21 ac. in the NE1/4
 The Falkirk Mining Company
 George L. Swanson and Val Rae Swanson
 State of North Dakota — State Land Department

TRACT 60

T145N-R83W-Section 15:
SURFACE OWNERSHIP:
COAL OWNERSHIP:

SW1/4
 The Falkirk Mining Company
 MDR Landenberger Family Trust Dated 10-19-02
 The Reserve Petroleum Company

TRACT 61

T145N-R83W-Section 15:
SURFACE OWNERSHIP:
COAL OWNERSHIP:

SE1/4
 The Falkirk Mining Company
 The Reserve Petroleum Company
 State of North Dakota — State Land Department

TRACT 62

T145N-R83W-Section 21:
SURFACE OWNERSHIP:
COAL OWNERSHIP:

SE1/4
 The Falkirk Mining Company
 The Falkirk Mining Company

TRACT 63

T145N-R83W-Section 22:
SURFACE OWNERSHIP:
COAL OWNERSHIP:

NW1/4
 The Falkirk Mining Company
 Estate of George W. Swanson
 Estates of Carl H. Reimers and Margaret A. Reimers
 Darlene Ostboe
 Michael Ranum
 Mark Ranum
 Andrew Ranum
 Norm Ostboe and Darlene A. Ostboe
 Donna L. Bloomquist
 Gerald T. Woolworth
 Patricia A. Reimers
 Mary O. Reimers
 Charlotte L. Potter
 Gary B. Reimers
 Ronald J. Stroh and Arlyce J. Stroh
 Karen Louise Sorensen

TRACT 64

T145N-R83W-Section 22:
SURFACE OWNERSHIP:
COAL OWNERSHIP:

NE1/4

The Falkirk Mining Company
Milton Saylor and Kathy Saylor
Marcia Walker, Life Estate
Remaindermen:

- John B. Walker
- Samuel C. Walker

TRACT 65

T145N-R83W-Section 22:
SURFACE OWNERSHIP:
COAL OWNERSHIP:

SW1/4, less 5 ac. in the SW corner and less the
SE1/4SE1/4SW1/4
The Falkirk Mining Company
Erma Carlson
Marva Deane Finck
Karen Carlson

TRACT 66

T145N-R83W-Section 22:
SURFACE OWNERSHIP:
COAL OWNERSHIP:

SE1/4SE1/4SW1/4, less 3.75 ac.
The Falkirk Mining Company
Erma Carlson
Marva Deane Finck
Karen Carlson

TRACT 66A

T145N-R83W-Section 22:
SURFACE OWNERSHIP:
COAL OWNERSHIP:

3.75 ac. in the SE1/4SE1/4SW1/4
The Falkirk Mining Company
The Falkirk Mining Company

TRACT 67

T145N-R83W-Section 22:
SURFACE OWNERSHIP:
COAL OWNERSHIP:

SE1/4, less the SW1/4SW1/4SE1/4
The Falkirk Mining Company
Estate of George W. Swanson

TRACT 68

T145N-R83W-Section 22:
SURFACE OWNERSHIP:
COAL OWNERSHIP:

SW1/4SW1/4SE1/4
The Falkirk Mining Company
Estate of George W. Swanson

TRACT 69

T145N-R83W-Section 28:
SURFACE OWNERSHIP:
COAL OWNERSHIP:

N1/2NW1/4, W1/2NE1/4
The Falkirk Mining Company
Erma Carlson
Marva D. Finck
Karen J. Carlson

TRACT 70

T145N-R83W-Section 28:
SURFACE OWNERSHIP:
COAL OWNERSHIP:

E1/2NE1/4
Marva Deane Finck
Marva Deane Finck

TRACT 71

T145N-R83W-Section 28:
SURFACE OWNERSHIP:
COAL OWNERSHIP:

SW1/4, S1/2NW1/4
Eileen C. Zander
Eileen C. Zander

TRACT 72

T145N-R83W-Section 28:
SURFACE OWNERSHIP:
COAL OWNERSHIP:

SE1/4
Dwight D. Gradin and Denise Gradin
Dwight D. Gradin and Denise Gradin
Miles W. Gradin
Wallyn K. Lee
Mark E. Gradin
Kyle E. Gradin
The Irene V. Johannes Revocable Living Trust. Dated
5-15-96

TRACT 73

T145N-R83W-Section 27:
SURFACE OWNERSHIP:
COAL OWNERSHIP:

NW1/4
The Falkirk Mining Company
Erma Carlson
Estates of Carl H. Reimers and Margaret A. Reimers
Darlene Ostboe
Michael Ranum
Mark Ranum
Andrew Ranum
Norm Ostboe and Darlene A. Ostboe
Donna L. Bloomquist
Gerald T. Woolworth
Patricia A. Reimers
Mary O. Reimers
Charlotte L. Potter
Gary B. Reimers
Ronald J. Stroh and Arlyce J. Stroh
Karen Louise Sorensen

TRACT 74

T145N-R83W-Section 27:
SURFACE OWNERSHIP:
COAL OWNERSHIP:

NE1/4
The Falkirk Mining Company
Erma Carlson

TRACT 75

T145N-R83W-Section 27:
SURFACE OWNERSHIP:
COAL OWNERSHIP:

SW1/4
The Falkirk Mining Company
Janice E. Hanson
Bonnie J. Kuntz

TRACT 76

T145N-R83W-Section 27:
SURFACE OWNERSHIP:
COAL OWNERSHIP:

SE1/4
The Falkirk Mining Company
Janice E. Hanson
Bonnie J. Kuntz

TRACT 77

T145N-R83W-Section 33:
SURFACE OWNERSHIP:
COAL OWNERSHIP:

NW1/4

Dwight D. Gradin and Denise Gradin
Dwight D. Gradin and Denise Gradin
Miles W. Gradin
Wallyn K. Lee
Mark E. Gradin
Kyle E. Gradin
The Irene V. Johannes Revocable Living Trust Dated
5-15-96

TRACT 78

T145N-R83W-Section 33:
SURFACE OWNERSHIP:
COAL OWNERSHIP:

NE1/4

Dwight D. Gradin and Denise Gradin
Dwight D. Gradin and Denise Gradin
Miles W. Gradin
Wallyn K. Lee
Mark E. Gradin
Kyle E. Gradin
The Irene V. Johannes Revocable Living Trust Dated
5-15-96

TRACT 79

T145N-R83W-Section 34:
SURFACE OWNERSHIP:
COAL OWNERSHIP:

NW1/4

Sharyn M. Calton
Sharyn M. Calton

TRACT 80

T145N-R83W-Section 34:
SURFACE OWNERSHIP:
COAL OWNERSHIP:

North 100 ac. of the NE1/4

The Falkirk Mining Company
Anne Carlsen Center for Children
Home on the Range
Dakota Boys Ranch of Minot
Trinity Lutheran Church Foundation
Birka Country Church
First Lutheran Church
Melvin A. Christenson Revocable Trust
Darlene Roach

TRACT 81

T145N-R83W-Section 34:
SURFACE OWNERSHIP:
COAL OWNERSHIP:

South 60 ac. of the NE1/4

The Falkirk Mining Company
Anne Carlsen Center for Children
Home on the Range
Dakota Boys Ranch of Minot
Trinity Lutheran Church Foundation
Birka Country Church
First Lutheran Church
Melvin A. Christenson Revocable Trust
Darlene Roach

TRACT 82

T145N-R83W-Section 34:
SURFACE OWNERSHIP:

SW1/4

Mildred Leidholm, as Trustee of the Lloyd Leidholm
Testamentary Trust
Roy B. Leidholm and Eva Leidholm, Life Estate
Remaindermen:

- Brian Leidholm
- Cordell Leidholm
- Glynda Janz
- Karen Perkerewicz
- Dean Leidholm
- Tammy Novak
- Sharon Rivers
- Dwayne Leidholm

Mildred Jahner and Valentine Jahner, Life Estate
Remaindermen:

- Curtis Jahner
- Brent Jahner

COAL OWNERSHIP:

Mildred Leidholm, as Trustee of the Lloyd Leidholm
Testamentary Trust

Roy B. Leidholm and Eva Leidholm, Life Estate

Remaindermen:

- Brian Leidholm
- Cordell Leidholm
- Glynda Janz
- Karen Perkerewicz
- Dean Leidholm
- Tammy Novak
- Sharon Rivers
- Dwayne Leidholm

Mildred Jahner and Valentine Jahner, Life Estate
Remaindermen:

- Curtis Jahner
- Brent Jahner

TRACT 83

T145N-R83W-Section 34:
SURFACE OWNERSHIP:
COAL OWNERSHIP:

SE1/4

The Falkirk Mining Company
Hazel Peterson, Life Estate
Remaindermen:

- James Peterson
- Dennis L. Peterson
- Duaine J. Peterson
- Jane Schulz
- Susan Krebsbach

State of North Dakota - State Land Department

TRACT 84

T145N-R83W-Section 35:
SURFACE OWNERSHIP:
COAL OWNERSHIP:

SW1/4

Thomas W. Lindell and David A. Lindell
William F. Lindell and Patricia Lindell
Robert L. Erickson and Susan F. Lawrence

TRACT 85

T145N-R83W-Section 35:
SURFACE OWNERSHIP:
COAL OWNERSHIP:

SE1/4
The Falkirk Mining Company
Barbara J. Hoffer
Eileen C. Zander
Alma Nelson
Arvin Swanson
Marcia Steinwand

Rodney Swanson
Sheryl Willits

TRACT 86

T145N-R83W-Section 36:
SURFACE OWNERSHIP:
COAL OWNERSHIP:

SW1/4
The Falkirk Mining Company
Hazel Peterson, Life Estate
Remaindermen:
- James Peterson
- Dennis L. Peterson
- Duaine J. Peterson
- Jane Schulz
- Susan Krebsbach
State of North Dakota -- State Land Department

TRACT 87

T145N-R83W-Section 36:
SURFACE OWNERSHIP:
COAL OWNERSHIP:

SE1/4
The Falkirk Mining Company
State of North Dakota -- State Land Department
Duaine J. Peterson and Deana R. Peterson
Hazel Peterson, Life Estate
Remaindermen:
- Duaine J. Peterson and Deana R. Peterson

Copies of the revision and renewal applications for surface coal mining Permit NAFK-9503 are available for public inspection at the offices of the North Dakota Public Service Commission, Capitol Building, Bismarck, North Dakota, and at the offices of the County Auditor, McLean County Courthouse, Washburn, North Dakota. Written comments, objections, or requests for informal conferences on the application may be submitted by any person with an interest which is or may be adversely affected to the North Dakota Public Service Commission, Capitol Building, Bismarck, North Dakota, within 30 days after the last publication of this notice.

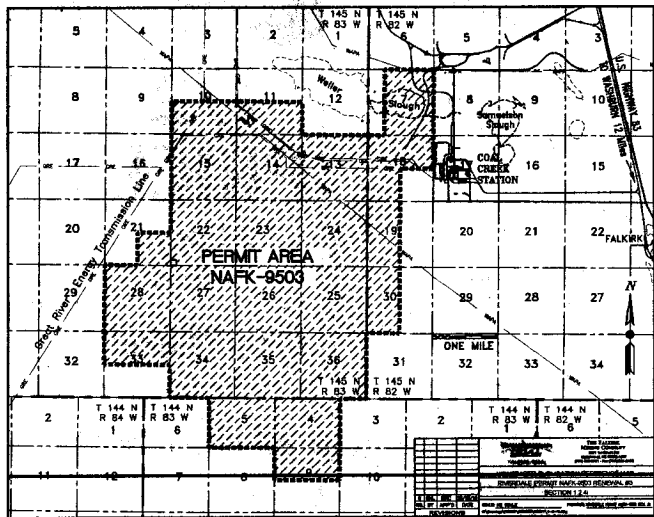

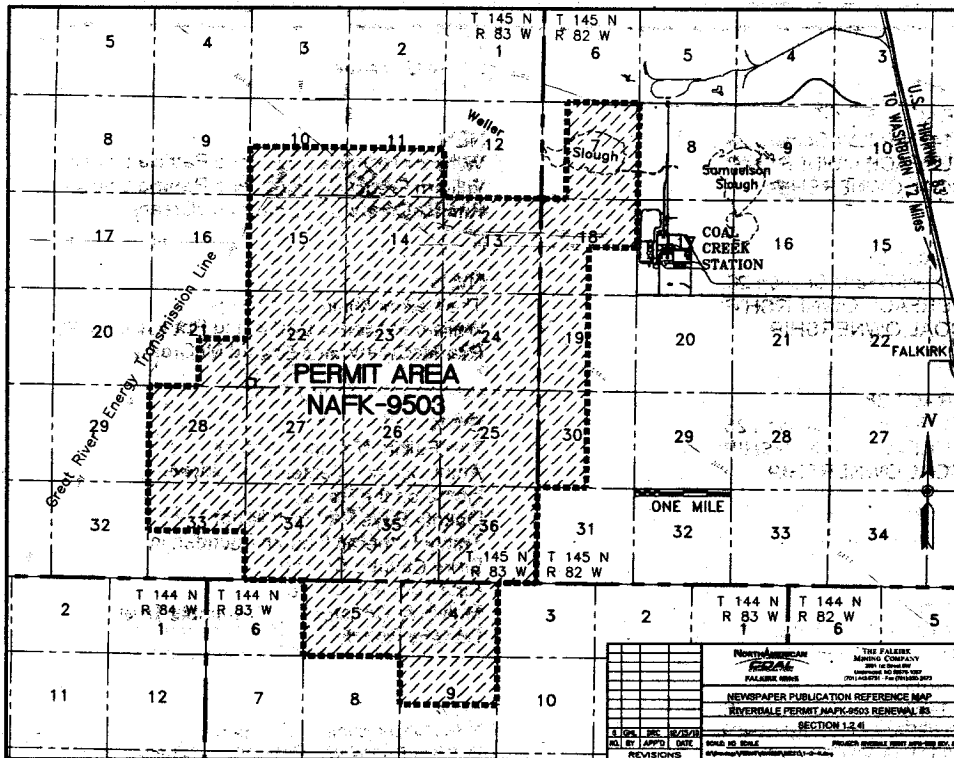

Notice of filing a permit renewal and revision to conduct surface coal mining operations

The Falkirk Mining Company, P.O. Box No. 1087, Underwood, North Dakota 58576-1087, as applicant, has filed renewal and revision applications for Surface Coal Mining Permit NAFK-9503, covering portions of Sections 7, 8, 18, 19, and 30, T145N, R82W and Sections 10, 11, 13, 14, 15, 21, 22, 23, 24, 25, 26, 27, 28, 33, 34, 35, and 36, T145N, R83W and Sections 4, 5, and 9, T144N, R83W in McLean County, North Dakota, which contains 12,386.4 acres. Renewal No. 3 to Permit NAFK-9503 will extend the permit term another five years until April 15, 2016. Revision No. 21 identifies the next five-year coal removal subarea and updates mining and reclamation plans and other information in the permit.

The permit area is located southwest of Underwood, North Dakota. The map shows the location of the City of Underwood, North Dakota, and the boundaries of the permit area. The names of The United States Geological Survey Quadrangle Map, which contains the area described and shown on the map, is "Washburn".

The owners of the surface and coal in the permit area are as follows:

TRACT 1

T145N-R82W- Section 7:
SURFACE OWNERSHIP:
COAL OWNERSHIP:

NE $\frac{1}{4}$, E $\frac{1}{2}$ NW $\frac{1}{4}$
The Falkirk Mining Company
Laverna Scheid
The Nokota Company
Linda Louise Schmidt,
Trustee of the Linda L. Schmidt
2007 Revocable Trust
Arthur V. Seay, III
Sidney Ray Lawler

TRACT 2

T145N-R82W-Section 7:
SURFACE OWNERSHIP:
COAL OWNERSHIP:

E $\frac{1}{2}$ SW $\frac{1}{4}$, SE $\frac{1}{4}$
The Falkirk Mining Company
LeRoy D. Traxel and Norma Traxel
The Nokota Company
Linda Louise Schmidt, Trustee of the Linda L. Schmidt
2007 Revocable Trust
Arthur V. Seay, III
Sidney Ray Lawler

TRACT 3

T145N-R82W-Section 8:
SURFACE OWNERSHIP:
COAL OWNERSHIP:

A trangular tract lying within the N $\frac{1}{2}$ NW $\frac{1}{4}$,
containing .4 acres, more or less
Great River Energy
Great River Energy

TRACT 4

T145N-R82W-Section 18:

SURFACE OWNERSHIP:

COAL OWNERSHIP:

NE $\frac{1}{4}$

The Falkirk Mining Company

Laurance L. Heger and Nancy L. Heger

Red Crown Royalties, LLC

Three Forks Oil Corporation

The Nokota Company

TRACT 5

T145N-R82W-Section 18

SURFACE OWNERSHIP:

COAL OWNERSHIP:

E $\frac{1}{2}$ of Lot 1, Lot 2, E $\frac{1}{2}$ NW $\frac{1}{4}$

The Falkirk Mining Company

Laurance L. Heger and Nancy L. Heger

Red Crown Royalties, LLC

Three Forks Oil Corporation

The Nokota Company

TRACT 6

T145N-R82W-Section 18:

SURFACE OWNERSHIP:

COAL OWNERSHIP:

W $\frac{1}{2}$ of Lot 1

The Falkirk Mining Company

Laurance L. Heger and Nancy L. Heger

Red Crown Royalties, LLC

Three Forks Oil Corporation

The Nokota Company

TRACT 7

T145N-R82W-Section 18:

SURFACE OWNERSHIP:

COAL OWNERSHIP:

Lots 3, 4, E $\frac{1}{2}$ SW $\frac{1}{4}$

The Falkirk Mining Company

United States of America –

Bureau of Land Management

TRACT 8

T145N-R82W-Section 19:

SURFACE OWNERSHIP:

COAL OWNERSHIP:

Lots 1, 2, E $\frac{1}{2}$ NW $\frac{1}{4}$

The Falkirk Mining Company

John C. Samuelson

Loren F. Gradin

TRACT 9

T145N-R82W-Section 19:

SURFACE OWNERSHIP:

COAL OWNERSHIP:

Lots 3, 4, E $\frac{1}{2}$ SW $\frac{1}{4}$

The Falkirk Mining Company

Janet Steckler

Lucille Gardella

Maurice Heger and Ione Heger

Loren F. Gradin

TRACT 10

T145N-R82W-Section 30:

SURFACE OWNERSHIP:

COAL OWNERSHIP:

Lots 1, 2, E $\frac{1}{2}$ NW $\frac{1}{4}$

The Falkirk Mining Company

Marian Reinhardt

State of North Dakota – State Land Department

TRACT 11

T145N-R82W-Section 30:

SURFACE OWNERSHIP:

COAL OWNERSHIP:

Lots 3, 4, E $\frac{1}{2}$ SW $\frac{1}{4}$

Roger O. Peterson, Life Estate

Remaindermen:

-Neal Peterson

-Cheryl Gillespie

Roger O. Peterson, Life Estate

Remaindermen:

-Neal Peterson

-Cheryl Gillespie

TRACT 12

T145N-R83W-Section 13:

SURFACE OWNERSHIP:

COAL OWNERSHIP:

SE $\frac{1}{4}$

The Falkirk Mining Company

Heger Land Trust Dated 4-30-08,

Deborah Siem, Laurance Heger, and Carl Heger,

Trustees

Richard Ermsdorf

August R. Johnson

Jean Neville, Life Estate

Remaindermen:

-Laurel A. Ross

-Linda J. Dillon

-Robert L. Neville

TRACT 13

T145N-R83W-Section 24:

SURFACE OWNERSHIP:

COAL OWNERSHIP:

NE $\frac{1}{4}$, less Outlot A

The Falkirk Mining Company

Barbara Lee Jones

TRACT 14

T145N-R83W-Section 24:

Outlot A of the NE¼, described as follows:

Beginning at a point that is located 1484.0 feet South of the northeast corner of Section 24, thence West and parallel with the North section line a distance of 1972.0 feet to a point, thence North and parallel with the East section line a distance of 492.0 feet, thence West and parallel with the North section line a distance of 668.0 feet to the quarter section line, thence South along the quarter section line a distance of 918.0 feet, thence East and parallel with the North section line a distance of 668.0 feet, thence North and parallel with the East section line a distance of 226.0 feet, thence East and parallel with the North section line a distance of 1972.0 feet to the East section line of Section 24, thence North along the East section line a distance of 200 feet to the point of beginning. Containing 23.14 acres, more or less.

SURFACE OWNERSHIP:

The Falkirk Mining Company

COAL OWNERSHIP:

Randy Van Asperen
Barbara Lee Jones
Bruce Allen Gradin

TRACT 15

T145N-R83W-Section 24:

NW¼

SURFACE OWNERSHIP:

The Falkirk Mining Company

COAL OWNERSHIP:

Michael Berg
Barbara Lee Jones
Bruce Allen Gradin

TRACT 16

T145N-R83W-Section 24:

SW¼

SURFACE OWNERSHIP:

The Falkirk Mining Company

COAL OWNERSHIP:

Barbara Lee Jones
Bruce Allen Gradin

TRACT 17

T145N-R83W-Section 24:

SE¼

SURFACE OWNERSHIP:

The Falkirk Mining Company

COAL OWNERSHIP:

Carol J. Reinhiller and Thomas R. Reinhiller
Joy M. Ochsner and Gary L. Ochsner
Judith K. Simpfenderfer and
Jerome D. Simpfenderfer
Sylvia Thompson

TRACT 18

T145N-R83W-Section 25:

NE¼

SURFACE OWNERSHIP:

The Falkirk Mining Company

COAL OWNERSHIP:

John C. Samuelson and Helen K. Samuelson
Shaun Stewart
Erica LeFevers
Chris Stewart
Brett Stewart
Sarah LeFevers

TRACT 19

T145N-R83W-Section 25:

NW¼

SURFACE OWNERSHIP:

The Falkirk Mining Company

COAL OWNERSHIP:

Rita McCreary and Edward McCreary
William Frederick Lindell and Patricia Lindell

TRACT 20

T145N-R83W-Section 25:

SW¼

SURFACE OWNERSHIP:

The Falkirk Mining Company

COAL OWNERSHIP:

Jeffrey G. Culver
Harry W. Samuelson, Jr., as Trustee of the
Harry W. Samuelson, Jr. Revocable Trust
Lois Samuelson, as Trustee of the
Lois Samuelson Revocable Trust

TRACT 21

T145N-R83W-Section 25:

SE¼

SURFACE OWNERSHIP:

The Falkirk Mining Company

COAL OWNERSHIP:

John C. Samuelson and Helen K. Samuelson
Dorothy E. Samuelson

TRACT 22
T145N-R83W-Section 36:
SURFACE OWNERSHIP:
COAL OWNERSHIP:

NE¼
The Falkirk Mining Company
State of North Dakota – State Land Department
Carol Adams
Sharon Huber
Donald Bender
Paul J. Bender
Brenda Dietrich
Marlin Bender
Merlin Bender
LeRoy Bender
The Estate of Elmer Bender
Dean Bender
Rayland Bender
Trent Bender
Nanette Aragon
Hope Witte

TRACT 23
T145N-R83W-Section 36:
SURFACE OWNERSHIP:
COAL OWNERSHIP:

NW¼
The Falkirk Mining Company
Carol J. Reinhiller and Thomas R. Reinhiller
Joy M. Ochsner and Gary L. Ochsner
Judith K. Simpfenderfer and
Jerome D. Simpfenderfer
Sylvia Thompson
State of North Dakota – State Land Department

TRACT 24
T145N-R83W-Section 13:
SURFACE OWNERSHIP:
COAL OWNERSHIP:

SW¼
The Falkirk Mining Company
AgriBank, FCB
Adele C. Saylor
Myrdred Swanson
Myrtle Breeding
Stanley E. Saylor, Sr.
Norma J. Schacher
Linda G. Hoerner
Elizabeth Reiland

TRACT 25
T145N-R83W-Section 11:
SURFACE OWNERSHIP:
COAL OWNERSHIP:

SW¼
The Falkirk Mining Company
Arnold J. Schafer and Gretchen M. Schafer,
Life Estate
Remaindermen:
-Mary Schafer Conlon
-Macy J. Schafer
-Marty J. Schafer
-Monty R. Schafer
AgriBank, FCB

TRACT 26
T145N-R83W-Section 11:
SURFACE OWNERSHIP:
COAL OWNERSHIP:

SE¼
The Falkirk Mining Company
Adele Saylor
Myrtle Breeding
Elizabeth Reiland
Stanley E. Saylor, Sr.
Norma J. Schacher
Linda G. Hoerner

TRACT 27
T145N-R83W-Section 13:
SURFACE OWNERSHIP:
COAL OWNERSHIP:

NE¼
The Falkirk Mining Company
Heger Land Trust Dated 4-30-08,
Deborah Siem, Laurance Heger, and Carl Heger,
Trustees
State of North Dakota – State Land Department
The Nokota Company
Three Forks Oil Corporation
Red Crown Royalties, LLC

TRACT 28
T145N-R83W-Section 13:
SURFACE OWNERSHIP:
COAL OWNERSHIP:

NW¼
The Falkirk Mining Company
The Ervin R. Schafer Revocable Trust
Dated 10-10-89
W. L. Braun Oil Properties Revocable Trust
Dated 10-22-98
Lavema McKelvy
The Estate of Donald D. Schafer
The Falkirk Mining Company

TRACT 29
T145N-R83W-Section 14:
SURFACE OWNERSHIP:
COAL OWNERSHIP:

NE¼
The Falkirk Mining Company
The Ervin R. Schafer Revocable Trust
Dated 10-10-89

TRACT 30
T145N-R83W-Section 14:
SURFACE OWNERSHIP:
COAL OWNERSHIP:

NW¼
The Falkirk Mining Company
The Adeline L. Schafer Revocable Trust
Dated 10-10-89

TRACT 31
T145N-R83W-Section 14:
SURFACE OWNERSHIP:
COAL OWNERSHIP:

SW¼
The Falkirk Mining Company
Richard Ernsdorf
The Nokota Company
Three Forks Oil Corporation
The Falkirk Mining Company

TRACT 32
T145N-R83W-Section 14:
SURFACE OWNERSHIP:
COAL OWNERSHIP:

SE¼
The Falkirk Mining Company
August R. Johnson
The Nokota Company
Three Forks Oil Corporation
The Falkirk Mining Company

TRACT 33
T145N-R83W-Section 23:
SURFACE OWNERSHIP:
COAL OWNERSHIP:

E½
The Falkirk Mining Company
Rita McCreary and Edward McCreary
William Frederick Lindell and Patricia Lindell

TRACT 34
T145N-R83W-Section 23:
SURFACE OWNERSHIP:
COAL OWNERSHIP:

NW¼
The Falkirk Mining Company
Terry Ollenburger
Audrey Schubarth
Jane Ollenburger
Monte Ollenburger

TRACT 35
T145N-R83W-Section 23:
SURFACE OWNERSHIP:
COAL OWNERSHIP:

SW¼
The Falkirk Mining Company
Barbara J. Hoffer
Eileen C. Zander

TRACT 36
T145N-R83W-Section 26:
SURFACE OWNERSHIP:
COAL OWNERSHIP:

NE¼
William Frederick Lindell and Patricia Lindell
William Frederick Lindell and Patricia Lindell
Rita McCreary and Edward McCreary

TRACT 37
T145N-R83W-Section 26:
SURFACE OWNERSHIP:
COAL OWNERSHIP:

NW¼
The Falkirk Mining Company
William Frederick Lindell and Patricia Lindell
Rita McCreary and Edward McCreary

TRACT 38
T145N-R83W-Section 26:
SURFACE OWNERSHIP:
COAL OWNERSHIP:

SW¼
The Falkirk Mining Company
Anne Carlsen Center for Children
Home on the Range
Dakota Boys Ranch of Minot
Trinity Lutheran Church Foundation
Birka Country Church
First Lutheran Church
Melvin A. Christenson Revocable Trust
Darlene Roach

TRACT 39
T145N-R83W-Section 26:
SURFACE OWNERSHIP:
COAL OWNERSHIP:

SE $\frac{1}{4}$
The Falkirk Mining Company
William Frederick Lindell and Patricia Lindell
Rita McCreary and Edward McCreary

TRACT 40
T145N-R83W-Section 35:
SURFACE OWNERSHIP:
COAL OWNERSHIP:

NE $\frac{1}{4}$
The Falkirk Mining Company
The Falkirk Mining Company

TRACT 41
T145N-R83W-Section 35:
SURFACE OWNERSHIP:
COAL OWNERSHIP:

W $\frac{1}{2}$ NW $\frac{1}{4}$
The Falkirk Mining Company
Anne Carlsen Center for Children
Home on the Range
Dakota Boys Ranch of Minot
Trinity Lutheran Church Foundation
Birka Country Church
First Lutheran Church
Melvin A. Christenson Revocable Trust
Darlene Roach

TRACT 42
T145N-R83W-Section 35:
SURFACE OWNERSHIP:
COAL OWNERSHIP:

E $\frac{1}{2}$ NW $\frac{1}{4}$
The Falkirk Mining Company
Estate of George W. Swanson

TRACT 43
T144N-R83W-Section 4:

SURFACE OWNERSHIP:
COAL OWNERSHIP:

Lots 1, 2, 3, 4,
less the south 40 rods of Lots 1 and 2
The Falkirk Mining Company
Ernest E. Slagg, Life Estate
Remaindermen:
-George L. Swanson and Val Rae Swanson
Adeline M. Slagg
Elda Ann Baisch
Martys Slagg
Kevin Slagg
Wayne Slagg
Julie Slagg
Steven W. Slagg
Miles J. Slagg
Marsha F. Slagg
Carolyn Currier
Jerald Slagg
Connie Jo Hill
Val Rae Swanson

TRACT 44
T144N-R83W-Section 4:
SURFACE OWNERSHIP:
COAL OWNERSHIP:

The south 40 rods of Lots 1 and 2
The Falkirk Mining Company
State of North Dakota - State Land Department
Adeline M. Slagg
Elda Ann Baisch
Martys Slagg
Kevin Slagg
Wayne Slagg
Julie Slagg
Steven W. Slagg
Miles J. Slagg
Marsha F. Slagg
Carolyn Currier
Jerald Slagg
Connie Jo Hill
Val Rae Swanson

TRACT 45
T144N-R83W-Section 4:
SURFACE OWNERSHIP:
COAL OWNERSHIP:

SW $\frac{1}{4}$
The Falkirk Mining Company
Gertrude E. Burck
Cleo Kersey
Kitty Tweeten

TRACT 46

T144N-R83W-Section 4:

SURFACE OWNERSHIP:

COAL OWNERSHIP:

SE $\frac{1}{4}$

The Falkirk Mining Company

State of North Dakota – State Land Department

Elda Ann Baisch

Carolyn S. Currier and Arch N. Currier

Steven W. Slagg

Miles J. Slagg

Marsha F. Slagg

Val Rae Swanson

Jerald A. Slagg

Connie Jo Hill

Adeline M. Slagg

Marlys Slagg

Kevin Slagg

Wayne Slagg

Julie Slagg

TRACT 47

T144N-R83W-Section 5:

SURFACE OWNERSHIP:

COAL OWNERSHIP:

Lots 3 and 4

Milton L. Holznagel Revocable Trust Dated 1-9-95

Milton L. Holznagel Revocable Trust Dated 1-9-95

TRACT 48

T144N-R83W-Section 5:

SURFACE OWNERSHIP:

COAL OWNERSHIP:

Lots 1 and 2

Roger Peterson, Life Estate

Remaindermen:

-Neal Peterson

-Cheryl Gillespie

Roger Peterson, Life Estate

Remaindermen:

-Neal Peterson

-Cheryl Gillespie

TRACT 49

T144N-R83W-Section 5:

SURFACE OWNERSHIP:

COAL OWNERSHIP:

SW $\frac{1}{4}$, less an 8 ac. tract in the SE $\frac{1}{4}$ SW $\frac{1}{4}$

Milton L. Holznagel Revocable Trust Dated 1-9-95

Milton L. Holznagel Revocable Trust Dated 1-9-95

TRACT 50

T144N-R83W-Section 5:

SURFACE OWNERSHIP:

COAL OWNERSHIP:

an 8 ac. tract in the SE $\frac{1}{4}$ SW $\frac{1}{4}$

The Falkirk Mining Company

The Falkirk Mining Company

TRACT 51

T144N-R83W-Section 5:

SURFACE OWNERSHIP:

Remaindermen:

- Neal Peterson

- Cheryl Gillespie

COAL OWNERSHIP:

Remaindermen:

- Neal Peterson

- Cheryl Gillespie

SE $\frac{1}{4}$

Roger Peterson, Life Estate

Roger Peterson, Life Estate

TRACT 52
T144N-R83W-Section 9:
SURFACE OWNERSHIP:
COAL OWNERSHIP:

NW¼
The Falkirk Mining Company
Maryls D. Allen and Lisa E. Allen
April Azar
Jana J. Azar
WLK Resources, LLC
Fred S. Wright, Jr.
Nancy Elizabeth Brooks
Mary Evelyn King
Dana Denise Wright
Major David L. Wright
Thomas Russell Wright, Jr.
Fred S. Wright, Jr.,
Trustee of the Fred S. Wright, Jr.
Trust
Plains Exploration & Production Company
Henry Lerman
Irving Lerner
Linda Petroleum Co.
Williston Projects, Inc.
Cotton 4 Mineral Trust
Cotton 6 Mineral Trust
George E. Moss, Jr.
John K. Moss
Myra Ellen Moss
Roscoe Moss, III
Frank Jeppi Bi-Pass Trust
J & L Hauptman Family Partnership
Phillip Mandel
Louis Dorfman
Myron H. Dorfman
Singer Bros.
S&P Co., A Louisiana Partnership
Fleischaker Mineral Company, LLC
Teton Properties, LLC
S D Resources, Ltd.
A.G.S. Limited Partnership
Eculirra Oil & Gas, LLC

TRACT 53
T144N-R83W-Section 9:
SURFACE OWNERSHIP:
COAL OWNERSHIP:

NE¼
The Falkirk Mining Company
State of North Dakota - State Land Department
April Azar
Jana J. Azar
WLK Resources, LLC
Fred S. Wright, Jr.
Nancy Elizabeth Brooks
Mary Evelyn King
Dana Denise Wright
Major David L. Wright
Thomas Russell Wright, Jr.
Fred S. Wright, Jr.,
Trustee of the Fred S. Wright, Jr.
Trust
Plains Exploration & Production Company
Henry Lerman
Irving Lerner
Linda Petroleum Co.
Williston Projects, Inc.
Cotton 4 Mineral Trust
Cotton 6 Mineral Trust
George E. Moss, Jr.
John K. Moss
Myra Ellen Moss
Roscoe Moss, III
Frank Jeppi Bi-Pass Trust
J & L Hauptman Family Partnership
Phillip Mandel
Louis Dorfman
Myron H. Dorfman
Singer Bros.
S&P Co., A Louisiana Partnership
Fleischaker Mineral Company, LLC
Teton Properties, LLC
S D Resources, Ltd.
A.G.S. Limited Partnership
Eculirra Oil & Gas, LLC

TRACT 54

T145N-R83W-Section 10:
SURFACE OWNERSHIP:
COAL OWNERSHIP:

SW $\frac{1}{4}$
The Falkirk Mining Company
Pennington Living Trust Dated 4-28-99

TRACT 55

T145N-R83W-Section 10:
SURFACE OWNERSHIP:
COAL OWNERSHIP:

SE $\frac{1}{4}$, less 2.55 ac. hwy.
The Falkirk Mining Company
MDR Landenberger Family Trust Dated 10-19-02

TRACT 56

T145N-R83W-Section 15:
SURFACE OWNERSHIP:
COAL OWNERSHIP:

NW $\frac{1}{4}$
The Falkirk Mining Company
Barbara J. Hoffer
Eileen C. Zander
State of North Dakota – State Land Department

TRACT 57

T145N-R83W-Section 15:
SURFACE OWNERSHIP:
COAL OWNERSHIP:

NE $\frac{1}{4}$, less tracts of 7.21 ac. and 5.75 ac.
The Falkirk Mining Company
Estate of George W. Swanson
State of North Dakota – State Land Department

TRACT 58

T145N-R83W-Section 15:
SURFACE OWNERSHIP:
COAL OWNERSHIP:

5.75 ac. in the NE $\frac{1}{4}$
The Falkirk Mining Company
The Falkirk Mining Company
State of North Dakota – State Land Department

TRACT 59

T145N-R83W-Section 15:
SURFACE OWNERSHIP:
COAL OWNERSHIP:

7.21 ac. in the NE $\frac{1}{4}$
The Falkirk Mining Company
George L. Swanson and Val Rae Swanson
State of North Dakota – State Land Department

TRACT 60

T145N-R83W-Section 15:
SURFACE OWNERSHIP:
COAL OWNERSHIP:

SW $\frac{1}{4}$
The Falkirk Mining Company
MDR Landenberger Family Trust Dated 10-19-02
The Reserve Petroleum Company

TRACT 61

T145N-R83W-Section 15:
SURFACE OWNERSHIP:
COAL OWNERSHIP:

SE $\frac{1}{4}$
The Falkirk Mining Company
The Reserve Petroleum Company
State of North Dakota – State Land Department

TRACT 62

T145N-R83W-Section 21:
SURFACE OWNERSHIP:
COAL OWNERSHIP:

SE $\frac{1}{4}$
The Falkirk Mining Company
The Falkirk Mining Company

TRACT 63

T145N-R83W-Section 22:
SURFACE OWNERSHIP:
COAL OWNERSHIP:

NW $\frac{1}{4}$
The Falkirk Mining Company
Estate of George W. Swanson
Estates of Carl H. Reimers and
Margaret A. Reimers
Darlene Ostboe
Michael Ranum
Mark Ranum
Andrew Ranum
Norm Ostboe and Darlene A. Ostboe
Donna L. Bloomquist
Gerald T. Woolworth
Patricia A. Reimers
Mary O. Reimers
Charlotte L. Potter
Gary B. Reimers
Ronald J. Stroh and Arlyce J. Stroh
Karen Louise Sorensen

TRACT 64
T145N-R83W-Section 22: NE $\frac{1}{4}$
SURFACE OWNERSHIP: The Falkirk Mining Company
COAL OWNERSHIP: Milton Saylor and Kathy Saylor
Marcia Walker, Life Estate
Remaindermen:
-John B. Walker
-Samuel C. Walker

TRACT 65
T145N-R83W-Section 22: SW $\frac{1}{4}$, less 5 ac. in the SW corner
and less the SE $\frac{1}{4}$ SE $\frac{1}{4}$ SW $\frac{1}{4}$
SURFACE OWNERSHIP: The Falkirk Mining Company
COAL OWNERSHIP: Erma Carlson
Marva Deane Finck
Karen Carlson

TRACT 66
T145N-R83W-Section 22: SE $\frac{1}{4}$ SE $\frac{1}{4}$ SW $\frac{1}{4}$, less 3.75 ac.
SURFACE OWNERSHIP: The Falkirk Mining Company
COAL OWNERSHIP: Erma Carlson
Marva Deane Finck
Karen Carlson

TRACT 66A
T145N-R83W-Section 22: 3.75 ac. in the SE $\frac{1}{4}$ SE $\frac{1}{4}$ SW $\frac{1}{4}$
SURFACE OWNERSHIP: The Falkirk Mining Company
COAL OWNERSHIP: The Falkirk Mining Company

TRACT 67
T145N-R83W-Section 22: SE $\frac{1}{4}$, less the SW $\frac{1}{4}$ SW $\frac{1}{4}$ SE $\frac{1}{4}$
SURFACE OWNERSHIP: The Falkirk Mining Company
COAL OWNERSHIP: Estate of George W. Swanson

TRACT 68
T145N-R83W-Section 22: SW $\frac{1}{4}$ SW $\frac{1}{4}$ SE $\frac{1}{4}$
SURFACE OWNERSHIP: The Falkirk Mining Company
COAL OWNERSHIP: Estate of George W. Swanson

TRACT 69
T145N-R83W-Section 28: N $\frac{1}{2}$ NW $\frac{1}{4}$, W $\frac{1}{2}$ NE $\frac{1}{4}$
SURFACE OWNERSHIP: The Falkirk Mining Company
COAL OWNERSHIP: Erma Carlson
Marva D. Finck
Karen J. Carlson

TRACT 70
T145N-R83W-Section 28: E $\frac{1}{2}$ NE $\frac{1}{4}$
SURFACE OWNERSHIP: Marva Deane Finck
COAL OWNERSHIP: Marva Deane Finck

TRACT 71
T145N-R83W-Section 28: SW $\frac{1}{4}$, S $\frac{1}{2}$ NW $\frac{1}{4}$
SURFACE OWNERSHIP: Eileen C. Zander
COAL OWNERSHIP: Eileen C. Zander
Barbara J. Hoffer

TRACT 72
T145N-R83W-Section 28: SE $\frac{1}{4}$
SURFACE OWNERSHIP: Dwight D. Gradin and Denise Gradin
COAL OWNERSHIP: Dwight D. Gradin and Denise Gradin
Miles W. Gradin
Wallyn K. Lee
Mark E. Gradin
Kyle E. Gradin
The Irene V. Johannes Revocable
Living Trust Dated 5-15-96

TRACT 73
T145N-R83W-Section 27:
SURFACE OWNERSHIP:
COAL OWNERSHIP:

NW¼
The Falkirk Mining Company
Erma Carlson
Estates of Carl H. Reimers and
Margaret A. Reimers
Darlene Ostboe
Michael Ranum
Mark Ranum
Andrew Ranum
Norm Ostboe and Darlene A. Ostboe
Donna L. Bloomquist
Gerald T. Woolworth
Patricia A. Reimers
Mary O. Reimers
Charlotte L. Potter
Gary B. Reimers
Ronald J. Stroh and Arlyce J. Stroh
Karen Louise Sorenson

TRACT 74
T145N-R83W-Section 27:
SURFACE OWNERSHIP:
COAL OWNERSHIP:

NE¼
The Falkirk Mining Company
Erma Carlson

TRACT 75
T145N-R83W-Section 27:
SURFACE OWNERSHIP:
COAL OWNERSHIP:

SW¼
The Falkirk Mining Company
Janice E. Hanson
Bonnie J. Kuntz

TRACT 76
T145N-R83W-Section 27:
SURFACE OWNERSHIP:
COAL OWNERSHIP:

SE¼
The Falkirk Mining Company
Janice E. Hanson
Bonnie J. Kuntz

TRACT 77
T145N-R83W-Section 33:
SURFACE OWNERSHIP:
COAL OWNERSHIP:

NW¼
Dwight D. Gradin and Denise Gradin
Dwight D. Gradin and Denise Gradin
Miles W. Gradin
Wallyn K. Lee
Mark E. Gradin
Kyle E. Gradin
The Irene V. Johannes Revocable Living Trust
Dated 5-15-86

TRACT 78
T145N-R83W-Section 33:
SURFACE OWNERSHIP:
COAL OWNERSHIP:

NE¼
Dwight D. Gradin and Denise Gradin
Dwight D. Gradin and Denise Gradin
Miles W. Gradin
Wallyn K. Lee
Mark E. Gradin
Kyle E. Gradin
The Irene V. Johannes Revocable Living Trust
Dated 5-15-96

TRACT 79
T145N-R83W-Section 34:
SURFACE OWNERSHIP:
COAL OWNERSHIP:

NW¼
Sharyn M. Calton
Sharyn M. Calton

TRACT 80
T145N-R83W-Section 34:
SURFACE OWNERSHIP:
COAL OWNERSHIP:

North 100 ac. of the NE¼
The Falkirk Mining Company
Anne Carlson Center for Children
Home on the Range
Dakota Boys Ranch of Minot
Trinity Lutheran Church Foundation
Birka Country Church
First Lutheran Church
Melvin A. Christenson Revocable Trust
Darlene Roach

TRACT 81
T145N-R83W-Section 34:
SURFACE OWNERSHIP:
COAL OWNERSHIP:

South 60 ac. of the NE¼
The Falkirk Mining Company
Anne Carlson Center for Children
Home on the Range
Dakota Boys Ranch of Minot
Trinity Lutheran Church Foundation
Birka Country Church
First Lutheran Church
Melvin A. Christenson Revocable Trust
Darlene Roach

TRACT 82
T145N-R83W-Section 34:
SURFACE OWNERSHIP:

SW¼
Mildred Leidholm, as Trustee of the Lloyd Leidholm
Testamentary Trust
Roy B. Leidholm and Eva Leidholm, Life Estate
Remaindermen:
-Brian Leidholm
-Cordell Leidholm
-Glynda Janz
-Karen Perkerewicz
-Dean Leidholm
-Tammy Novak
-Sharon Rivers
-Dwayne Leidholm

Mildred Jahner and Valentine Jahner, Life Estate
Remaindermen:
-Curtis Jahner
-Brent Jahner

COAL OWNERSHIP:

Mildred Leidholm, as Trustee of the Lloyd Leidholm
Testamentary Trust
Roy B. Leidholm and Eva Leidholm, Life Estate
Remaindermen:
-Brian Leidholm
-Cordell Leidholm
-Glynda Janz
-Karen Perkerewicz
-Dean Leidholm
-Tammy Novak
-Sharon Rivers
-Dwayne Leidholm
Mildred Jahner and Valentine Jahner, Life Estate
Remaindermen:
-Curtis Jahner
-Brent Jahner

TRACT 83
T145N-R83W-Section 34:
SURFACE OWNERSHIP:
COAL OWNERSHIP:

SE¼
The Falkirk Mining Company
Hazel Peterson, Life Estate
Remaindermen:
-James Peterson
-Dennis L. Peterson
-Duaine J. Peterson
-Jane Schulz
-Susan Krebsbach
State of North Dakota – State Land Department

TRACT 84
T145N-R83W-Section 35:
SURFACE OWNERSHIP:
COAL OWNERSHIP:

SW¼
Thomas W. Lindell and David A. Lindell
William F. Lindell and Patricia Lindell
Robert L. Erickson and Susan F. Lawrence

TRACT 85
T145N-R83W-Section 35:
SURFACE OWNERSHIP:
COAL OWNERSHIP:

SE¼
The Falkirk Mining Company
Barbara J. Hoffer
Eileen C. Zander
Alma Nelson
Arvin Swanson
Marcia Steinwand
Rodney Swanson
Sheryl Willits

TRACT 86
T145N-R83W-Section 36:
SURFACE OWNERSHIP:
COAL OWNERSHIP:

SW¼
The Falkirk Mining Company
Hazel Peterson, Life Estate
Remaindermen:
-James Peterson
-Dennis L. Peterson
-Duaine J. Peterson
-Jane Schulz
-Susan Krebsbach
State of North Dakota – State Land Department

TRACT 87
T145N-R83W-Section 36:
SURFACE OWNERSHIP:
COAL OWNERSHIP:

SE¼
The Falkirk Mining Company
State of North Dakota – State Land Department
Duaine J. Peterson and Deana R. Peterson
Hazel Peterson, Life Estate
Remaindermen:
-Duaine J. Peterson and Deana R. Peterson

Copies of the revision and renewal applications for surface coal mining Permit NAFK-9503 are available for public inspection at the offices of the North Dakota Public Service Commission, Capitol Building, Bismarck, North Dakota, and at the offices of the County Auditor, McLean County Courthouse, Washburn, North Dakota.

Written comments, objections, or requests for informal conferences on the application may be submitted by any person with an interest which is or may be adversely affected to the North Dakota Public Service Commission, Capitol Building, Bismarck, North Dakota, within 30 days after the last publication of this notice.

The Falkirk Mining Company
Diana Edinger, executive assistant

(Jan. 13, 20, 27, Feb. 3, 2011)

AFFIDAVIT OF PUBLICATION

STATE OF NORTH DAKOTA)
)
COUNTY OF McLean)

I SHELLEY CHASE, being first duly sworn, on my own oath, say, that I am the bookkeeper of the Underwood News, a weekly newspaper of general circulation, published in the city of Underwood, that the advertisement headed:

FALKIRK MINING CO UN-NOTICE OF FILING PERMIT RENEWAL/LEGAL

a printed copy of which is here annexed, was published in the regular and entire issue of said newspaper during the period and time of publication, and that the notice was published in the newspaper proper, and not in a supplement,

for 4 consecutive week 02/03/2011 to wit:

Column Inches 291.5	\$5.57	\$1,623.66	01/13/2011
Column Inches 291.5	\$5.57	\$1,623.66	01/20/2011
Column Inches 291.5	\$5.57	\$1,623.66	01/27/2011 ✓
Column Inches 291.5	\$5.57	\$1,623.66	02/03/2011 ✓

Notary Fee \$1.00 ✓ Total Cost of Legal \$6,495.64

Shelley Chase

Subscribed and sworn to before me this 9th day of February A.D. 2011.

(Seal) Darla J Mautz
Notary Public, State of North Dakota

My Commission Expires

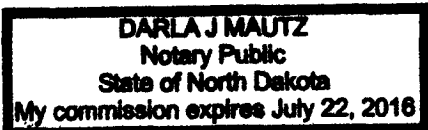

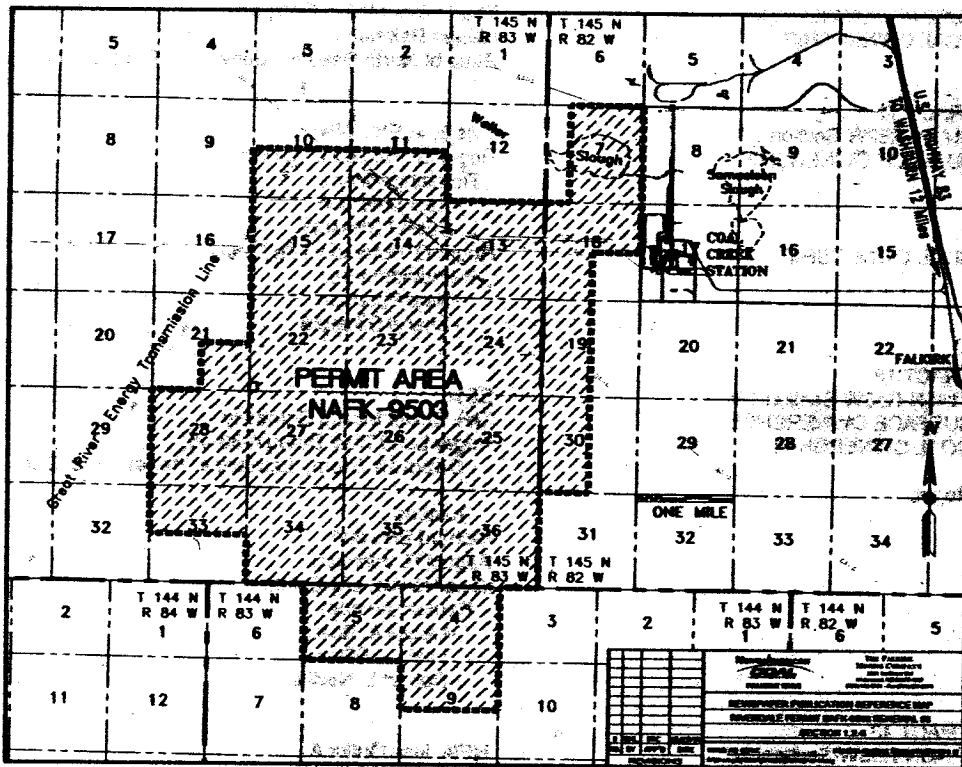

Notice of filing a permit renewal and revision to conduct surface coal mining operations

The Falkirk Mining Company, P.O. Box No. 1067, Underwood, North Dakota 58576-1067, as applicant, has filed renewal and revision applications for Surface Coal Mining Permit NAFK-9503, covering portions of Sections 7, 8, 18, 19, and 30, T145N, R82W and Sections 10, 11, 13, 14, 15, 21, 22, 23, 24, 25, 26, 27, 28, 33, 34, 35, and 36, T145N, R83W and Sections 4, 5, and 9, T144N, R83W in McLean County, North Dakota, which contains 12,386.4 acres. Renewal No. 3 to Permit NAFK-9503 will extend the permit term another five years until April 15, 2016. Revision No. 21 identifies the next five-year coal removal subarea and updates mining and reclamation plans and other information in the permit.

The permit area is located southwest of Underwood, North Dakota. The map shows the location of the City of Underwood, North Dakota, and the boundaries of the permit area. The names of The United States Geological Survey Quadrangle Map, which contains the area described and shown on the map, is "Washburn".

The owners of the surface and coal in the permit area are as follows:

TRACT 1

T145N-R82W- Section 7:

SURFACE OWNERSHIP:

COAL OWNERSHIP:

NE¼, E½NW¼

The Falkirk Mining Company

Lavera Scheid

The Nokota Company

Linda Louise Schmidt,

Trustee of the Linda L. Schmidt

2007 Revocable Trust

Arthur V. Seay, III

Sidney Ray Lawler

TRACT 2

T145N-R82W-Section 7:

SURFACE OWNERSHIP:

COAL OWNERSHIP:

E½SW¼, SE¼

The Falkirk Mining Company

LeRoy D. Traxel and Norma Traxel

The Nokota Company

Linda Louise Schmidt, Trustee of the Linda L. Schmidt

2007 Revocable Trust

Arthur V. Seay, III

Sidney Ray Lawler

TRACT 3

T145N-R82W-Section 8:

SURFACE OWNERSHIP:

COAL OWNERSHIP:

A triangular tract lying within the N½NW¼, containing .4 acres, more or less

Great River Energy

Great River Energy

TRACT 4

T145N-R82W-Section 18:

SURFACE OWNERSHIP:

COAL OWNERSHIP:

NE¼

The Falkirk Mining Company

Laurance L. Heger and Nancy L. Heger

Red Crown Royalties, LLC

Three Forks Oil Corporation

The Nokota Company

TRACT 5
T145N-R82W-Section 18
SURFACE OWNERSHIP:
COAL OWNERSHIP:

E½ of Lot 1, Lot 2, E½NW¼
The Falkirk Mining Company
Laurance L. Heger and Nancy L. Heger
Red Crown Royalties, LLC
Three Forks Oil Corporation
The Nokota Company

TRACT 6
T145N-R82W-Section 18:
SURFACE OWNERSHIP:
COAL OWNERSHIP:

W½ of Lot 1
The Falkirk Mining Company
Laurance L. Heger and Nancy L. Heger
Red Crown Royalties, LLC
Three Forks Oil Corporation
The Nokota Company

TRACT 7
T145N-R82W-Section 18:
SURFACE OWNERSHIP:
COAL OWNERSHIP:

Lots 3, 4, E½SW¼
The Falkirk Mining Company
United States of America –
Bureau of Land Management

TRACT 8
T145N-R82W-Section 19:
SURFACE OWNERSHIP:
COAL OWNERSHIP:

Lots 1, 2, E½NW¼
The Falkirk Mining Company
John C. Samuelson
Loren F. Gradin

TRACT 9
T145N-R82W-Section 19:
SURFACE OWNERSHIP:
COAL OWNERSHIP:

Lots 3, 4, E½SW¼
The Falkirk Mining Company
Janet Steckler
Lucille Gardella
Maurice Heger and Ione Heger
Loren F. Gradin

TRACT 10
T145N-R82W-Section 30:
SURFACE OWNERSHIP:
COAL OWNERSHIP:

Lots 1, 2, E½NW¼
The Falkirk Mining Company
Merian Reinhardt
State of North Dakota – State Land Department

TRACT 11
T145N-R82W-Section 30:
SURFACE OWNERSHIP:

Lots 3, 4, E½SW¼
Roger O. Peterson, Life Estate
Remaindermen:
-Neal Peterson
-Cheryl Gillespie
Roger O. Peterson, Life Estate
Remaindermen:
-Neal Peterson
-Cheryl Gillespie

COAL OWNERSHIP:

TRACT 12
T145N-R83W-Section 13:
SURFACE OWNERSHIP:
COAL OWNERSHIP:

SE¼
The Falkirk Mining Company
Heger Land Trust Dated 4-30-08,
Deborah Slem, Laurance Heger, and Carl

Heger,

Trustees
Richard Emsdorf
August R. Johnson
Jean Neville, Life Estate
Remaindermen:
-Laurel A. Ross
-Linda J. Dillon
-Robert L. Neville

TRACT 13
T145N-R83W-Section 24:
SURFACE OWNERSHIP:
COAL OWNERSHIP:

NE¼, less Outlot A
The Falkirk Mining Company
Barbara Lee Jones

TRACT 14

T145N-R83W-Section 24:

Outlot A of the NE¼, described as follows:

Beginning at a point that is located 1484.0 feet South of the northeast corner of Section 24, thence West and parallel with the North section line a distance of 1972.0 feet to a point, thence North and parallel with the East section line a distance of 492.0 feet, thence West and parallel with the North section line a distance of 868.0 feet to the quarter section line, thence South along the quarter section line a distance of 918.0 feet, thence East and parallel with the North section line a distance of 668.0 feet, thence North and parallel with the East section line a distance of 226.0 feet, thence East and parallel with the North section line a distance of 1972.0 feet to the East section line of Section 24, thence North along the East section line a distance of 200 feet to the point of beginning. Containing 23.14 acres, more or less.

SURFACE OWNERSHIP:

The Falkirk Mining Company

COAL OWNERSHIP:

Randy Van Asperen

Barbara Lee Jones

Bruce Allen Gradin

TRACT 15

T145N-R83W-Section 24:

NW¼

SURFACE OWNERSHIP:

The Falkirk Mining Company

COAL OWNERSHIP:

Michael Berg

Barbara Lee Jones

Bruce Allen Gradin

TRACT 16

T145N-R83W-Section 24:

SW¼

SURFACE OWNERSHIP:

The Falkirk Mining Company

COAL OWNERSHIP:

Barbara Lee Jones

Bruce Allen Gradin

TRACT 17

T145N-R83W-Section 24:

SE¼

SURFACE OWNERSHIP:

The Falkirk Mining Company

COAL OWNERSHIP:

Carol J. Reinhiller and Thomas R. Reinhiller

Joy M. Ochsner and Gary L. Ochsner

Judith K. Simplenderfer and

Jerome D. Simplenderfer

Sylvia Thompson

TRACT 18

T145N-R83W-Section 25:

NE¼

SURFACE OWNERSHIP:

The Falkirk Mining Company

COAL OWNERSHIP:

John C. Samuelson and Helen K. Samuelson

Shaun Stewart

Erica LeFevers

Chris Stewart

Brett Stewart

Sarah LeFevers

TRACT 19

T145N-R83W-Section 25:

NW¼

SURFACE OWNERSHIP:

The Falkirk Mining Company

COAL OWNERSHIP:

Rita McCreary and Edward McCreary

William Frederick Lindell and Patricia Lindell

TRACT 20

T145N-R83W-Section 25:

SW¼

SURFACE OWNERSHIP:

The Falkirk Mining Company

COAL OWNERSHIP:

Jeffrey G. Culver

Harry W. Samuelson, Jr., as Trustee of the

Harry W. Samuelson, Jr. Revocable Trust

Lois Samuelson, as Trustee of the

Lois Samuelson Revocable Trust

TRACT 21

T145N-R83W-Section 25:

SE¼

SURFACE OWNERSHIP:

The Falkirk Mining Company

COAL OWNERSHIP:

John C. Samuelson and Helen K. Samuelson

Dorothy E. Samuelson

TRACT 22
T145N-R83W-Section 36:
SURFACE OWNERSHIP:
COAL OWNERSHIP:

NE¼
The Falkirk Mining Company
State of North Dakota – State Land Department
Carol Adams
Sharon Huber
Donald Bender
Paul J. Bender
Brenda Dietrich
Marlin Bender
Merlin Bender
LeRoy Bender
The Estate of Elmer Bender
Dean Bender
Rayland Bender
Trent Bender
Nanette Aragon
Hope Witte

TRACT 23
T145N-R83W-Section 36:
SURFACE OWNERSHIP:
COAL OWNERSHIP:

NW¼
The Falkirk Mining Company
Carol J. Reinhiller and Thomas R. Reinhiller
Joy M. Ochener and Gary L. Ochener
Judith K. Simpfenderfer and
Jerome D. Simpfenderfer
Sylvia Thompson
State of North Dakota – State Land Department

TRACT 24
T145N-R83W-Section 13:
SURFACE OWNERSHIP:
COAL OWNERSHIP:

SW¼
The Falkirk Mining Company
AgriBank, FCB
Adele C. Saylor
Myldred Swanson
Myrtle Breeding
Stanley E. Saylor, Sr.
Norma J. Schacher
Linda G. Hoerner
Elizabeth Reiland

TRACT 25
T145N-R83W-Section 11:
SURFACE OWNERSHIP:
COAL OWNERSHIP:

SW¼
The Falkirk Mining Company
Arnold J. Schafer and Gretchen M. Schafer,
Life Estate
Remaindermen:
-Mary Schafer Conlon
-Macy J. Schafer
-Marty J. Schafer
-Monty R. Schafer
AgriBank, FCB

TRACT 26
T145N-R83W-Section 11:
SURFACE OWNERSHIP:
COAL OWNERSHIP:

SE¼
The Falkirk Mining Company
Adele Saylor
Myrtle Breeding
Elizabeth Reiland
Stanley E. Saylor, Sr.
Norma J. Schacher
Linda G. Hoerner

TRACT 27
T145N-R83W-Section 13:
SURFACE OWNERSHIP:
COAL OWNERSHIP:

NE¼
The Falkirk Mining Company
Heger Land Trust Dated 4-30-08,
Deborah Stem, Laurance Heger, and Carl Heger,
Trustees
State of North Dakota – State Land Department
The Nokota Company
Three Forks Oil Corporation
Red Crown Royalties, LLC

TRACT 28
T145N-R83W-Section 13:
SURFACE OWNERSHIP:
COAL OWNERSHIP:

NW¼
The Falkirk Mining Company
The Ervin R. Schafer Revocable Trust
Dated 10-10-89
W. L. Braun Oil Properties Revocable Trust
Dated 10-22-98
Laverna McKelvy
The Estate of Donald D. Schafer
The Falkirk Mining Company

TRACT 29
T145N-R83W-Section 14:
SURFACE OWNERSHIP:
COAL OWNERSHIP:

NE¼
The Falkirk Mining Company
The Ervin R. Schafer Revocable Trust
Dated 10-10-89

TRACT 30
T145N-R83W-Section 14:
SURFACE OWNERSHIP:
COAL OWNERSHIP:

NW¼
The Falkirk Mining Company
The Adeline L. Schafer Revocable Trust
Dated 10-10-89

TRACT 31
T145N-R83W-Section 14:
SURFACE OWNERSHIP:
COAL OWNERSHIP:

SW¼
The Falkirk Mining Company
Richard Ernsdorf
The Nokota Company
Three Forks Oil Corporation
The Falkirk Mining Company

TRACT 32
T145N-R83W-Section 14:
SURFACE OWNERSHIP:
COAL OWNERSHIP:

SE¼
The Falkirk Mining Company
August R. Johnson
The Nokota Company
Three Forks Oil Corporation
The Falkirk Mining Company

TRACT 33
T145N-R83W-Section 23:
SURFACE OWNERSHIP:
COAL OWNERSHIP:

E½
The Falkirk Mining Company
Rita McCreary and Edward McCreary
William Frederick Lindell and Patricia Lindell

TRACT 34
T145N-R83W-Section 23:
SURFACE OWNERSHIP:
COAL OWNERSHIP:

NW¼
The Falkirk Mining Company
Terry Ollenburger
Audrey Schubarth
Jane Ollenburger
Monte Ollenburger

TRACT 35
T145N-R83W-Section 23:
SURFACE OWNERSHIP:
COAL OWNERSHIP:

SW¼
The Falkirk Mining Company
Barbara J. Hoffer
Eileen C. Zander

TRACT 36
T145N-R83W-Section 26:
SURFACE OWNERSHIP:
COAL OWNERSHIP:

NE¼
William Frederick Lindell and Patricia Lindell
William Frederick Lindell and Patricia Lindell
Rita McCreary and Edward McCreary

TRACT 37
T145N-R83W-Section 26:
SURFACE OWNERSHIP:
COAL OWNERSHIP:

NW¼
The Falkirk Mining Company
William Frederick Lindell and Patricia Lindell
Rita McCreary and Edward McCreary

TRACT 38
T145N-R83W-Section 26:
SURFACE OWNERSHIP:
COAL OWNERSHIP:

SW¼
The Falkirk Mining Company
Anne Carlsen Center for Children
Home on the Range
Dakota Boys Ranch of Minot
Trinity Lutheran Church Foundation
Birka Country Church
First Lutheran Church
Melvin A. Christenson Revocable Trust
Darlene Roach

TRACT 39
T145N-R83W-Section 26:
SURFACE OWNERSHIP:
COAL OWNERSHIP:

SE¼
The Falkirk Mining Company
William Frederick Lindell and Patricia Lindell
Rita McCreary and Edward McCreary

TRACT 40
T145N-R83W-Section 35:
SURFACE OWNERSHIP:
COAL OWNERSHIP:

NE¼
The Falkirk Mining Company
The Falkirk Mining Company

TRACT 41
T145N-R83W-Section 35:
SURFACE OWNERSHIP:
COAL OWNERSHIP:

W½NW¼
The Falkirk Mining Company
Anne Carlson Center for Children
Home on the Range
Dakota Boys Ranch of Minot
Trinity Lutheran Church Foundation
Birka Country Church
First Lutheran Church
Melvin A. Christenson Revocable Trust
Darlene Roach

TRACT 42
T145N-R83W-Section 35:
SURFACE OWNERSHIP:
COAL OWNERSHIP:

E½NW¼
The Falkirk Mining Company
Estate of George W. Swanson

TRACT 43
T144N-R83W-Section 4:
SURFACE OWNERSHIP:
COAL OWNERSHIP:

Lots 1, 2, 3, 4,
less the south 40 rods of Lots 1 and 2
The Falkirk Mining Company
Ernest E. Slagg, Life Estate
Remaindermen:
-George L. Swanson and Val Rae Swanson
Adeline M. Slagg
Elda Ann Baisch
Marlys Slagg
Kevin Slagg
Wayne Slagg
Julie Slagg
Steven W. Slagg
Miles J. Slagg
Marsha F. Slagg
Carolyne Currier
Jerald Slagg
Connie Jo Hill
Val Rae Swanson

TRACT 44
T144N-R83W-Section 4:
SURFACE OWNERSHIP:
COAL OWNERSHIP:

The south 40 rods of Lots 1 and 2
The Falkirk Mining Company
State of North Dakota - State Land Department
Adeline M. Slagg
Elda Ann Baisch
Marlys Slagg
Kevin Slagg
Wayne Slagg
Julie Slagg
Steven W. Slagg
Miles J. Slagg
Marsha F. Slagg
Carolyne Currier
Jerald Slagg
Connie Jo Hill
Val Rae Swanson

TRACT 45
T144N-R83W-Section 4:
SURFACE OWNERSHIP:
COAL OWNERSHIP:

SW¼
The Falkirk Mining Company
Gertrude E. Burck
Cleo Kersey
Kitty Tweeten

TRACT 46
T144N-R83W-Section 4:
SURFACE OWNERSHIP:
COAL OWNERSHIP:

SE $\frac{1}{4}$
The Falkirk Mining Company
State of North Dakota – State Land Department
Elda Ann Baisch
Carolyn S. Currier and Arch N. Currier
Steven W. Slagg
Miles J. Slagg
Marsha F. Slagg
Val Rae Swanson
Jerald A. Slagg
Connie Jo Hill
Adeline M. Slagg
Marlys Slagg
Kevin Slagg
Wayne Slagg
Julie Slagg

TRACT 47
T144N-R83W-Section 5:
SURFACE OWNERSHIP:
COAL OWNERSHIP:

Lots 3 and 4
Milton L. Holznagel Revocable Trust Dated 1-9-95
Milton L. Holznagel Revocable Trust Dated 1-9-95

TRACT 48
T144N-R83W-Section 5:
SURFACE OWNERSHIP:

Lots 1 and 2
Roger Peterson, Life Estate
Remaindermen:
-Neal Peterson
-Cheryl Gillespie
Roger Peterson, Life Estate
Remaindermen:
-Neal Peterson
-Cheryl Gillespie

COAL OWNERSHIP:

TRACT 49
T144N-R83W-Section 5:
SURFACE OWNERSHIP:
COAL OWNERSHIP:

SW $\frac{1}{4}$, less an 8 ac. tract in the SE $\frac{1}{4}$ SW $\frac{1}{4}$
Milton L. Holznagel Revocable Trust Dated 1-9-95
Milton L. Holznagel Revocable Trust Dated 1-9-95

TRACT 50
T144N-R83W-Section 5:
SURFACE OWNERSHIP:
COAL OWNERSHIP:

an 8 ac. tract in the SE $\frac{1}{4}$ SW $\frac{1}{4}$
The Falkirk Mining Company
The Falkirk Mining Company

TRACT 51
T144N-R83W-Section 5:
SURFACE OWNERSHIP:

SE $\frac{1}{4}$
Roger Peterson, Life Estate

Remaindermen:
- Neal Peterson
- Cheryl Gillespie
COAL OWNERSHIP:
Remaindermen:
- Neal Peterson
- Cheryl Gillespie

Roger Peterson, Life Estate

TRACT 52
T144N-R83W-Section 9:
SURFACE OWNERSHIP:
COAL OWNERSHIP:

NW¼
The Falkirk Mining Company
Marys D. Allen and Lisa E. Allen
April Azar
Jana J. Azar
WLK Resources, LLC
Fred S. Wright, Jr.
Nancy Elizabeth Brooks
Mary Evelyn King
Dana Denise Wright
Major David L. Wright
Thomas Russell Wright, Jr.
Fred S. Wright, Jr.,
Trustee of the Fred S. Wright, Jr.
Trust
Plains Exploration & Production Company
Henry Lerman
Irving Lerner
Linda Petroleum Co.
Williston Projects, Inc.
Cotton 4 Mineral Trust
Cotton 6 Mineral Trust
George E. Moss, Jr.
John K. Moss
Myra Ellen Moss
Roscoe Moss, III
Frank Jeppi Bi-Pass Trust
J & L Hauptman Family Partnership
Phillip Mandel
Louis Dorfman
Myron H. Dorfman
Singer Bros.
S&P Co., A Louisiana Partnership
Fleischaker Mineral Company, LLC
Teton Properties, LLC
S D Resources, Ltd.
A.G.S. Limited Partnership
Eculirra Oil & Gas, LLC

TRACT 53
T144N-R83W-Section 9:
SURFACE OWNERSHIP:
COAL OWNERSHIP:

NE¼
The Falkirk Mining Company
State of North Dakota - State Land Department
April Azar
Jana J. Azar
WLK Resources, LLC
Fred S. Wright, Jr.
Nancy Elizabeth Brooks
Mary Evelyn King
Dana Denise Wright
Major David L. Wright
Thomas Russell Wright, Jr.
Fred S. Wright, Jr.,
Trustee of the Fred S. Wright, Jr.
Trust
Plains Exploration & Production Company
Henry Lerman
Irving Lerner
Linda Petroleum Co.
Williston Projects, Inc.
Cotton 4 Mineral Trust
Cotton 6 Mineral Trust
George E. Moss, Jr.
John K. Moss
Myra Ellen Moss
Roscoe Moss, III
Frank Jeppi Bi-Pass Trust
J & L Hauptman Family Partnership
Phillip Mandel
Louis Dorfman
Myron H. Dorfman
Singer Bros.
S&P Co., A Louisiana Partnership
Fleischaker Mineral Company, LLC
Teton Properties, LLC
S D Resources, Ltd.
A.G.S. Limited Partnership
Eculirra Oil & Gas, LLC

TRACT 54
T145N-R83W-Section 10:
SURFACE OWNERSHIP:
COAL OWNERSHIP:

SW¼
The Falkirk Mining Company
Pennington Living Trust Dated 4-28-99

TRACT 55
T145N-R83W-Section 10:
SURFACE OWNERSHIP:
COAL OWNERSHIP:

SE¼, less 2.55 ac. hwy.
The Falkirk Mining Company
MDR Landenberger Family Trust Dated 10-19-02

TRACT 56
T145N-R83W-Section 15:
SURFACE OWNERSHIP:
COAL OWNERSHIP:

NW¼
The Falkirk Mining Company
Barbara J. Hoffer
Eileen C. Zander
State of North Dakota – State Land Department

TRACT 57
T145N-R83W-Section 15:
SURFACE OWNERSHIP:
COAL OWNERSHIP:

NE¼, less tracts of 7.21 ac. and 5.75 ac.
The Falkirk Mining Company
Estate of George W. Swanson
State of North Dakota – State Land Department

TRACT 58
T145N-R83W-Section 15:
SURFACE OWNERSHIP:
COAL OWNERSHIP:

5.75 ac. in the NE¼
The Falkirk Mining Company
The Falkirk Mining Company
State of North Dakota – State Land Department

TRACT 59
T145N-R83W-Section 15:
SURFACE OWNERSHIP:
COAL OWNERSHIP:

7.21 ac. in the NE¼
The Falkirk Mining Company
George L. Swanson and Val Rae Swanson
State of North Dakota – State Land Department

TRACT 60
T145N-R83W-Section 15:
SURFACE OWNERSHIP:
COAL OWNERSHIP:

SW¼
The Falkirk Mining Company
MDR Landenberger Family Trust Dated 10-19-02
The Reserve Petroleum Company

TRACT 61
T145N-R83W-Section 15:
SURFACE OWNERSHIP:
COAL OWNERSHIP:

SE¼
The Falkirk Mining Company
The Reserve Petroleum Company
State of North Dakota – State Land Department

TRACT 62
T145N-R83W-Section 21:
SURFACE OWNERSHIP:
COAL OWNERSHIP:

SE¼
The Falkirk Mining Company
The Falkirk Mining Company

TRACT 63
T145N-R83W-Section 22:
SURFACE OWNERSHIP:
COAL OWNERSHIP:

NW¼
The Falkirk Mining Company
Estate of George W. Swanson
Estates of Carl H. Reimers and
Margaret A. Reimers
Darlene Ostboe
Michael Ranum
Mark Ranum
Andrew Ranum
Norm Ostboe and Darlene A. Ostboe
Denna L. Bloomquist
Gerald T. Woolworth
Patricia A. Reimers
Mary O. Reimers
Charlotte L. Potter
Gary B. Reimers
Ronald J. Stroh and Arlyce J. Stroh
Karen Louise Sorensen

TRACT 64
T145N-R83W-Section 22:
SURFACE OWNERSHIP:
COAL OWNERSHIP:

NE¼
The Falkirk Mining Company
Milton Saylor and Kathy Saylor
Marcia Walker, Life Estate
Remaindermen:
-John B. Walker
-Samuel C. Walker

TRACT 65 T145N-R83W-Section 22: SURFACE OWNERSHIP: COAL OWNERSHIP:	SW $\frac{1}{4}$, less 5 ac. in the SW corner and less the SE $\frac{1}{4}$ SE $\frac{1}{4}$ SW $\frac{1}{4}$ The Falkirk Mining Company Erma Carlson Marva Deane Finck Karen Carlson
TRACT 66 T145N-R83W-Section 22: SURFACE OWNERSHIP: COAL OWNERSHIP:	SE $\frac{1}{4}$ SE $\frac{1}{4}$ SW $\frac{1}{4}$, less 3.75 ac. The Falkirk Mining Company Erma Carlson Marva Deane Finck Karen Carlson
TRACT 66A T145N-R83W-Section 22: SURFACE OWNERSHIP: COAL OWNERSHIP:	3.75 ac. in the SE $\frac{1}{4}$ SE $\frac{1}{4}$ SW $\frac{1}{4}$ The Falkirk Mining Company The Falkirk Mining Company
TRACT 67 T145N-R83W-Section 22: SURFACE OWNERSHIP: COAL OWNERSHIP:	SE $\frac{1}{4}$, less the SW $\frac{1}{4}$ SW $\frac{1}{4}$ SE $\frac{1}{4}$ The Falkirk Mining Company Estate of George W. Swanson
TRACT 68 T145N-R83W-Section 22: SURFACE OWNERSHIP: COAL OWNERSHIP:	SW $\frac{1}{4}$ SW $\frac{1}{4}$ SE $\frac{1}{4}$ The Falkirk Mining Company Estate of George W. Swanson
TRACT 69 T145N-R83W-Section 28: SURFACE OWNERSHIP: COAL OWNERSHIP:	N $\frac{1}{2}$ NW $\frac{1}{4}$, W $\frac{1}{2}$ NE $\frac{1}{4}$ The Falkirk Mining Company Erma Carlson Marva D. Finck Karen J. Carlson
TRACT 70 T145N-R83W-Section 28: SURFACE OWNERSHIP: COAL OWNERSHIP:	E $\frac{1}{2}$ NE $\frac{1}{4}$ Marva Deane Finck Marva Deane Finck
TRACT 71 T145N-R83W-Section 28: SURFACE OWNERSHIP: COAL OWNERSHIP:	SW $\frac{1}{4}$, S $\frac{1}{2}$ NW $\frac{1}{4}$ Eileen C. Zander Eileen C. Zander Barbara J. Hoffer
TRACT 72 T145N-R83W-Section 28: SURFACE OWNERSHIP: COAL OWNERSHIP:	SE $\frac{1}{4}$ Dwight D. Gradin and Denise Gradin Dwight D. Gradin and Denise Gradin Miles W. Gradin Wallyn K. Lee Mark E. Gradin Kyle E. Gradin The Irene V. Johannes Revocable Living Trust Dated 5-15-96
TRACT 73 T145N-R83W-Section 27: SURFACE OWNERSHIP: COAL OWNERSHIP:	NW $\frac{1}{4}$ The Falkirk Mining Company Erma Carlson Estates of Carl H. Reimers and Margaret A. Reimers Darlene Ostboe Michael Ranum Mark Ranum Andrew Ranum Norm Ostboe and Darlene A. Ostboe Donna L. Bloomquist Gerald T. Woolworth Patricia A. Reimers Mary O. Reimers Charlotte L. Potter Gary B. Reimers Ronald J. Stroh and Arlyce J. Stroh Karen Louise Sorensen

TRACT 74
T145N-R83W-Section 27:
SURFACE OWNERSHIP:
COAL OWNERSHIP:

NE $\frac{1}{4}$
The Falkirk Mining Company
Erma Carlson

TRACT 75
T145N-R83W-Section 27:
SURFACE OWNERSHIP:
COAL OWNERSHIP:

SW $\frac{1}{4}$
The Falkirk Mining Company
Janice E. Hanson
Bonnie J. Kuntz

TRACT 76
T145N-R83W-Section 27:
SURFACE OWNERSHIP:
COAL OWNERSHIP:

SE $\frac{1}{4}$
The Falkirk Mining Company
Janice E. Hanson
Bonnie J. Kuntz

TRACT 77
T145N-R83W-Section 33:
SURFACE OWNERSHIP:
COAL OWNERSHIP:

NW $\frac{1}{4}$
Dwight D. Gradin and Denise Gradin
Dwight D. Gradin and Denise Gradin
Miles W. Gradin
Wallyn K. Lee
Mark E. Gradin
Kyle E. Gradin
The Irene V. Johannes Revocable Living Trust
Dated 5-15-96

TRACT 78
T145N-R83W-Section 33:
SURFACE OWNERSHIP:
COAL OWNERSHIP:

NE $\frac{1}{4}$
Dwight D. Gradin and Denise Gradin
Dwight D. Gradin and Denise Gradin
Miles W. Gradin
Wallyn K. Lee
Mark E. Gradin
Kyle E. Gradin
The Irene V. Johannes Revocable Living Trust
Dated 5-15-96

TRACT 79
T145N-R83W-Section 34:
SURFACE OWNERSHIP:
COAL OWNERSHIP:

NW $\frac{1}{4}$
Sharyn M. Calton
Sharyn M. Calton

TRACT 80
T145N-R83W-Section 34:
SURFACE OWNERSHIP:
COAL OWNERSHIP:

North 100 ac. of the NE $\frac{1}{4}$
The Falkirk Mining Company
Anne Carlson Center for Children
Home on the Range
Dakota Boys Ranch of Minot
Trinity Lutheran Church Foundation
Birka Country Church
First Lutheran Church
Melvin A. Christenson Revocable Trust
Darlene Roach

TRACT 81
T145N-R83W-Section 34:
SURFACE OWNERSHIP:
COAL OWNERSHIP:

South 60 ac. of the NE $\frac{1}{4}$
The Falkirk Mining Company
Anne Carlson Center for Children
Home on the Range
Dakota Boys Ranch of Minot
Trinity Lutheran Church Foundation
Birka Country Church
First Lutheran Church
Melvin A. Christenson Revocable Trust
Darlene Roach

TRACT 82
T145N-R83W-Section 34:
SURFACE OWNERSHIP:
Leidholm

SW¼
Mildred Leidholm, as Trustee of the Lloyd

Testamentary Trust
Roy B. Leidholm and Eva Leidholm, Life Estate

Remaindermen:

- Brian Leidholm
- Cordell Leidholm
- Glynda Janz
- Karen Perkerewicz
- Dean Leidholm
- Tammy Novak
- Sharon Rivers
- Dwayne Leidholm

Mildred Jahner and Valentine Jahner, Life Estate

Remaindermen:

- Curtis Jahner
- Brent Jahner

COAL OWNERSHIP:
Leidholm

Mildred Leidholm, as Trustee of the Lloyd

Testamentary Trust

Roy B. Leidholm and Eva Leidholm, Life Estate

Remaindermen:

- Brian Leidholm
- Cordell Leidholm
- Glynda Janz
- Karen Perkerewicz
- Dean Leidholm
- Tammy Novak
- Sharon Rivers
- Dwayne Leidholm

Mildred Jahner and Valentine Jahner, Life Estate

Remaindermen:

- Curtis Jahner
- Brent Jahner

TRACT 83
T145N-R83W-Section 34:
SURFACE OWNERSHIP:
COAL OWNERSHIP:

SE¼
The Falkirk Mining Company
Hazel Peterson, Life Estate

Remaindermen:

- James Peterson
- Dennis L. Peterson
- Duaine J. Peterson
- Jane Schulz
- Susan Krebsbach

State of North Dakota – State Land Department

TRACT 84
T145N-R83W-Section 35:
SURFACE OWNERSHIP:
COAL OWNERSHIP:

SW¼
Thomas W. Lindell and David A. Lindell
William F. Lindell and Patricia Lindell
Robert L. Erickson and Susan F. Lawrence

TRACT 85
T145N-R83W-Section 35:
SURFACE OWNERSHIP:
COAL OWNERSHIP:

SE¼
The Falkirk Mining Company
Barbara J. Hoffer
Elton C. Zander
Aina Nelson
Arvin Swanson
Marcia Steinwand
Rodney Swanson
Sheryl Willits

TRACT 86
T145N-R83W-Section 36:
SURFACE OWNERSHIP:
COAL OWNERSHIP:

SW¼
The Falkirk Mining Company
Hazel Peterson, Life Estate

Remaindermen:

- James Peterson
- Dennis L. Peterson
- Duaine J. Peterson
- Jane Schulz
- Susan Krebsbach

State of North Dakota – State Land Department

TRACT 87

T145N-R83W-Section 36:

SURFACE OWNERSHIP:

COAL OWNERSHIP:

SE ¼

The Falkirk Mining Company

State of North Dakota – State Land Department

Duaine J. Peterson and Deana R. Peterson

Hazel Peterson, Life Estate

Remaindermen:

-Duaine J. Peterson and Deana R. Peterson

Copies of the revision and renewal applications for surface coal mining Permit NAFK-9503 are available for public inspection at the offices of the North Dakota Public Service Commission, Capitol Building, Bismarck, North Dakota, and at the offices of the County Auditor, McLean County Courthouse, Washburn, North Dakota.

Written comments, objections, or requests for informal conferences on the application may be submitted by any person with an interest which is or may be adversely affected to the North Dakota Public Service Commission, Capitol Building, Bismarck, North Dakota, within 30 days after the last publication of this notice.

The Falkirk Mining Company
Diana Edinger, executive assistant

UN Jan. 13, 20, 27, Feb. 3, 2011

RECEIVED FEB 24 2011

AFFIDAVIT OF PUBLICATION

STATE OF NORTH DAKOTA)
)
COUNTY OF McLean)

I SHELLEY CHASE, being first duly sworn, on my own oath, say, that I am the bookkeeper of the Leader News, a weekly newspaper of general circulation, published in the city of Washburn, that the advertisement headed:

FALKIRK MINING CO LN-NOTICE OF FILING PERMIT RENEWAL/LEGAL

a printed copy of which is here annexed, was published in the regular and entire issue of said newspaper during the period and time of publication, and that the notice was published in the newspaper proper, and not in a supplement,

for 4 consecutive week 02/03/2011 to wit:

Column Inches 291.5	\$5.57	\$1,623.66	01/13/2011
Column Inches 291.5	\$5.57	\$1,623.66	01/20/2011
Column Inches 291.5	\$5.57	\$1,623.66	01/27/2011 ✓
Column Inches 291.5	\$5.57	\$1,623.66	02/03/2011 ✓

Notary Fee \$1.00 ✓ Total Cost of Legal \$6,495.64

Shelley Chase

Subscribed and sworn to before me this 9th day of February A.D. 2011.

(Seal) *Darla J Mautz*

Notary Public, State of North Dakota

My Commission Expires

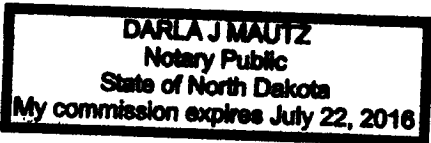

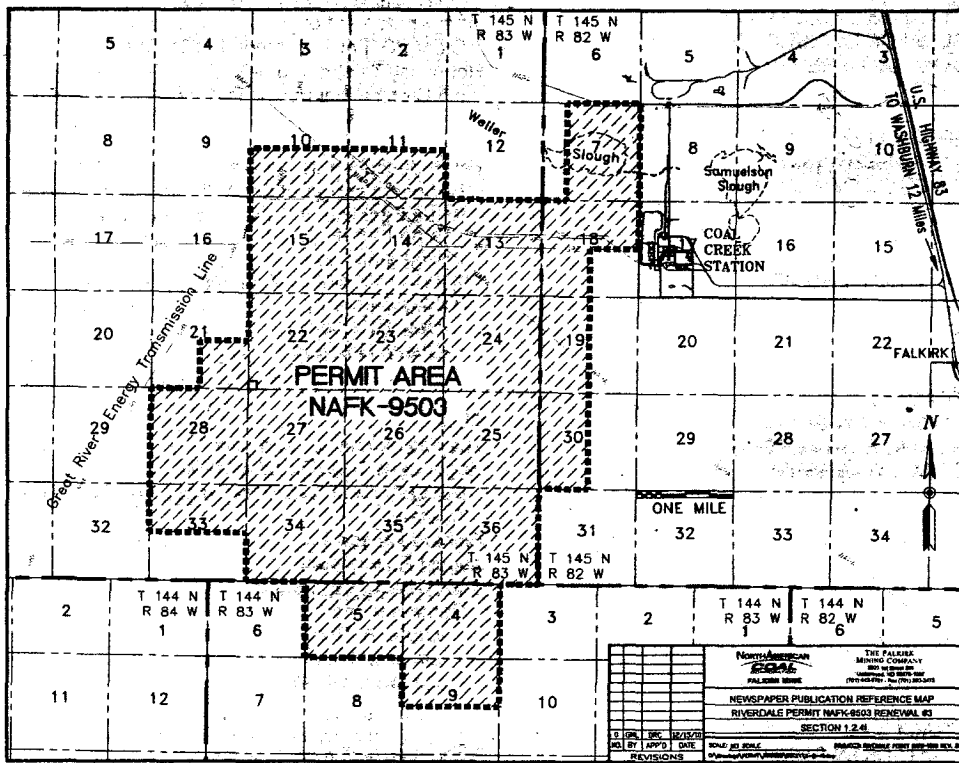

Notice of filing a permit renewal and revision to conduct surface coal mining operations

The Falkirk Mining Company, P.O. Box No. 1087, Underwood, North Dakota 58576-1087, as applicant, has filed renewal and revision applications for Surface Coal Mining Permit NAFK-9503, covering portions of Sections 7, 8, 18, 19, and 30, T145N, R82W and Sections 10, 11, 13, 14, 15, 21, 22, 23, 24, 25, 26, 27, 28, 33, 34, 35, and 36, T145N, R83W and Sections 4, 5, and 9, T144N, R83W in McLean County, North Dakota, which contains 12,386.4 acres. Renewal No. 3 to Permit NAFK-9503 will extend the permit term another five years until April 15, 2016. Revision No. 21 identifies the next five-year coal removal subarea and updates mining and reclamation plans and other information in the permit.

The permit area is located southwest of Underwood, North Dakota. The map shows the location of the City of Underwood, North Dakota, and the boundaries of the permit area. The names of The United States Geological Survey Quadrangle Map, which contains the area described and shown on the map, is "Washburn".

The owners of the surface and coal in the permit area are as follows:

TRACT 1

T145N-R82W- Section 7:
SURFACE OWNERSHIP:
COAL OWNERSHIP:

NE $\frac{1}{4}$, E $\frac{1}{2}$ NW $\frac{1}{4}$
The Falkirk Mining Company
Laverna Scheid
The Nokota Company
Linda Louise Schmidt,
Trustee of the Linda L. Schmidt
2007 Revocable Trust
Arthur V. Seay, III
Sidney Ray Lawler

TRACT 2

T145N-R82W-Section 7:
SURFACE OWNERSHIP:
COAL OWNERSHIP:

E $\frac{1}{2}$ SW $\frac{1}{4}$, SE $\frac{1}{4}$
The Falkirk Mining Company
LeRoy D. Traxel and Norma Traxel
The Nokota Company
Linda Louise Schmidt, Trustee of the Linda L. Schmidt
2007 Revocable Trust
Arthur V. Seay, III
Sidney Ray Lawler

TRACT 3

T145N-R82W-Section 8:

SURFACE OWNERSHIP:
COAL OWNERSHIP:

A triangular tract lying within the N $\frac{1}{2}$ NW $\frac{1}{4}$,
containing .4 acres, more or less
Great River Energy
Great River Energy

TRACT 4

T145N-R82W-Section 18:
SURFACE OWNERSHIP:
COAL OWNERSHIP:

NE $\frac{1}{4}$
The Falkirk Mining Company
Laurance L. Heger and Nancy L. Heger
Red Crown Royalties, LLC
Three Forks Oil Corporation
The Nokota Company

TRACT 5
T145N-R82W-Section 18
SURFACE OWNERSHIP:
COAL OWNERSHIP:

E½ of Lot 1, Lot 2, E½NW¼
The Falkirk Mining Company
Laurance L. Heger and Nancy L. Heger
Red Crown Royalties, LLC
Three Forks Oil Corporation
The Nokota Company

TRACT 6
T145N-R82W-Section 18:
SURFACE OWNERSHIP:
COAL OWNERSHIP:

W½ of Lot 1
The Falkirk Mining Company
Laurance L. Heger and Nancy L. Heger
Red Crown Royalties, LLC
Three Forks Oil Corporation
The Nokota Company

TRACT 7
T145N-R82W-Section 18:
SURFACE OWNERSHIP:
COAL OWNERSHIP:

Lots 3, 4, E½SW¼
The Falkirk Mining Company
United States of America –
Bureau of Land Management

TRACT 8
T145N-R82W-Section 19:
SURFACE OWNERSHIP:
COAL OWNERSHIP:

Lots 1, 2, E½NW¼
The Falkirk Mining Company
John C. Samuelson
Loren F. Gradin

TRACT 9
T145N-R82W-Section 19:
SURFACE OWNERSHIP:
COAL OWNERSHIP:

Lots 3, 4, E½SW¼
The Falkirk Mining Company
Janet Steckler
Lucille Gardella
Maurice Heger and Ione Heger
Loren F. Gradin

TRACT 10
T145N-R82W-Section 30:
SURFACE OWNERSHIP:
COAL OWNERSHIP:

Lots 1, 2, E½NW¼
The Falkirk Mining Company
Marian Reinhardt
State of North Dakota – State Land Department

TRACT 11
T145N-R82W-Section 30:
SURFACE OWNERSHIP:

Lots 3, 4, E½SW¼
Roger O. Peterson, Life Estate
Remaindermen:
-Neal Peterson
-Cheryl Gillespie
COAL OWNERSHIP:
Roger O. Peterson, Life Estate
Remaindermen:
-Neal Peterson
-Cheryl Gillespie

TRACT 12
T145N-R83W-Section 13:
SURFACE OWNERSHIP:
COAL OWNERSHIP:

SE¼
The Falkirk Mining Company
Heger Land Trust Dated 4-30-08,
Deborah Siem, Laurance Heger, and Carl Heger,
Trustees
Richard Ernsdorf
August R. Johnson
Jean Neville, Life Estate
Remaindermen:
-Laurel A. Ross
-Linda J. Dillon
-Robert L. Neville

TRACT 13
T145N-R83W-Section 24:
SURFACE OWNERSHIP:
COAL OWNERSHIP:

NE¼, less Outlot A
The Falkirk Mining Company
Barbara Lee Jones

TRACT 14
T145N-R83W-Section 24:

Outlot A of the NE¼, described as follows:

Beginning at a point that is located 1484.0 feet South of the northeast corner of Section 24, thence West and parallel with the North section line a distance of 1972.0 feet to a point, thence North and parallel with the East section line a distance of 492.0 feet, thence West and parallel with the North section line a distance of 668.0 feet to the quarter section line, thence South along the quarter section line a distance of 918.0 feet, thence East and parallel with the North section line a distance of 668.0 feet, thence North and parallel with the East section line a distance of 226.0 feet, thence East and parallel with the North section line a distance of 1972.0 feet to the East section line of Section 24, thence North along the East section line a distance of 200 feet to the point of beginning. Containing 23.14 acres, more or less.

SURFACE OWNERSHIP:
COAL OWNERSHIP:

The Falkirk Mining Company
Randy Van Asperen
Barbara Lee Jones
Bruce Allen Gradin

TRACT 15 T145N-R83W-Section 24: SURFACE OWNERSHIP: COAL OWNERSHIP:	NW¼ The Falkirk Mining Company Michael Berg Barbara Lee Jones Bruce Allen Gradin
TRACT 16 T145N-R83W-Section 24: SURFACE OWNERSHIP: COAL OWNERSHIP:	SW¼ The Falkirk Mining Company Barbara Lee Jones Bruce Allen Gradin
TRACT 17 T145N-R83W-Section 24: SURFACE OWNERSHIP: COAL OWNERSHIP:	SE¼ The Falkirk Mining Company Carol J. Reinhiller and Thomas R. Reinhiller Joy M. Ochsner and Gary L. Ochsner Judith K. Simpfinderfer and Jerome D. Simpfinderfer Sylvia Thompson
TRACT 18 T145N-R83W-Section 25: SURFACE OWNERSHIP: COAL OWNERSHIP:	NE¼ The Falkirk Mining Company John C. Samuelson and Helen K. Samuelson Shaun Stewart Erica LeFevers Chris Stewart Brett Stewart Sarah LeFevers
TRACT 19 T145N-R83W-Section 25: SURFACE OWNERSHIP: COAL OWNERSHIP:	NW¼ The Falkirk Mining Company Rita McCreary and Edward McCreary William Frederick Lindell and Patricia Lindell
TRACT 20 T145N-R83W-Section 25: SURFACE OWNERSHIP: COAL OWNERSHIP:	SW¼ The Falkirk Mining Company Jeffrey G. Culver Harry W. Samuelson, Jr., as Trustee of the Harry W. Samuelson, Jr. Revocable Trust Lois Samuelson, as Trustee of the Lois Samuelson Revocable Trust
TRACT 21 T145N-R83W-Section 25: SURFACE OWNERSHIP: COAL OWNERSHIP:	SE¼ The Falkirk Mining Company John C. Samuelson and Helen K. Samuelson Dorothy E. Samuelson
TRACT 22 T145N-R83W-Section 36: SURFACE OWNERSHIP: COAL OWNERSHIP:	NE¼ The Falkirk Mining Company State of North Dakota – State Land Department Carol Adams Sharon Huber Donald Bender Paul J. Bender Brenda Dietrich Marlin Bender Merlin Bender LeRoy Bender The Estate of Elmer Bender Dean Bender Rayland Bender Trent Bender Nanette Aragon Hope Witte
TRACT 23 T145N-R83W-Section 36: SURFACE OWNERSHIP: COAL OWNERSHIP:	NW¼ The Falkirk Mining Company Carol J. Reinhiller and Thomas R. Reinhiller Joy M. Ochsner and Gary L. Ochsner Judith K. Simpfinderfer and Jerome D. Simpfinderfer Sylvia Thompson State of North Dakota – State Land Department

TRACT 24
T145N-R83W-Section 13:
SURFACE OWNERSHIP:
COAL OWNERSHIP:

SW¼
The Falkirk Mining Company
AgriBank, FCB
Adele C. Saylor
Myldred Swanson
Myrtle Breeding
Stanley E. Saylor, Sr.
Norma J. Schacher
Linda G. Hoerner
Elizabeth Reiland

TRACT 25
T145N-R83W-Section 11:
SURFACE OWNERSHIP:
COAL OWNERSHIP:

SW¼
The Falkirk Mining Company
Arnold J. Schafer and Gretchen M. Schafer,
Life Estate
Remaindermen:
-Mary Schafer Conlon
-Macy J. Schafer
-Marty J. Schafer
-Monty R. Schafer
AgriBank, FCB

TRACT 26
T145N-R83W-Section 11:
SURFACE OWNERSHIP:
COAL OWNERSHIP:

SE¼
The Falkirk Mining Company
Adele Saylor
Myrtle Breeding
Elizabeth Reiland
Stanley E. Saylor, Sr.
Norma J. Schacher
Linda G. Hoerner

TRACT 27
T145N-R83W-Section 13:
SURFACE OWNERSHIP:
COAL OWNERSHIP:

NE¼
The Falkirk Mining Company
Heger Land Trust Dated 4-30-08,
Deborah Siem, Laurance Heger, and Carl Heger,
Trustees
State of North Dakota – State Land Department
The Nokota Company
Three Forks Oil Corporation
Red Crown Royalties, LLC

TRACT 28
T145N-R83W-Section 13:
SURFACE OWNERSHIP:
COAL OWNERSHIP:

NW¼
The Falkirk Mining Company
The Ervin R. Schafer Revocable Trust
Dated 10-10-89
W. L. Braun Oil Properties Revocable Trust
Dated 10-22-98
Laverna McKelvy
The Estate of Donald D. Schafer
The Falkirk Mining Company

TRACT 29
T145N-R83W-Section 14:
SURFACE OWNERSHIP:
COAL OWNERSHIP:

NE¼
The Falkirk Mining Company
The Ervin R. Schafer Revocable Trust
Dated 10-10-89

TRACT 30
T145N-R83W-Section 14:
SURFACE OWNERSHIP:
COAL OWNERSHIP:

NW¼
The Falkirk Mining Company
The Adeline L. Schafer Revocable Trust
Dated 10-10-89

TRACT 31
T145N-R83W-Section 14:
SURFACE OWNERSHIP:
COAL OWNERSHIP:

SW¼
The Falkirk Mining Company
Richard Ernsdorf
The Nokota Company
Three Forks Oil Corporation
The Falkirk Mining Company

TRACT 32
T145N-R83W-Section 14:
SURFACE OWNERSHIP:
COAL OWNERSHIP:

SE¼
The Falkirk Mining Company
August R. Johnson
The Nokota Company
Three Forks Oil Corporation
The Falkirk Mining Company

TRACT 33
T145N-R83W-Section 23:
SURFACE OWNERSHIP: E½
COAL OWNERSHIP: The Falkirk Mining Company
Rita McCreary and Edward McCreary
William Frederick Lindell and Patricia Lindell

TRACT 34
T145N-R83W-Section 23:
SURFACE OWNERSHIP: NW¼
COAL OWNERSHIP: The Falkirk Mining Company
Terry Ollenburger
Audrey Schubarth
Jane Ollenburger
Monte Ollenburger

TRACT 35
T145N-R83W-Section 23:
SURFACE OWNERSHIP: SW¼
COAL OWNERSHIP: The Falkirk Mining Company
Barbara J. Hoffer
Eileen C. Zander

TRACT 36
T145N-R83W-Section 26:
SURFACE OWNERSHIP: NE¼
COAL OWNERSHIP: William Frederick Lindell and Patricia Lindell
William Frederick Lindell and Patricia Lindell
Rita McCreary and Edward McCreary

TRACT 37
T145N-R83W-Section 26:
SURFACE OWNERSHIP: NW¼
COAL OWNERSHIP: The Falkirk Mining Company
William Frederick Lindell and Patricia Lindell
Rita McCreary and Edward McCreary

TRACT 38
T145N-R83W-Section 26:
SURFACE OWNERSHIP: SW¼
COAL OWNERSHIP: The Falkirk Mining Company
Anne Carlsen Center for Children
Home on the Range
Dakota Boys Ranch of Minot
Trinity Lutheran Church Foundation
Birka Country Church
First Lutheran Church
Melvin A. Christenson Revocable Trust
Darlene Roach

TRACT 39
T145N-R83W-Section 26:
SURFACE OWNERSHIP: SE¼
COAL OWNERSHIP: The Falkirk Mining Company
William Frederick Lindell and Patricia Lindell
Rita McCreary and Edward McCreary

TRACT 40
T145N-R83W-Section 35:
SURFACE OWNERSHIP: NE¼
COAL OWNERSHIP: The Falkirk Mining Company
The Falkirk Mining Company

TRACT 41
T145N-R83W-Section 35:
SURFACE OWNERSHIP: W½NW¼
COAL OWNERSHIP: The Falkirk Mining Company
Anne Carlsen Center for Children
Home on the Range
Dakota Boys Ranch of Minot
Trinity Lutheran Church Foundation
Birka Country Church
First Lutheran Church
Melvin A. Christenson Revocable Trust
Darlene Roach

TRACT 42
T145N-R83W-Section 35:
SURFACE OWNERSHIP: E½NW¼
COAL OWNERSHIP: The Falkirk Mining Company
Estate of George W. Swanson

TRACT 43
T144N-R83W-Section 4:

SURFACE OWNERSHIP:
COAL OWNERSHIP:

Lots 1, 2, 3, 4,
less the south 40 rods of Lots 1 and 2
The Falkirk Mining Company
Ernest E. Slagg, Life Estate
Remaindermen:
-George L. Swanson and Val Rae Swanson

Adeline M. Slagg
Elda Ann Baisch
Marilyn Slagg
Kevin Slagg
Wayne Slagg
Julie Slagg
Steven W. Slagg
Miles J. Slagg
Marsha F. Slagg
Carolyn Currier
Jerald Slagg
Connie Jo Hill
Val Rae Swanson

TRACT 44
T144N-R83W-Section 4:
SURFACE OWNERSHIP:
COAL OWNERSHIP:

The south 40 rods of Lots 1 and 2
The Falkirk Mining Company
State of North Dakota - State Land Department
Adeline M. Slagg
Elda Ann Baisch
Marilyn Slagg
Kevin Slagg
Wayne Slagg
Julie Slagg
Steven W. Slagg
Miles J. Slagg
Marsha F. Slagg
Carolyn Currier
Jerald Slagg
Connie Jo Hill
Val Rae Swanson

TRACT 45
T144N-R83W-Section 4:
SURFACE OWNERSHIP:
COAL OWNERSHIP:

SW $\frac{1}{4}$
The Falkirk Mining Company
Gertrude E. Burck
Cleo Kersey
Kitty Tweeten

TRACT 46
T144N-R83W-Section 4:
SURFACE OWNERSHIP:
COAL OWNERSHIP:

SE $\frac{1}{4}$
The Falkirk Mining Company
State of North Dakota - State Land Department
Elda Ann Baisch
Carolyn S. Currier and Arch N. Currier
Steven W. Slagg
Miles J. Slagg
Marsha F. Slagg
Val Rae Swanson
Jerald A. Slagg
Connie Jo Hill
Adeline M. Slagg
Marilyn Slagg
Kevin Slagg
Wayne Slagg
Julie Slagg

TRACT 47
T144N-R83W-Section 5:
SURFACE OWNERSHIP:
COAL OWNERSHIP:

Lots 3 and 4
Milton L. Holznagel Revocable Trust Dated 1-9-95
Milton L. Holznagel Revocable Trust Dated 1-9-95

TRACT 48
T144N-R83W-Section 5:
SURFACE OWNERSHIP:

Lots 1 and 2
Roger Peterson, Life Estate
Remaindermen:

COAL OWNERSHIP:

-Neal Peterson
-Cheryl Gillespie
Roger Peterson, Life Estate
Remaindermen:
-Neal Peterson
-Cheryl Gillespie

TRACT 49
T144N-R83W-Section 5: SW¼, less an 8 ac. tract in the SE¼SW¼
SURFACE OWNERSHIP: Milton L. Holznagel Revocable Trust Dated 1-9-95
COAL OWNERSHIP: Milton L. Holznagel Revocable Trust Dated 1-9-95

TRACT 50
T144N-R83W-Section 5: an 8 ac. tract in the SE¼SW¼
SURFACE OWNERSHIP: The Falkirk Mining Company
COAL OWNERSHIP: The Falkirk Mining Company

TRACT 51
T144N-R83W-Section 5: SE¼
SURFACE OWNERSHIP: Roger Peterson, Life Estate
Remaindermen:
- Neal Peterson
- Cheryl Gillespie
COAL OWNERSHIP: Roger Peterson, Life Estate
Remaindermen:
- Neal Peterson
- Cheryl Gillespie

TRACT 52
T144N-R83W-Section 9: NW¼
SURFACE OWNERSHIP: The Falkirk Mining Company
COAL OWNERSHIP: Martys D. Allen and Lisa E. Allen
April Azar
Jana J. Azar
WLK Resources, LLC
Fred S. Wright, Jr.
Nancy Elizabeth Brooks
Mary Evelyn King
Dana Denise Wright
Major David L. Wright
Thomas Russell Wright, Jr.
Fred S. Wright, Jr.,
Trustee of the Fred S. Wright, Jr.
Trust
Plains Exploration & Production Company
Henry Lerman
Irving Lerner
Linda Petroleum Co.
Williston Projects, Inc.
Cotton 4 Mineral Trust
Cotton 6 Mineral Trust
George E. Moss, Jr.
John K. Moss
Myra Ellen Moss
Roscoe Moss, III
Frank Jeppi Bi-Pass Trust
J & L Hauptman Family Partnership
Phillip Mandel
Louis Dorfman
Myron H. Dorfman
Singer Bros.
S&P Co., A Louisiana Partnership
Fleischaker Mineral Company, LLC
Teton Properties, LLC
S D Resources, Ltd.
A.G.S. Limited Partnership
Eculirra Oil & Gas, LLC

TRACT 53
T144N-R83W-Section 9:
SURFACE OWNERSHIP:
COAL OWNERSHIP:

NE $\frac{1}{4}$
The Falkirk Mining Company
State of North Dakota – State Land Department
April Azar
Jana J. Azar
WLK Resources, LLC
Fred S. Wright, Jr.
Nancy Elizabeth Brooks
Mary Evelyn King
Dana Denise Wright
Major David L. Wright
Thomas Russell Wright, Jr.
Fred S. Wright, Jr.,
Trustee of the Fred S. Wright, Jr.
Trust
Plains Exploration & Production Company
Henry Lerman
Irving Lerner
Linda Petroleum Co.
Williston Projects, Inc.
Cotton 4 Mineral Trust
Cotton 6 Mineral Trust
George E. Moss, Jr.
John K. Moss
Myra Ellen Moss
Roscoe Moss, III
Frank Jeppi Bi-Pass Trust
J & L Hauptman Family Partnership
Phillip Mandel
Louis Dorfman
Myron H. Dorfman
Singer Bros.
S&P Co., A Louisiana Partnership
Fleischaker Mineral Company, LLC
Teton Properties, LLC
S D Resources, Ltd.
A.G.S. Limited Partnership
Eculirra Oil & Gas, LLC

TRACT 54
T145N-R83W-Section 10:
SURFACE OWNERSHIP:
COAL OWNERSHIP:

SW $\frac{1}{4}$
The Falkirk Mining Company
Pennington Living Trust Dated 4-28-99

TRACT 55
T145N-R83W-Section 10:
SURFACE OWNERSHIP:
COAL OWNERSHIP:

SE $\frac{1}{4}$, less 2.55 ac. hwy.
The Falkirk Mining Company
MDR Landenberger Family Trust Dated 10-19-02

TRACT 56
T145N-R83W-Section 15:
SURFACE OWNERSHIP:
COAL OWNERSHIP:

NW $\frac{1}{4}$
The Falkirk Mining Company
Barbara J. Hoffer
Eileen C. Zander
State of North Dakota – State Land Department

TRACT 57
T145N-R83W-Section 15:
SURFACE OWNERSHIP:
COAL OWNERSHIP:

NE $\frac{1}{4}$, less tracts of 7.21 ac. and 5.75 ac.
The Falkirk Mining Company
Estate of George W. Swanson
State of North Dakota – State Land Department

TRACT 58
T145N-R83W-Section 15:
SURFACE OWNERSHIP:
COAL OWNERSHIP:

5.75 ac. in the NE $\frac{1}{4}$
The Falkirk Mining Company
The Falkirk Mining Company
State of North Dakota – State Land Department

TRACT 59
T145N-R83W-Section 15:
SURFACE OWNERSHIP:
COAL OWNERSHIP:

7.21 ac. in the NE $\frac{1}{4}$
The Falkirk Mining Company
George L. Swanson and Val Rae Swanson
State of North Dakota – State Land Department

TRACT 60
T145N-R83W-Section 15:
SURFACE OWNERSHIP:
COAL OWNERSHIP:

SW $\frac{1}{4}$
The Falkirk Mining Company
MDR Landenberger Family Trust Dated 10-19-02
The Reserve Petroleum Company

TRACT 61 T145N-R83W-Section 15: SURFACE OWNERSHIP: COAL OWNERSHIP:	SE $\frac{1}{4}$ The Falkirk Mining Company The Reserve Petroleum Company State of North Dakota – State Land Department
TRACT 62 T145N-R83W-Section 21: SURFACE OWNERSHIP: COAL OWNERSHIP:	SE $\frac{1}{4}$ The Falkirk Mining Company The Falkirk Mining Company
TRACT 63 T145N-R83W-Section 22: SURFACE OWNERSHIP: COAL OWNERSHIP:	NW $\frac{1}{4}$ The Falkirk Mining Company Estate of George W. Swanson Estates of Carl H. Reimers and Margaret A. Reimers Darlene Ostboe Michael Ranum Mark Ranum Andrew Ranum Norm Ostboe and Darlene A. Ostboe Donna L. Bloomquist Gerald T. Woolworth Patricia A. Reimers Mary O. Reimers Charlotte L. Potter Gary B. Reimers Ronald J. Stroh and Arlyce J. Stroh Karen Louise Sorensen
TRACT 64 T145N-R83W-Section 22: SURFACE OWNERSHIP: COAL OWNERSHIP:	NE $\frac{1}{4}$ The Falkirk Mining Company Milton Sayler and Kathy Sayler Marcia Walker, Life Estate Remaindermen: -John B. Walker -Samuel C. Walker
TRACT 65 T145N-R83W-Section 22: SURFACE OWNERSHIP: COAL OWNERSHIP:	SW $\frac{1}{4}$, less 5 ac. in the SW corner and less the SE $\frac{1}{4}$ SE $\frac{1}{4}$ SW $\frac{1}{4}$ The Falkirk Mining Company Erma Carlson Marva Deane Finck Karen Carlson
TRACT 66 T145N-R83W-Section 22: SURFACE OWNERSHIP: COAL OWNERSHIP:	SE $\frac{1}{4}$ SE $\frac{1}{4}$ SW $\frac{1}{4}$, less 3.75 ac. The Falkirk Mining Company Erma Carlson Marva Deane Finck Karen Carlson
TRACT 66A T145N-R83W-Section 22: SURFACE OWNERSHIP: COAL OWNERSHIP:	3.75 ac. in the SE $\frac{1}{4}$ SE $\frac{1}{4}$ SW $\frac{1}{4}$ The Falkirk Mining Company The Falkirk Mining Company
TRACT 67 T145N-R83W-Section 22: SURFACE OWNERSHIP: COAL OWNERSHIP:	SE $\frac{1}{4}$, less the SW $\frac{1}{4}$ SW $\frac{1}{4}$ SE $\frac{1}{4}$ The Falkirk Mining Company Estate of George W. Swanson
TRACT 68 T145N-R83W-Section 22: SURFACE OWNERSHIP: COAL OWNERSHIP:	SW $\frac{1}{4}$ SW $\frac{1}{4}$ SE $\frac{1}{4}$ The Falkirk Mining Company Estate of George W. Swanson
TRACT 69 T145N-R83W-Section 28: SURFACE OWNERSHIP: COAL OWNERSHIP:	N $\frac{1}{2}$ NW $\frac{1}{4}$, W $\frac{1}{2}$ NE $\frac{1}{4}$ The Falkirk Mining Company Erma Carlson Marva D. Finck Karen J. Carlson
TRACT 70 T145N-R83W-Section 28: SURFACE OWNERSHIP: COAL OWNERSHIP:	E $\frac{1}{2}$ NE $\frac{1}{4}$ Marva Deane Finck Marva Deane Finck

TRACT 71
T145N-R83W-Section 28:
SURFACE OWNERSHIP:
COAL OWNERSHIP:

SW¼, S½NW¼
Eileen C. Zander
Eileen C. Zander
Barbara J. Hoffer

TRACT 72
T145N-R83W-Section 28:
SURFACE OWNERSHIP:
COAL OWNERSHIP:

SE¼
Dwight D. Gradin and Denise Gradin
Dwight D. Gradin and Denise Gradin
Miles W. Gradin
Wallyn K. Lee
Mark E. Gradin
Kyle E. Gradin
The Irene V. Johannes Revocable
Living Trust Dated 5-15-96

TRACT 73
T145N-R83W-Section 27:
SURFACE OWNERSHIP:
COAL OWNERSHIP:

NW¼
The Falkirk Mining Company
Erma Carlson
Estates of Carl H. Reimers and
Margaret A. Reimers
Darlene Ostboe
Michael Ranum
Mark Ranum
Andrew Ranum
Norm Ostboe and Darlene A. Ostboe
Donna L. Bloomquist
Gerald T. Woolworth
Patricia A. Reimers
Mary O. Reimers
Charlotte L. Potter
Gary B. Reimers
Ronald J. Stroh and Arlyce J. Stroh
Karen Louise Sorensen

TRACT 74
T145N-R83W-Section 27:
SURFACE OWNERSHIP:
COAL OWNERSHIP:

NE¼
The Falkirk Mining Company
Erma Carlson

TRACT 75
T145N-R83W-Section 27:
SURFACE OWNERSHIP:
COAL OWNERSHIP:

SW¼
The Falkirk Mining Company
Janice E. Hanson
Bonnie J. Kuntz

TRACT 76
T145N-R83W-Section 27:
SURFACE OWNERSHIP:
COAL OWNERSHIP:

SE¼
The Falkirk Mining Company
Janice E. Hanson
Bonnie J. Kuntz

TRACT 77
T145N-R83W-Section 33:
SURFACE OWNERSHIP:
COAL OWNERSHIP:

NW¼
Dwight D. Gradin and Denise Gradin
Dwight D. Gradin and Denise Gradin
Miles W. Gradin
Wallyn K. Lee
Mark E. Gradin
Kyle E. Gradin
The Irene V. Johannes Revocable Living Trust
Dated 5-15-96

TRACT 78
T145N-R83W-Section 33:
SURFACE OWNERSHIP:
COAL OWNERSHIP:

NE¼
Dwight D. Gradin and Denise Gradin
Dwight D. Gradin and Denise Gradin
Miles W. Gradin
Wallyn K. Lee
Mark E. Gradin
Kyle E. Gradin
The Irene V. Johannes Revocable Living Trust
Dated 5-15-96

TRACT 79
T145N-R83W-Section 34:
SURFACE OWNERSHIP:
COAL OWNERSHIP:

NW¼
Sharyn M. Calton
Sharyn M. Calton

TRACT 80
T145N-R83W-Section 34:
SURFACE OWNERSHIP:
COAL OWNERSHIP:

North 100 ac. of the NE¼
The Falkirk Mining Company
Anne Carlsen Center for Children
Home on the Range
Dakota Boys Ranch of Minot
Trinity Lutheran Church Foundation
Birka Country Church
First Lutheran Church
Melvin A. Christenson Revocable Trust
Darlene Roach

TRACT 81
T145N-R83W-Section 34:
SURFACE OWNERSHIP:
COAL OWNERSHIP:

South 60 ac. of the NE¼
The Falkirk Mining Company
Anne Carlsen Center for Children
Home on the Range
Dakota Boys Ranch of Minot
Trinity Lutheran Church Foundation
Birka Country Church
First Lutheran Church
Melvin A. Christenson Revocable Trust
Darlene Roach

TRACT 82
T145N-R83W-Section 34:
SURFACE OWNERSHIP:

SW¼
Mildred Leidholm, as Trustee of the Lloyd Leidholm
Testamentary Trust

Roy B. Leidholm and Eva Leidholm, Life Estate

Remaindermen:

-Brian Leidholm

-Cordell Leidholm

-Glynda Janz

-Karen Perkerewicz

-Dean Leidholm

-Tammy Novak

-Sharon Rivers

-Dwayne Leidholm

Mildred Jahner and Valentine Jahner, Life Estate

Remaindermen:

-Curtis Jahner

-Brent Jahner

COAL OWNERSHIP:

Mildred Leidholm, as Trustee of the Lloyd Leidholm
Testamentary Trust

Roy B. Leidholm and Eva Leidholm, Life Estate

Remaindermen:

-Brian Leidholm

-Cordell Leidholm

-Glynda Janz

-Karen Perkerewicz

-Dean Leidholm

-Tammy Novak

-Sharon Rivers

-Dwayne Leidholm

Mildred Jahner and Valentine Jahner, Life Estate

Remaindermen:

-Curtis Jahner

-Brent Jahner

TRACT 83
T145N-R83W-Section 34:
SURFACE OWNERSHIP:
COAL OWNERSHIP:

SE¼
The Falkirk Mining Company
Hazel Peterson, Life Estate
Remaindermen:

-James Peterson

-Dennis L. Peterson

-Duaine J. Peterson

-Jane Schulz

-Susan Krebsbach

State of North Dakota – State Land Department

TRACT 84
T145N-R83W-Section 35:
SURFACE OWNERSHIP:
COAL OWNERSHIP:

SW¼
Thomas W. Lindell and David A. Lindell
William F. Lindell and Patricia Lindell
Robert L. Erickson and Susan F. Lawrence

TRACT 85
T145N-R83W-Section 35:
SURFACE OWNERSHIP:
COAL OWNERSHIP:

SE¼
The Falkirk Mining Company
Barbara J. Hoffer
Eileen C. Zander
Alma Nelson
Arvin Swanson
Marcia Steinwand
Rodney Swanson
Sheryl Willits

TRACT 86
T145N-R83W-Section 36:
SURFACE OWNERSHIP:
COAL OWNERSHIP:

SW¼
The Falkirk Mining Company
Hazel Peterson, Life Estate
Remaindermen:
-James Peterson
-Dennis L. Peterson
-Duaine J. Peterson
-Jane Schutz
-Susan Krebsbach
-State of North Dakota - State Land Department

TRACT 87
T145N-R83W-Section 36:
SURFACE OWNERSHIP:
COAL OWNERSHIP:

SE¼
The Falkirk Mining Company
State of North Dakota - State Land Department
Duaine J. Peterson and Deana R. Peterson
Hazel Peterson, Life Estate
Remaindermen:
-Duaine J. Peterson and Deana R. Peterson

Copies of the revision and renewal applications for surface coal mining Permit NAFK-9503 are available for public inspection at the offices of the North Dakota Public Service Commission, Capitol Building, Bismarck, North Dakota, and at the offices of the County Auditor, McLean County Courthouse, Washburn, North Dakota.

Written comments, objections, or requests for informal conferences on the application may be submitted by any person with an interest which is or may be adversely affected to the North Dakota Public Service Commission, Capitol Building, Bismarck, North Dakota, within 30 days after the last publication of this notice.

The Falkirk Mining Company
Diana Edinger, executive assistant

LN Jan. 13, 20, 27, Feb. 3, 2011