

The Bismarck  
**Tribune**  
www.bismarcktribune.com

The  
**Finder**

**Classified  
Advertising  
Invoice**

**Bismarck Tribune**

PO BOX 4001  
LaCrosse, WI 54602-4001  
In State 701-250-8218  
Toll free 800-472-2273

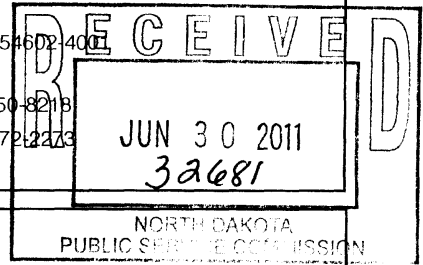

DAKOTA WESTMORELAND  
  
PO BOX 39  
BEULAH ND 58523-0039

Customer: 60007152  
Phone: (701) 873-4333  
Date: 06/02/2011

**CREDIT CARD PAYMENT (circle one)**



Card #: \_\_\_\_\_  
Exp Date: \_\_\_\_\_  
Signature: \_\_\_\_\_  
Credit card users: Fax to 701-223-6584

Cash Amt \_\_\_\_\_

PLEASE DETACH AND RETURN TOP PORTION WITH YOUR PAYMENT

Date	Date	Times Run	Description	Lines	Class Code	Order Amt	Net Amt Due
05/12/11	06/02/11	4	606728/Mercer County Bismarck Tribune	222.00	Legals	1,764.00	1,764.00

**Affidavit of Publication**  
State of North Dakota ) SS County of Burleigh  
Before me, a Notary Public for the State of North Dakota  
personally appeared CK who being duly sworn, deposes  
and says that he (she) is the Clerk of Bismarck Tribune Co.,  
and that the publication(s) were made through the  
Bismarck Tribune on the following dates:  
5/12, 19, 26, 6/2 Signed Carmey Kuntz  
sworn and subscribed to before me this 7th  
day of JUNE 2011  
Notary Public in and for the State of North Dakota

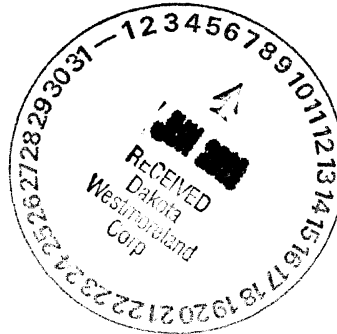

*Paula T. Gora*  
6-9-11

**GREGORY P. ZIEGLER**  
Notary Public  
State of North Dakota  
My Commission Expires July 22, 2015

Please return invoice or put order number on check. Thank You.

Remarks	Total Due: 1,764.00
---------	---------------------

**Bismarck Tribune**  
www.bismarcktribune.com  
PO BOX 4001  
LaCrosse, WI 54602-4001

Terms: PAYMENT IS DUE UPON RECEIPT OF INVOICE

# STATEMENT



91 N. Main Street • P.O. Box 309  
Garrison, ND 58540  
(701) 463-2201



DAKOTA WESTMORELAND  
PO BOX 39  
BEULAH ND 58523-0039



Dept. Code

BH-Beulah Beacon	MC-McClusky Gazette
CR-Center Republican	VL-Velva Area Voice
DS-Coal Country Dollar Saver	NT-New Town News
GR-McLean County Independent	PR-Mountrail County Recorder
HZ-Hazen Star	NS-Northern Sentry
LN-Leader News	UN-Underwood News
TL-McLean County Journal	XT- XTRA

www.bhgnews.com/paybills

Account No.	Date
1499	05/24/11
\$ _____	
Amount Remitted	

Please Detach and Return Top Portion With Your Payment

A late charge of 1 3/4% will be assessed on unpaid charges more than one month old.

DATE	DESCRIPTION	CHARGES	
04/28/2011	BH-80" PTO CARNIVAL/KITE FLY MAY SIG AD	\$9.00	TS
05/19/2011	BH-160" RECOGNIZING THE MUSIC AD/QUOTE	\$100.00	TS
05/19/2011	HZ-R24 PUBLIC NOTICE W/MAP/LEGAL	\$250.65	TS
05/19/2011	CR-R24 PUBLIC NOTICE/MAP/LEGAL	\$250.65	TS

*Handwritten notes:*  
 Renewal # 5  
 Revision # 24  
 KR5B-8603  
 dia  
 pig 5-31-11

BHG, Inc. P.O. Box 309, Garrison, ND 58540

PAYMENT RECEIVED \$317.68

FINANCE CHARGE \$0.00

CURRENT	30 DAYS	60 DAYS	90 DAYS	BALANCE
\$610.30	\$0.00	\$0.00	\$0.00	\$610.30

**NOTICE OF APPLICATION  
FOR REVISION and RENEWAL TO A SURFACE COAL MINE PERMIT**

Please take notice that Dakota Westmoreland Corporation, PO Box 39, Beulah, North Dakota 58523, has made application to the North Dakota Public Service Commission for Revision No. 24 and Renewal No. 5 to Surface Coal Mining Permit KRSB-8603.

The permit area is located in Sections 14, 15, 16, 17, 18, 19, 20, 21, and 22, T.143N., R.88W., Mercer County, North Dakota. The precise location and boundaries of the permit area are depicted on the accompanying map.

Permit KRSB-8603 encompasses 2,666.1 acres for coal excavation, mining and associated disturbance activities in support thereof. Revision No. 24 updates the current permit to reflect changes necessary for the next permit term including updates to the legal and financial sections, general operations and reclamation plans. In addition, the revision identifies the coal removal subarea that will be mined during the next 5-year permit term. Renewal No. 5 will allow mining and reclamation activities to continue during the next five-year permit term ending August 7, 2016.

This application is on file in the Office of the Director, Reclamation Division, Public Service Commission, State Capitol, Bismarck, North Dakota and the Office of the County Auditor, Mercer County, Stanton, North Dakota. It may be viewed at these locations during normal working hours.

Written comments, objections, requests for an informal conference or a petition to designate an area as unsuitable for surface coal mining operations may be submitted by any person with an interest, which is or may be adversely affected to the North Dakota Public Service Commission, 600 East Boulevard Avenue, Dept. 408, Bismarck, ND 58505-0480, within 30 days of the last publication of this notice. Any request for an informal conference must include the reasons for the request.

The legal description and names of the apparent surface and mineral owners of the permit area follows:

**T.143N., R.88W., Mercer County**

<u>LOCATION</u>	<u>SURFACE OWNER(S)</u>	<u>COAL OWNER(S)</u>
S1/2NW1/4, Sec. 14	Otter Tail Power Company Northern Municipal Power Agency Northwestern Corporation Montana-Dakota Utilities Co.	United States of America
NW1/4, Sec. 15	Otter Tail Power Company Northern Municipal Power Agency Northwestern Corporation Montana-Dakota Utilities Co.	Robert A. Keogh Robert A. Keogh Mineral Trust Faye Keogh Rev. Trust Claire C. Schwalbe
NE1/4, Sec. 15	Dakota Westmoreland Corp. Otter Tail Power Company Northern Municipal Power Agency Northwestern Corporation Montana-Dakota Utilities Co.	Robert A. Keogh Robert A. Keogh Mineral Trust Faye Keogh Rev. Trust Claire C. Schwalbe
S1/2, Sec. 15	Faye Keogh Revocable Trust	Robert A. Keogh Robert A. Keogh Mineral Trust Faye Keogh Rev. Trust Claire C. Schwalbe
N1/2, Sec. 16	State of North Dakota	State of North Dakota
SW1/4, Sec. 16	Leona Weil Joan Miller Sharon Winkler	State of North Dakota Leona Weil Sharon Winkler Joan Miller
SE1/4, Sec. 16	Martha Gunsch	Martha Gunsch Ronald Gunsch Janice Sigman Sylvia Zeiszler State of North Dakota
S1/2, Sec. 17	Faye Keogh Revocable Trust	Robert A. Keogh Robert A. Keogh Mineral Trust Faye Keogh Rev. Trust Claire C. Schwalbe
N1/2, Sec. 17	Claire C. Schwalbe	Robert A. Keogh Robert A. Keogh Mineral Trust Faye Keogh Rev. Trust Claire C. Schwalbe
SE1/4, Sec. 18	Donald & Claire Schwalbe	Donald & Claire Schwalbe State of North Dakota
N1/2, Sec. 19	Casey Voigt	Casey Voigt Kari Trappen Donald Voigt Shawn Voigt Kenneth Voigt Karmen Eslinger Dean Voigt Patience Saylor
NE1/4 NE1/4 NW1/4 NW1/4 S1/2 N1/2 N1/2 S1/2, Sec. 20	Dakota Westmoreland Corporation	United States of America
NE1/4NW1/4, Sec. 20	Dakota Westmoreland Corporation	Dakota Westmoreland Corp.
NW1/4NE1/4, Sec. 20	Martha Gunsch	Martha Gunsch Ronald Gunsch Janice Sigman Sylvia Zeiszler
N1/2, Sec. 21	Leona Weil Sharon Winkler Joan Miller	Leona Weil Sharon Winkler Joan Miller
S1/2, Sec. 21	Wilfred Fetch Angeline Braun Cary Unterseher	Wilfred Fetch Angeline Braun Cary Unterseher
NE1/4, Sec. 22	Terence Schmidt	United States of America
NW1/4, Sec. 22	Martha Gunsch	United States of America

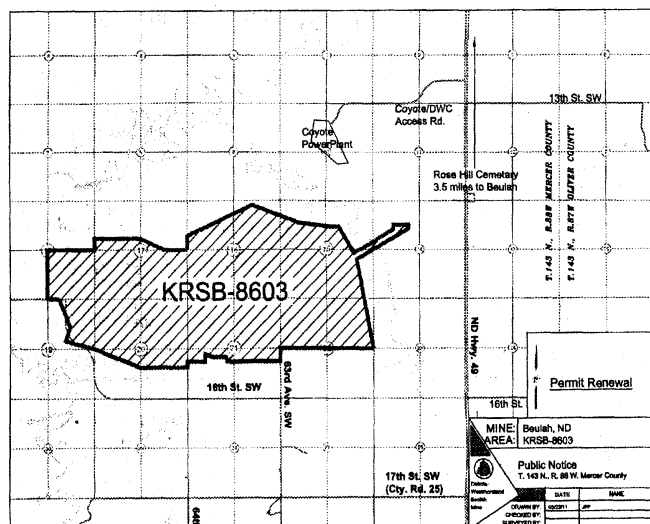

telephone number and received by June 20, 2011, will be fully considered. If you plan to attend the public hearing and require special accommodations relating to a disability, please contact the ND State Board of Medical Examiners at the above telephone number or address at least 10 days prior to the public hearing.

Dated this 4th day of May, 2011.  
Duane Houdek  
Executive Secretary & Treasurer  
ND State Board of Medical Examiners

**NOTICE OF APPLICATION FOR REVISION AND RENEWAL TO A SURFACE COAL MINE PERMIT**

Please take notice that Dakota Westmoreland Corporation, PO Box 39, Beulah, North Dakota 58523, has made application to the North Dakota Public Service Commission for Revision No. 24 and Renewal No. 5 to Surface Coal Mining Permit KRSB-8603.

The permit area is located in Sections 14, 15, 16, 17, 18, 19, 20, 21, and 22, T.143N., R.88W., Mercer County, North Dakota. The precise location and boundaries of the permit area are depicted on the accompanying map.

Permit KRSB-8603 encompasses 2,666.1 acres for coal excavation, mining and associated disturbance activities in support thereof. Revision No. 24 updates the current permit to reflect changes necessary for the next permit term including updates to the legal and financial sections, general operations and reclamation plans. In addition, the revision identifies the coal removal sub-area that will be mined during the next 5-year permit term. Renewal No. 5 will allow mining and reclamation activities to continue during the next five-year permit term ending August 7, 2016.

This application is on file in the Office of the Director, Reclamation Division, Public Service Commission, State Capitol, Bismarck, North Dakota and the Office of the County Auditor, Mercer County, Stanton, North Dakota. It may be viewed at these locations during normal working hours.

Written comments, objections, requests for an informal conference or a petition to designate an area as unsuitable for surface coal mining operations may be submitted by any person with an interest which is or may be adversely affected to the North Dakota Public Service Commission, 600 East Boulevard Avenue, Dept. 408, Bismarck, ND 58505-0480, within 30 days of the last publication of this notice. Any request for an informal conference must include the reasons for the request.

The legal description and names of the apparent surface and mineral owners of the permit area follows:

T.143N., R88W., Mercer County

**LOCATION**  
**S $\frac{1}{2}$ NW $\frac{1}{4}$ , Sec. 14**  
**SURFACE OWNER(S)**  
Otter Tail Power Company  
Northern Municipal Power Agency  
Northwestern Corporation  
Montana-Dakota Utilities Co.  
**COAL OWNER(S)**  
United States of America

**LOCATION**  
**NW $\frac{1}{4}$ , Sec. 15**  
**SURFACE OWNER(S)**  
Otter Tail Power Company



1-855-GO2LINK  
www.carechoice.nd.gov  
ND Relay TTY 1-800-366-6888

**PUBLIC NOTICES**

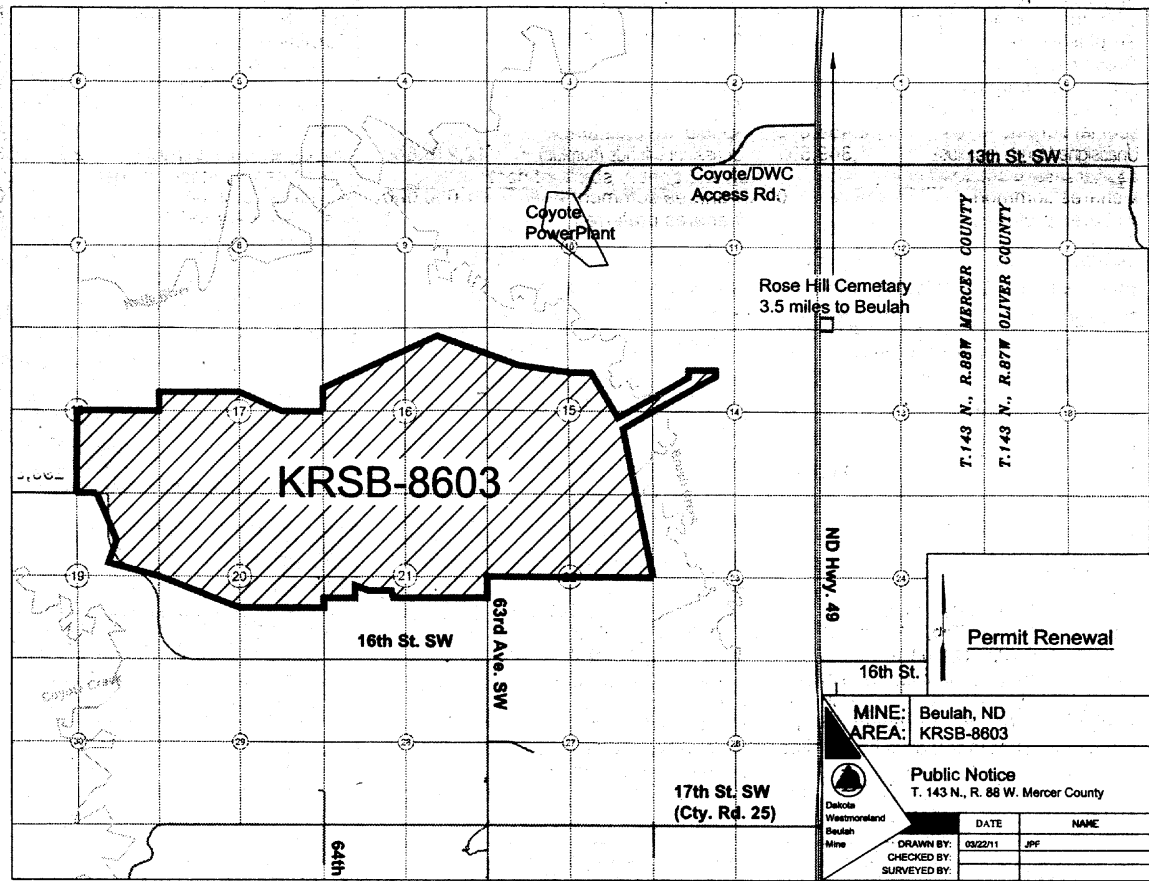

Shawn Voigt  
Kenneth Voigt  
Karmen Eslinger  
Dean Voigt  
Patience Saylor

**LOCATION**  
**NE $\frac{1}{4}$  NE $\frac{1}{4}$**   
**NW $\frac{1}{4}$  NW $\frac{1}{4}$**   
**S $\frac{1}{2}$  N $\frac{1}{2}$**   
**N $\frac{1}{4}$  S $\frac{1}{4}$ , Sec. 20**  
**SURFACE OWNER(S)**  
Dakota Westmoreland Corporation  
**COAL OWNER(S)**  
United States of America

**LOCATION**  
**NE $\frac{1}{4}$ NW $\frac{1}{4}$ , Sec. 20**  
**SURFACE OWNER(S)**  
Dakota Westmoreland Corporation  
**COAL OWNER(S)**  
Dakota Westmoreland Corp.

**LOCATION**  
**NW $\frac{1}{4}$ NE $\frac{1}{4}$ , Sec. 20**  
**SURFACE OWNER(S)**  
Martha Gunsch  
**COAL OWNER(S)**  
Martha Gunsch  
Ronald Gunsch  
Janice Sigman  
Sylvia Zeiszler

**LOCATION**  
**N $\frac{1}{2}$ , Sec. 21**  
**SURFACE OWNER(S)**  
Leona Weil  
Sharon Winkler  
Joan Miller  
**COAL OWNER(S)**  
Leona Weil  
Sharon Winkler  
Joan Miller

**LOCATION**  
**S $\frac{1}{2}$ , Sec. 21**  
**SURFACE OWNER(S)**  
Wilfred Fetch  
Angeline Braun  
Cary Unterseher  
**COAL OWNER(S)**  
Wilfred Fetch  
Angeline Braun  
Cary Unterseher

**LOCATION**  
**NE $\frac{1}{4}$ , Sec. 22**  
**SURFACE OWNER(S)**  
Terence Schmidt  
**COAL OWNER(S)**  
United States of America

**LOCATION**  
**NW $\frac{1}{4}$ , Sec. 22**  
**SURFACE OWNER(S)**  
Martha Gunsch  
**COAL OWNER(S)**  
United States of America  
(5-19-11-5-26-11-6-2-11-6-9-11)

Northern Municipal Power Agency  
Northwestern Corporation  
Montana-Dakota Utilities Co.  
**COAL OWNER(S)**  
Robert A. Keogh  
Robert A. Keogh Mineral Trust  
Faye Keogh Rev. Trust  
Claire C. Schwalbe

**LOCATION**  
**NE $\frac{1}{4}$ , Sec. 15**  
**SURFACE OWNER(S)**  
Dakota Westmoreland Corp.  
Otter Tail Power Company  
Northern Municipal Power Agency  
Northwestern Corporation  
Montana-Dakota Utilities Co.  
**COAL OWNER(S)**  
Robert A. Keogh  
Robert A. Keogh Mineral Trust  
Faye Keogh Rev. Trust  
Claire C. Schwalbe

**LOCATION**  
**S $\frac{1}{2}$ , Sec. 15**  
**SURFACE OWNER(S)**  
Faye Keogh Revocable Trust  
**COAL OWNER(S)**  
Robert A. Keogh  
Robert A. Keogh Mineral Trust  
Faye Keogh Rev. Trust  
Claire C. Schwalbe

**LOCATION**  
**N $\frac{1}{2}$ , Sec. 16**  
**SURFACE OWNER(S)**  
State of North Dakota  
**COAL OWNER(S)**  
State of North Dakota

**LOCATION**  
**SW $\frac{1}{4}$ , Sec. 16**  
**SURFACE OWNER(S)**  
Leona Weil  
Joan Miller  
Sharon Winkler  
**COAL OWNER(S)**  
State of North Dakota  
Leona Weil  
Sharon Winkler  
Joan Miller

**LOCATION**  
**SE $\frac{1}{4}$ , Sec. 16**  
**SURFACE OWNER(S)**  
Martha Gunsch  
**COAL OWNER(S)**  
Martha Gunsch  
Ronald Gunsch  
Janice Sigman  
Sylvia Zeiszler  
State of North Dakota

**LOCATION**  
**S $\frac{1}{2}$ , Sec. 17**  
**SURFACE OWNER(S)**

Faye Keogh Revocable Trust  
**COAL OWNER(S)**  
Robert A. Keogh  
Robert A. Keogh Mineral Trust  
Faye Keogh Rev. Trust  
Claire C. Schwalbe

**LOCATION**  
**N $\frac{1}{2}$ , Sec. 17**  
**SURFACE OWNER(S)**  
Claire C. Schwalbe  
**COAL OWNER(S)**  
Robert A. Keogh  
Robert A. Keogh Mineral Trust  
Faye Keogh Rev. Trust  
Claire C. Schwalbe

**LOCATION**  
**SE $\frac{1}{4}$ , Sec. 18**  
**SURFACE OWNER(S)**  
Donald & Claire Schwalbe  
**COAL OWNER(S)**  
Donald & Claire Schwalbe  
State of North Dakota

**LOCATION**  
**N $\frac{1}{2}$ , Sec. 19**  
**SURFACE OWNER(S)**  
Casey Voigt  
**COAL OWNER(S)**  
Casey Voigt  
Kari Trappen  
Donalda Voigt

(11-6-9-11-5-26-11-6-2-11-6-9-11)

(11-6-9-11-5-26-11-6-2-11-6-9-11)

(11-6-9-11-5-26-11-6-2-11-6-9-11)

(11-6-9-11-5-26-11-6-2-11-6-9-11)

# Public Notices

## NOTICE OF APPLICATION FOR REVISION AND RENEWAL TO A SURFACE COAL MINE PERMIT

Please take notice that Dakota Westmoreland Corporation, P.O. Box 39, Beulah, North Dakota 58523, has made application to the North Dakota Public Service Commission for Revision No. 24 and Renewal No. 5 to Surface Coal Mining Permit KRSB-8603.

The permit area is located in Sections 14, 15, 16, 17, 18, 19, 20, 21, and 22, T.143N., R.88W., Mercer County, North Dakota. The precise location and boundaries of the permit area are depicted on the accompanying map.

Permit KRSB-8603 encompasses 2,666.1 acres for coal excavation, mining and associated disturbance activities in support thereof. Revision No. 24 updates the current permit to reflect changes necessary for the next permit term including updates to the legal and financial sections, general operations and reclamation plans. In addition, the revision identifies the coal removal sub-area that will be mined during the next 5-year permit term. Renewal No. 5 will allow mining and reclamation activities to continue during the next five-year permit term ending August 7, 2016.

This application is on file in the Office of the Director, Reclamation Division, Public Service Commission, State Capitol, Bismarck, North Dakota and the Office of the County Auditor, Mercer County, Stanton, North Dakota. It may be viewed at these locations during normal working hours.

Written comments, objections, requests for an informal conference or a petition to designate an area as unsuitable for surface coal mining operations may be submitted by any person with an interest which is or may be adversely affected to the North Dakota Public Service Commission, 600 East Boulevard Avenue, Dept. 408, Bismarck, ND 58505-0480, within 30 days of the last publication of this notice. Any request for an informal conference must include the reasons for the request.

The legal description and names of the apparent surface and mineral owners of the permit area follows:  
T.143N., R88W., Mercer County

**LOCATION**  
S $\frac{1}{2}$ NW $\frac{1}{4}$ , Sec. 14  
SURFACE OWNER(S)

Otter Tail Power Company  
Northern Municipal Power Agency  
Northwestern Corporation  
Montana-Dakota Utilities Co.  
COAL OWNER(S)  
United States of America

**LOCATION**  
NW $\frac{1}{4}$ , Sec. 15  
SURFACE OWNER(S)  
Otter Tail Power Company

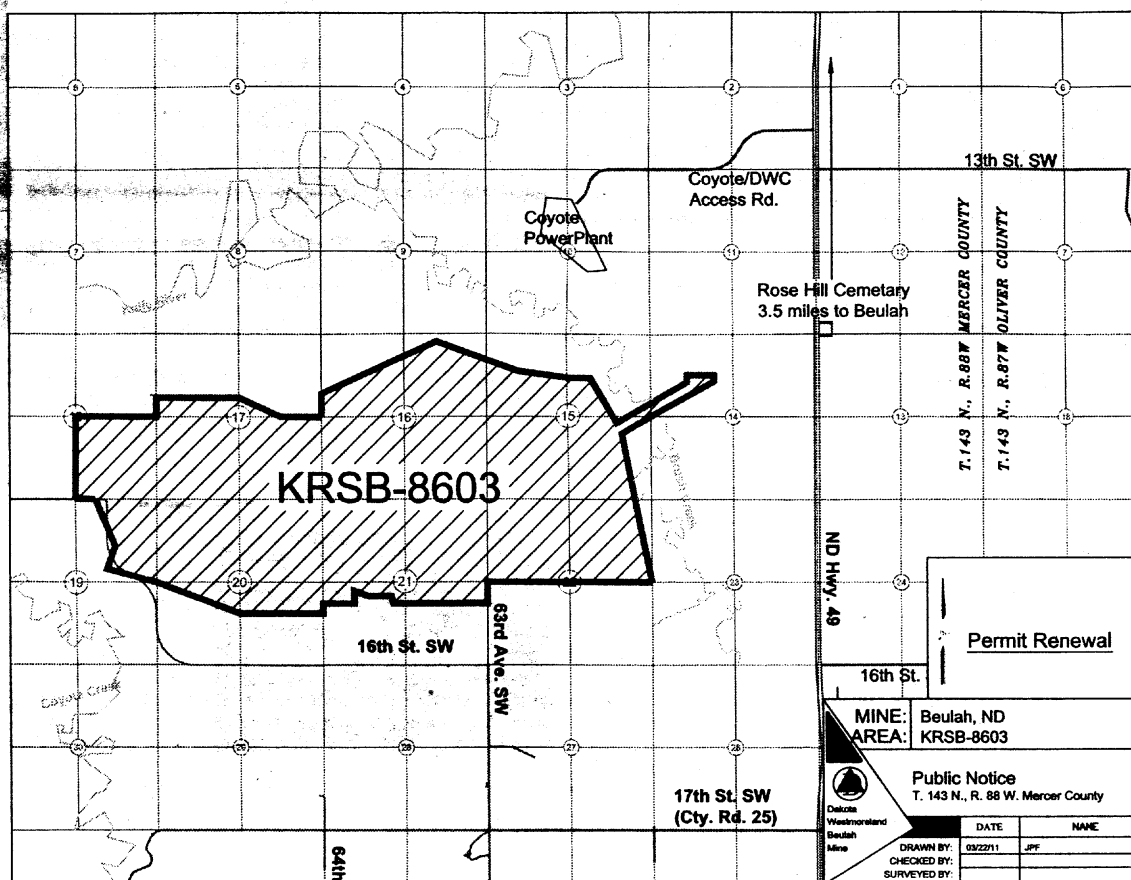

Northern Municipal Power Agency  
Northwestern Corporation  
Montana-Dakota Utilities Co.  
COAL OWNER(S)  
Robert A. Keogh  
Robert A. Keogh Mineral Trust  
Faye Keogh Rev. Trust  
Claire C. Schwalbe

**LOCATION**  
NE $\frac{1}{4}$ , Sec. 15  
SURFACE OWNER(S)  
Dakota Westmoreland Corp.  
Otter Tail Power Company  
Northern Municipal Power Agency  
Northwestern Corporation  
Montana-Dakota Utilities Co.  
COAL OWNER(S)  
Robert A. Keogh  
Robert A. Keogh Mineral Trust  
Faye Keogh Rev. Trust  
Claire C. Schwalbe

**LOCATION**  
S $\frac{1}{2}$ , Sec. 15  
SURFACE OWNER(S)  
Faye Keogh Revocable Trust  
COAL OWNER(S)  
Robert A. Keogh  
Robert A. Keogh Mineral Trust  
Faye Keogh Rev. Trust  
Claire C. Schwalbe

**LOCATION**  
N $\frac{1}{2}$ , Sec. 16  
SURFACE OWNER(S)  
State of North Dakota  
COAL OWNER(S)  
State of North Dakota

**LOCATION**  
SW $\frac{1}{4}$ , Sec. 16  
SURFACE OWNER(S)  
Leona Weil  
Joan Miller  
Sharon Winkler  
COAL OWNER(S)  
State of North Dakota  
Leona Weil  
Sharon Winkler  
Joan Miller

**LOCATION**  
SE $\frac{1}{4}$ , Sec. 16  
SURFACE OWNER(S)  
Martha Gunsch  
COAL OWNER(S)  
Martha Gunsch  
Ronald Gunsch  
Janice Sigman  
Sylvia Zeiszler  
State of North Dakota

**LOCATION**  
S $\frac{1}{2}$ , Sec. 17  
SURFACE OWNER(S)

Faye Keogh Revocable Trust  
COAL OWNER(S)  
Robert A. Keogh  
Robert A. Keogh Mineral Trust  
Faye Keogh Rev. Trust  
Claire C. Schwalbe

**LOCATION**  
N $\frac{1}{2}$ , Sec. 17  
SURFACE OWNER(S)  
Claire C. Schwalbe  
COAL OWNER(S)  
Robert A. Keogh  
Robert A. Keogh Mineral Trust  
Faye Keogh Rev. Trust  
Claire C. Schwalbe

**LOCATION**  
SE $\frac{1}{4}$ , Sec. 18  
SURFACE OWNER(S)  
Donald & Claire Schwalbe  
COAL OWNER(S)  
Donald & Claire Schwalbe  
State of North Dakota

**LOCATION**  
N $\frac{1}{2}$ , Sec. 19  
SURFACE OWNER(S)  
Casey Voigt  
COAL OWNER(S)  
Casey Voigt  
Kari Trappen  
Donalda Voigt

Shawn Voigt  
Kenneth Voigt  
Karmen Eslinger  
Dean Voigt  
Patience Saylor

**LOCATION**  
NE $\frac{1}{4}$  NE $\frac{1}{4}$   
NW $\frac{1}{4}$  NW $\frac{1}{4}$   
S $\frac{1}{2}$  N $\frac{1}{2}$   
N $\frac{1}{2}$  S $\frac{1}{2}$ , Sec. 20  
SURFACE OWNER(S)  
Dakota Westmoreland Corporation  
COAL OWNER(S)  
United States of America

**LOCATION**  
NE $\frac{1}{4}$ NW $\frac{1}{4}$ , Sec. 20  
SURFACE OWNER(S)  
Dakota Westmoreland Corporation  
COAL OWNER(S)  
Dakota Westmoreland Corp.

**LOCATION**  
NW $\frac{1}{4}$ NE $\frac{1}{4}$ , Sec. 20  
SURFACE OWNER(S)  
Martha Gunsch  
COAL OWNER(S)  
Martha Gunsch  
Ronald Gunsch  
Janice Sigman  
Sylvia Zeiszler

**LOCATION**  
N $\frac{1}{2}$ , Sec. 21  
SURFACE OWNER(S)  
Leona Weil  
Sharon Winkler  
Joan Miller  
COAL OWNER(S)  
Leona Weil  
Sharon Winkler  
Joan Miller

**LOCATION**  
S $\frac{1}{2}$ , Sec. 21  
SURFACE OWNER(S)  
Wilfred Fetch  
Angeline Braun  
Cary Unterseher  
COAL OWNER(S)  
Wilfred Fetch  
Angeline Braun  
Cary Unterseher

**LOCATION**  
NE $\frac{1}{4}$ , Sec. 22  
SURFACE OWNER(S)  
Terence Schmidt  
COAL OWNER(S)  
United States of America

**LOCATION**  
NW $\frac{1}{4}$ , Sec. 22  
SURFACE OWNER(S)  
Martha Gunsch  
COAL OWNER(S)  
United States of America  
(5-19-11-5-26-11-6-2-11-6-9-11)