

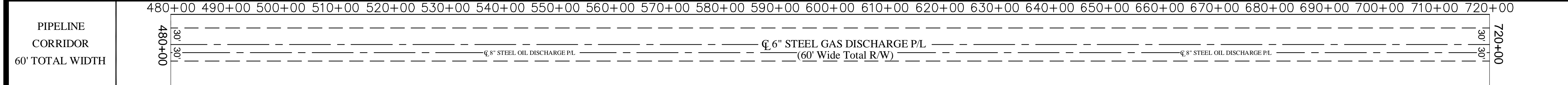

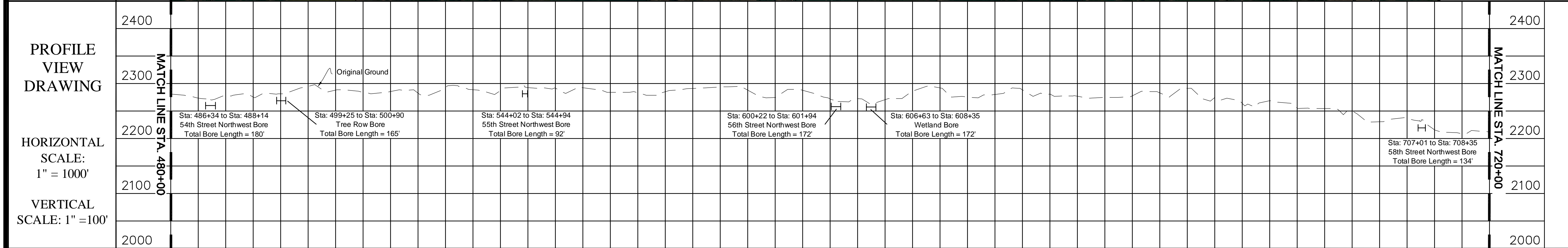

OWNERSHIP *SEE ALIGNMENT VIEW	Marshall Craft W1/2 SW1/4, Sec. 35, T155N, R91W Total Footage = 2712'	Ed & Diane Moon SW1/4 SW1/4, Sec. 26, T155N, R91W Total Footage = 1336'	Michael & Shelly Craft NW1/4 SW1/4 & SW1/4 NW1/4, Sec. 26, T155N, R91W Total Footage = 3009'	Sydney M. & Carol A. Craft NW1/4 NW1/4, Sec. 26, T155N, R91W Total Footage = 1321'	Warren D. Craft W1/2 W1/2, Sec. 23, T155N, R91W Total Footage = 5285'	Marie Harstad, Living Estate SW1/4, Sec. 14, T155N, R91W Total Footage = 2753'	John & Kathryn Sauber NW1/4, Sec. 14, T155N, R91W Total Footage = 2640'	Evelyn Schmitz SW1/4 SW1/4, Sec. 11, T155N, R91W Total Footage = 1323'			
RODDAGE	165	81	103	81	183	80	321	167	160	707+69	81

STATION DESCRIPTION	Sta = 506+15 P.1, 2708' RT Sta = 500+00 End Bore Sta = 600+00 P.1, 11'48" LT Sta = 499+25 Begin Bore Sta = 489+25 P.1, 1'25" LT Sta = 486+98 P.1, 4'06" LT Sta = 491+19 P.1, 9'28" LT Sta = 491+36 OHP X-Ing Sta = 491+11 P.1, 17'51" LT Sta = 489+14 P.1, 17'38" RT Sta = 488+14 End Bore Sta = 487+39 Fence X-Ing Sta = 487+33 CR ROW Sta = 487+00 54th Street Northwest Sta = 486+57 CR ROW Sta = 486+34 Begin Bore Sta = 485+59 P.1, 10'27" RT Sta = 484+79 P.1, 1'53" RT	Sta = 514+12 1/4 Sec. Line Sta = 512+26 UG Tie X-Ing Sta = 511+61 P.1, 8'14" RT Sta = 510+26 P.1, 4'09" RT	Sta = 577+03 P.1, 16'20" RT Sta = 576+49 P.1, 16'20" RT Sta = 575+75 P.1, 22'30" RT Sta = 569+28 P.1, 11'34" LT Sta = 568+83 P.1, 12'02" LT Sta = 568+20 P.1, 4'55" LT Sta = 564+22 P.1, 6'11" LT Sta = 563+40 P.1, 11'54" LT Sta = 557+61 1/16 Sec. Line Sta = 554+58 P.1, 8'00" LT Sta = 553+75 P.1, 8'15" LT Sta = 549+19 UG Tie X-Ing Sta = 549+19 UG Tie X-Ing Sta = 549+19 UG Tie X-Ing Sta = 544+71 OHP X-Ing Sta = 544+25 CR ROW Sta = 544+02 Begin Bore Sta = 543+66 P.1, 8'51" LT Sta = 543+26 P.1, 6'05" LT Sta = 539+21 P.1, 1'14" RT Sta = 532+39 P.1, 23'54" RT Sta = 531+46 P.1, 22'34" RT Sta = 527+94 1/16 Sec. Line	Sta = 610+57 P.1, 6'12" RT Sta = 608+35 End Bore Sta = 607+42 P.1, 12'28" LT Sta = 606+63 Begin Bore Sta = 606+40 Blk Vlv End Sta = 604+36 P.1, 6'18" RT Sta = 601+77 P.1, 8'00" RT Sta = 601+76 UG Tie X-Ing Sta = 601+19 UG Tie X-Ing Sta = 600+91 1/4 Sec. Line Sta = 600+58 CR ROW Sta = 600+22 Begin Bore Sta = 587+70 1/16 Sec. Line	Sta = 670+55 MISSILE X-Ing Sta = 670+47 P.1, 45'00" RT Sta = 659+36 P.1, 45'00" RT Sta = 657+39 P.1, 45'00" LT Sta = 656+74 P.1, 45'00" LT Sta = 654+77 P.1, 45'00" RT Sta = 654+22 OHP X-Ing Sta = 654+09 CR ROW Sta = 653+76 Section Line Sta = 653+43 CR ROW	Sta = 681+29 1/4 Sec. Line Sta = 681+28 Fence X-Ing	Sta = 711+35 P.1, 5'53" LT Sta = 708+35 End Bore Sta = 708+35 P.1, 6'33" RT Sta = 708+16 OHP X-Ing Sta = 708+04 UG Tie X-Ing Sta = 707+69 Section Line Sta = 707+36 CR ROW Sta = 707+01 Begin Bore
------------------------	--	---	---	--	--	--	---



PIPELINE LEGEND	
	PLSS Monument - Found
	PLSS Monument - Not Found
	Existing Pipeline
	Existing Fence
	Existing Overhead Power Line
	Existing Underground Telephone
	Block Valve Area
	Valve
	Mile Post
	Station Equation
	Cathodic Test Station
	Bore Location
	P.I. Location
	Highway Right-of-Way
	Check Valve
	Relief Valve
	Meter Station
	P/L Warning Sign

PIPELINE MATERIAL		
STATION	PIPE SIZE	PIPE DETAILS
480+00 to 720+00	6" Steel	

PROJECT REVISIONS		
REV. NO.	DATE	DESCRIPTION

**PROJECT DETAILS**

WHITING PETROLEUM CORPORATION  
SOUTH ROBINSON GAS PLANT TO NEXEN FACILITY  
6" STEEL GAS DISCHARGE LINE  
480+00 TO 720+00  
SECTION 2, T154N, R91W  
SECTIONS 11, 14, 23, 26 & 35, T155N, R91W  
MOUNTRAIL COUNTY, NORTH DAKOTA

SURVEYING & DRAFTING SERVICES PROVIDED BY:

**ECS INC.**  
ERICKSON CONTRACT SURVEYING  
333 10th Ave. SE Sidney, Montana  
Office 406-482-6806 / Fax 406-482-6800

**ECS PROJECT #2008-633**

Surveyed By: Cundiff / Tofte  
Date Surveyed:  
Drawn By: F. Syth  
Date Drawn: April 2010  
Approved By: Mike Madler  
Approval Date:

