



May 29, 2015

North Dakota Public Service Commission
Patrick Fahn
600 E. Boulevard, Dept 408
Bismark, ND 58505-0480



RE: Tree and Shrub Reclamation Plan for Vantage Pipeline Case No. PU-11-109

Dear NDPSC and Mr. Fahn,

In accordance with the North Dakota Public Service Commission (NDPSC) Tree and Shrub Mitigation Specifications, KC Harvey is submitting documentation of reclamation planting for the Vantage Pipeline Case Number PU-11-109.

The Tree and Shrub Reclamation Plan provided the following information as requested by the NDPSC Mitigation Specifications:

- The number and variety of trees and shrubs removed during construction
- Reclamation plan for replacing these species at a 2:1 ratio
- The variety, location, and date of replacement plantings in 2014

The First Annual Monitoring Report of Tree and Shrub Reclamation Planting Survival indicated that additional plantings were needed in 2015 to reach the 70% survival requirements because many of the 2014 planting were disturbed during the construction of another pipeline. Attachment 1 provides documentation of the species, number, location, and date of replacement planting in 2014 and 2015. All trees and shrubs were purchased from the Divide County Conservation District (Attachment 2). In 2015, we planted an additional 830 trees/shrubs in three locations. The three locations were identified with the assistance of landowners as places windbreaks were desired and watering is possible to increase survival. Monitoring of all planting locations is scheduled for September 2015 (Attachment 3).

Please contact us if you require any additional information.

Sincerely,

David P. Cameron, P.E.
Principal Engineer
KC Harvey Environmental, LLC

Monica Pokorny
Senior Ecologist
KC Harvey Environmental, LLC

Attachment 1. Replacement Plantings 2014 and 2015.

Pipeline Milepost	Inventory Species	Inventory Stem Count	Mitigation Plan	Dates Planted	Mitigation Species Planted	2014 Mitigation Stem Count Planted	2015 Mitigation Stem Count Planted
0.71	Silverberry	25	replace same, 2 to 1	5/7/2014	Silverberry	50	0
2.50	Russian Olive	1	lace with chokecherry, 2	5/7/2014	Chokecherry	2	0
3.15	Chokecherry	50	replace same, 2 to 1	5/7/2014	Chokecherry	100	0
3.51	Dogwood	5	replace same, 2 to 1	5/7/2014	Dogwood	10	0
4.24	Siberian Elm	1	lace with chokecherry, 2	5/7/2014	Chokecherry	2	0
4.35	Chokecherry	2	replace same, 2 to 1	5/7/2014	Chokecherry	4	0
4.35	Green Ash	10	replace same, 2 to 1	5/7/2014	Green Ash	20	0
4.36	Willow	2	replace same, 2 to 1	5/7/2014	Willow	4	0
4.95	Silverberry	100	replace same, 2 to 1	5/7/2014	Silverberry	200	0
5.36	Chokecherry	10	replace same, 2 to 1	5/8/2014	Chokecherry	20	0
5.68	Silverberry	75	replace same, 2 to 1	5/8/2014	Silverberry	150	0
5.71	Silverberry	10	replace same, 2 to 1	5/8/2014	Silverberry	20	0
6.07	Caragana	10	replace same, 2 to 1	5/8/2014	Caragana	20	0
6.07	Green Ash	5	replace same, 2 to 1	5/8/2014	Green Ash	10	0
6.21	Caragana	15	replace same, 2 to 1	5/8/2014	Caragana	30	0
6.35	Caragana	16	replace same, 2 to 1	5/8/2014	Caragana	32	0
6.48	Caragana	20	replace same, 2 to 1	5/8/2014	Caragana	40	0
6.48	Green Ash	6	replace same, 2 to 1	5/8/2014	Green Ash	12	0
6.77	Silver Buffaloberry	50	replace same, 2 to 1	5/8/2014	Silver Buffaloberry	100	0
7.63	Juniper	1	replace same, 2 to 1	5/8/2014	Juniper	2	0
8.41	Chokecherry	1	replace same, 2 to 1	5/8/2014	Chokecherry	2	0
11.93	Russian Olive	1	lace with chokecherry, 2	5/6/2014	Chokecherry	2	0
12.43	Siberian Elm	7	replace same, 2 to 1	5/6/2014	Siberian Elm	14	0
15.10	Siberian Elm	1	lace with chokecherry, 2	5/6/2014	Chokecherry	2	0
16.09	Chokecherry	1	replace same, 2 to 1	5/6/2014	Chokecherry	2	0
21.36	Maple	1	replace same, 2 to 1	5/6/2014	Maple	2	0
21.38	Green Ash	8	replace same, 2 to 1	5/6/2014	Green Ash	16	0
21.39	Willow	2	replace same, 2 to 1	5/6/2014	Willow	4	0
30.24	Chokecherry	1	replace same, 2 to 1	5/6/2014	Chokecherry	2	0
30.34	Chokecherry	3	replace same, 2 to 1	5/6/2014	Chokecherry	6	0
30.48	Chokecherry	2	replace same, 2 to 1	5/6/2014	Chokecherry	4	0
32.00			homestead windbreak	5/1/2015	Chokecherry	0	140
32.00			homestead windbreak	5/1/2015	Silverberry	0	75
32.00			homestead windbreak	5/1/2015	Silver Buffaloberry	0	100
32.00			homestead windbreak	5/1/2015	Willow	0	20
32.00			homestead windbreak	5/1/2015	Dogwood	0	25
33.44	Ponderose Pine	4	replace same, 2 to 1	5/6/2014	Ponderose Pine	8	0
33.44			additional windbreak	5/1/2015	Caragana	0	117
33.44			additional windbreak	5/1/2015	Siberian Elm	0	30
33.44			additional windbreak	5/1/2015	Green Ash	0	60
33.44			additional windbreak	5/1/2015	Silverberry	0	100
40.16	Siberian Elm	7	replace same, 2 to 1	5/6/2014	Siberian Elm	14	0
61.52	Caragana	95	replace same, 2 to 1	5/6/2014 & 4/29/2015	Caragana	190	163
TOTAL						1096	830

DIVIDE COUNTY SOIL CONSERVATION DISTRICT
 P.O. Box 66
 Crosby, ND 58730





00352

Customer's Order No.		Phone No.		Date 12-22-14	
Sold To KC Harvey Environmental					
Address 376 Gallatin Park Dr					
City Bozeman MT 59715					
Sold By BB	Cash	C.O.D.	Charge X	On Acct.	Mdse. Ret'd.
Qty.		Description		Price	Amount
4	6x500' Roll Barrier		150 ⁰⁰	600.00	
280	Caragana 3'		6.50	1820.00	
140	Chokecherry 4-5'		6.50	910.00	
25	Dogwood 3'		6.50	162.50	
60	Green Ash 3'		6.50	390.00	
10	Maple 4'		6.50	65.00	
30	Elm 3'		6.50	195.00	
100	Buffaloberry		3.00	300.00	
175	Silverberry		3.00	350.00	
10	Laurel Willow		6.50	65.00	
All claims and returned goods MUST be accompanied by this bill.				Tax	
Rec'd By				Total	4757.50

Thank You!



INDEX MAP 1

-  Populated Place
-  Pipeline Route
-  Plantings (before 2015)
-  Plantings (new 2015)

North Dakota

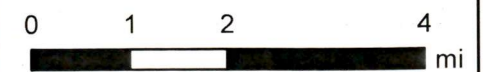
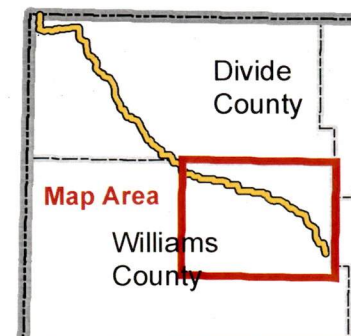

KC HARVEY
ENVIRONMENTAL, LLC

376 Gallatin Park Drive
Bozeman, MT 59715
406-585-7402
www.kcharvey.com

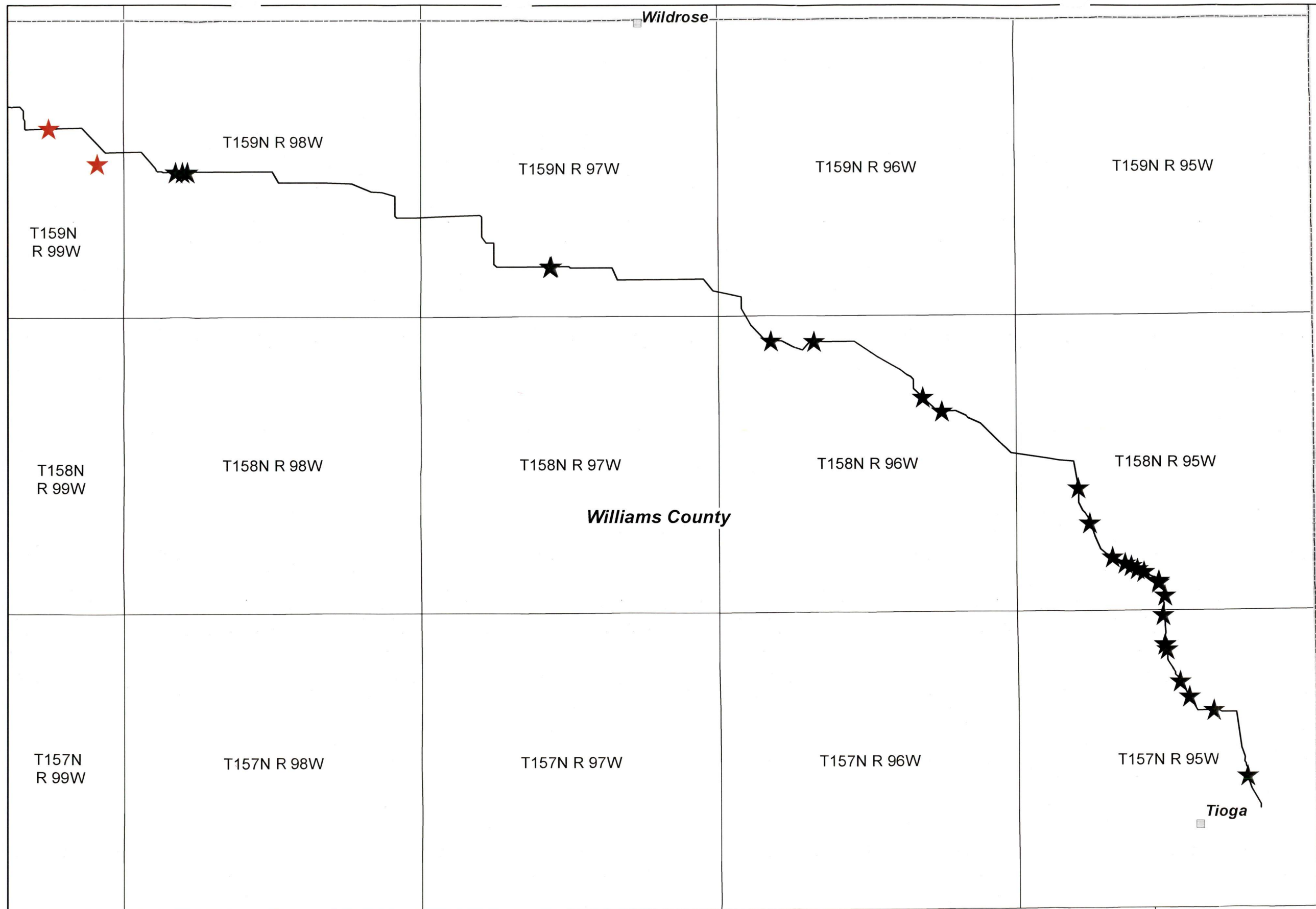



INDEX MAP 2

■ Populated Place

— Pipeline Route

★ Plantings (before 2015)

★ Plantings (new 2015)

North Dakota

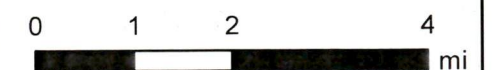
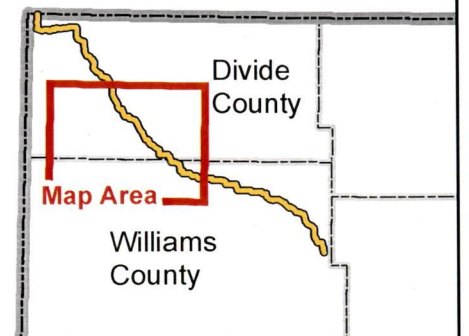

KC HARVEY
ENVIRONMENTAL, LLC

376 Gallatin Park Drive
Bozeman, MT 59715
406-585-7402
www.kcharvey.com

