

The Bismarck
Tribune
www.bismarcktribune.com

The
Finder

**Classified
Advertising
Invoice**

Bismarck Tribune

PO BOX 4001
LaCrosse, WI 54602-4001
In State 701-250-8218
Toll free 800-472-2273

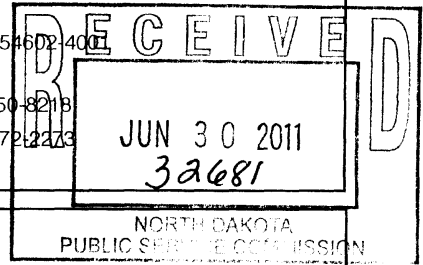

DAKOTA WESTMORELAND

PO BOX 39
BEULAH ND 58523-0039

Customer: 60007152
Phone: (701) 873-4333
Date: 06/02/2011

CREDIT CARD PAYMENT (circle one)



Card #: _____
Exp Date: _____
Signature: _____
Credit card users: Fax to 701-223-6584

Cash Amt _____

PLEASE DETACH AND RETURN TOP PORTION WITH YOUR PAYMENT

Date	Date	Times Run	Description	Lines	Class Code	Order Amt	Net Amt Due
05/12/11	06/02/11	4	606728/Mercer County Bismarck Tribune	222.00	Legals	1,764.00	1,764.00

Affidavit of Publication

State of North Dakota) SS County of Burleigh
Before me, a Notary Public for the State of North Dakota
personally appeared CK who being duly sworn, deposes
and says that he (she) is the Clerk of Bismarck Tribune Co.,
and that the publication(s) were made through the
Bismarck Tribune on the following dates:
5/12, 19, 26, 6/2 Signed Carmen Kuntz
sworn and subscribed to before me this 7th
day of JUNE 2011
Notary Public in and for the State of North Dakota

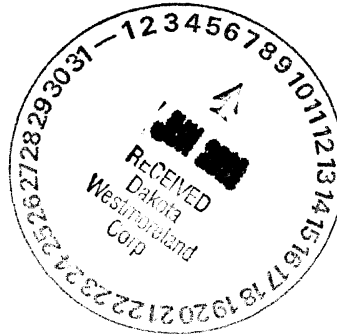

Paula T. Gora
6-9-11

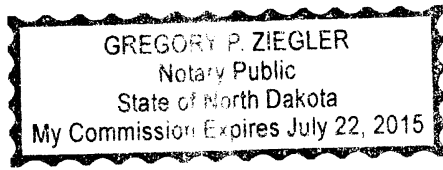

Please return invoice or put order number on check. Thank You.

Remarks _____ Total Due: 1,764.00

Bismarck Tribune
www.bismarcktribune.com
PO BOX 4001
LaCrosse, WI 54602-4001

STATEMENT



91 N. Main Street • P.O. Box 309
Garrison, ND 58540
(701) 463-2201



DAKOTA WESTMORELAND
PO BOX 39
BEULAH ND 58523-0039



Dept. Code

BH-Beulah Beacon	MC-McClusky Gazette
CR-Center Republican	VL-Velva Area Voice
DS-Coal Country Dollar Saver	NT-New Town News
GR-McLean County Independent	PR-Mountrail County Recorder
HZ-Hazen Star	NS-Northern Sentry
LN-Leader News	UN-Underwood News
TL-McLean County Journal	XT- XTRA

www.bhgnews.com/paybills

Account No.	Date
1499	05/24/11
\$ _____	
Amount Remitted	

Please Detach and Return Top Portion With Your Payment

A late charge of 1 1/4% will be assessed on unpaid charges more than one month old.

DATE	DESCRIPTION	CHARGES	
04/28/2011	BH-80" PTO CARNIVAL/KITE FLY MAY SIG AD	\$9.00	TS
05/19/2011	BH-160" RECOGNIZING THE MUSIC AD/QUOTE	\$100.00	TS
05/19/2011	HZ-R24 PUBLIC NOTICE W/MAP/LEGAL	\$250.65	TS
05/19/2011	CR-R24 PUBLIC NOTICE/MAP/LEGAL	\$250.65	TS

Handwritten notes:
 Renewal # 5
 Revision # 24
 KR5B-8603
 dia
 pig 5-31-11

BHG, Inc. P.O. Box 309, Garrison, ND 58540

PAYMENT RECEIVED \$317.68

FINANCE CHARGE \$0.00

CURRENT	30 DAYS	60 DAYS	90 DAYS	BALANCE
\$610.30	\$0.00	\$0.00	\$0.00	\$610.30

**NOTICE OF APPLICATION
FOR REVISION and RENEWAL TO A SURFACE COAL MINE PERMIT**

Please take notice that Dakota Westmoreland Corporation, PO Box 39, Beulah, North Dakota 58523, has made application to the North Dakota Public Service Commission for Revision No. 24 and Renewal No. 5 to Surface Coal Mining Permit KRSB-8603.

The permit area is located in Sections 14, 15, 16, 17, 18, 19, 20, 21, and 22, T.143N., R.88W., Mercer County, North Dakota. The precise location and boundaries of the permit area are depicted on the accompanying map.

Permit KRSB-8603 encompasses 2,666.1 acres for coal excavation, mining and associated disturbance activities in support thereof. Revision No. 24 updates the current permit to reflect changes necessary for the next permit term including updates to the legal and financial sections, general operations and reclamation plans. In addition, the revision identifies the coal removal subarea that will be mined during the next 5-year permit term. Renewal No. 5 will allow mining and reclamation activities to continue during the next five-year permit term ending August 7, 2016.

This application is on file in the Office of the Director, Reclamation Division, Public Service Commission, State Capitol, Bismarck, North Dakota and the Office of the County Auditor, Mercer County, Stanton, North Dakota. It may be viewed at these locations during normal working hours.

Written comments, objections, requests for an informal conference or a petition to designate an area as unsuitable for surface coal mining operations may be submitted by any person with an interest, which is or may be adversely affected to the North Dakota Public Service Commission, 600 East Boulevard Avenue, Dept. 408, Bismarck, ND 58505-0480, within 30 days of the last publication of this notice. Any request for an informal conference must include the reasons for the request.

The legal description and names of the apparent surface and mineral owners of the permit area follows:

T.143N., R.88W., Mercer County

<u>LOCATION</u>	<u>SURFACE OWNER(S)</u>	<u>COAL OWNER(S)</u>
S1/2NW1/4, Sec. 14	Otter Tail Power Company Northern Municipal Power Agency Northwestern Corporation Montana-Dakota Utilities Co.	United States of America
NW1/4, Sec. 15	Otter Tail Power Company Northern Municipal Power Agency Northwestern Corporation Montana-Dakota Utilities Co.	Robert A. Keogh Robert A. Keogh Mineral Trust Faye Keogh Rev. Trust Claire C. Schwalbe
NE1/4, Sec. 15	Dakota Westmoreland Corp. Otter Tail Power Company Northern Municipal Power Agency Northwestern Corporation Montana-Dakota Utilities Co.	Robert A. Keogh Robert A. Keogh Mineral Trust Faye Keogh Rev. Trust Claire C. Schwalbe
S1/2, Sec. 15	Faye Keogh Revocable Trust	Robert A. Keogh Robert A. Keogh Mineral Trust Faye Keogh Rev. Trust Claire C. Schwalbe
N1/2, Sec. 16	State of North Dakota	State of North Dakota
SW1/4, Sec. 16	Leona Weil Joan Miller Sharon Winkler	State of North Dakota Leona Weil Sharon Winkler Joan Miller
SE1/4, Sec. 16	Martha Gunsch	Martha Gunsch Ronald Gunsch Janice Sigman Sylvia Zeiszler State of North Dakota
S1/2, Sec. 17	Faye Keogh Revocable Trust	Robert A. Keogh Robert A. Keogh Mineral Trust Faye Keogh Rev. Trust Claire C. Schwalbe
N1/2, Sec. 17	Claire C. Schwalbe	Robert A. Keogh Robert A. Keogh Mineral Trust Faye Keogh Rev. Trust Claire C. Schwalbe
SE1/4, Sec. 18	Donald & Claire Schwalbe	Donald & Claire Schwalbe State of North Dakota
N1/2, Sec. 19	Casey Voigt	Casey Voigt Kari Trappen Donald Voigt Shawn Voigt Kenneth Voigt Karmen Eslinger Dean Voigt Patience Saylor
NE1/4 NE1/4 NW1/4 NW1/4 S1/2 N1/2 N1/2 S1/2, Sec. 20	Dakota Westmoreland Corporation	United States of America
NE1/4NW1/4, Sec. 20	Dakota Westmoreland Corporation	Dakota Westmoreland Corp.
NW1/4NE1/4, Sec. 20	Martha Gunsch	Martha Gunsch Ronald Gunsch Janice Sigman Sylvia Zeiszler
N1/2, Sec. 21	Leona Weil Sharon Winkler Joan Miller	Leona Weil Sharon Winkler Joan Miller
S1/2, Sec. 21	Wilfred Fetch Angeline Braun Cary Unterseher	Wilfred Fetch Angeline Braun Cary Unterseher
NE1/4, Sec. 22	Terence Schmidt	United States of America
NW1/4, Sec. 22	Martha Gunsch	United States of America

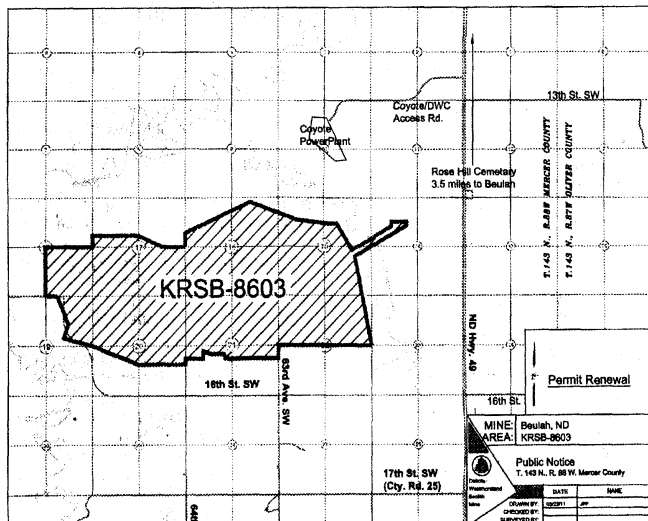

telephone number and received by June 20, 2011, will be fully considered. If you plan to attend the public hearing and require special accommodations relating to a disability, please contact the ND State Board of Medical Examiners at the above telephone number or address at least 10 days prior to the public hearing.

Dated this 4th day of May, 2011.
Duane Houdek
Executive Secretary & Treasurer
ND State Board of Medical Examiners

NOTICE OF APPLICATION FOR REVISION AND RENEWAL TO A SURFACE COAL MINE PERMIT

Please take notice that Dakota Westmoreland Corporation, PO Box 39, Beulah, North Dakota 58523, has made application to the North Dakota Public Service Commission for Revision No. 24 and Renewal No. 5 to Surface Coal Mining Permit KRSB-8603.

The permit area is located in Sections 14, 15, 16, 17, 18, 19, 20, 21, and 22, T.143N., R.88W., Mercer County, North Dakota. The precise location and boundaries of the permit area are depicted on the accompanying map.

Permit KRSB-8603 encompasses 2,666.1 acres for coal excavation, mining and associated disturbance activities in support thereof. Revision No. 24 updates the current permit to reflect changes necessary for the next permit term including updates to the legal and financial sections, general operations and reclamation plans. In addition, the revision identifies the coal removal sub-area that will be mined during the next 5-year permit term. Renewal No. 5 will allow mining and reclamation activities to continue during the next five-year permit term ending August 7, 2016.

This application is on file in the Office of the Director, Reclamation Division, Public Service Commission, State Capitol, Bismarck, North Dakota and the Office of the County Auditor, Mercer County, Stanton, North Dakota. It may be viewed at these locations during normal working hours.

Written comments, objections, requests for an informal conference or a petition to designate an area as unsuitable for surface coal mining operations may be submitted by any person with an interest which is or may be adversely affected to the North Dakota Public Service Commission, 600 East Boulevard Avenue, Dept. 408, Bismarck, ND 58505-0480, within 30 days of the last publication of this notice. Any request for an informal conference must include the reasons for the request.

The legal description and names of the apparent surface and mineral owners of the permit area follows:

T.143N., R88W., Mercer County

LOCATION
S $\frac{1}{2}$ NW $\frac{1}{4}$, Sec. 14
SURFACE OWNER(S)
Otter Tail Power Company
Northern Municipal Power Agency
Northwestern Corporation
Montana-Dakota Utilities Co.
COAL OWNER(S)
United States of America

LOCATION
NW $\frac{1}{4}$, Sec. 15
SURFACE OWNER(S)
Otter Tail Power Company



1-855-GO2LINK
www.carechoice.nd.gov
ND Relay TTY 1-800-366-6888

PUBLIC NOTICES

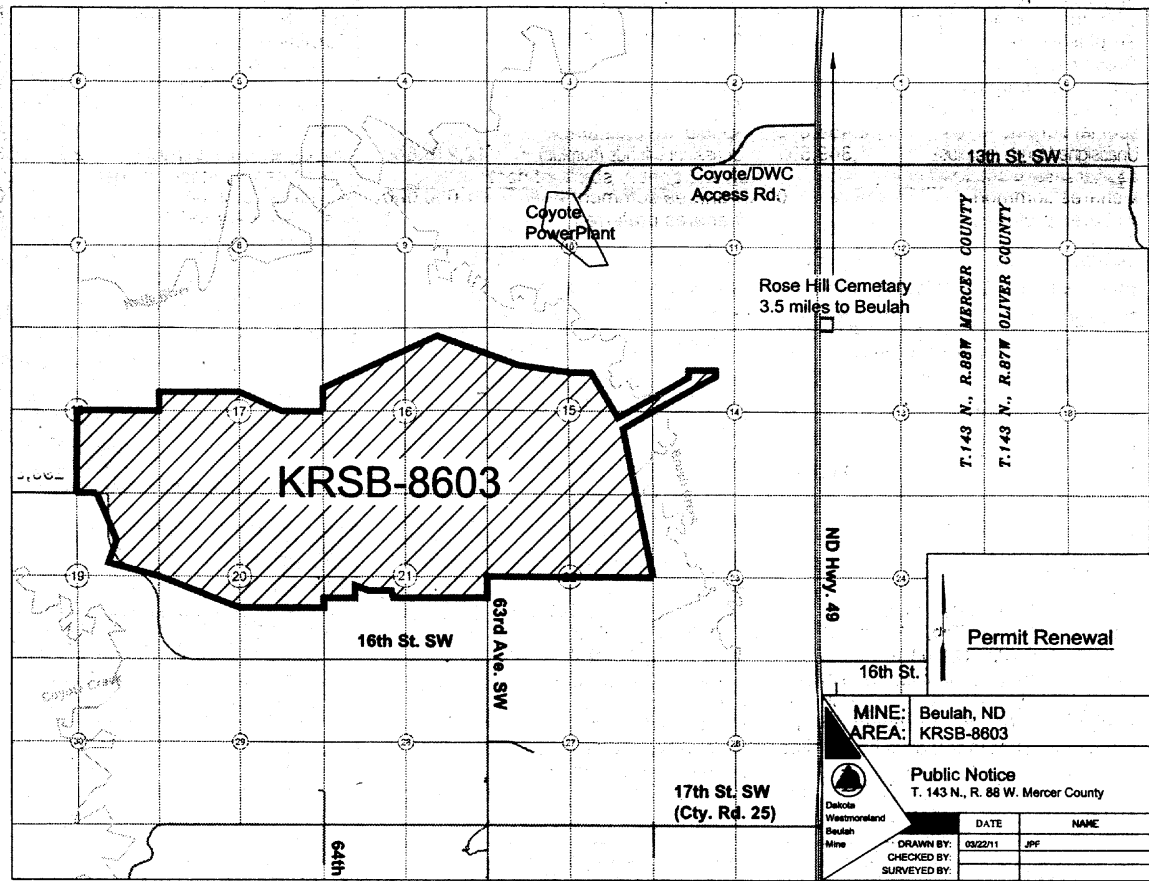

Shawn Voigt
Kenneth Voigt
Karmen Eslinger
Dean Voigt
Patience Saylor

LOCATION
NE $\frac{1}{4}$ NE $\frac{1}{4}$
NW $\frac{1}{4}$ NW $\frac{1}{4}$
S $\frac{1}{2}$ N $\frac{1}{2}$
N $\frac{1}{4}$ S $\frac{1}{4}$, Sec. 20
SURFACE OWNER(S)
Dakota Westmoreland Corporation
COAL OWNER(S)
United States of America

LOCATION
NE $\frac{1}{4}$ NW $\frac{1}{4}$, Sec. 20
SURFACE OWNER(S)
Dakota Westmoreland Corporation
COAL OWNER(S)
Dakota Westmoreland Corp.

LOCATION
NW $\frac{1}{4}$ NE $\frac{1}{4}$, Sec. 20
SURFACE OWNER(S)
Martha Gunsch
COAL OWNER(S)
Martha Gunsch
Ronald Gunsch
Janice Sigman
Sylvia Zeiszler

LOCATION
N $\frac{1}{2}$, Sec. 21
SURFACE OWNER(S)
Leona Weil
Sharon Winkler
Joan Miller
COAL OWNER(S)
Leona Weil
Sharon Winkler
Joan Miller

LOCATION
S $\frac{1}{2}$, Sec. 21
SURFACE OWNER(S)
Wilfred Fetch
Angeline Braun
Cary Unterseher
COAL OWNER(S)
Wilfred Fetch
Angeline Braun
Cary Unterseher

LOCATION
NE $\frac{1}{4}$, Sec. 22
SURFACE OWNER(S)
Terence Schmidt
COAL OWNER(S)
United States of America

LOCATION
NW $\frac{1}{4}$, Sec. 22
SURFACE OWNER(S)
Martha Gunsch
COAL OWNER(S)
United States of America
(5-19-11-5-26-11-6-2-11-6-9-11)

Northern Municipal Power Agency
Northwestern Corporation
Montana-Dakota Utilities Co.
COAL OWNER(S)
Robert A. Keogh
Robert A. Keogh Mineral Trust
Faye Keogh Rev. Trust
Claire C. Schwalbe

LOCATION
NE $\frac{1}{4}$, Sec. 15
SURFACE OWNER(S)
Dakota Westmoreland Corp.
Otter Tail Power Company
Northern Municipal Power Agency
Northwestern Corporation
Montana-Dakota Utilities Co.
COAL OWNER(S)
Robert A. Keogh
Robert A. Keogh Mineral Trust
Faye Keogh Rev. Trust
Claire C. Schwalbe

LOCATION
S $\frac{1}{2}$, Sec. 15
SURFACE OWNER(S)
Faye Keogh Revocable Trust
COAL OWNER(S)
Robert A. Keogh
Robert A. Keogh Mineral Trust
Faye Keogh Rev. Trust
Claire C. Schwalbe

LOCATION
N $\frac{1}{2}$, Sec. 16
SURFACE OWNER(S)
State of North Dakota
COAL OWNER(S)
State of North Dakota

LOCATION
SW $\frac{1}{4}$, Sec. 16
SURFACE OWNER(S)
Leona Weil
Joan Miller
Sharon Winkler
COAL OWNER(S)
State of North Dakota
Leona Weil
Sharon Winkler
Joan Miller

LOCATION
SE $\frac{1}{4}$, Sec. 16
SURFACE OWNER(S)
Martha Gunsch
COAL OWNER(S)
Martha Gunsch
Ronald Gunsch
Janice Sigman
Sylvia Zeiszler
State of North Dakota

LOCATION
S $\frac{1}{2}$, Sec. 17
SURFACE OWNER(S)

Faye Keogh Revocable Trust
COAL OWNER(S)
Robert A. Keogh
Robert A. Keogh Mineral Trust
Faye Keogh Rev. Trust
Claire C. Schwalbe

LOCATION
N $\frac{1}{2}$, Sec. 17
SURFACE OWNER(S)
Claire C. Schwalbe
COAL OWNER(S)
Robert A. Keogh
Robert A. Keogh Mineral Trust
Faye Keogh Rev. Trust
Claire C. Schwalbe

LOCATION
SE $\frac{1}{4}$, Sec. 18
SURFACE OWNER(S)
Donald & Claire Schwalbe
COAL OWNER(S)
Donald & Claire Schwalbe
State of North Dakota

LOCATION
N $\frac{1}{2}$, Sec. 19
SURFACE OWNER(S)
Casey Voigt
COAL OWNER(S)
Casey Voigt
Kari Trappen
Donalda Voigt

(11-6-9-11-5-26-11-6-2-11-6-9-11)

(11-6-9-11-5-26-11-6-2-11-6-9-11)

(11-6-9-11-5-26-11-6-2-11-6-9-11)

(11-6-9-11-5-26-11-6-2-11-6-9-11)

Public Notices

NOTICE OF APPLICATION FOR REVISION AND RENEWAL TO A SURFACE COAL MINE PERMIT

Please take notice that Dakota Westmoreland Corporation, P.O. Box 39, Beulah, North Dakota 58523, has made application to the North Dakota Public Service Commission for Revision No. 24 and Renewal No. 5 to Surface Coal Mining Permit KRSB-8603.

The permit area is located in Sections 14, 15, 16, 17, 18, 19, 20, 21, and 22, T.143N., R.88W., Mercer County, North Dakota. The precise location and boundaries of the permit area are depicted on the accompanying map.

Permit KRSB-8603 encompasses 2,666.1 acres for coal excavation, mining and associated disturbance activities in support thereof. Revision No. 24 updates the current permit to reflect changes necessary for the next permit term including updates to the legal and financial sections, general operations and reclamation plans. In addition, the revision identifies the coal removal sub-area that will be mined during the next 5-year permit term. Renewal No. 5 will allow mining and reclamation activities to continue during the next five-year permit term ending August 7, 2016.

This application is on file in the Office of the Director, Reclamation Division, Public Service Commission, State Capitol, Bismarck, North Dakota and the Office of the County Auditor, Mercer County, Stanton, North Dakota. It may be viewed at these locations during normal working hours.

Written comments, objections, requests for an informal conference or a petition to designate an area as unsuitable for surface coal mining operations may be submitted by any person with an interest which is or may be adversely affected to the North Dakota Public Service Commission, 600 East Boulevard Avenue, Dept. 408, Bismarck, ND 58505-0480, within 30 days of the last publication of this notice. Any request for an informal conference must include the reasons for the request.

The legal description and names of the apparent surface and mineral owners of the permit area follows:
T.143N., R88W., Mercer County

LOCATION
S¹/₂NW¹/₄, Sec. 14
SURFACE OWNER(S)
Otter Tail Power Company
Northern Municipal Power Agency
Northwestern Corporation
Montana-Dakota Utilities Co.
COAL OWNER(S)
United States of America

LOCATION
NW¹/₄, Sec. 15
SURFACE OWNER(S)
Otter Tail Power Company

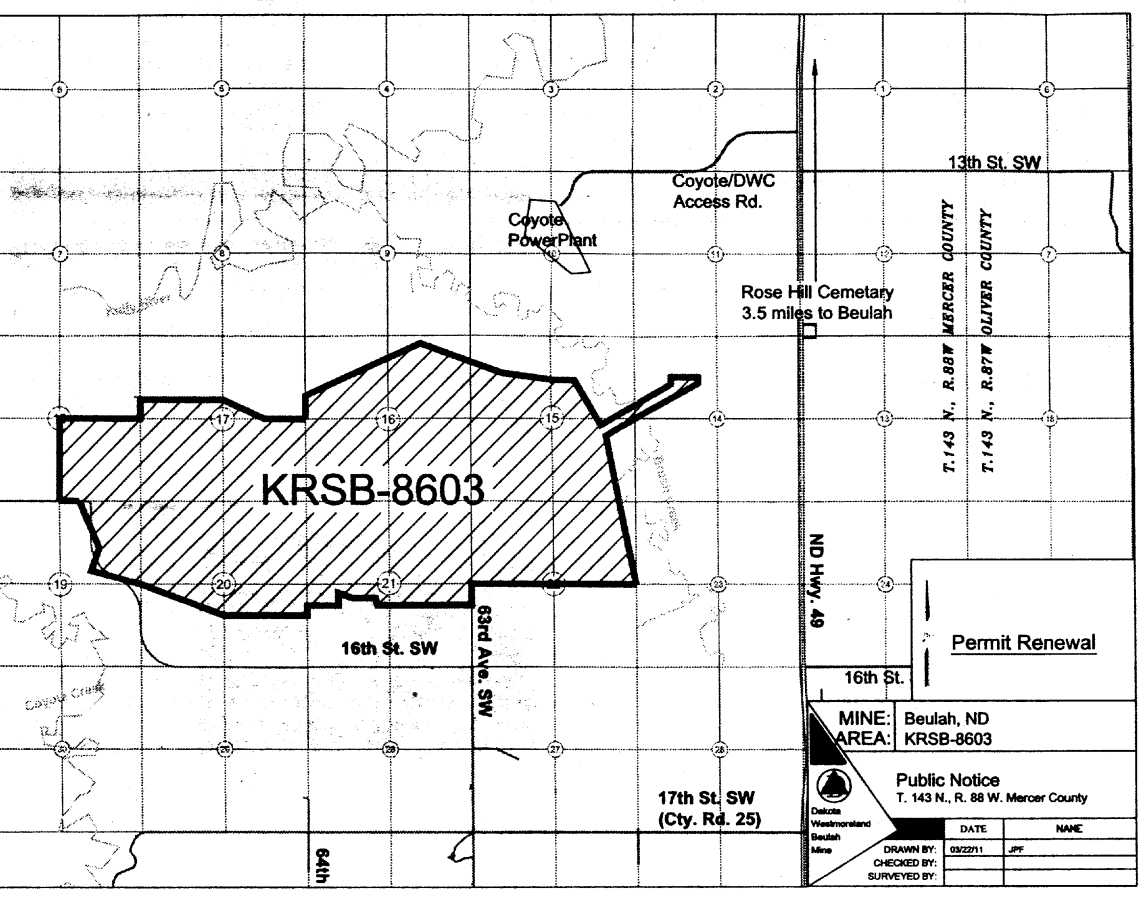

Northern Municipal Power Agency
Northwestern Corporation
Montana-Dakota Utilities Co.
COAL OWNER(S)
Robert A. Keogh
Robert A. Keogh Mineral Trust
Faye Keogh Rev. Trust
Claire C. Schwalbe

LOCATION
NE¹/₄, Sec. 15
SURFACE OWNER(S)
Dakota Westmoreland Corp.
Otter Tail Power Company
Northern Municipal Power Agency
Northwestern Corporation
Montana-Dakota Utilities Co.
COAL OWNER(S)
Robert A. Keogh
Robert A. Keogh Mineral Trust
Faye Keogh Rev. Trust
Claire C. Schwalbe

LOCATION
S¹/₂, Sec. 15
SURFACE OWNER(S)
Faye Keogh Revocable Trust
COAL OWNER(S)
Robert A. Keogh
Robert A. Keogh Mineral Trust
Faye Keogh Rev. Trust
Claire C. Schwalbe

LOCATION
N¹/₂, Sec. 16
SURFACE OWNER(S)
State of North Dakota
COAL OWNER(S)
State of North Dakota

LOCATION
SW¹/₄, Sec. 16
SURFACE OWNER(S)
Leona Weil
Joan Miller
Sharon Winkler
COAL OWNER(S)
State of North Dakota
Leona Weil
Sharon Winkler
Joan Miller

LOCATION
SE¹/₄, Sec. 16
SURFACE OWNER(S)
Martha Gunsch
COAL OWNER(S)
Martha Gunsch
Ronald Gunsch
Janice Sigman
Sylvia Zeiszler
State of North Dakota

LOCATION
S¹/₂, Sec. 17
SURFACE OWNER(S)

Faye Keogh Revocable Trust
COAL OWNER(S)
Robert A. Keogh
Robert A. Keogh Mineral Trust
Faye Keogh Rev. Trust
Claire C. Schwalbe

LOCATION
N¹/₂, Sec. 17
SURFACE OWNER(S)
Claire C. Schwalbe
COAL OWNER(S)
Robert A. Keogh
Robert A. Keogh Mineral Trust
Faye Keogh Rev. Trust
Claire C. Schwalbe

LOCATION
SE¹/₄, Sec. 18
SURFACE OWNER(S)
Donald & Claire Schwalbe
COAL OWNER(S)
Donald & Claire Schwalbe
State of North Dakota

LOCATION
N¹/₂, Sec. 19
SURFACE OWNER(S)
Casey Voigt
COAL OWNER(S)
Casey Voigt
Kari Trappen
Donalda Voigt

Shawn Voigt
Kenneth Voigt
Karmen Eslinger
Dean Voigt
Patience Saylor

LOCATION
NE¹/₄ NE¹/₄
NW¹/₄ NW¹/₄
S¹/₂ N¹/₂
N¹/₂ S¹/₂, Sec. 20
SURFACE OWNER(S)
Dakota Westmoreland Corporation
COAL OWNER(S)
United States of America

LOCATION
NE¹/₄NW¹/₄, Sec. 20
SURFACE OWNER(S)
Dakota Westmoreland Corporation
COAL OWNER(S)
Dakota Westmoreland Corp.

LOCATION
NW¹/₄NE¹/₄, Sec. 20
SURFACE OWNER(S)
Martha Gunsch
COAL OWNER(S)
Martha Gunsch
Ronald Gunsch
Janice Sigman
Sylvia Zeiszler

LOCATION
N¹/₂, Sec. 21
SURFACE OWNER(S)
Leona Weil
Sharon Winkler
Joan Miller
COAL OWNER(S)
Leona Weil
Sharon Winkler
Joan Miller

LOCATION
S¹/₂, Sec. 21
SURFACE OWNER(S)
Wilfred Fetch
Angeline Braun
Cary Unterseher
COAL OWNER(S)
Wilfred Fetch
Angeline Braun
Cary Unterseher

LOCATION
NE¹/₄, Sec. 22
SURFACE OWNER(S)
Terence Schmidt
COAL OWNER(S)
United States of America

LOCATION
NW¹/₄, Sec. 22
SURFACE OWNER(S)
Martha Gunsch
COAL OWNER(S)
United States of America
(5-19-11-5-26-11-6-2-11-6-9-11)