

**DeSaye, Cara G.**

---

**From:** DeSaye, Cara G.  
**Sent:** Thursday, June 23, 2011 4:06 PM  
**To:** 'shandy@kwh.com'; 'bschmidt@kwh.com'  
**Attachments:** 4708\_001.pdf

Please find attached a request from Otter Tail Power Company for temporary authority to extend electric services to Kent Road in Cass County, North Dakota.

Please review this request as soon as possible and let me know whether the Cooperative will protest the application.

Thank you for your attention in this matter.

Cara DeSaye  
ND Public Service Commission  
600 E. Boulevard Ave., Dept. 408  
Bismarck, ND 58505-0480  
701-328-4076  
[cdesaye@nd.gov](mailto:cdesaye@nd.gov)

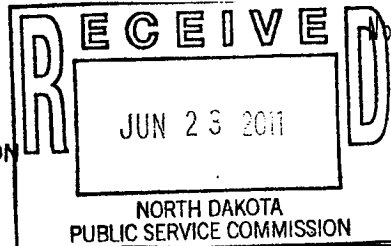

**TEMPORARY AUTHORITY PERMIT**  
 NORTH DAKOTA PUBLIC SERVICE COMMISSION  
 PUBLIC UTILITIES  
 SFN 50680 (8-96)

Date 6/23/11	Time 8:00	<input type="checkbox"/> a.m. <input type="checkbox"/> p.m.	Name of Utility OTTER TAIL POWER COMPANY	Telephone Number 800-257-4044
Name of Person Calling CHARLES KREBS			Name of Coop Serving CASS COUNTY ELECTRIC COOPERATIVE	
Name of Customer KENT ROOD		Location Sec SW1/4 OF NW 1/4-18 Twp 138N R 54W		
Address			County CASS	
City ALICE			State ND	Zip Code 58003
Name of Nearest City ALICE			Distance to the City 90 ft	
When will service be extended? JUNE 2011 OR ASAP		Type of Service <input checked="" type="checkbox"/> Residence <input type="checkbox"/> Storage <input type="checkbox"/> Grain Bin <input type="checkbox"/> Other _____		
Extension Length to Most Economical Point of Service Utility: 300 FT Coop: 2000 FT		Extension <input type="checkbox"/> Overhead <input checked="" type="checkbox"/> Underground		
Has customer signed request for service? <input checked="" type="checkbox"/> Yes <input type="checkbox"/> No		Will cooperative protest application? <input type="checkbox"/> Yes <input checked="" type="checkbox"/> No		
Name of Person Contacted (PSC Use)		Date of Contact (PSC Use)	Time (PSC Use) <input type="checkbox"/> a.m. <input type="checkbox"/> p.m.	
Estimated Cost of Extension \$9,200		Estimated Revenue \$2,000 PER YEAR		
Under what rate filed with the Public Service Commission will customer be served? ND SECTION 9.01, RATE CODE 50-101				
Will extension cross over coop lines? <input type="checkbox"/> Yes <input checked="" type="checkbox"/> No		Will extension cross over railroad tracks? <input type="checkbox"/> Yes <input checked="" type="checkbox"/> No		
Temporary Authority Authorized By <input type="checkbox"/> Telephone <input checked="" type="checkbox"/> Letter		Date Authorized		
Authorized By (Name of Commissioner)				

Extension must be made from most economical point of service.

**Comments:**  
 OTTER TAIL POWER COMPANY EXTENSION IS APPROXIMATELY 300 FT EAST OF OUR ALICE 115 KV SUBSTATION. CASS COUNTY ELECTRIC COOPERATIVE IS APPROXIMATELY 2,000 FT NORTH.  
  
 AGREEMENT REACHED WITH CASS COUNTY ELECTRIC COOPERATIVE (DONNIE BAASCH) ON JUNE 20, 2011, FOR OTTER TAIL POWER COMPANY TO PROVIDE SERVICE.

P. 3.

No. 9283

150'

OTPCO SUB. LOT

3-266R

2-1ØR

~ 300

300'

F1-F240K)  
SLUGGED

3-50'

KENT  
ROAD.

ALICE SUBSTATION  
SUB NO. 63259

3-250 KVAR

115KV 7.2

FLOAT 

F3-F5(200K)  
SLUGGED

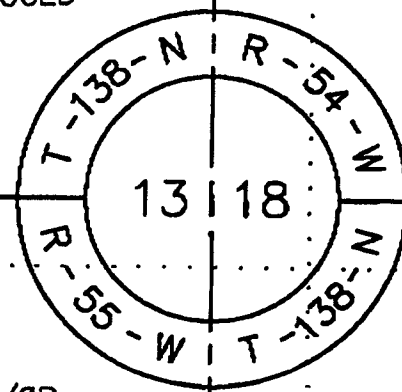

1-1ØRN

3-1/ØR

50'

Jun. 23. 2011 11:51AM