



TEMPORARY AUTHORITY PERMIT
NORTH DAKOTA PUBLIC SERVICE COMMISSION
PUBLIC UTILITIES
 SFN 50560 (8-96)

Date 6/24/11	Time 8:00	<input type="checkbox"/> a.m. <input type="checkbox"/> p.m.	Name of Utility OTTER TAIL POWER COMPANY	Telephone Number 800-257-4044
Name of Person Calling CHARLES KREBS			Name of Coop Serving NODAK ELECTRIC COOPERATIVE INC	
Name of Customer CLIFFORD FARMERS COOPERATIVE ELEVATOR		Location NW 1/4 OF NW 1/4-27 Twp 145-N R 53-W		
Address PO BOX 68			County TRAIL	
City CLIFFORD			State ND	Zip Code 58016-0068
Name of Nearest City CLIFFORD			Distance to the City APPROX 350 FT	
When will service be extended? JULY 2011		Type of Service <input type="checkbox"/> Residence <input type="checkbox"/> Storage <input type="checkbox"/> Grain Bin <input checked="" type="checkbox"/> Other <u>COMMERCIAL</u>		
Extension Length to Most Economical Point of Service Utility: 600 FT Coop: UNKNOWN		Extension <input checked="" type="checkbox"/> Overhead <input type="checkbox"/> Underground		
Has customer signed request for service? <input checked="" type="checkbox"/> Yes <input type="checkbox"/> No		Will cooperative protest application? <input type="checkbox"/> Yes <input checked="" type="checkbox"/> No		
Name of Person Contacted (PSC Use)		Date of Contact (PSC Use)	Time (PSC Use) <input type="checkbox"/> a.m. <input type="checkbox"/> p.m.	
Estimated Cost of Extension \$13,000		Estimated Revenue \$4,000 PER YEAR		
Under what rate filed with the Public Service Commission will customer be served? ND SECTION 10.02, RATE 50-401				
Will extension cross over coop lines? <input type="checkbox"/> Yes <input checked="" type="checkbox"/> No		Will extension cross over railroad tracks? <input type="checkbox"/> Yes <input checked="" type="checkbox"/> No		
Temporary Authority Authorized By <input type="checkbox"/> Telephone <input type="checkbox"/> Letter		Date Authorized		
Authorized By (Name of Commissioner)				

Extension must be made from most economical point of service.

Comments:
 OTTER TAIL POWER COMPANY EXTENSION IS APPROXIMATELY 600 FT FROM OUR NEAREST THREE-PHASE LINE WITHIN THE CITY LIMITS AND APPROXIMATELY 300 FT NORTH OF THE CITY LIMITS.

AGREEMENT REACHED WITH NODAK ELECTRIC COOPERATIVE INC (GEORGE BERG, GENERAL MANAGER) ON JUNE 24, 2011, FOR OTTER TAIL POWER COMPANY TO PROVIDE SERVICE DUE TO THE DISTANCE INVOLVED FOR THEM TO PROVIDE THREE-PHASE SERVICE.

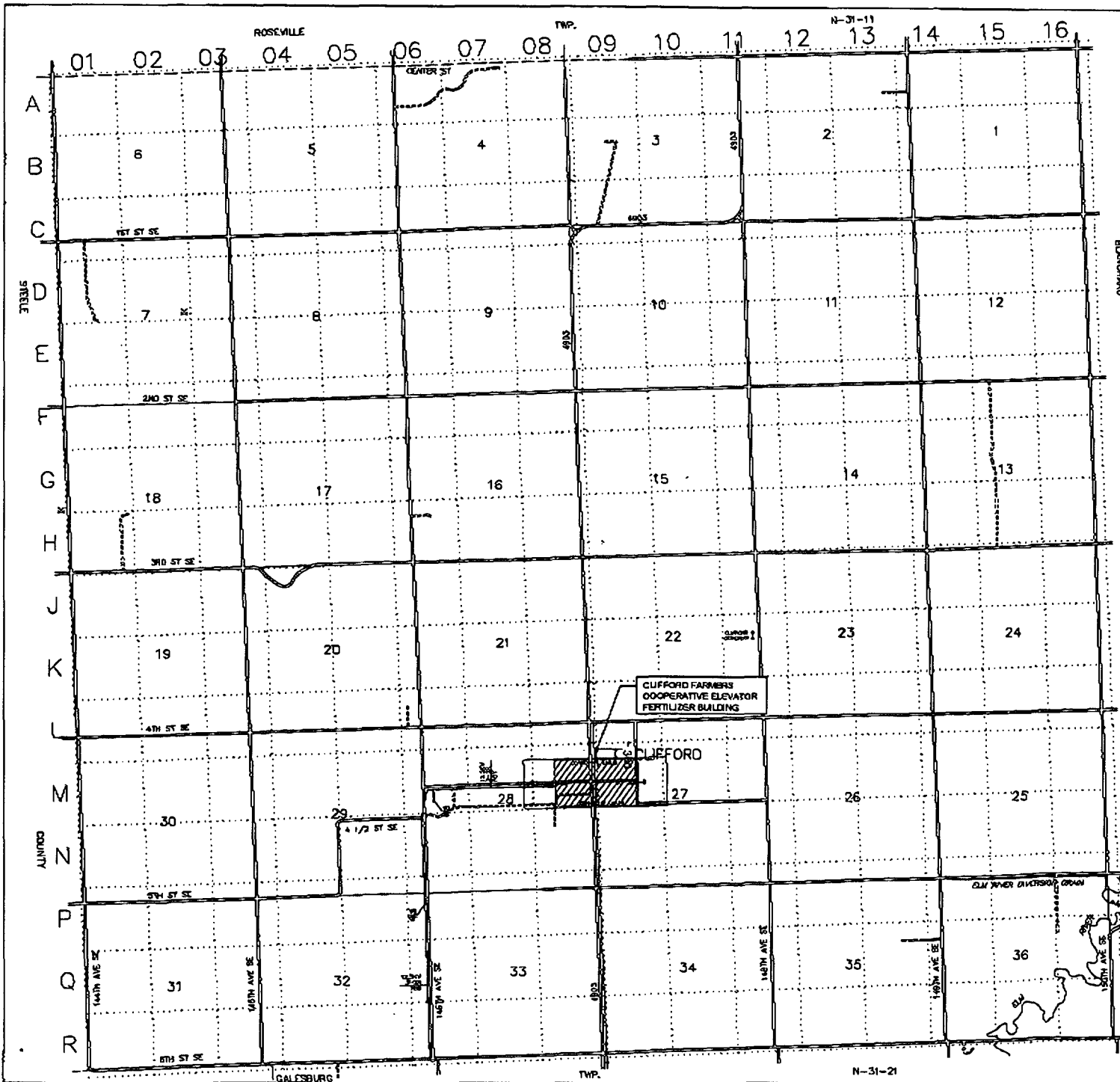

NORMAN TOWNSHIP

T-145-N : R-53-W
 TRAIL COUNTY, NORTH DAKOTA

Scale: 1" = 2000' 3-7-2001
 BY : S. GUNDERSON

Reference USCS 7.5 minute series
 quadrangle maps:
 Gadsburg NW, ND 1988
 Mayville South, ND 1981
 Gadsburg, ND 1986
 Gadsburg SE, ND 1968

LEGEND

1	CORNER	1	ROAD	1	RAILROAD
2	CRASS	2	CRASS	2	RAILROAD
3	CRASS	3	CRASS	3	RAILROAD
4	CRASS	4	CRASS	4	RAILROAD
5	CRASS	5	CRASS	5	RAILROAD
6	CRASS	6	CRASS	6	RAILROAD
7	CRASS	7	CRASS	7	RAILROAD
8	CRASS	8	CRASS	8	RAILROAD
9	CRASS	9	CRASS	9	RAILROAD
10	CRASS	10	CRASS	10	RAILROAD
11	CRASS	11	CRASS	11	RAILROAD
12	CRASS	12	CRASS	12	RAILROAD
13	CRASS	13	CRASS	13	RAILROAD
14	CRASS	14	CRASS	14	RAILROAD
15	CRASS	15	CRASS	15	RAILROAD
16	CRASS	16	CRASS	16	RAILROAD
17	CRASS	17	CRASS	17	RAILROAD
18	CRASS	18	CRASS	18	RAILROAD
19	CRASS	19	CRASS	19	RAILROAD
20	CRASS	20	CRASS	20	RAILROAD
21	CRASS	21	CRASS	21	RAILROAD
22	CRASS	22	CRASS	22	RAILROAD
23	CRASS	23	CRASS	23	RAILROAD
24	CRASS	24	CRASS	24	RAILROAD
25	CRASS	25	CRASS	25	RAILROAD
26	CRASS	26	CRASS	26	RAILROAD
27	CRASS	27	CRASS	27	RAILROAD
28	CRASS	28	CRASS	28	RAILROAD
29	CRASS	29	CRASS	29	RAILROAD
30	CRASS	30	CRASS	30	RAILROAD
31	CRASS	31	CRASS	31	RAILROAD
32	CRASS	32	CRASS	32	RAILROAD
33	CRASS	33	CRASS	33	RAILROAD
34	CRASS	34	CRASS	34	RAILROAD
35	CRASS	35	CRASS	35	RAILROAD
36	CRASS	36	CRASS	36	RAILROAD

CLIFFORD FARMERS
COOPERATIVE ELEVATOR
FERTILIZER BUILDING

CLIFFORD
27

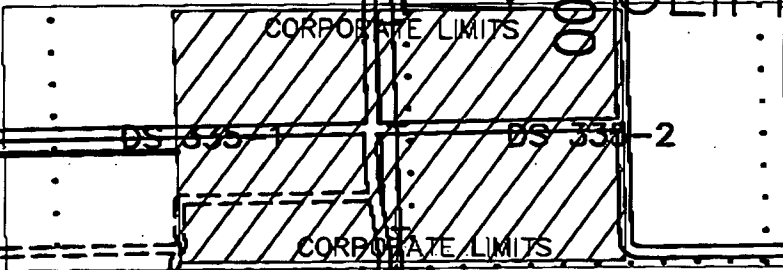

28

